

(SEE NOTE 4)

HDMR-XX-XX-X-XX-XX-XX

No OF POSITIONS \_\_\_\_\_

-19: (SEE SHT 1, FIG. 1)

-29: (SEE SHT 3)

SHIELD TAIL STYLE \_\_\_\_\_

-01: THROUGH HOLE

-02: SURFACE MOUNT

(SEE SHT 2, FIG 2)(-19 POS ONLY)

- PACKAGING OPTION
  - TR: TAPE & REEL (ONLY AVAILABLE WITH OUT -PF OPTION)
- OPTION
  - PF: PANEL FLANGE (SEE SHT 2, FIG. 4)
  - L: LOCKING OPTION (ONLY AVAILABLE ON HDMR-19-01-X-TH-PF-L, SEE SHT 2, FIG 5 & HDMR-29-01-X-TH-PF-L, SEE SHT 3 FIG 8)
- LEAD TERMINATION
  - SM: SURFACE MOUNT
  - TH: THROUGH HOLE (ONLY AVAILABLE ON HDMR-19-01-X-TH-PF-L) (SEE SHT 2, FIG 3)

PLATING (C2)  
(-19 POSITION)  
-S: CONTACT AREA: .000030" GOLD  
TAILS: BRIGHT ACID TIN  
SHELL: NICKEL  
-F: CONTACT AREA: .000001" GOLD  
TAILS: BRIGHT ACID TIN  
SHELL: NICKEL  
(-29 POSITION)  
-S: CONTACT AREA: .000030" GOLD  
TAILS: BRIGHT ACID TIN  
SHELL: NICKEL  
-F: CONTACT AREA: .000001" GOLD  
TAILS: BRIGHT ACID TIN  
SHELL: NICKEL

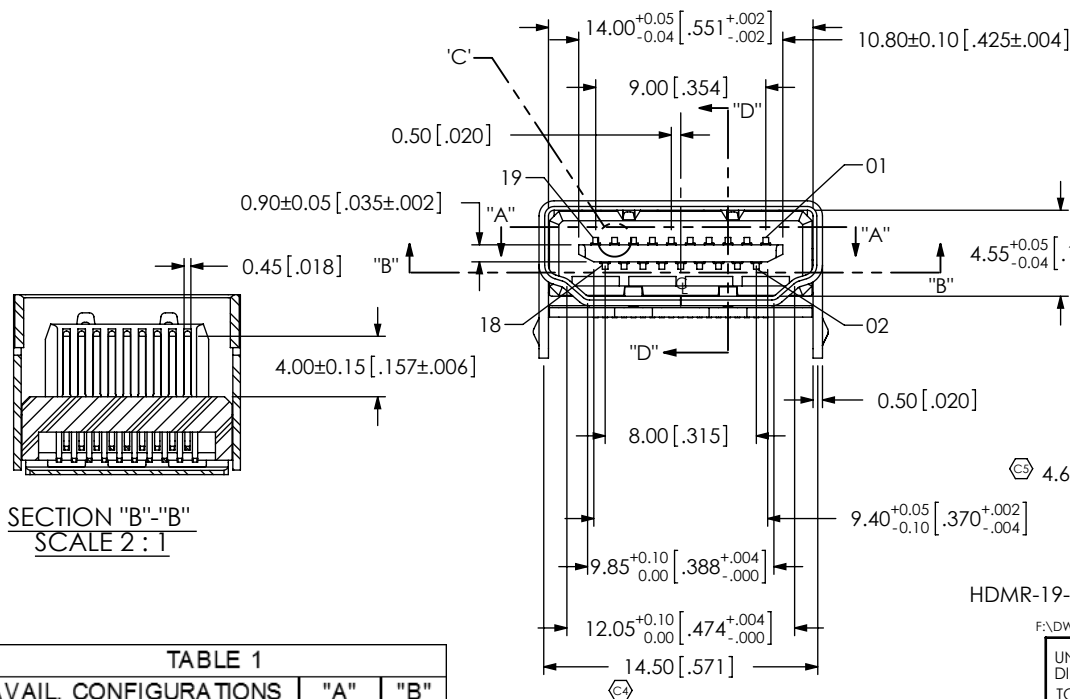
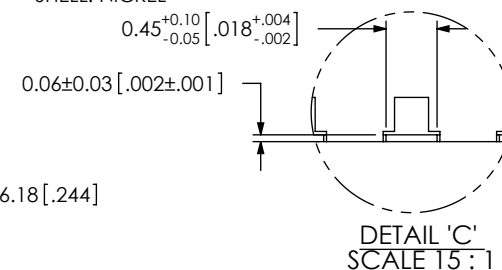
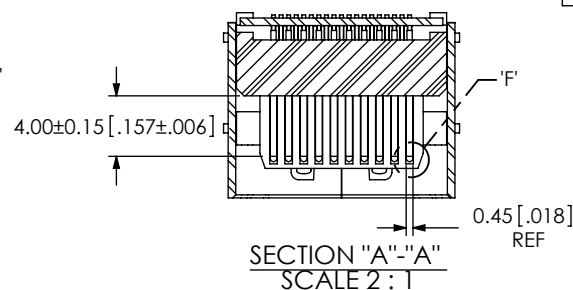
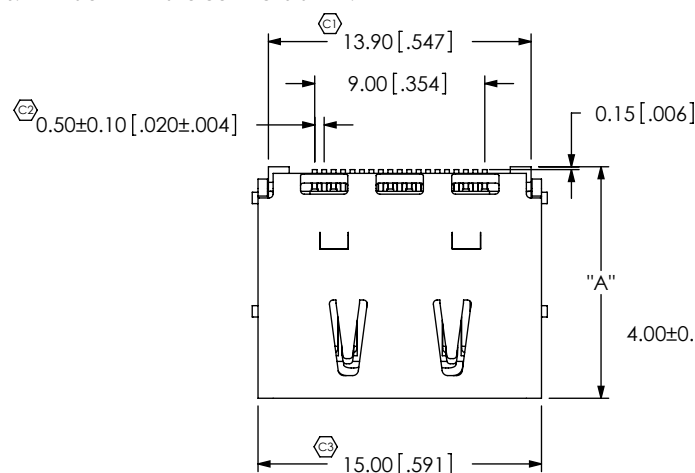

FIG 1  
HDMR-19-01-X-SM SHOWN

F:\DWG\MISC\Mktg\HDMR-XX-XX-X-XX-XX-XX-MKT.SLDDRW

**TOLERANCES ARE:**

DECIMALS	ANGLES
.X: $\pm 0.25[.010]$	1°
.XX: $\pm 0.20[.008]$	
.XXX: $\pm 0.10[.004]$	

THIS DOCUMENT CONTAINS INFORMATION  
CONFIDENTIAL AND PROPRIETARY TO  
SAMTEC, INC. AND SHALL NOT BE REPRODUCED  
OR TRANSFERRED TO OTHER DOCUMENTS OR  
DISCLOSED TO OTHERS OR USED FOR ANY  
PURPOSE OTHER THAN THAT WHICH IT WAS  
OBTAINED WITHOUT THE EXPRESSED WRITTEN  
CONSENT OF SAMTEC, INC.

**MATERIAL:**  
INSULATOR: HIGH TEMP THERMOPLASTIC (UL94V-0)  
CONTACT: COPPER ALLOY  
SHELL: NICKEL PLATED BRASS

DO NOT SCALE DRAWING SHEET SCALE: 1:0.333333

3	DESCRIPTION:
---	--------------

HDMI RECEPTACLE

DWG. NO.

HDMR-XX-XX-X-XX-XX-XX

BY: B. PERRY 9/14/07

SHEET 1 OF 3

TABLE 1

AVAIL. CONFIGURATIONS	"A"	"B"
HDMR-19-01-X-SM	12.16	5.96
HDMR-19-02-X-SM	12.16	5.96
HDMR-19-01-X-SM-PF	12.16	5.96
HDMR-19-02-X-SM-PF	12.16	5.96
HDMR-19-01-X-TH-PF-L	12.25	6.00
HDMR-29-01-X-SM	SEE SHT 3	
HDMR-29-01-X-SM-PF	SEE SHT 3	

FIG 2  
-02 SHIELD TAIL STYLE  
(HDMR-19-02-X-SM SHOWN)  
(DIFFERENT AS SHOWN, OTHERWISE SAME AS FIG 1))

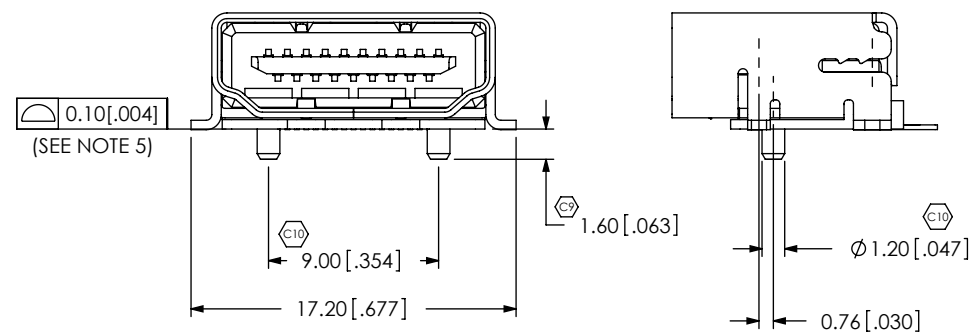

FIG 3  
-TH LEAD TERMINATION STYLE  
(ONLY AVAILABLE ON HDMR-19-01-X-TH-PF-L)  
(DIFFERENT AS SHOWN, OTHERWISE SAME AS FIG 1))

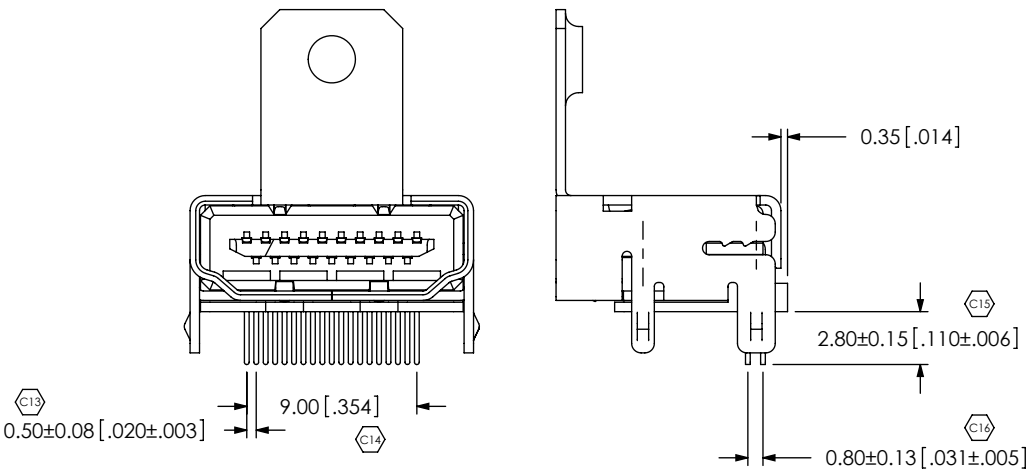

FIG 4  
-PF: PANEL FLANGE  
(HDMR-19-01-X-SM-PF SHOWN)  
(DIFFERENT AS SHOWN, OTHERWISE SAME AS FIG 1))

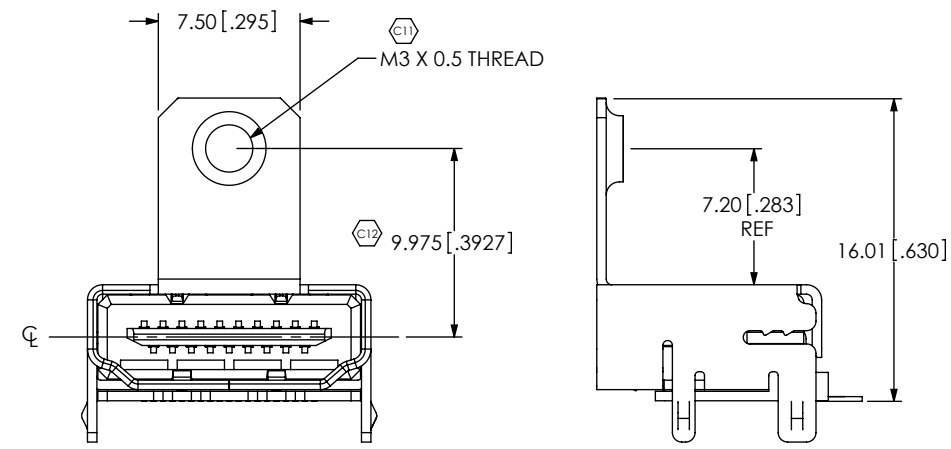
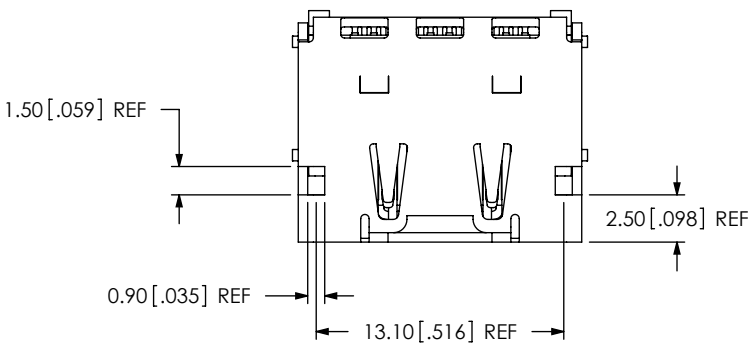

FIG 5  
-L: LOCKING LEADS  
(ONLY AVAILABLE ON HDMR-19-01-X-TH-PF-L)  
(DIFFERENT AS SHOWN, OTHERWISE SAME AS FIG 1))



<p>PROPRIETARY NOTE</p> <p>THIS DOCUMENT CONTAINS INFORMATION CONFIDENTIAL AND PROPRIETARY TO SAMTEC, INC. AND SHALL NOT BE REPRODUCED OR TRANSFERRED TO OTHER DOCUMENTS OR DISCLOSED TO OTHERS OR USED FOR ANY PURPOSE OTHER THAN THAT WHICH IT WAS OBTAINED WITHOUT THE EXPRESSED WRITTEN CONSENT OF SAMTEC, INC.</p> <p>DO NOT SCALE DRAWING</p> <p>SHEET SCALE: 3:1</p>		
	520 PARK EAST BLVD, NEW ALBANY, IN 47150 PHONE: 812-944-6733 FAX: 812-948-5047 e-Mail: info@SAMTEC.com code 55322	
	DESCRIPTION: HDMI RECEPTACLE	
	DWG. NO. HDMR-XX-XX-X-XX-XX-XX	
BY: B. PERRY 9/14/07		SHEET 2 OF 3

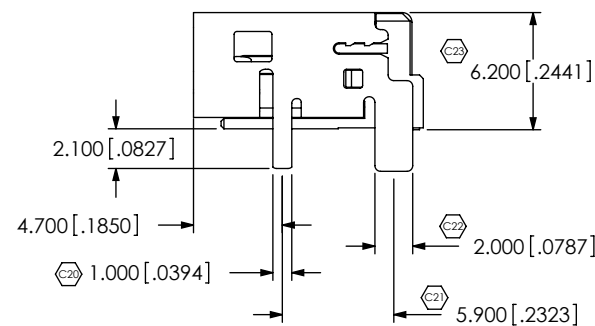
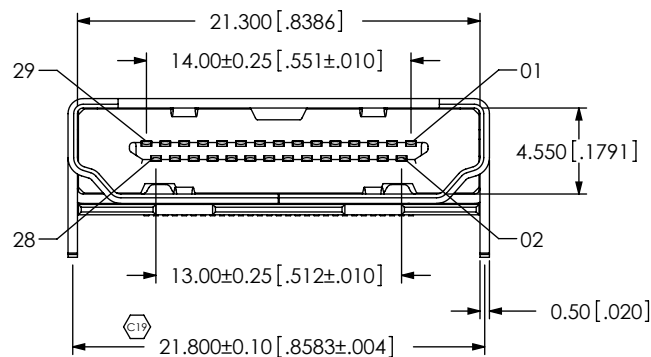
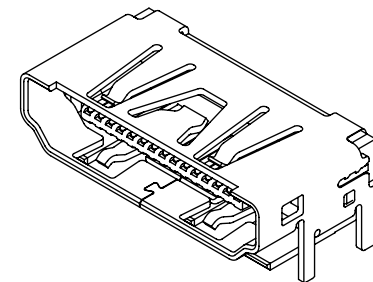
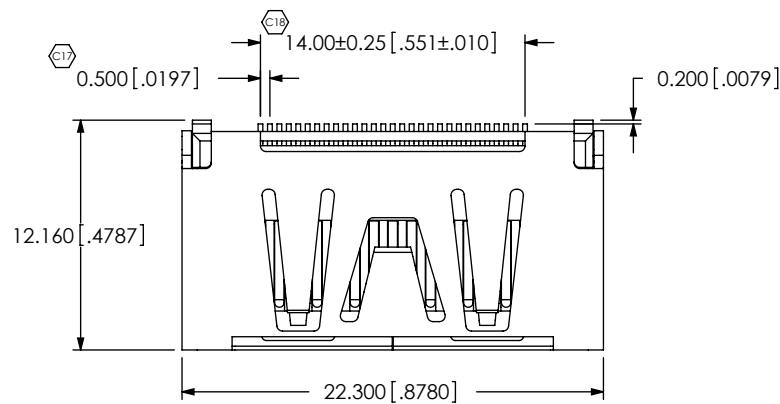
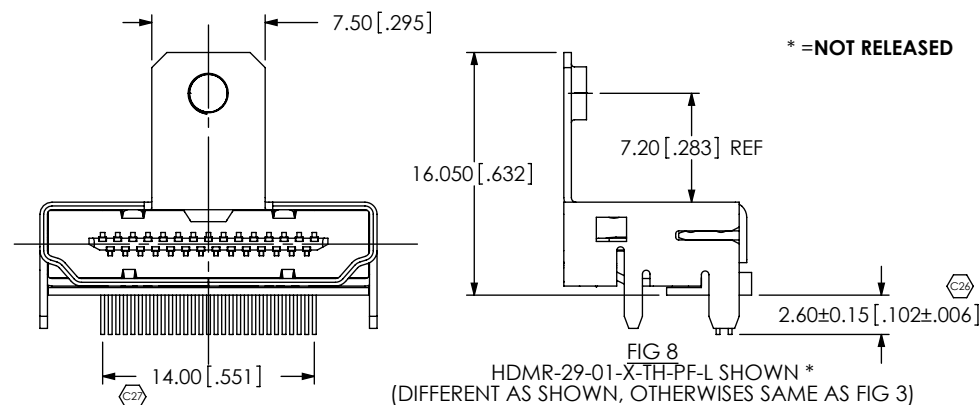
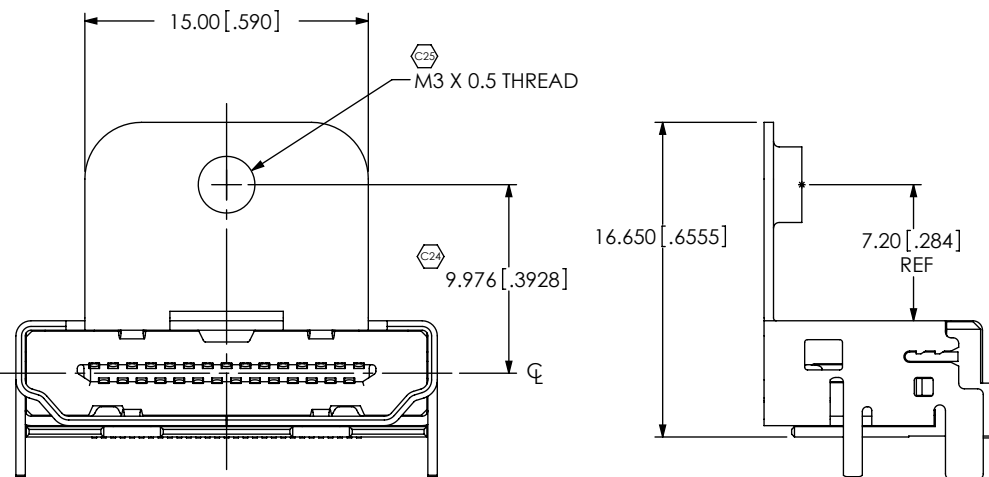

FIG 7  
HDMR-29-01-X-SM-PF SHOWN  
(DIFFERENT AS SHOWN, OTHERWISE SAME AS FIG 6)



PROPRIETARY NOTE

THIS DOCUMENT CONTAINS INFORMATION  
CONFIDENTIAL AND PROPRIETARY TO  
SAMTEC, INC. AND SHALL NOT BE REPRODUCED  
OR TRANSFERRED TO OTHER DOCUMENTS OR  
DISCLOSED TO OTHERS OR USED FOR ANY  
PURPOSE OTHER THAN THAT WHICH IT WAS  
OBTAINED WITHOUT THE EXPRESSED WRITTEN  
CONSENT OF SAMTEC, INC.

DO NOT SCALE DRAWING

SHEET SCALE: 3:1

**samtec**

520 PARK EAST BLVD, NEW ALBANY, IN 47150  
PHONE: 812-944-6733 FAX: 812-948-5047  
e-Mail: info@SAMTEC.com code 55322

DESCRIPTION:

HDMI RECEPTACLE

DWG. NO.

HDMR-XX-XX-X-XX-XX-XX

BY: B. PERRY 9/14/07

SHEET 3 OF 3

# Mouser Electronics

Authorized Distributor

Click to View Pricing, Inventory, Delivery & Lifecycle Information:

[Samtec:](#)

[HDMR-19-01-F-SM-TR](#)