

PAGE 1/2

ISSUE 30-06-15A

SERIES **SMB**

PART NUMBER **R114426147**

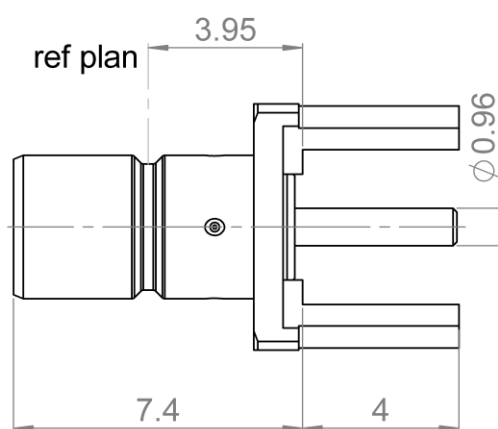
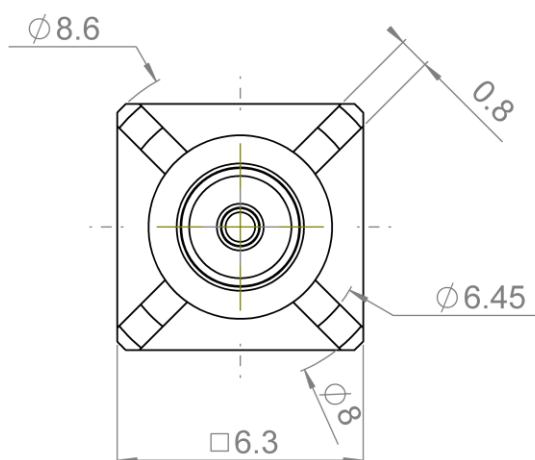

### PANEL CUT OUT

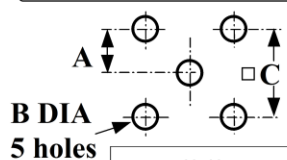

	mm	
	Maxi	mini
A	2.59	2.49
B	1.40	1.30
C	5.16	5.00

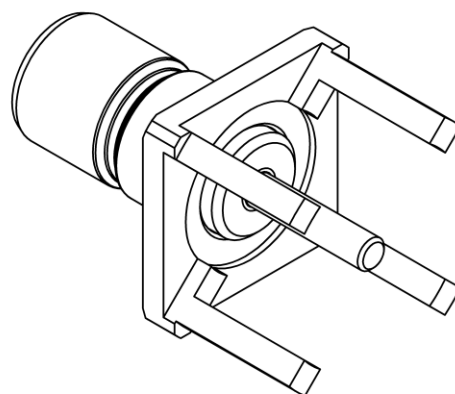
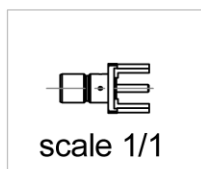

All dimensions are in mm.

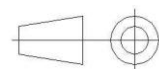

COMPONENTS	MATERIALS	PLATING (μm)
Body	<b>NON MAGNETIC BRONZE</b>	<b>GOLD OVER COPPER</b>
Center contact	<b>NON MAGNETIC BRONZE</b>	<b>GOLD OVER COPPER</b>
Outer contact	-	-
Insulator	<b>PTFE</b>	-
Gasket	-	-
Others parts	-	-
-	-	-
-	-	-

PAGE 2/2

ISSUE **30-06-15A**

SERIES **SMB**

PART NUMBER **R114426147**

### PACKAGING

Standard	Unit	Other
<b>100</b>	<b>Contact us</b>	<b>Contact us</b>

### ELECTRICAL CHARACTERISTICS

Impedance	<b>50</b>	$\Omega$
Frequency	<b>0-4</b>	GHz
VSWR	<b>1.05*</b> + <b>0.0080</b>	x F(GHz) Maxi
Insertion loss	<b>0.03</b>	$\sqrt{F}$ (GHz) dB Maxi
RF leakage	- ( <b>57</b>	- F(GHz)) dB Maxi
Voltage rating	<b>500</b>	Veff Maxi
Dielectric withstanding voltage	<b>1000</b>	Veff mini
Insulation resistance	<b>1000</b>	M $\Omega$ mini

### MECHANICAL CHARACTERISTICS

Center contact retention		
Axial force – Mating End	<b>10</b>	N mini
Axial force – Opposite end	<b>10</b>	N mini
Torque	<b>NA</b>	N.cm mini
Recommended torque		
Mating	<b>NA</b>	N.cm
Panel nut	<b>NA</b>	N.cm
Mating life	<b>500</b>	Cycles mini
Weight	<b>0.6000</b>	g

### ENVIRONMENTAL

Operating temperature	<b>-65/+165</b>	°C
Hermetic seal	<b>NA</b>	Atm.cm3/s
Panel leakage	<b>NA</b>	

### SPECIFICATION

### OTHER CHARACTERISTICS

Assembly instruction:

Others:

**\* COAXIAL TRANSMISSION LINE ONLY**

**Distorsion of the magnetic field**

**<0.5 ppm at 10mm at Bo=1.5 Tesla**

**Non magnetic component**

# Mouser Electronics

Authorized Distributor

Click to View Pricing, Inventory, Delivery & Lifecycle Information:

Radial:

[R114426147](#)