

PAGE 1/4

ISSUE **26-04-18A**

SERIES **DIVERS**

PART NUMBER **R299763000**

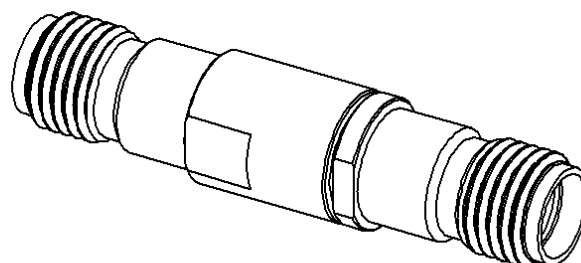
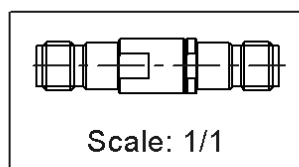
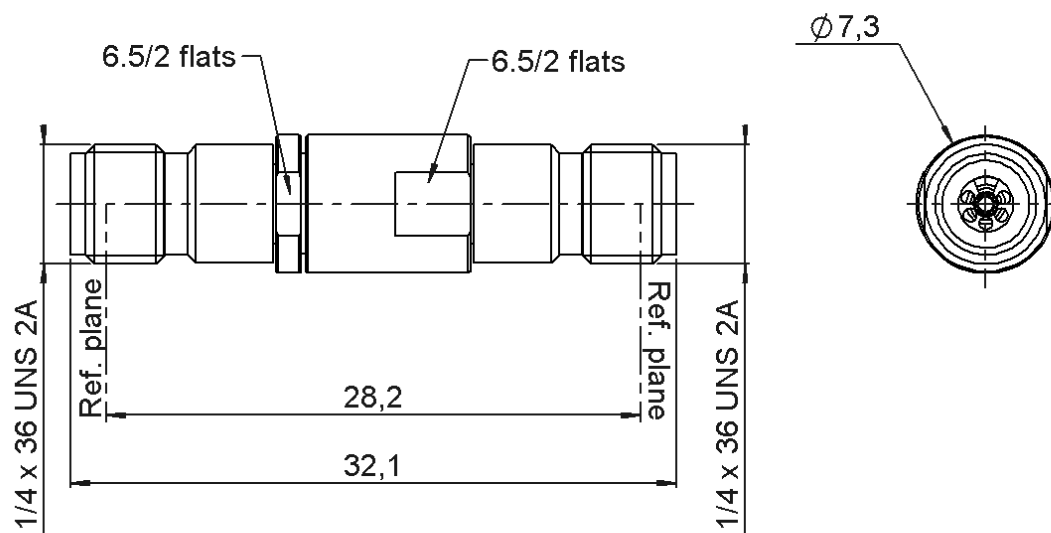

All dimensions are in mm. Tolerances according ISO 2768 m-H

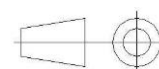

COMPONENTS	MATERIALS	PLATING (μm)
Body	STAINLESS STEEL, BRASS	GOLD OVER NICKEL
Center contact	BERYLLIUM COPPER	GOLD OVER NICKEL
Outer contact		
Insulator	PEEK	
Gasket		
Others parts		
-	-	-
-	-	-

PAGE 2/4

ISSUE **26-04-18A**

SERIES **DIVERS**

PART NUMBER **R299763000**

PACKAGING

Standard	Unit	Other
1	Contact us	Contact us

ELECTRICAL CHARACTERISTICS

Impedance	50	Ω
Frequency	0-18	GHz
VSWR	* + 0,0000	x F(GHz) Maxi
Insertion loss	**	\sqrt{F} (GHz) dB Maxi
RF leakage	- (NA	- F(GHz)) dB Maxi
Voltage rating	90	Veff Maxi
Dielectric withstanding voltage	130	Veff mini
Insulation resistance	5000	M Ω mini

MECHANICAL CHARACTERISTICS

Center contact retention		
Axial force – Mating End	27	N mini
Axial force – Opposite end	27	N mini
Torque	NA	N.cm mini
Recommended torque		
Mating	NA	N.cm
Panel nut	NA	N.cm
Mating life	500	Cycles mini
Weight	6,0000	g

ENVIRONMENTAL

Operating temperature	-65/+165	°C
Hermetic seal	NA	Atm.cm3/s
Panel leakage	NA	

SPECIFICATION

OTHER CHARACTERISTICS

Assembly instruction:

Others:

***V.S.W.R: 1.3 max DC-12GHz**

***V.S.W.R: 1.5 max 12.5-18GHz**

****0.13 dB max**

COMPONENTS

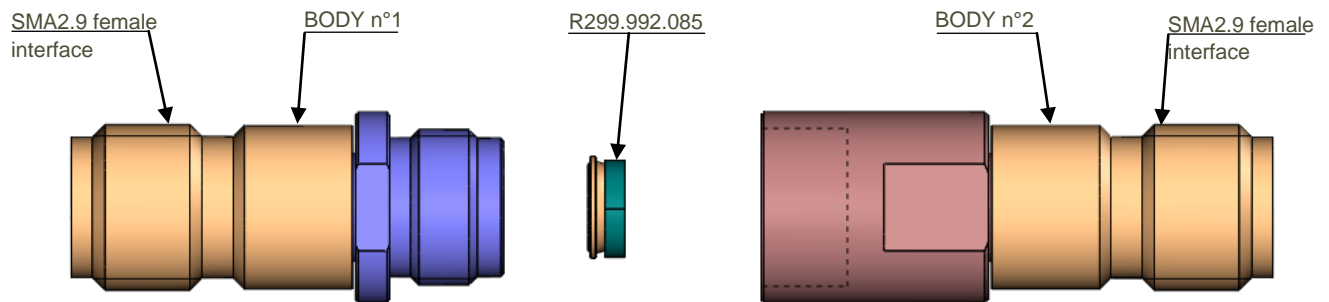

1

- Hold the body 1 of the measuring connector.
- Take the R299.992.085 connector to measure in V.S.W.R.
- Mount the R299.992.085 connector in the body cavity 1.

-Warning
Observe the mounting direction.

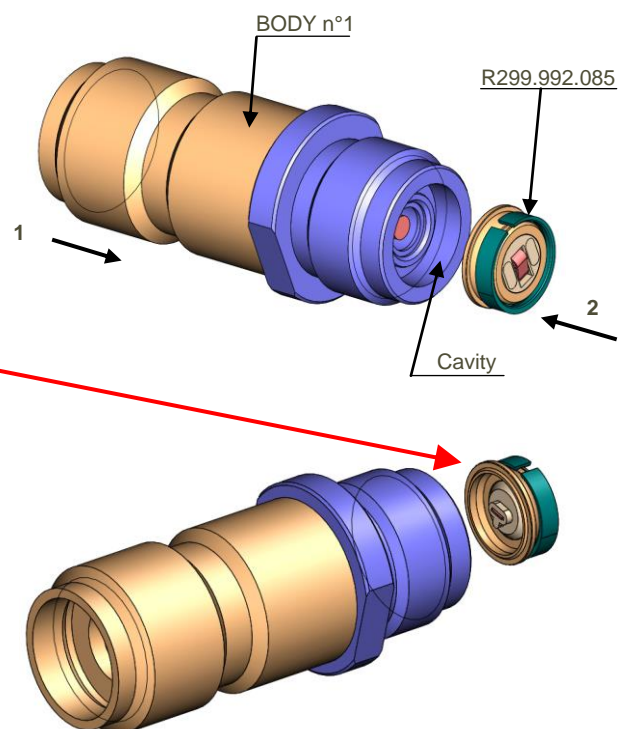

2

- Take the body 2 of the measuring connector.
- Screw the body 2 onto the body 1 of the measuring connector.
- Recommended tightening torque: 90N.cm**

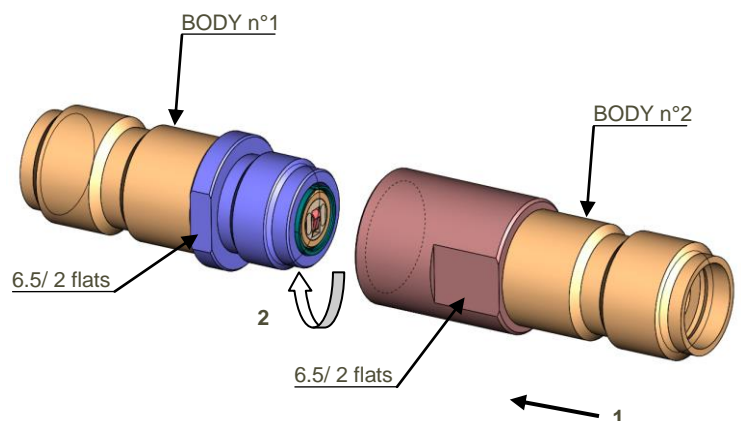

PAGE 4/4

ISSUE **26-04-18A**

SERIES **DIVERS**

PART NUMBER **R299763000**

3

- Connect the assembly obtained to the terminals of a spectrum analyzer.
- Measure the V.S.W.R.
- To have V.S.W.R measurement of the R299.992.085 connector, make gates closer to it.

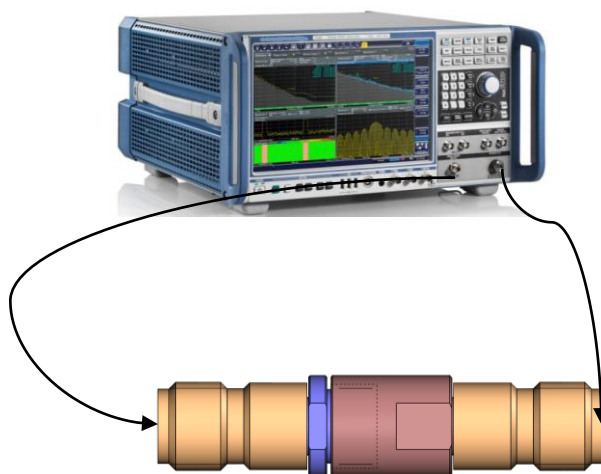

Mouser Electronics

Authorized Distributor

Click to View Pricing, Inventory, Delivery & Lifecycle Information:

Radial:

[R299763000](#)