

4112-9212 This information is given as an indication. In the continual goal to improve our products, we reserve the right to make any modifications judged necessary



**3 GHz    N    FAILSAFE    TRANSFER    SWITCH**

Page  
1 / 2

OPTIONS:

**R F CHARACTERISTICS**

FREQUENCY RANGE : 0 - 3 GHz  
IMPEDANCE : 50 Ohms

|                 |            |         |         |
|-----------------|------------|---------|---------|
| FREQUENCY (GHz) | 0 - 1      | 1 - 2   | 2 - 3   |
| V.S.W.R         | <= 1.15    | 1.20    | 1.25    |
| INSERT. LOSS    | <= 0.15 dB | 0.20 dB | 0.25 dB |
| ISOLATION       | >= 85 dB   | 80 dB   | 75 dB   |
| AVER. POWER (*) | 700 W      | 500 W   | 400 W   |

**ELECTRICAL CHARACTERISTICS**

ACTUATOR : FAILSAFE  
NOMINAL CURRENT AT 25° C (±10%) : 340 mA  
ACTUATOR VOLTAGE (Vcc) : 12V (10.2 to 13V)  
TERMINALS : solder pins (250 Deg.C max./30 sec)

**MECHANICAL CHARACTERISTICS**

CONNECTORS : N female per MIL C 39012  
LIFE : 2.500.000 cycles  
SWITCHING TIME (nominal voltage;25° C) : < 15 ms  
CONSTRUCTION : splashproof  
WEIGHT : < 215 g

**ENVIRONMENTAL CHARACTERISTICS**

OPERATING TEMPERATURE RANGE (°C) : -40 , +85  
STORAGE TEMPERATURE RANGE (°C) : -55 , +85

(\* : average power at 25° C)

4113-9212 This information is given as an indication. In the continual goal to improve our products, we reserve the right to make any modifications judged necessary

DRAWING

General tolerance:  $\pm 0,5$  mm

R577.012.002

Page  
2/2

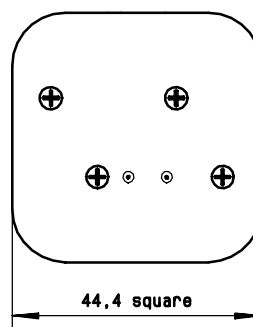
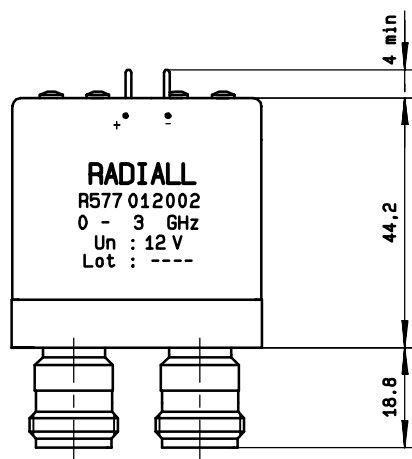
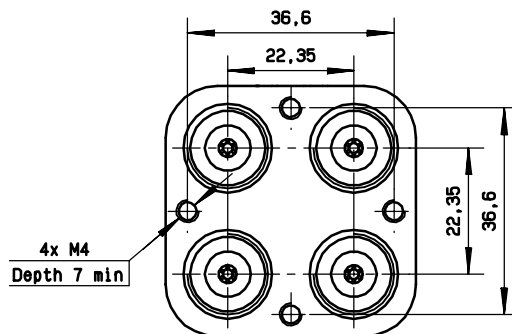
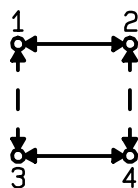

SCHEMATIC DIAGRAM

| Voltage      | RF continuity |
|--------------|---------------|
| energized    | 1↔3 2↔4       |
| De-energized | 1↔2 3↔4       |

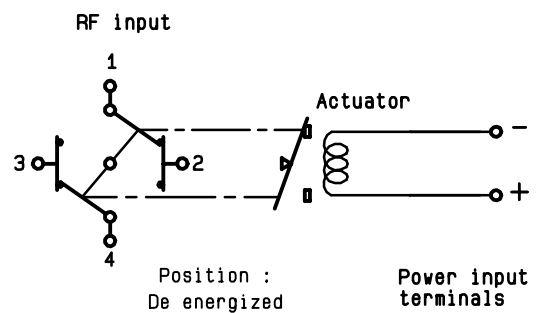

ISSUE 22. jan.08

# Mouser Electronics

Authorized Distributor

Click to View Pricing, Inventory, Delivery & Lifecycle Information:

Radial:

[R577012002](#)