

PAGE 1/2	ISSUE 1416C	SERIES ADAPTER	PART NUMBER <b>R191663000</b>
----------	-------------	-------------------	-------------------------------

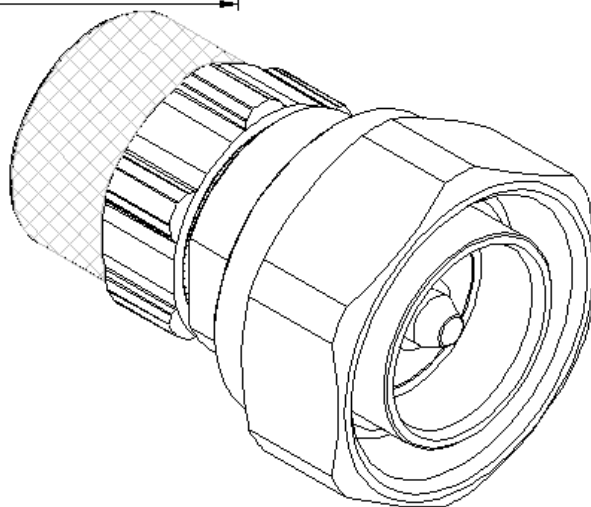

All dimensions are in mm.

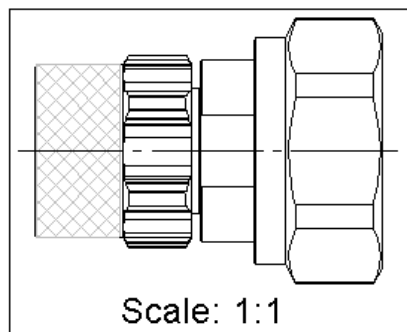
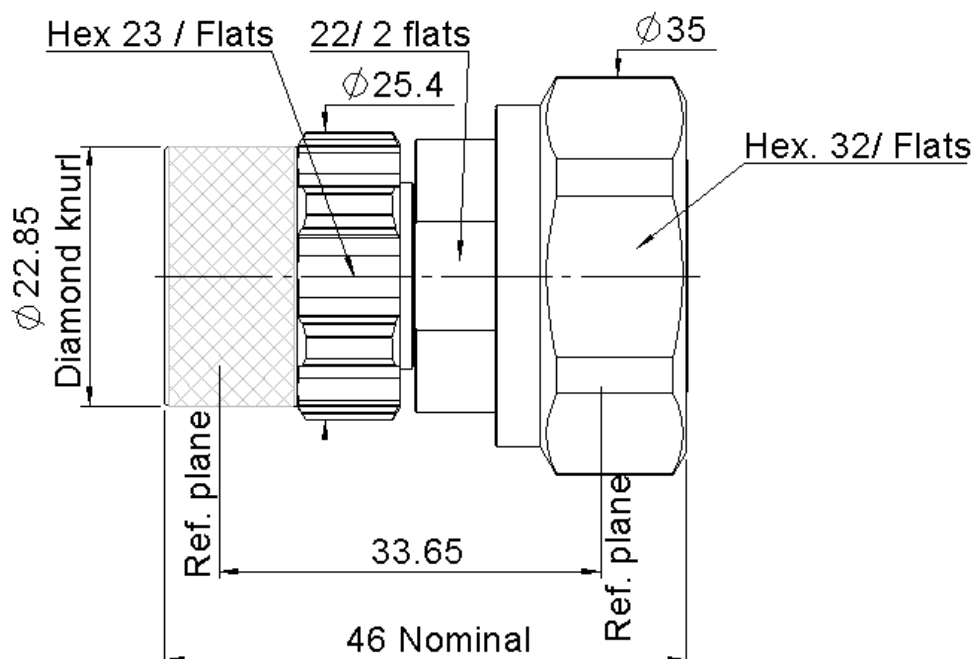
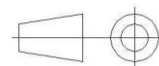

COMPONENTS	MATERIALS	PLATING ( $\mu\text{m}$ )
Body	<b>BRASS</b>	<b>BBR</b>
Center contact	<b>BRONZE</b>	<b>SILVER</b>
Outer contact	<b>BRASS</b>	<b>BBR</b>
Insulator	<b>PTFE</b>	
Gasket	<b>SILICONE RUBBER</b>	
Others parts	<b>BRASS</b>	<b>BBR</b>
-	-	-
-	-	-

PAGE <b>2/2</b>	ISSUE <b>1416C</b>	SERIES <b>ADAPTER</b>	PART NUMBER <b>R191663000</b>
-----------------	--------------------	--------------------------	-------------------------------

## PACKAGING

Standard	Unit	Other
<b>1</b>		<b>Contact us</b>

## ELECTRICAL CHARACTERISTICS

Impedance		<b>50</b>	$\Omega$
Frequency		<b>0-6</b>	GHz
VSWR	<b>1.04</b>	<b>+</b>	<b>0.0200</b> x F(GHz) Maxi
Insertion loss			<b>0.05</b> $\sqrt{F}$ (GHz) dB Maxi
RF leakage		<b>- (</b>	<b>NA</b> - F(GHz)) dB Maxi
Voltage rating			<b>1400</b> Veff Maxi
Dielectric withstanding voltage			<b>2500</b> Veff mini
Insulation resistance			<b>5000</b> M $\Omega$ mini

## MECHANICAL CHARACTERISTICS

Center contact retention			
Axial force – Mating End		<b>50</b>	N mini
Axial force – Opposite end		<b>200</b>	N mini
Torque		<b>NA</b>	N.cm mini
Recommended torque			
Mating	<b>QLI</b>	<b>0</b>	N.cm
	<b>7/16</b>	<b>3000</b>	N.cm
		<b>0</b>	N.cm
Panel nut		<b>NA</b>	N.cm
Mating life		<b>100</b>	Cycles mini
Weight		<b>128.4870</b>	g

## ENVIRONMENTAL

Operating	<b>-55~+120</b>	°C
Hermetic seal	<b>NA</b>	Atm.cm3/s
Panel leakage	<b>NA</b>	

## SPECIFICATION

## OTHER CHARACTERISTICS

**IMP3<-120dBm under 2 carriers of +43dBm**  
**IP67 mated condition**

# Mouser Electronics

Authorized Distributor

Click to View Pricing, Inventory, Delivery & Lifecycle Information:

Radial:

[R191663000](#)