

## M8-Receptacle Connectors In Accordance With IEC 61076-2-104

### RSMEDG | RSMEDGN



#### Male, 8-Pole

Receptacle connector, M8 male connector for sensors, with combined snap-in/threaded joint, mounting hole for LED, short solder contacts, hollow contacts on solder side.

#### RSMEDG

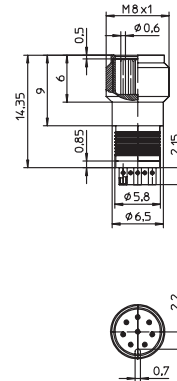

#### Male, 3 and 4-Pole

Receptacle connector, M8 male connector for sensors, with housing of stainless steel, threaded joint, 4 light indicator windows, mounting hole for LED, short solder contacts, hollow contact on solder side.

#### RSMEDGN

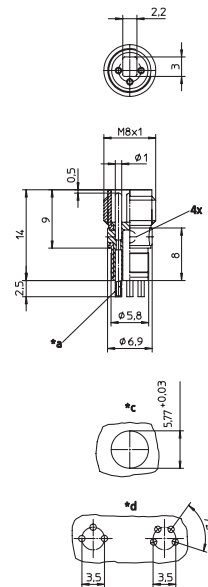

### Pin Assignments

#### Face Views

#### M8 - 3 and 4 poles

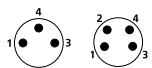

#### M8 - 8 poles



\*a hollow  
\*c cut out  
\*d hole pattern in printed circuit board



**M8-Receptacle Connectors In Accordance With IEC 61076-2-104**  
RSMEDG | RSMEDGN

**Technical Data**

<b>Environmental</b>	
Degree of protection	IP 67 / NEMA 6P
Operating temperature range	-25°C (-13°F) / +80°C (+176°F)

<b>Mechanical</b>	
Housing / Molded body	CuZn, nickel-plated
Insert	PA
Contact	CuZn, pre-nickel- and 0.8 microns gold-plated
Mode of connection	solder connection
Connectable conductor	max. 0.14 mm <sup>2</sup>

<b>Electrical</b>	
Contact resistance	≤ 5 mΩ
Nominal current at 40°C	1.5 A
Nominal voltage	30 V
Test voltage	0.5 kV eff. / 60 s
Insulation resistance	> 10 <sup>9</sup> Ω
Pollution degree	3

Part Number	Pins	Contact (soldering side)	Characteristics
RSMEDGN 3	3		
RSMEDGN 4	4		
RSMEDG 8	8	hollow contact	

# Mouser Electronics

Authorized Distributor

Click to View Pricing, Inventory, Delivery & Lifecycle Information:

[Lumberg Automation:](#)

[RSMEDGN 3](#) [RSMEDGN 4](#) [RSMEDG 8](#)