

RKT | RKWT

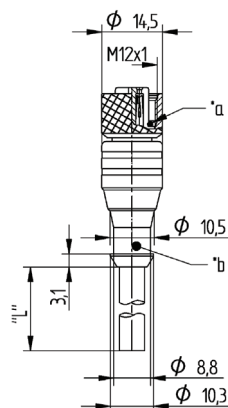

Actuator/sensor cordset, single-ended, M12, 4-poles, female straight connector with threaded joint and molded cable, connecting to knurled screw.

RKT

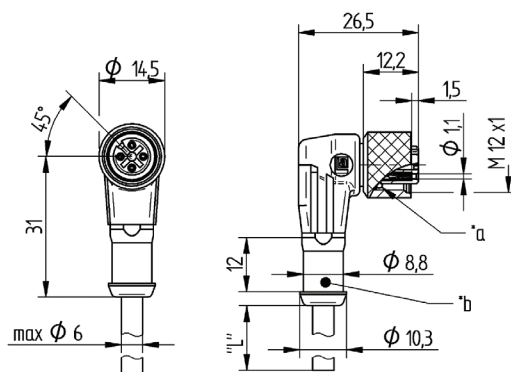

Actuator/sensor cordset, single-ended, M12, 4-poles, female 90° connector with threaded joint and molded cable, connecting to knurled screw.

RKWT

M12 - Male

4 poles

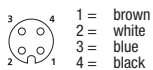

Be Certain with Belden

**Cordsets
Single-Ended**



M12-Round-Plug Connector, Single-Ended Cordsets, According to IEC 61076-2-101 for Robotic Applications RKT | RKWT

Technical Data

Environmental

Degree of protection (IEC 60529)* IP67, IP68 (15m / 48h & 100m / 2h)
Operating temperature range -40°C to +85°C

Mechanical

Housing / Molded body TPU - translucent
Insert (contact bearer) TPU, orange
Contact CuSn
Contact surface Cu/Au
Knurled nut CuZn, nickel-plated
O-ring FKM

Electrical

Rated voltage 250V AC/DC
Rated current* 4 A



Additional technical data

Fastening torque (coupling nut) M 12x1: (40-60) Ncm, hand-tight

Cable Specifications

Cable No.	Outer Jacket	Conductor Size	Jacket Color	OD
500	PUR	22 AWG stranded	black	5.10 mm nominal

**Cordsets
Single-Ended**

Part Number		Pins	Outer Jacket	Standard Cable Lengths	Characteristics
Male Straight	Male 90°				
RKT 4-500/...M	RKWT 4-500/...M	4	PUR	2 M / 5 M / 10 M / 15 M / 20 M	  

Mouser Electronics

Authorized Distributor

Click to View Pricing, Inventory, Delivery & Lifecycle Information:

[Lumberg Automation:](#)

[RKT 4-500/10 M](#) [RKT 4-500/15 M](#) [RKT 4-500/2 M](#) [RKT 4-500/20 M](#) [RKT 4-500/5 M](#)