

## M8-Round-Plug Connector, Single-Ended Cordsets, According to IEC 61976-2-104

RKMW/LED



### 3-Poles (LED)

Actuator/sensor cordset, single-ended, M8, 3-poles, female 90° connector with LED operation and function indicator, with snap-in joint and molded cable.

RKMW/LED

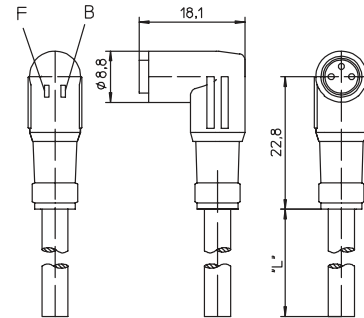

### Pin Assignments

M8

3 poles

1 = brown  
3 = blue  
4 = black

### Wiring Diagram

A pnp Normally open = yellow-green

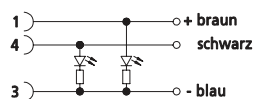

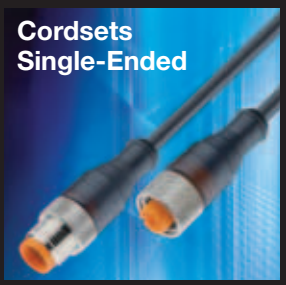

Be Certain with Belden

## M8-Round-Plug Connector, Single-Ended Cordsets, According to IEC 61976-2-104 RKMW/LED 3

### Technical Data

#### Environmental

Degree of protection	IP 65
Operating temperature range	-40°C (-40°F) / +90°C (+194°F)

#### Mechanical





Housing / Molded body	TPU
Insert	PA / TPU
Contact	CuZn, pre-nickel-coated and 0.8 microns gold-plated
Coupling nut	CuZn, nickel-plated

#### Electrical data

Contact resistance	≤ 5 mΩ
Nominal current at 40°C	4 A
Nominal voltage	10-30 V DC
Insulation resistance	> 10 <sup>9</sup> Ω
Pollution degree	3

### Cable Specifications

Cable No.	Outer Jacket	Conductor Size	Jacket Color	OD
<b>06</b>	<b>PVC</b>	3 x 0.34 mm <sup>2</sup>	Orange	.197" (5.0 mm)
<b>224</b>	<b>PUR, halogen-free</b>	3 x 0.34 mm <sup>2</sup>	Black	.169" (4.3 mm)

Part Number	Pins	Outer Jacket	Standard Cable Lengths	Characteristics
RKMW/LED A 3-06/...M	<b>3</b>		2 M / 5 M / 10 M	
RKMW/LED A 3-224/...M			2 M / 5 M / 10 M	  

# Mouser Electronics

Authorized Distributor

Click to View Pricing, Inventory, Delivery & Lifecycle Information:

[Lumberg Automation:](#)

[RKMW/LED A 3-06/5 M](#) [RKMW/LED A 3-224/5 M](#)