

M12-Receptacle Connectors In Accordance With IEC 61076-2-101

PRSFM/0.5 M | PRKFM/0.5 M



Male, 4-, 5- and 8-Pole

M12 Receptacle connector, M12 male connector for front mounting, housing of stainless steel, assembled stranded wire, solder contacts potted with epoxy, chassis side thread M16 x 1.5 (panel nut RSKFM 16)

– especially designed for use in food processing equipment –

PRSFM/0.5 M

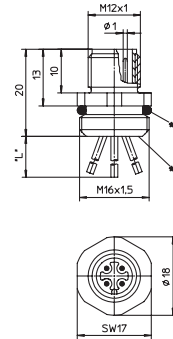

*a O-ring enclosed separately
*b solder contacts potted with epoxy
*L*0.5 m



Female, 4-, 5- and 8-Pole

M12 Receptacle connector, M12 female connector for front mounting, housing of stainless steel, assembled stranded wire, solder contacts potted with epoxy, chassis side thread M16 x 1.5 (panel nut RSKFM 16)

– especially designed for use in food processing equipment –

PRKFM/0.5 M

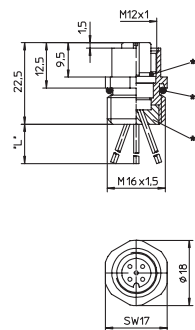

*a O-Ring
*b O-ring enclosed separately
*c solder contacts potted with epoxy
*L*0.5 m

Pin Assignments

Face Views / M12, Male / Female

4 pole

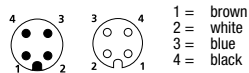

5 pole

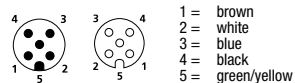

8 pole

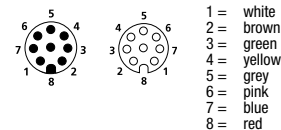



Be Certain with Belden

M12-Receptacle Connectors In Accordance With IEC 61076-2-101

PRSFM/0.5 M | PRKFM/0.5 M

Technical Data

Environmental







Degree of protection IP 67 / NEMA 6P
Operating temperature range -25°C (-13°F) / +70°C (+158°F)

Mechanical

Housing / Molded body stainless steel
Insert PBT
Contact CuZn, pre-nickel and 0.8 microns gold-plated
O-ring EPDM

Electrical

Contact resistance $\leq 5 \text{ m}\Omega$
Nominal current at 40°C
4–5 poles 4 A
8 poles 2 A
Nominal voltage
4 poles 240 V
5 poles 60 V
8 poles 30 V
Rated voltage
4 poles 250 V
5 poles 63 V
8 poles 36 V
Test voltage
4 poles 2.0 kV eff. / 60 s
5–8 poles 1.5 kV eff. / 60 s
Insulation resistance $> 10^9 \Omega$
Pollution degree 3

Part Number		Pins	Lead (mm ²)	Characteristics
PRSFM 4/0,5 M	PRKFM 4/0,5 M	4	0.34 (22 AWG)	 
PRSFM 5/0,5 M	PRKFM 5/0,5 M	5	1 x 0.5 / 4 x AWG 22	 
PRSFM 8/0,5 M	PRKFM 8/0,5 M	8	0.22 (24 AWG)	 

Mouser Electronics

Authorized Distributor

Click to View Pricing, Inventory, Delivery & Lifecycle Information:

[Lumberg Automation:](#)

[PRSFM 4](#) [PRSFM 5](#)