

M8-Receptacle Connectors In Accordance With IEC 61076-2-104

RSME | RSMEK | RSMEK...L



Male, 3- and 4-Pole

Receptacle connector, M8 male connector for sensors, with long solder contacts, solid contacts on solder side.

RSME

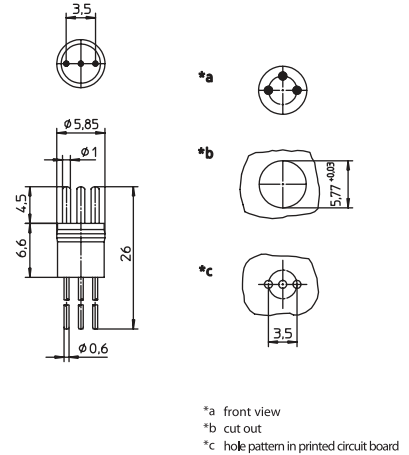

Male, 3- and 4-Pole

Receptacle connector, M8 male connector for sensors, with short solder contacts, solid contacts on solder side, RSMEK...L: with ventilation hole 1.1 mm Ø.

RSMEK | RSMEK...L

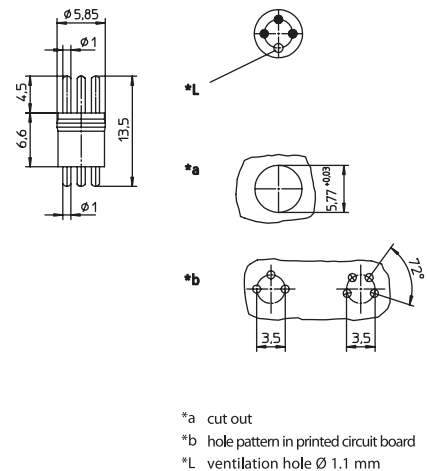

Pin Assignments

Face Views

M8 - 3 and 4 poles

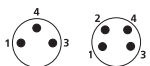



M8-Receptacle Connectors In Accordance With IEC 61076-2-104
RSME | RSMEK | RSMEK...L

Technical Data

Environmental



Degree of protection IP 67 / NEMA 6P
Operating temperature range -25°C (-13°F) / +80°C (+176°F)

Mechanical

Insert PA
Contact CuZn, pre-nickel and 0.8 microns gold-plated

Electrical

Contact resistance $\leq 5 \text{ m}\Omega$
Nominal current at 40°C 4 A
Nominal voltage 60 V
Rated voltage 63 V
Test voltage 1.5 kV eff. / 60 s
Insulation resistance $> 10^9 \Omega$
Pollution degree 3

Part Number	Pins	Ventilation hole	Contact (soldering side)	Characteristics
RSME 3	3		solid contact	
RSMEK 3L		1.1 mm Ø	solid contact	
RSMEK 4	4		solid contact	

Mouser Electronics

Authorized Distributor

Click to View Pricing, Inventory, Delivery & Lifecycle Information:

[Lumberg Automation:](#)

[RSMEK 4](#)