

M12-Receptacle Connectors In Accordance With IEC 61076-2-101

FWD 5 | FWD 5B



Male, 5-Pole

Receptacle connector, combined FIXCON/M12 male connector to combined FIXCON/M12 female connector.

– especially designed for use as panel feed through –

FWD 5 | FWD 5B

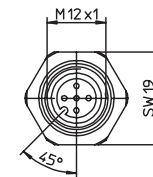
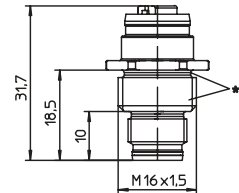
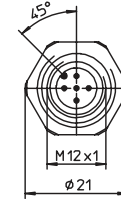

Pin Assignments

Face Views / M12

Male Connector : 5 poles



Female Connector: 5 poles



Male Connector: 5 poles B Coding



Female Connector: 5 poles B Coding





M12-Receptacle Connectors In Accordance With IEC 61076-2-101
FWD 5 | FWD 5B

Technical Data

Environmental

Degree of protection IP 67 / NEMA 6P
Operating temperature range -25°C (-13°F) / +80°C (+176°F)

Mechanical

Housing / Molded body CuZn, nickel-plated
Insert Male connector PA 6.6
Insert Female connector TPU, self-extinguishing
Contact CuZn, pre-nickel and 0.8 microns gold-plated
O-ring FKM

Electrical

Contact resistance $\leq 5 \text{ m}\Omega$
Nominal current at 40°C 4 A
Nominal voltage 60 V
Test voltage 1.5 kV eff. / 60 s
Insulation resistance $> 10^9 \Omega$
Pollution degree 3

Part Number	Pins	Characteristics
FWD 5	5	
FWD 5B	5B	

Mouser Electronics

Authorized Distributor

Click to View Pricing, Inventory, Delivery & Lifecycle Information:

[Lumberg Automation:](#)

[FWD 5](#) [FWD 5B](#)