



0911 ANC 101



AS-Interface Junction Branches

AS-Interface branch to connect AS-Interface slaves via a M12 connector with a flat cable system.

Technical Data

Environmental	
Degree of protection	IP 65
Housing material	PA
Nominal current at 40°C	4 A

Note

- insertion of the AS-Interface flat cable (yellow) in cable shaft "LINE1"
- insertion of the additional voltage supply (black flat cable) in cable shaft "LINE 2"

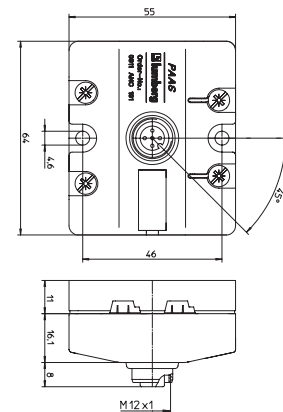

0911 ANC 401



AS-Interface branch to connect two flat cables (opening of an AS-Interface branch or additional voltage supply).

Technical Data

Environmental	
Degree of protection	IP 65
Housing material	PA
Nominal current at 40°C	8 A

Note

Please be aware that only two wires with the same function may be inserted into this AS-Interface branch. This means that either only the yellow or only the black AS-Interface flat cable may be used.

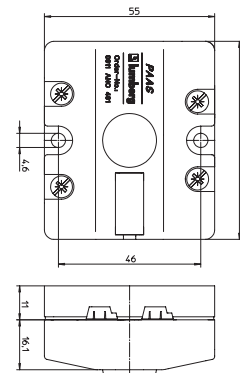

Pin Assignments

Cable	M12 - 5 Poles
1 = AS-Interface + brown	
2 = 0 V AUX white	
3 = AS-Interface - blue	
4 = +24 V AUX black	
5 = earth green/yellow	



1 = AS-Interface +
2 = 0 V AUX
3 = AS-Interface -
4 = +24 V AUX
5 = earth

Part Number

0911 ANC 101

0911 ANC 401



The application of these products in harsh environments should always be checked before use.
Specifications subject to alteration.

Mouser Electronics

Authorized Distributor

Click to View Pricing, Inventory, Delivery & Lifecycle Information:

[Lumberg Automation:](#)

[0911 ANC 401](#) [0911 ANC 101](#)