



AUTOMATION TRANSFORMERS - FLOOR MOUNT - NON-VENTILATED 15 KVA TO 150 KVA

SolaHD™ encapsulated transformers are rated for hazardous locations as well as harsh industrial environments. Encapsulation and rugged enclosures protect the transformer from dust, moisture, and provide extra shock and vibration resistance. SolaHD transformers fully comply with the latest edition of the National Electrical Code.

FEATURES

- cULus Listed for Class I, Division 2/Zone 2 hazardous locations temperature classification T3C or T3
- UL Listed/NEMA Type 1, 2, 3R, 4, and 12 encapsulated enclosure for indoor and outdoor service
- Electrostatically shielded for quality power
- UL Class 200 °C insulation system, 115 °C (40 °C Ambient) temperature rise under full load
- Gland plates standard for ease of conduit entry.
- Gland plates allow for easy cable entry into an enclosure while maintaining enclosure rating, providing easier installation and the ability to rewire or relocate existing equipment easily over the life of the transformer
- Available in ANSI gray painted cold roll steel for standard NEMA 1, 2 3R, 4/12 or stainless steel (4X) that offers the same or better corrosion resistance, and looks like our standard NEMA finish
- Copper terminations on all units
- Encapsulated with electrical grade silica and epoxy for industrial applications

RELATED PRODUCTS

- Some SolaHD DC power supplies are available with Class I, Division 2 ratings or encapsulation.
- Surge Protective Devices

CERTIFICATIONS AND COMPLIANCES

-  cULus Listed: E361435
 - UL 1561 or UL 5085-1, UL 5085-2
 - CSA C22.2 No. 47 or No. 66
 - RoHS Compliant

ACCESSORIES AND OPTIONAL DESIGN STYLES

- NEMA 4X Stainless Steel Enclosures
- 50 °C Ambient temperature and other temperature classifications (T4, T4A or T3B) available
- Additional configured transformer designs are available
- contact technical support (ex. copper, K-Factor and low temperature)
- Replacement gland plates (SGP) for moves, adds and rework are available

SOLAHD

For product information:
www.solahd.com
1.800.377.4384



CONSIDER IT SOLVED™

DESIGN STYLES

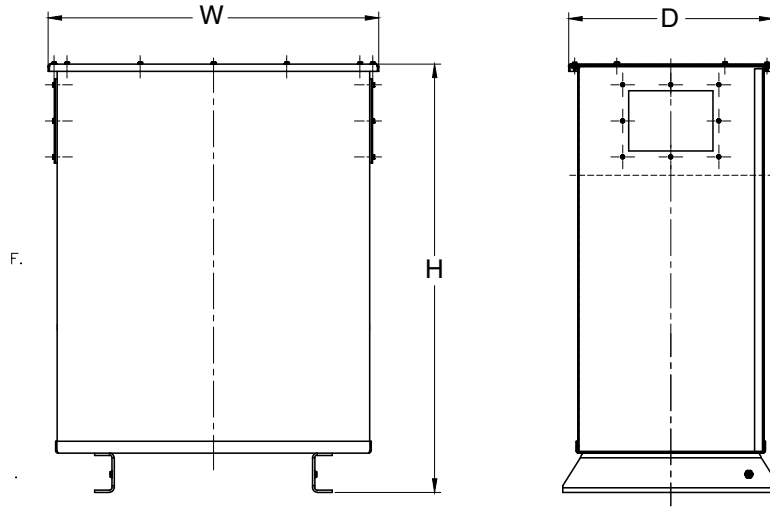

SELECTION TABLES: FLOOR MOUNT – THREE PHASE

kVA	Catalog Number Group I Rolled Steel	Height in (mm)	Width in (mm)	Depth in (mm)	Approx. Ship Weight lbs (kg)	Design Style ¹	Elec Conn ¹	Primary Amps	Secondary Amps
Group A: 480 Volt Δ Primary, 208Y/120 Secondary, 60 Hz									
15	F2F15S	24.34 (618.2)	17.45 (443.2)	12 (304.8)	300 (136)	6	34	18	41.6
30	F2F30S	33.53 (851.7)	26.36 (669.5)	14.2 (368.7)	730 (331)	6	34	36	83.3
45	F2F45BSCU	33.53 (851.7)	26.36 (669.5)	14.2 (368.7)	790 (358)	6	34	54.1	124.9
45	F2F45S	35.60 (904.24)	27.50 (698.5)	18.00 (457.2)	1400 (635)	6	34	54.1	124.9
75	F2F75SCU	35.60 (904.24)	27.50 (698.5)	18.00 (457.2)	1500 (680)	6	34	90.2	208.2
75	F2F75S	44.10 (1120.1)	31.51 (800.1)	18.00 (457.2)	1700 (771)	6	34	90.2	208.2
112.5	F2F112S	44.10 (1120.1)	31.51 (800.1)	18.00 (457.2)	1800 (816)	6	34	135.3	312.3
150	F2F150SCU	44.10 (1120.1)	31.51 (800.1)	18.00 (457.2)	2200 (998)	6	34	180.4	416.4
Group B: 480 Volt Δ Primary, 480Y/277 Secondary, 60 Hz									
15	F81F15S	24.34 (618.2)	17.45 (443.2)	12 (304.8)	300 (136)	6	35	18	18
30	F81F30S	33.53 (851.7)	26.36 (669.5)	14.2 (368.7)	730 (331)	6	35	36	36
45	F81F45BSCU	33.53 (851.7)	26.36 (669.5)	14.2 (368.7)	790 (358)	6	35	54.1	54.1
45	F81F45S	35.60 (904.24)	27.50 (698.5)	18.00 (457.2)	1400 (635)	6	35	54.1	54.1
75	F81F75SCU	35.60 (904.24)	27.50 (698.5)	18.00 (457.2)	1500 (680)	6	35	90.2	90.2
75	F81F75S	44.10 (1120.1)	31.51 (800.1)	18.00 (457.2)	1700 (771)	6	35	90.2	90.2
112.5	F81F112S	44.10 (1120.1)	31.51 (800.1)	18.00 (457.2)	1800 (816)	6	35	135.3	135.3
150	F81F150SCU	44.10 (1120.1)	31.51 (800.1)	18.00 (457.2)	2200 (998)	6	35	180.4	180.4

Notes:

Weights and dimensions may change and should not be used for construction purposes.

1. Design Styles and Electrical Connections can be found at the end of the Non-Ventilated Distribution Transformers section of the Solahd catalog.

SOLAHD

United States: 1.800.377.4384 | Asia/Pacific: + 65.6891.7600 | Australia: + 61.3.9721.0387
 Brazil: São Paulo/SP + 55.11.2122.5777 | Brazil: Camaçari/BA + 55.71.3496.4427 | Canada: + 1.888.765.2226
 China: + 86.21.3418.3888 | Europe: + 33.3.2254.1390 | Mexico/Latin America: + 52.55.5809.5049
 Middle East/Africa/India: + 971.4.811.8100
www.solahd.com

EMERSON

Mouser Electronics

Authorized Distributor

Click to View Pricing, Inventory, Delivery & Lifecycle Information:

[SolaHD:](#)

[F2F15S](#)