

A FULLY SCREENED ROBUST RANGE OF DIN CONNECTORS  
FOR USE IN INSTRUMENTATION AND AUDIO APPLICATIONS.  
AVAILABLE IN BLACK CHROME AND BRIGHT NICKEL.  
ROBUST CONSTRUCTION INCORPORATING  
CABLE GRIP AND STRAIN RELIEF.

MANUFACTURED TO DIN 41524, 45322, 45326, 45327 AND 45329.

## DIMENSIONS

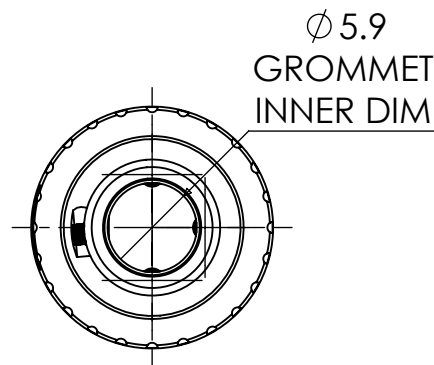
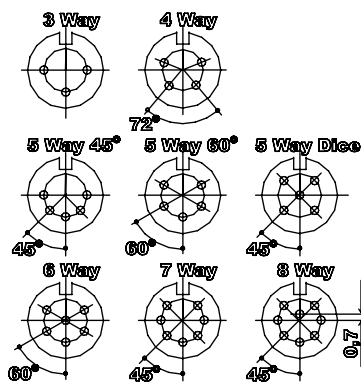
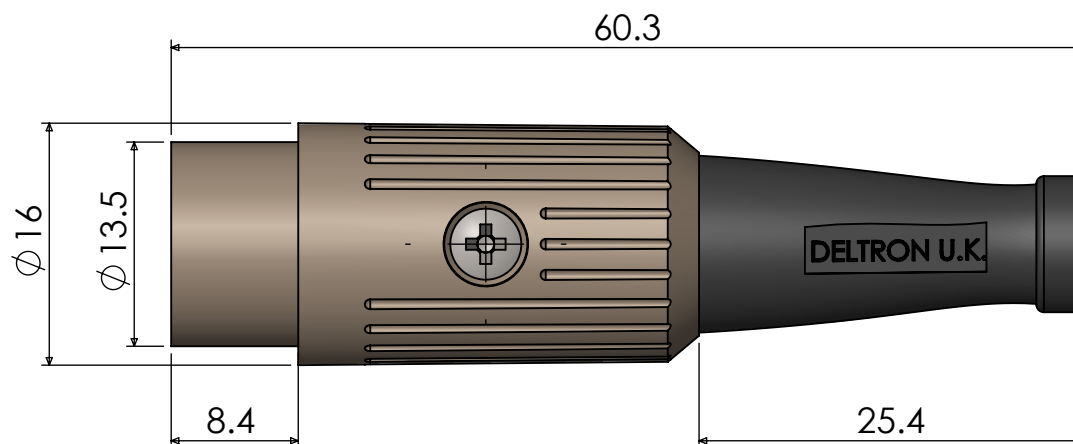

MATERIALS	
HOUSING	MAZAK
FINISH	BRIGHT NICKEL PLATE
	OR BLACK CHROME PLATE
MOULDING	NYLON
CONTACTS	BRASS BS2874 CZ121M, SILVER PLATED
CABLE CLAMP	MILD STEEL, SILVER PLATED
SCREW	MILD STEEL, NICKEL PLATED
GROMMET	PVC BLACK
ELECTRICAL	
RATED VOLTAGE	34 V AC or DC
CURRENT RATING	2 Amp
TEST VOLTAGE	500 V r.m.s
INSULATION RESISTANCE	103 MΩ MIN AT 100 V DC
CONTACT RESISTANCE	10 mΩ MAX
CAPACITANCE (MATED)	3pF
CLIMATIC	
CLIMATIC CATEGORY	25/070/21
TEMPERATURE RANGE	-25 °C TO +70 °C
DAMP HEAT, STEADY STATE	21 DAYS
RECOMMENDED WIRE SIZE	24-28AWG
CONDUCTOR SIZE	Ø 0.75mm - MAX
PIN SOLDER BUCKET SIZE	Ø 1mm +0.1mm/-0.0

TYPE	PART NUMBERS	
	NICKEL	BLACK
3 WAY	610-0300	611-0300
4 WAY	610-0400	611-0400
5 WAY 45°	610-0500	611-0500
5 WAY 60°	610-0510	611-0510
5 WAY	610-0520	611-0520
6 WAY	610-0600	611-0600
7 WAY	610-0700	611-0700
8 WAY	610-0800	611-0800

#### PROPRIETARY AND CONFIDENTIAL:

THE INFORMATION CONTAINED IN THIS DRAWING IS THE SOLE PROPERTY OF ALPHA 3 MANUFACTURING. ANY REPRODUCTION IN PART OR AS A WHOLE WITHOUT THE WRITTEN PERMISSION OF ALPHA 3 MANUFACTURING IS PROHIBITED.

DEM Manufacturing is a division of Alpha 3 Manufacturing LTD  
DEM Manufacturing, Deltron Emcon House, Hargreaves Way,  
Sawcliffe Ind. Park, Scunthorpe, North Lincolnshire, DN15 8RF, UK

UNLESS OTHERWISE SPECIFIED  
DIMENSIONS ARE IN MILLIMETRES  
LINEAR & RADIAL TOLERANCE:

**GENERAL SPECIFICATION  
ONLY**

#### IF IN DOUBT ASK! DO NOT SCALE DRAWING!

FINISH SEE NOTE

MATERIAL SEE NOTE

THE FINISHED PRODUCT SHOULD BE CLEAN AND FREE FROM ALL  
LIQUIDS AND DEBRIS. SURFACES SHOULD BE OF UNIFORM  
APPEARANCE FREE FROM SHARP EDGES, BURRS AND CORROSION

AUTHOR

SB

EDITOR

DT

APPROVER

DT

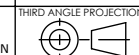

SHEET 1 OF 1

SCALE 1:1 A4

TITLE GENERAL SPECIFICATION

FILE 610 - 611 SERIES

PART DIN CONNECTORS

ISSUE/REV. 006

RELEASED

EDIT DATE 17/06/2021

RELEASE DATE 17/06/2021

# **PIN VARIATIONS USED IN: 590 / 591 / 592 / 600 / 601 / 610 / 611 - DIN PLUG CONNECTORS**

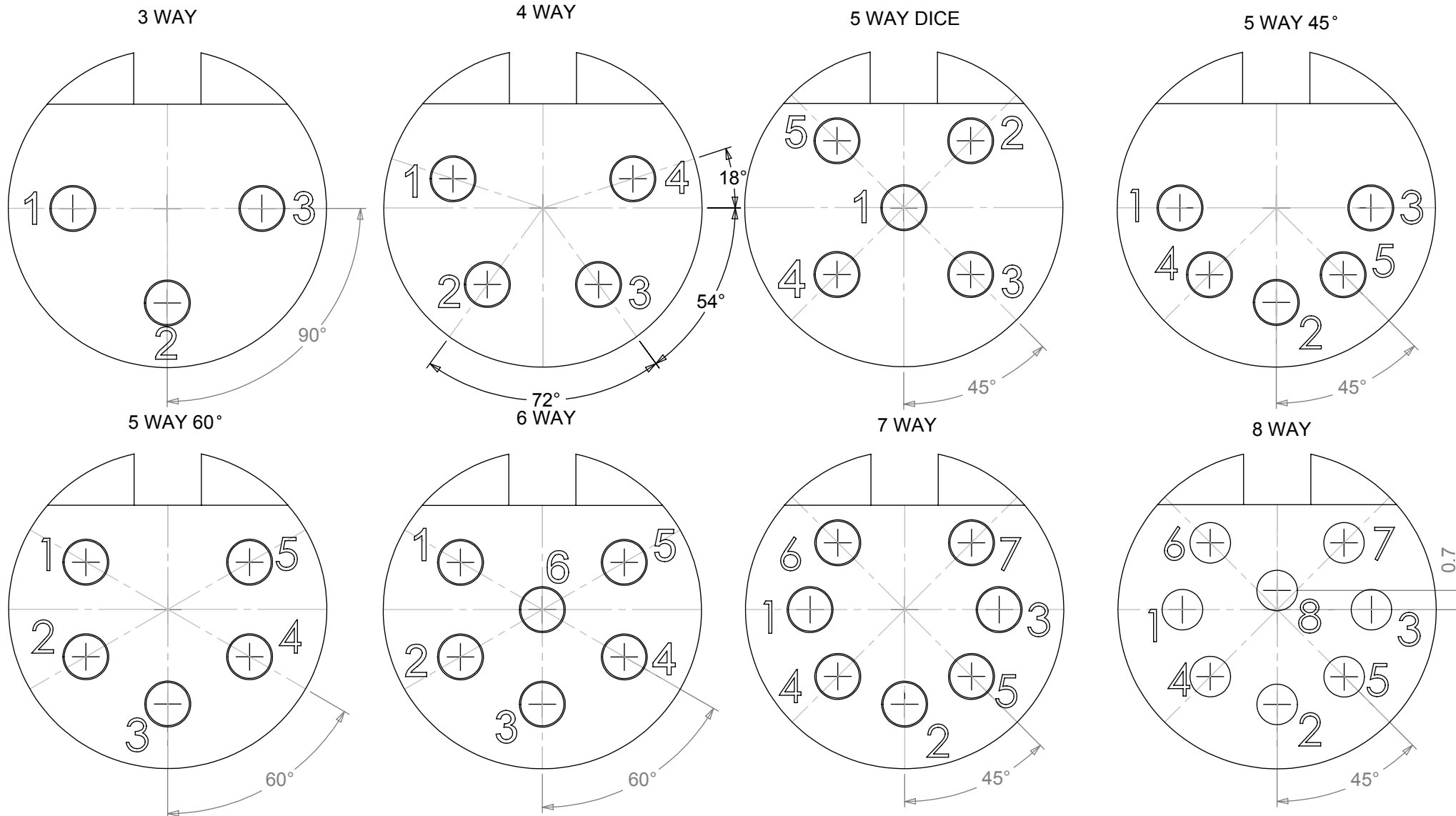

**MANUFACTURED TO DIN STANDARD 41524, 45322, 45326, 45327 AND 45329**

# Mouser Electronics

Authorized Distributor

Click to View Pricing, Inventory, Delivery & Lifecycle Information:

[Deltron:](#)

[611-0510](#)