

A FULLY SCREENED ROBUST RANGE OF DIN CONNECTORS  
FOR USE IN INSTRUMENTATION AND AUDIO APPLICATIONS.  
AVAILABLE IN BLACK CHROME AND BRIGHT NICKEL.  
ROBUST CONSTRUCTION INCORPORATING  
CABLE GRIP AND STRAIN RELIEF.

MANUFACTURED TO DIN 41524, 45322, 45326, 45327 AND 45329.

## DIMENSIONS

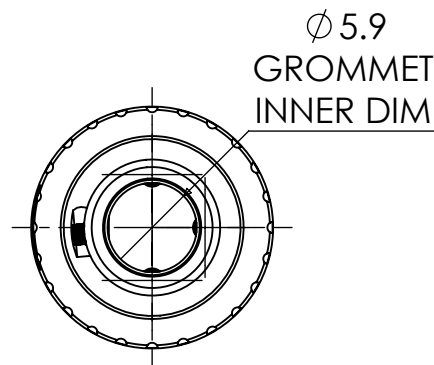
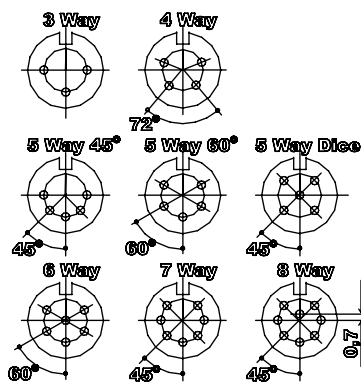
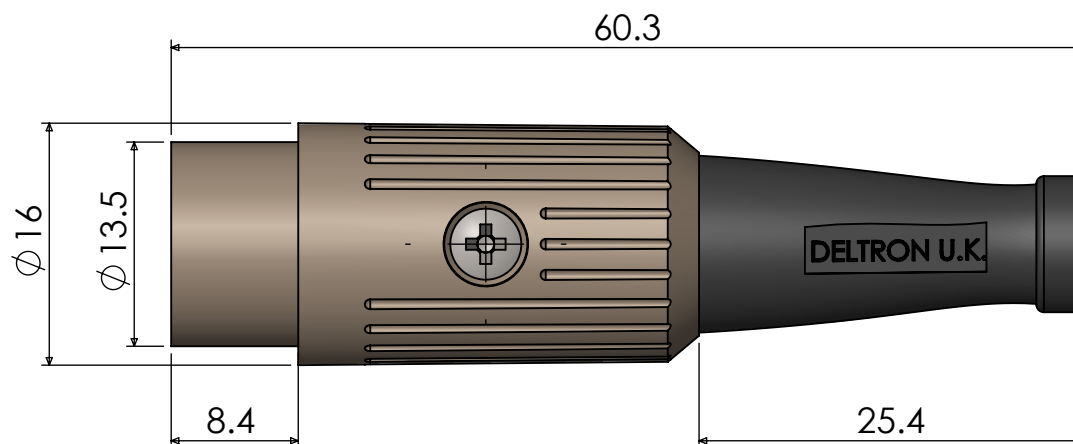

MATERIALS	
HOUSING	MAZAK
FINISH	BRIGHT NICKEL PLATE
	OR BLACK CHROME PLATE
MOULDING	NYLON
CONTACTS	BRASS BS2874 CZ121M, SILVER PLATED
CABLE CLAMP	MILD STEEL, SILVER PLATED
SCREW	MILD STEEL, NICKEL PLATED
GROMMET	PVC BLACK
ELECTRICAL	
RATED VOLTAGE	34 V AC or DC
CURRENT RATING	2 Amp
TEST VOLTAGE	500 V r.m.s
INSULATION RESISTANCE	103 MΩ MIN AT 100 V DC
CONTACT RESISTANCE	10 mΩ MAX
CAPACITANCE (MATED)	3pF
CLIMATIC	
CLIMATIC CATEGORY	25/070/21
TEMPERATURE RANGE	-25 °C TO +70 °C
DAMP HEAT, STEADY STATE	21 DAYS
RECOMMENDED WIRE SIZE	24-28AWG
CONDUCTOR SIZE	Ø 0.75mm - MAX
PIN SOLDER BUCKET SIZE	Ø 1mm +0.1mm/-0.0

TYPE	PART NUMBERS	
	NICKEL	BLACK
3 WAY	610-0300	611-0300
4 WAY	610-0400	611-0400
5 WAY 45°	610-0500	611-0500
5 WAY 60°	610-0510	611-0510
5 WAY	610-0520	611-0520
6 WAY	610-0600	611-0600
7 WAY	610-0700	611-0700
8 WAY	610-0800	611-0800

# **PIN VARIATIONS USED IN: 590 / 591 / 592 / 600 / 601 / 610 / 611 - DIN PLUG CONNECTORS**

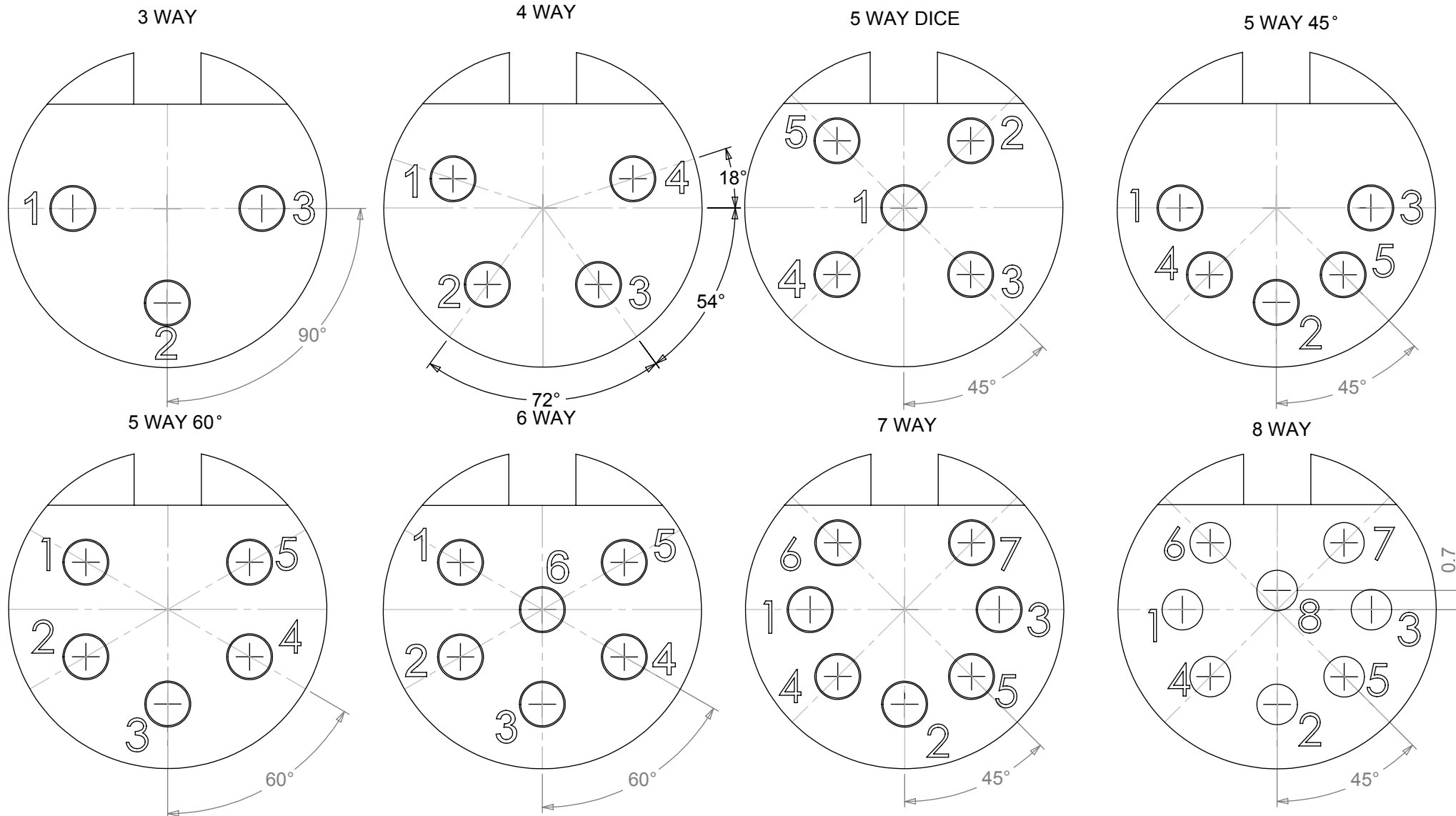

**MANUFACTURED TO DIN STANDARD 41524, 45322, 45326, 45327 AND 45329**

# Mouser Electronics

Authorized Distributor

Click to View Pricing, Inventory, Delivery & Lifecycle Information:

[Deltron:](#)

[611-0300](#)