

A non-insulated terminal binding post, manufactured from nickel plated brass, rated at 30 Amps, with a non-captive 2 BA nut. Can be used on a maximum of 12,5mm panel thickness.

## Dimensions

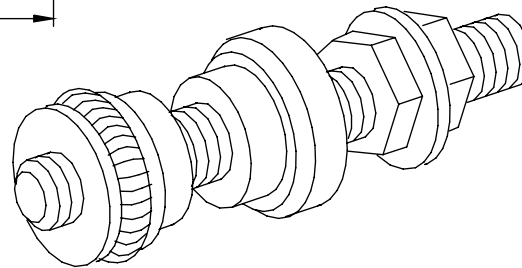
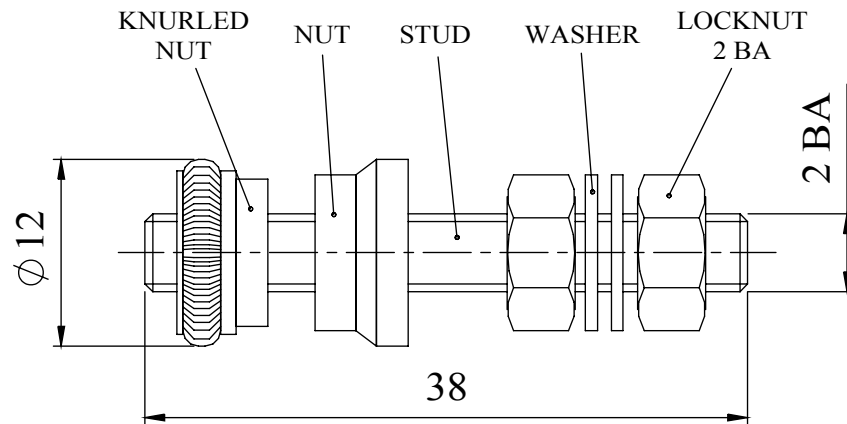

MATERIAL  
LOCKNUT

: Brass, bright nickel plate

WASHER  
STUD  
NUT  
KNURLED  
NUT

: Brass, bright nickel plate  
: Brass, bright nickel plate  
: Brass, bright nickel plate  
: Brass, bright nickel plate

Maximum  
Current  
Rating

: 30 Amps

Tel No. +44(0)1724 273200 Website [www.dem-uk.com](http://www.dem-uk.com)



PROPRIETARY AND CONFIDENTIAL  
THE INFORMATION CONTAINED IN THIS DRAWING IS THE SOLE PROPERTY OF  
ALPHA 3 MANUFACTURING.  
ANY REPRODUCTION IN PART OR AS A WHOLE WITHOUT THE WRITTEN PERMISSION OF  
ALPHA 3 MANUFACTURING IS PROHIBITED.

DEM Manufacturing, Deltron Emcon House  
Hargreaves Way, Sawcliffe Ind. Park,  
Scunthorpe, North Lincolnshire, DN15 8RF, UK

UNLESS OTHERWISE SPECIFIED:  
DIMENSIONS ARE IN MILLIMETRES  
LINEAR TOLERANCE:  
NO DECIMAL PLACES  $\pm 0.5\text{mm}$   
1 DECIMAL PLACE  $\pm 0.25\text{mm}$   
2 DECIMAL PLACES  $\pm 0.125\text{mm}$   
ANGULAR TOLERANCE:  $\pm 1^\circ$

FINISH TERMINAL  
BINDING POST  
-  
IF IN DOUBT ASK  
DO NOT SCALE DRAWING  
MATERIAL SEE NOTE

DEBURR AND BREAK  
SHARP EDGES  
DRAWN BY  
APPROVED BY  
THIRD ANGLE PROJECTION

SPB  
WC  
SHEET 1 OF 1  
SCALE 1:1  
A4

TITLE GENERAL SPECIFICATION  
FOR  
351-0000  
DRAWING NO. 351-0000  
ISSUE 02  
Release

# Mouser Electronics

Authorized Distributor

Click to View Pricing, Inventory, Delivery & Lifecycle Information:

[Deltron:](#)

[351-0000](#)