

THE INFORMATION CONTAINED IN THIS DRAWING IS THE SOLE PROPERTY OF YAMAICHI ELECTRONICS DEUTSCHLAND GmbH. ANY REPRODUCTION IN PART OR WHOLE WITHOUT THE WRITTEN PERMISSION OF YAMAICHI ELECTRONICS DEUTSCHLAND GmbH IS PROHIBITED.

Assembly before crimping

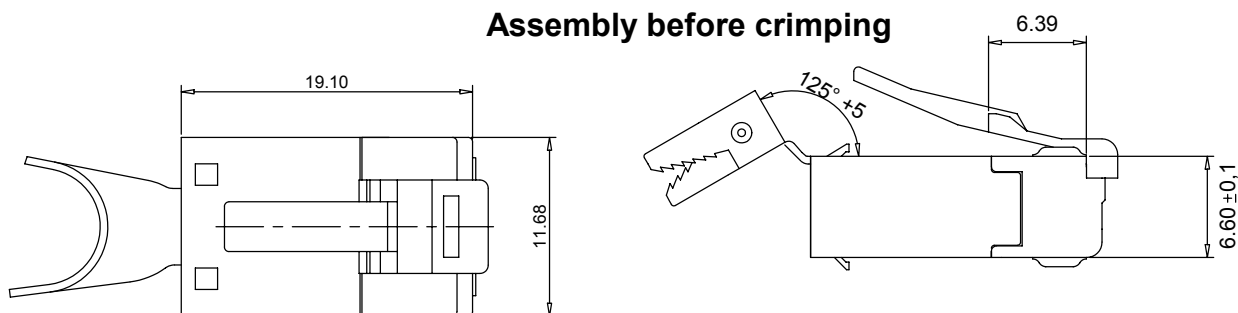

Contacts for stranded wire

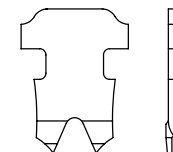

Assembly after crimping

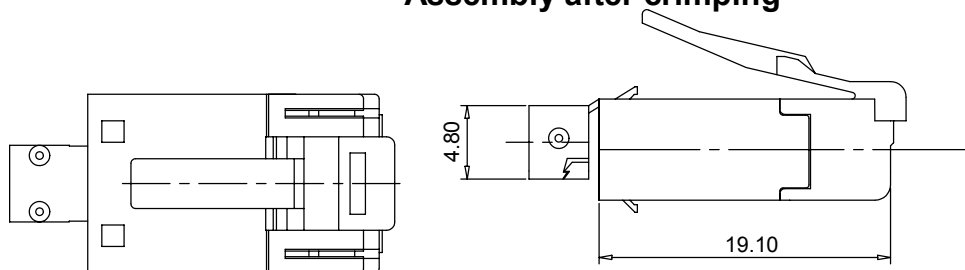

5:1 (without contact)

INSERT

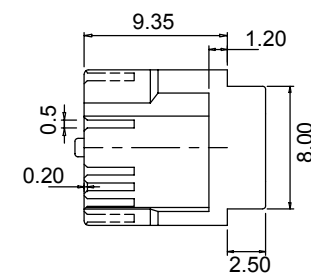

Shield

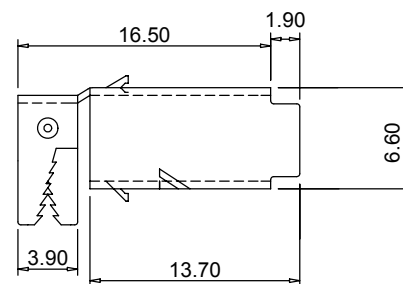

Material :
Housing material : PBT
Durability : 2000 mating cycles
Contact blade : phosphor Bronze
High strenght copper alloy
100 microinches nickel under plated &
gold selected 30 microinches

Shield after round crimping

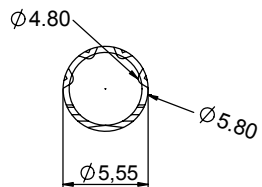

After square crimping

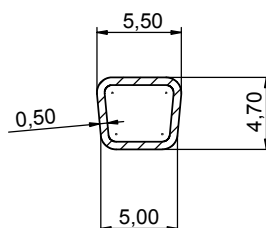

UNLESS OTHERWISE SPECIFIED:
DIMENSIONS ARE IN MILLIMETERS
TOLERANCES: ±0.3

REV.	REVISION DESCRIPTION	INITIALS	REV. DATE
5			
4			
3			
2			
1			



NOTES:

DO NOT SCALE DRAWING	NAME	DATE
DESIGN		
DRAWN		
CHECKED		
Q.A.		
APPROVED		

CLASSIFICATION:	TITLE:	DWG NO.:	REV. ORIGIN	REV.
Customer-drawing	Y-CON Plug-11 / 8(4) Ethernet RJ45plus without power contacts	Customer-P(090)A12	-	-

Mouser Electronics

Authorized Distributor

Click to View Pricing, Inventory, Delivery & Lifecycle Information:

[Yamaichi Electronics:](#)

[Y-ConPlug-11](#) [Y-CONAS-11](#)