

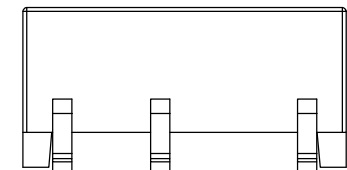

NOTES:

1. ROHS COMPLIANT
2. STORAGE TEMPERATURE: -50°C TO +150°C
3. COMPLIANCE TO J-STD:
 - A. J-STD-002: SOLDERABILITY AT 245°C REFLOW PROFILE
 - B. J-STD-020: LEVEL 1, NO MOISTURE SENSITIVE
 - C. J-STD-075: R7, 245°C MAXIMUM THROUGH REFLOW SOLDER
4. TO ORDER TAPE & REEL PACKAGING ADD A "T" SUFFIX
TO THE PART NUMBER(i.e HXXXXXXNL BECOMES HXXXXXXNLT).

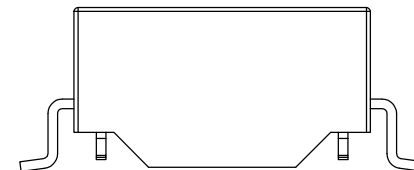
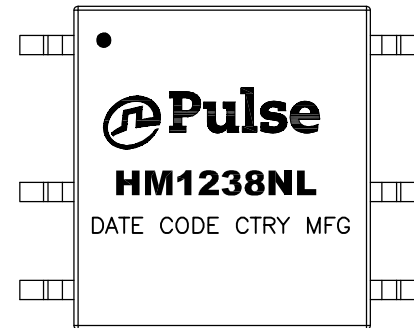

FINAL OUTLINE

© Copyright, 2017. Pulse Electronics Corp. All rights reserved. Pulse confidential & proprietary. (08/10/17)

PRODUCT DESCRIPTION	TLA DRAWING	PS DRAWING	SHEET	PART NO.	DATASHEET REV.
TRANSFORMER/CMC,4.3KVDC ISO,SGL,SM	HM1238NL-P1	PS-XXXX	1 OF 3	HM1238NL	D

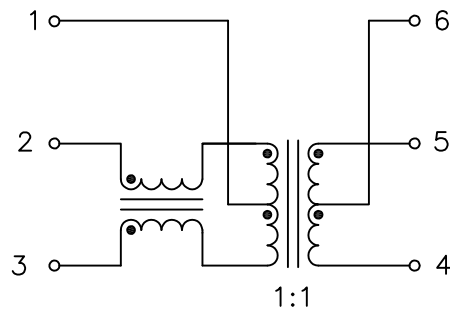

SCHEMATIC

ELECTRICAL CHARACTERISTICS AT +25°C UNLESS OTHERWISE SPECIFIED
(FOR REFERENCE ONLY. USED FOR CUSTOMER INFORMATION.)

PARAMETER	SPECIFICATIONS
QUALIFICATION	AEC-Q200 (PENDING)
OPERATING TEMP	-40°C TO +150°C
URNS RATIO	1 : 1 ±2%
POLARITY	PER SCHEMATIC
* LL	AT 100 KHz, 1 VRMS (2-3) = 0.5 uH MAXIMUM, SHORT (6-4-5)
INDUCTANCE (OCL) AT 100 kHz, 100 mV (-40°C TO +125°C)	300 uH MIN
DCR	(1-3) = (1-2) = 0.5 OHMS MAX
	(4-6) = (5-6) = 0.4 OHMS MAX
*INPUT - OUTPUT ISOLATION	4300 VDC FOR 60 SECONDS
WORKING VOLTAGE	1000 VDC

NOTE: "*" IS SPECIAL CHARACTERISTIC.

PRODUCT DESCRIPTION	TLA DRAWING	PS DRAWING	SHEET	PART NO.	DATASHEET REV.
TRANSFORMER/CMC,4.3KVDC ISO,SGL,SM	HM1238NL-P1	PS-XXXX	2 OF 3	HM1238NL	D

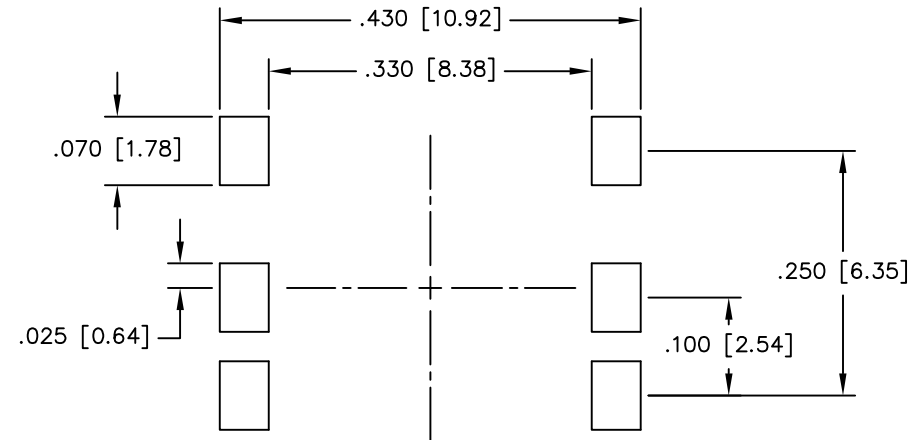
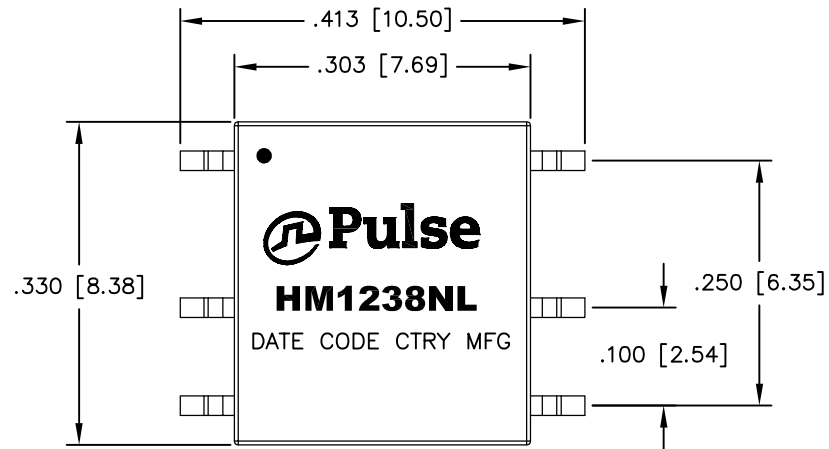

SUGGESTED LAND PATTERN

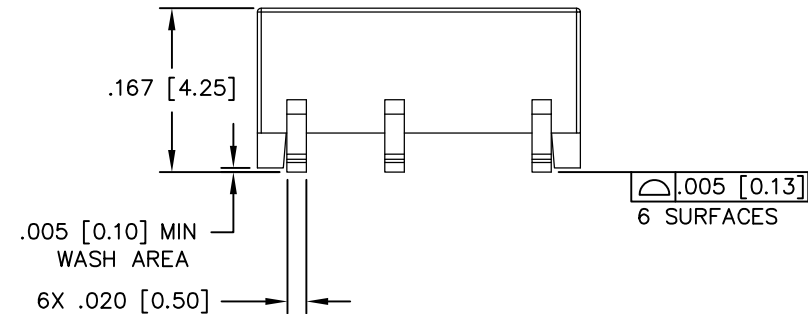
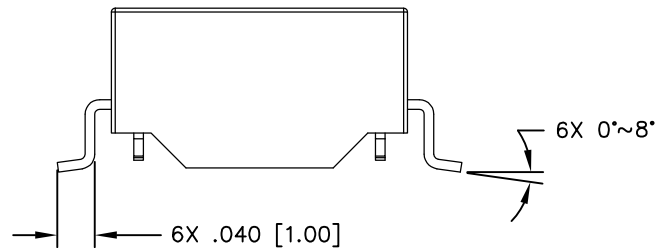

DIMENSIONS ARE IN INCHES [MILLIMETERS] WITH THE FOLLOWING TOLERANCES: [MILLIMETERS] ARE FOR REFERENCE ONLY.
.XX= ± 0.01 [± 0.25]
.XXX= ± 0.005 [± 0.13]

© Copyright, 2017. Pulse Electronics Corp. All rights reserved. Pulse confidential & proprietary. (08/10/17)

PRODUCT DESCRIPTION	TLA DRAWING	PS DRAWING	SHEET	PART NO.	DATASHEET REV.
TRANSFORMER/CMC,4.3KVDC ISO,SGL,SM	HM1238NL-P1	PS-XXXX	3 OF 3	HM1238NL	D

Mouser Electronics

Authorized Distributor

Click to View Pricing, Inventory, Delivery & Lifecycle Information:

Pulse:

[HM1238NL](#) [HM1238NLT](#)