



Feature :

Multiple keys and poles
Interlock and individual lock

Application :

Various switching purpose
Home electronic equipments
Industrial equipments

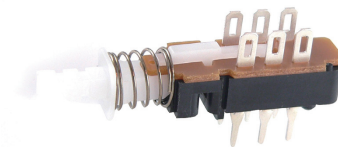

SWITCH SPECIFICATIONS

POLE - POSITION	2P2T, 4P2T, 6P2T, 8P2T, 10P2T, 16P2T, Momentary and Lock Type Available
CONTACT RATING	25 V DC , 1 A ; 125 V AC , 0.2 A
CONTACT RESISTANCE	40 mΩ MAX. 1.5 V DC ; 100 mA , by Method of Voltage DROP
INSULATION RESISTANCE	100 MΩ MIN. 500 V DC
DIELECTRIC STRENGTH	Breakdown is not Allowable ; 500 V AC for 1 Minute
OPERATING FORCE	2P2T , 4P2T , 6P2T : 350 ± 150gf ; 8P2T , 10P2T , 16P2T : 600 ± 150gf
OPERATING LIFE	10,000 cycles
OPERATING TEMPERATURE RANGE	-40°C ~ 85°C
OPERATING TRAVEL	2.0 ± 0.3 mm

► HOW TO ORDER

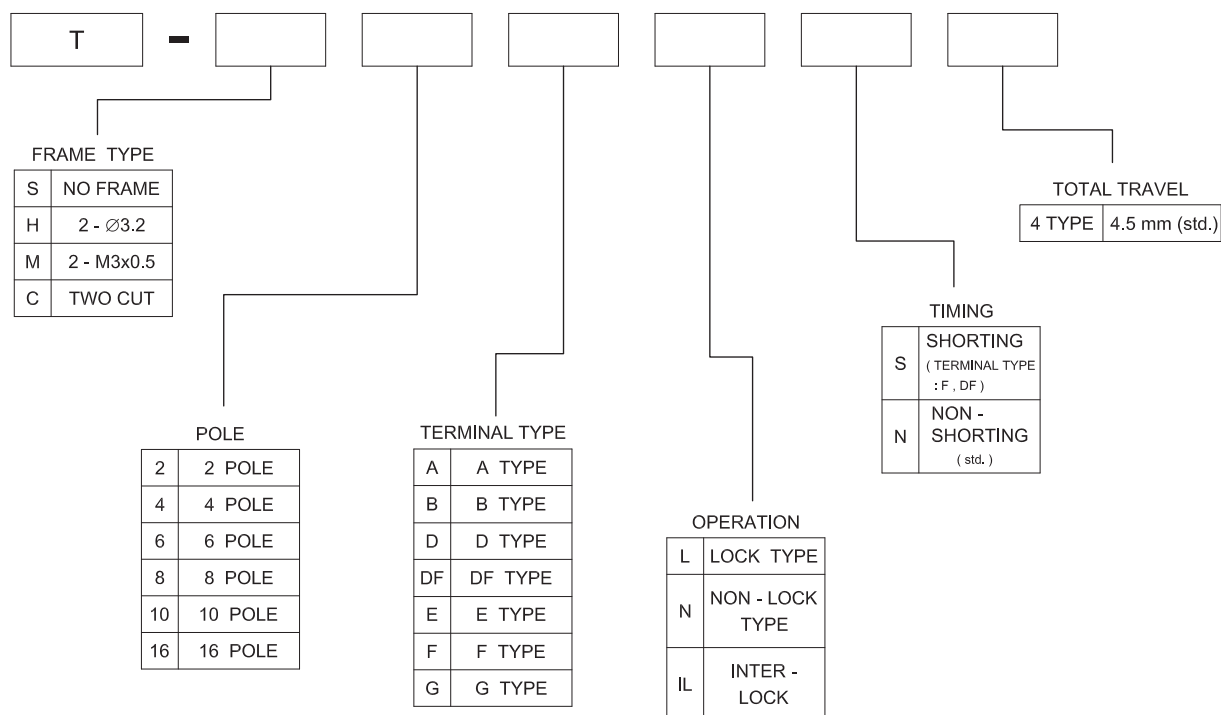

DIMENSION

T - S2ANN4

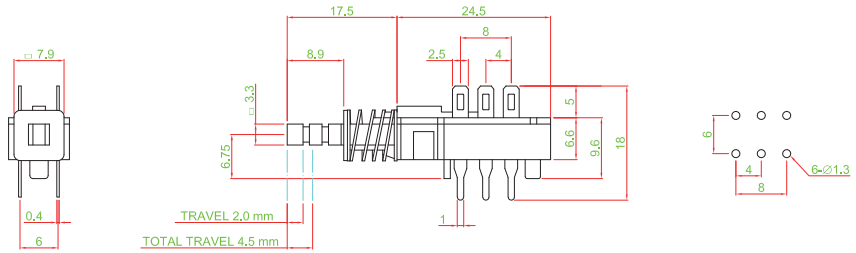
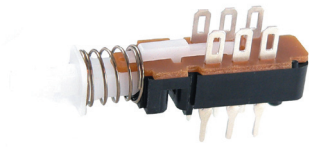

T - H2ALN4

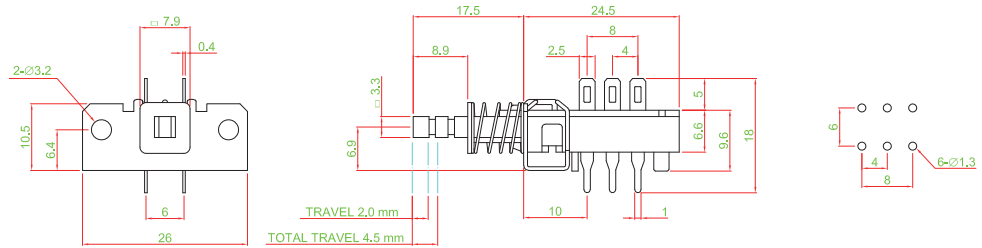
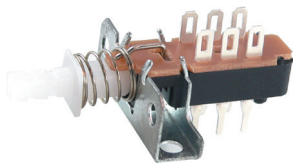

T - M2ANN4

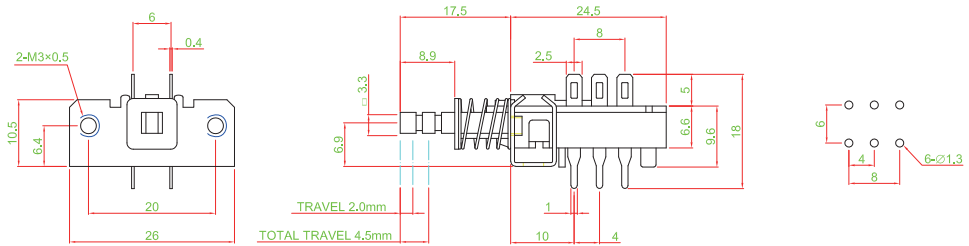
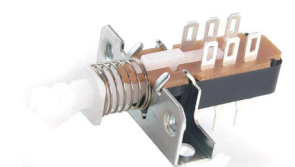

T-S4G/2ALN4

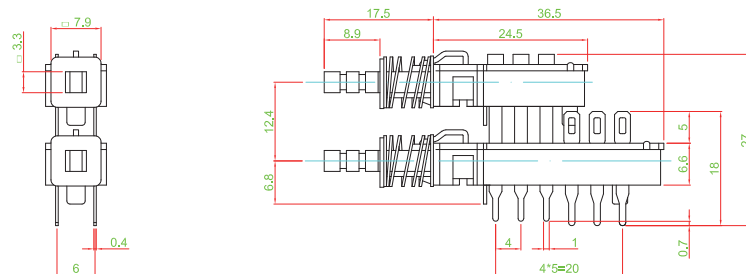
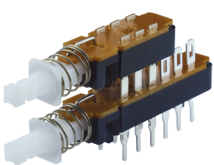

FRAME TYPE

S TYPE

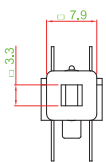

H TYPE

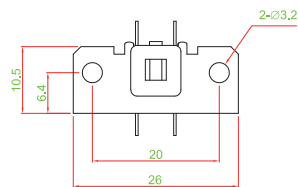

M TYPE

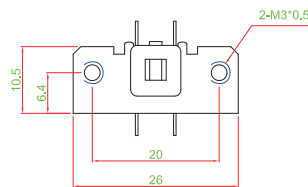

C TYPE

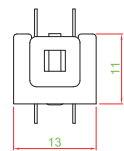

TERMINAL TYPE

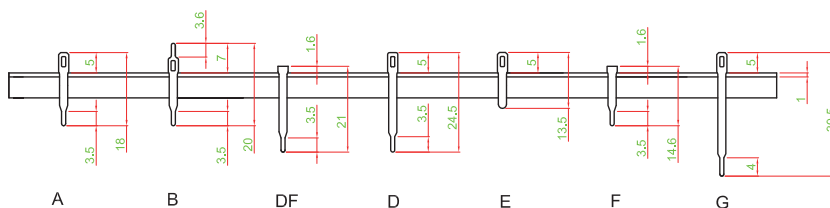



► CIRCUIT

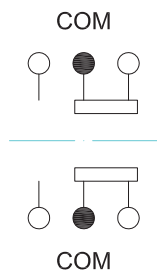

► POLE & LENGTH

POLE	2	4	6	8	10	16
L(mm)	24.5	36.5	48.5	60.5	72.5	108.5

► INTER-LOCK & LENGTH

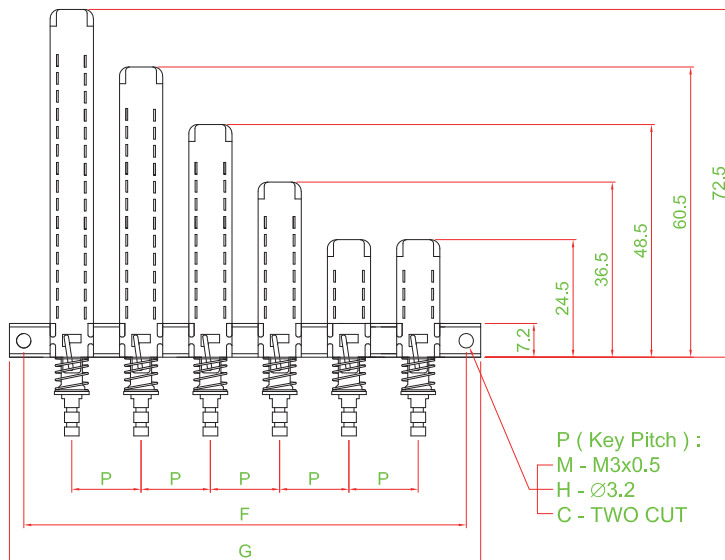
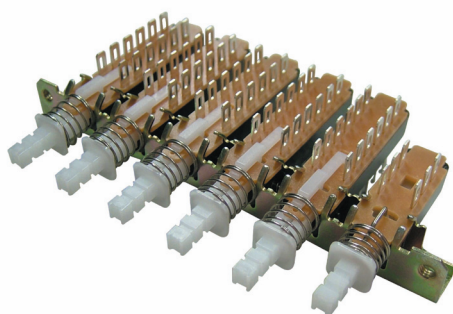

SIZE PITCH	G	F		G	F		G	F		G	F		G	F
10	26	20		46	40		66	60		86	80		106	100
12.5	24	18	3	51	45	5	76	70	7	101	95	9	126	120
15				56	50		86	80		116	110		146	140
17.5	F		F	61	55	F	96	90	F	131	125	F	166	160
20				66	60		106	100		146	140		186	180
10	36	30		56	50		76	70		96	90		116	110
12.5	38.5	32.5	4	63.5	57.5	6	88.5	82.5	8	113.5	107.5	10	138.5	132.5
15	41	35		71	65		101	95		131	125		161	155
17.5	F	37.5	F	78.5	72.5	F	113.5	107.5	F	148.5	142.5	F	183.5	177.5
20	46	40		86	80		126	120		166	160		206	200

► MULTI - KEY TYPE AND INTER - LOCK TYPE

FRAME TYPE M ☐ M3x0.5 H ☐ Ø3.2 C ☐ TWO CUT

KEY	1	2	3	4	5	6	7	8	9	10	11	12	13	14	15	16
OPTION / 選項																
POLE / 回路數																
TERMINAL TYPE / 端子																
OPERATING / 動作																
TIMING N / S																
TRAVEL / 行程																
KNOB																
PITCH / 間距	<input type="checkbox"/> 10mm <input type="checkbox"/> 12.5mm <input type="checkbox"/> 15mm <input type="checkbox"/> 17.5mm <input type="checkbox"/> 20mm <input type="checkbox"/> 25mm <input type="checkbox"/> 30mm															

Mouser Electronics

Authorized Distributor

Click to View Pricing, Inventory, Delivery & Lifecycle Information:

[Well Buying:](#)

[T-S2FLN4-18](#) [T-C4ALN4](#)