



Feature :

Approved by automotive brand after market
 Snap in push button switch
 Custom symbol and LED indicator available
 Wire and connector available

Application :

Consumer products
 Automotive



SWITCH SPECIFICATIONS

POLE - POSITION	OFF - <ON> for Momentary Type , SPST
CONTACT RATING	12V DC , 300 mA
CONTACT RESISTANCE	200 mΩ MAX.
INSULATION RESISTANCE	100 MΩ MIN. 500 V DC
DIELECTRIC STRENGTH	Breakdown is not Allowable ; 500 V AC for 1 Minute
OPERATING FORCE	350 ± 150gf
OPERATING LIFE	200,000 cycles
OPERATING TEMPERATURE RANGE	-25°C ~ 85°C
STORAGE TEMPERATURE RANGE	-40°C ~ 85°C
TOTAL TRAVEL	2.2 ± 0.3 mm

LED SPECIFICATIONS

ATTENTION LEDs are Electrostatic Sensitive devices  (+) — (-)	Unit	Value / LED Color						
		Blue	Pure Green	Red	Yellow	Orange	Green	White
LUMINOUS INTENSITY@20mA I _v	mcd	100	413	230	150	250	50	200
Dominant Wavelength λ _D	nm	470	525	630	590	601	568	/
FORWARD VOLTAGE@20mA V _f	V	3.3	3.3	1.95	2	2.1	2.1	3.3

■ A single bin cannot be ordered, please contact us in advance if you need a particular bin sorting before placing your order to clarify the lead time, MOQ and pricing

► HOW TO ORDER

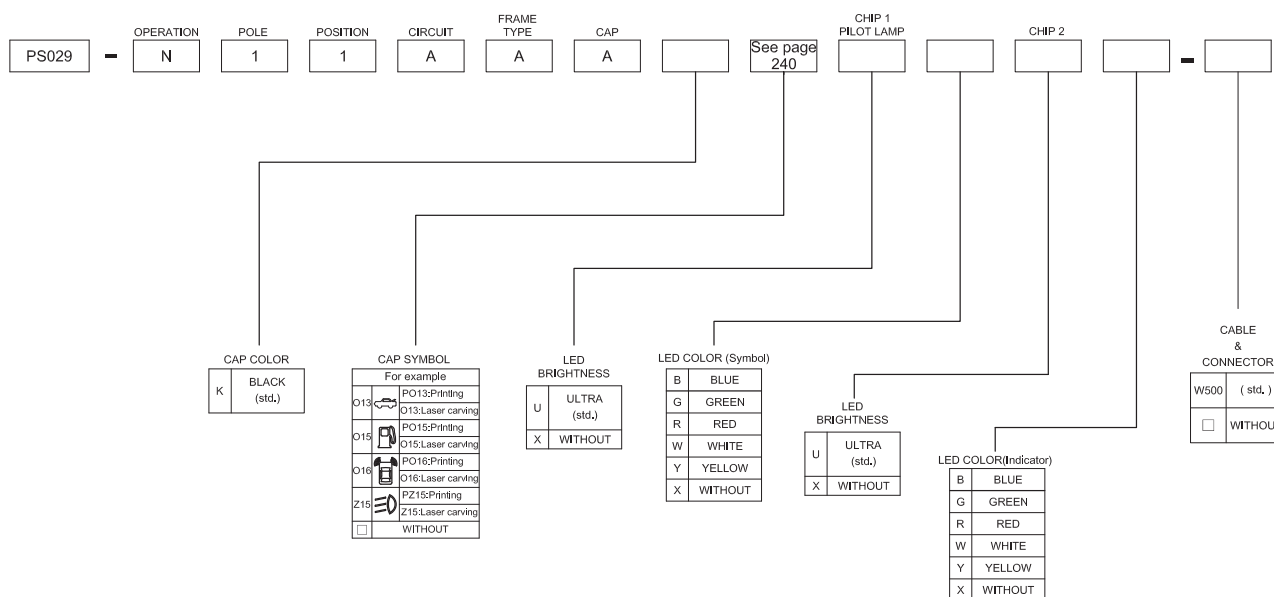

DIMENSION

PS029-N11AAAKH26UWUB-W1500

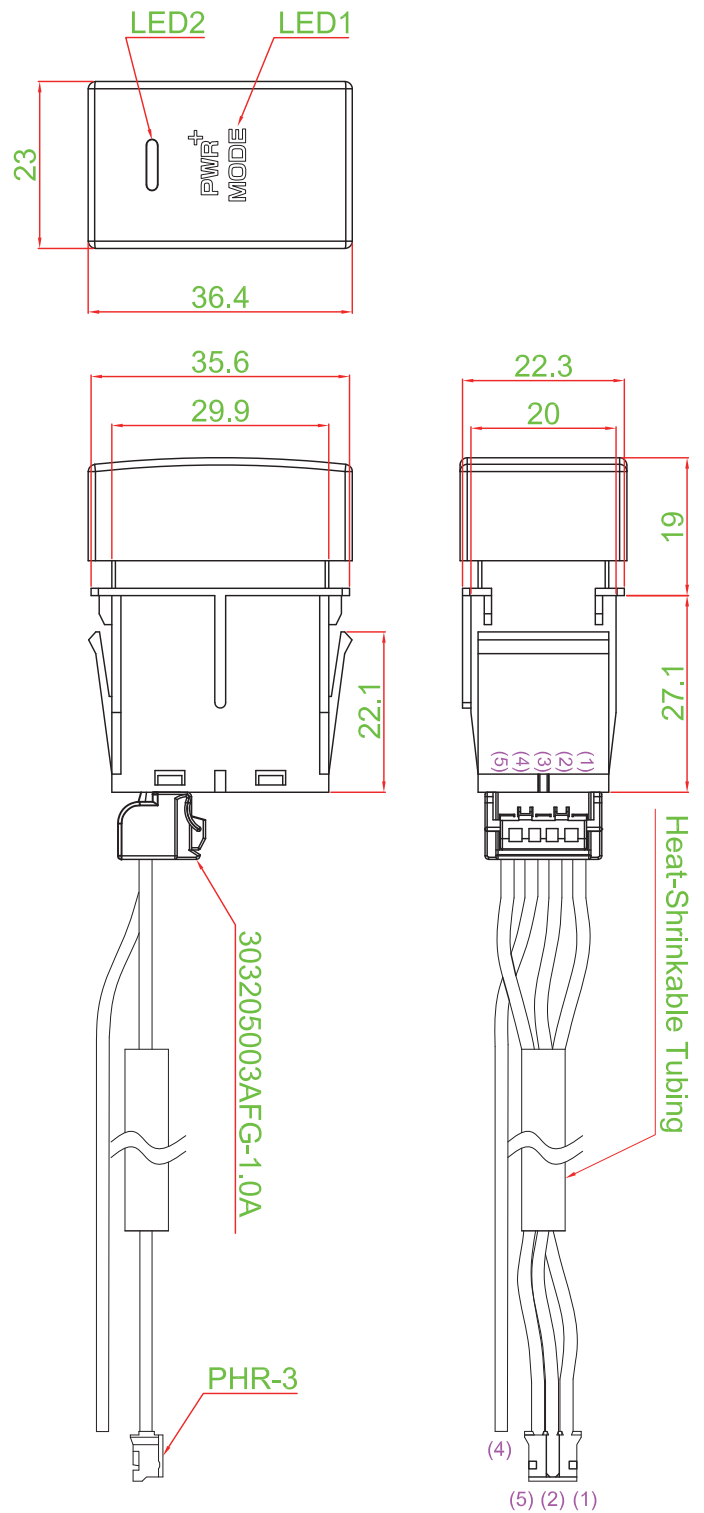

PANEL CUT OUT

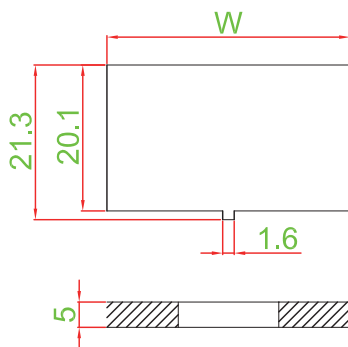

PANEL THICK	W
5.0 ~ 5.7	33.5

CIRCUIT

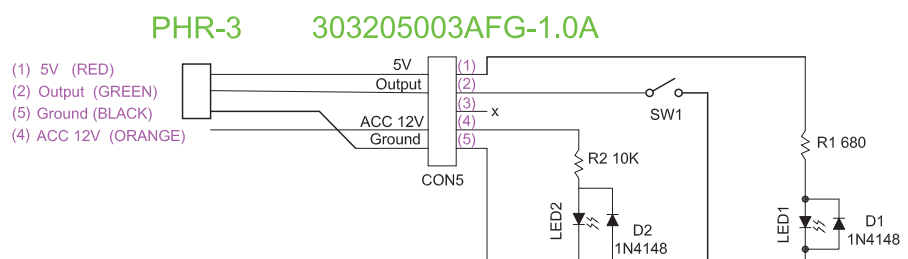

Mouser Electronics

Authorized Distributor

Click to View Pricing, Inventory, Delivery & Lifecycle Information:

[Well Buying:](#)

[PS029-N11A1AAKH26UWUB](#) [PS029-N11AAAKO14UWUR](#)