

# wakefield-vette

| Standard<br>P/N | Height Above<br>PC Board<br>in. (mm) | Maximum<br>Footprint<br>in. (mm) | Thermal Performance at Typical Load |                   |
|-----------------|--------------------------------------|----------------------------------|-------------------------------------|-------------------|
|                 |                                      |                                  | Natural Convection                  | Forced Convection |
| 206-1PABEH      | 1.18 (30.0)                          | 1.00 (25.4) x .50 (12.7)         | 56°C rise @ 4W                      | 7.3°C/W @ 200LFM  |

## MECHANICAL DIMENSIONS

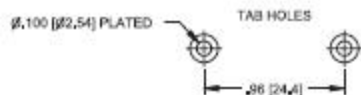
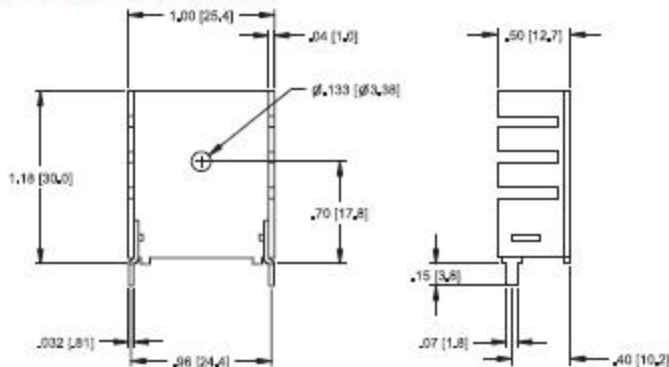

## NATURAL AND FORCED CONVECTION CHARACTERISTICS

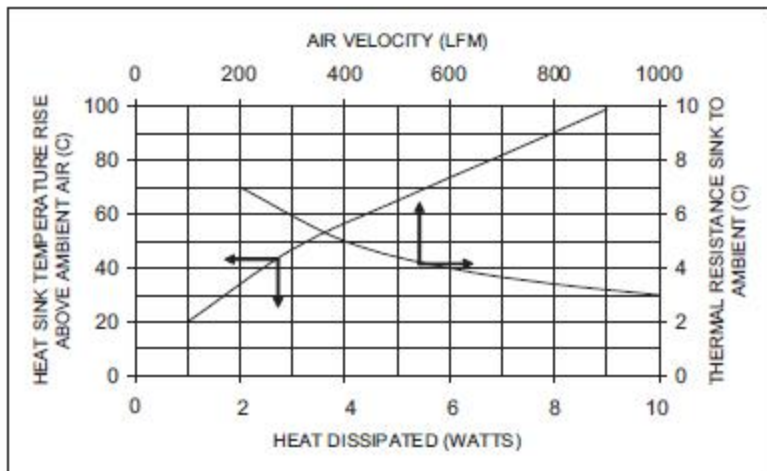

# Mouser Electronics

Authorized Distributor

Click to View Pricing, Inventory, Delivery & Lifecycle Information:

[Wakefield Thermal:](#)

[206-1PABH](#) [206-1PABHE](#)