

PML50 Series

0.688" (17.5mm) Waterproof LED

FlexVolt™ Panel Mount Indicator

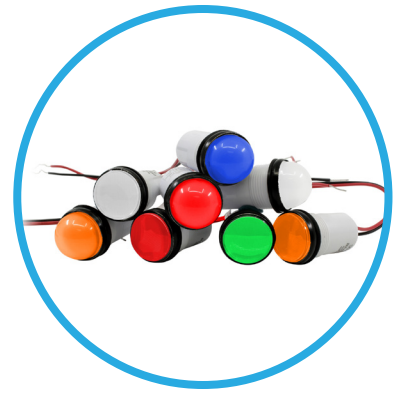

PML50 Series with built-in LED FlexVolt™ technology offers daytime visibility, easy installation in harsh environments

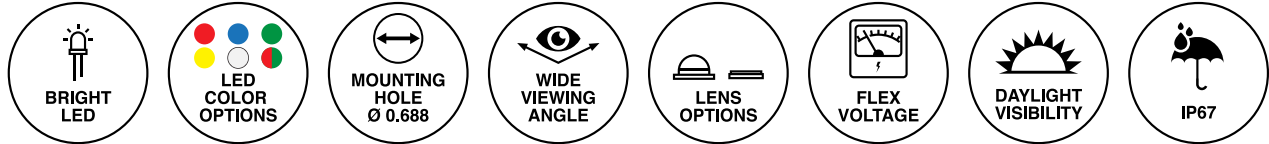

Application

- Industrial
- Transportation
- People Movers
- Maritime, Oil and Gas Industry
- Automation and Control
- Slot, Gaming and Vending Machines
- Safety and Emergency
- Pilot Instrumentation
- Outdoor Applications

Key Features

- For panel hole diameter: 0.688" (17.5mm)
- Low profile flat and semi dome lens options for uniform illumination
- Flat lens with a clear diffused lens for increased contrast visibility between on and off
- Semi dome lens with a white diffused lens for optimal side distance viewing
- Designed for extreme, harsh and outdoor environments
- Available in five single colors: red, green, white, blue or yellow and in bi/color: red/green
- Offered with two lens options: Low Profile Flat and Semi Dome
- Resistant to shock and vibration
- Flex voltage (5 VDC to 28 VDC) designed for application flexibility: one solution for several required input voltages
- Wide viewing angle
- Mounting hardware provided: lock washer and hex nut
- Maximum installation torque: 15in/lb
- "Double D" mounting hole prevents any rotation of the indicator while the nut is being installed
- IP67 specification rating protects front panels against entry of dust, rain and moisture
- InGaN and AlInGaP Technology
- Visible LED in direct sunlight with UV resistance lens
- Long lifetime, up to 100k hours
- Does not require an external resistor to work
- For custom cable length, connectors or colors contact VCC
- RoHS and REACH Compliant

Ordering Data

The PML50 Series is available in a range of standard features and options. To specify your Panel Mount Indicator, select one option from each column.

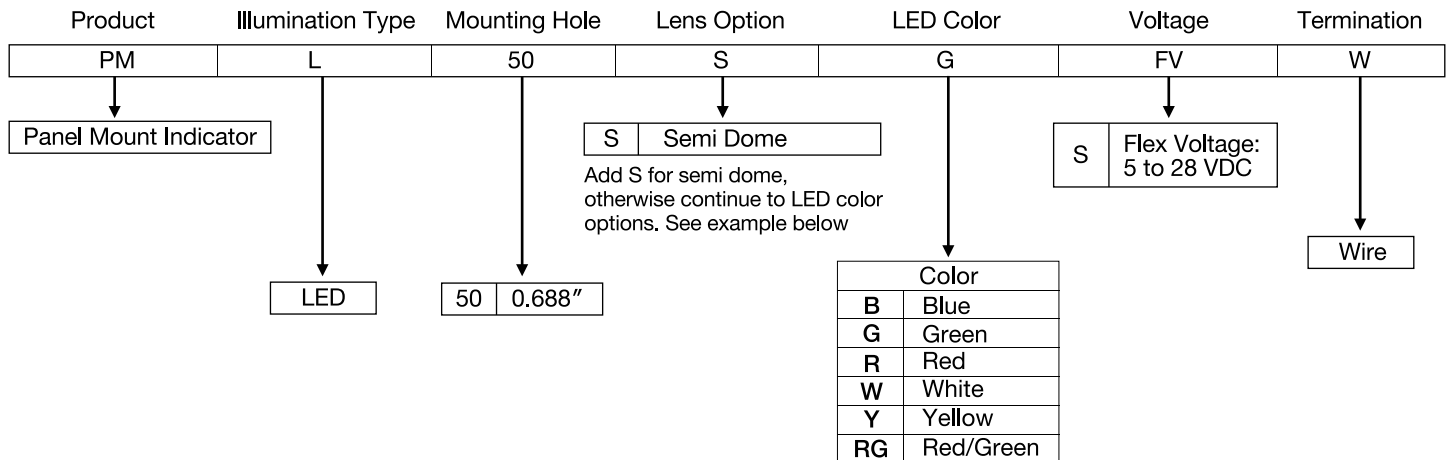

| Part Numbers | Color | Lens Option |
|--------------|-----------|-------------|
| PML50RFVW | Red | Flat |
| PML50WFVW | White | Flat |
| PML50GFVW | Green | Flat |
| PML50BFVW | Blue | Flat |
| PML50YFVW | Yellow | Flat |
| PML50RGFVW | Red/Green | Flat |
| PML50SRFVW | Red | Semi Dome |
| PML50SWFVW | White | Semi Dome |
| PML50SGFVW | Green | Semi Dome |
| PML50SBFVW | Blue | Semi Dome |
| PML50SYFVW | Yellow | Semi Dome |
| PML50SRGFVW | Red/Green | Semi Dome |

Example:

PML50SGFVW

PML50 Semi Dome, Green, Flex Voltage, Wire



PML50RFVW

PML50 Flat, Red, Flex Voltage, Wire



Product Dimensions

Semi Dome Lens

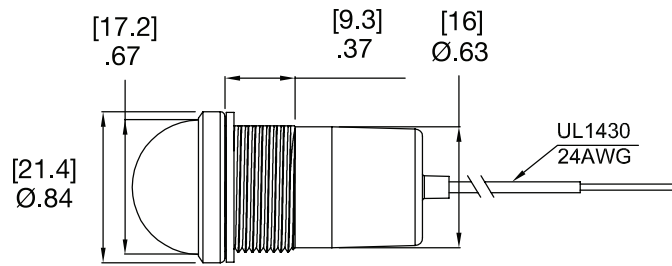
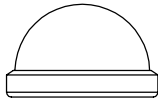

Flat Lens

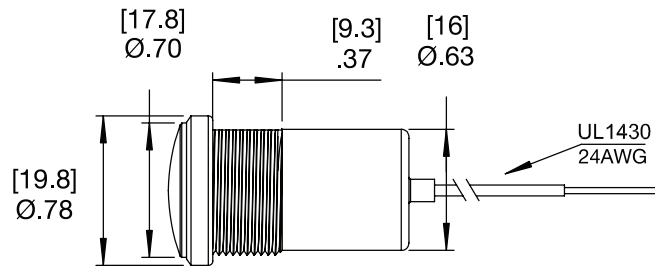

Recommended Mounting Hole

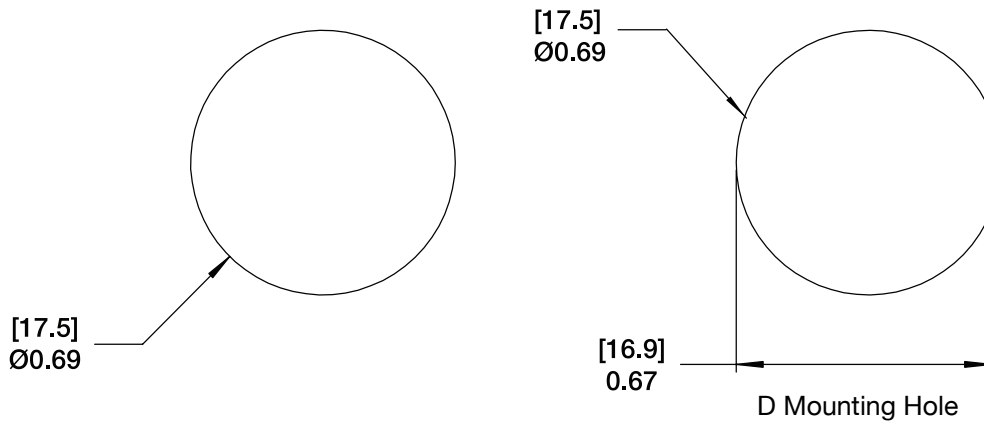

Notes:

1. All dimensions are in inches [millimeters]
2. Tolerance is $\pm[0.25] 0.01$ unless otherwise noted.
3. The specifications, characteristics and technical data described in the datasheet are subject to change without prior notice.

Product Dimensions

Semi Dome Lens

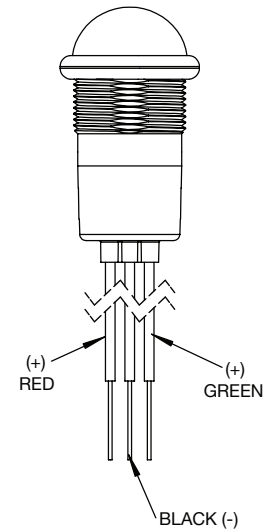
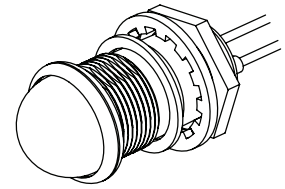
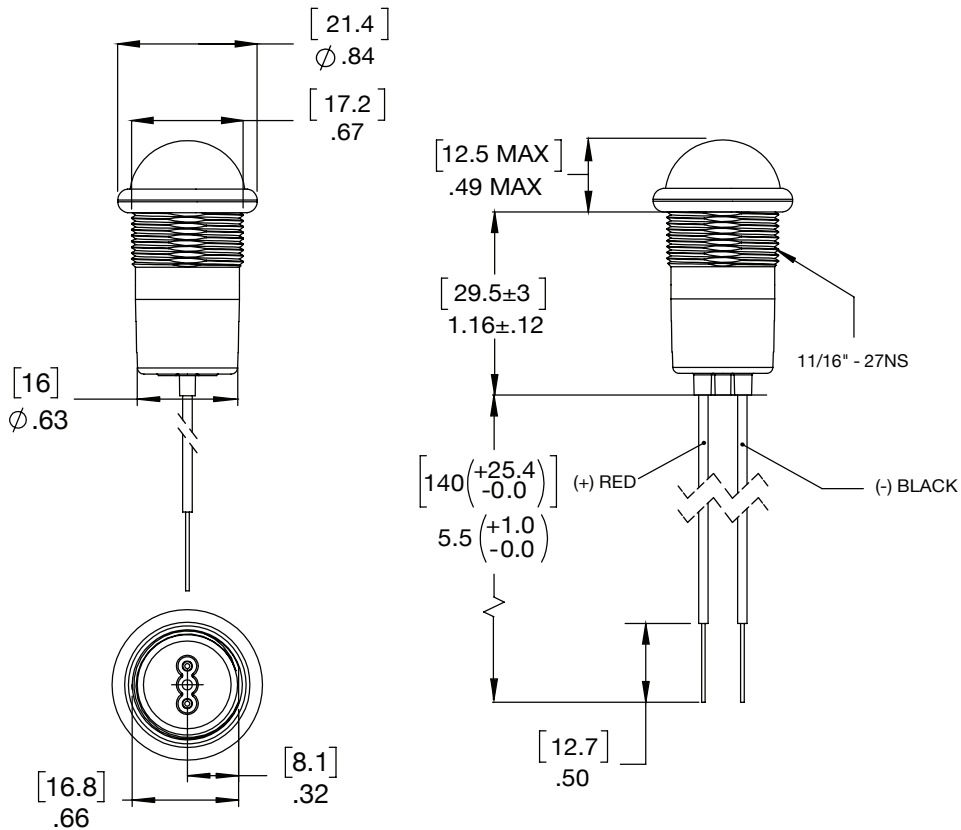

**BI-COLOR
(3-LEAD WIRE)**

Notes:

1. All dimensions are in inches [millimeters]
2. Tolerance is $\pm[0.25] 0.01$ unless otherwise noted.
3. The specifications, characteristics and technical data described in the datasheet are subject to change without prior notice.

Product Dimensions

Flat Lens

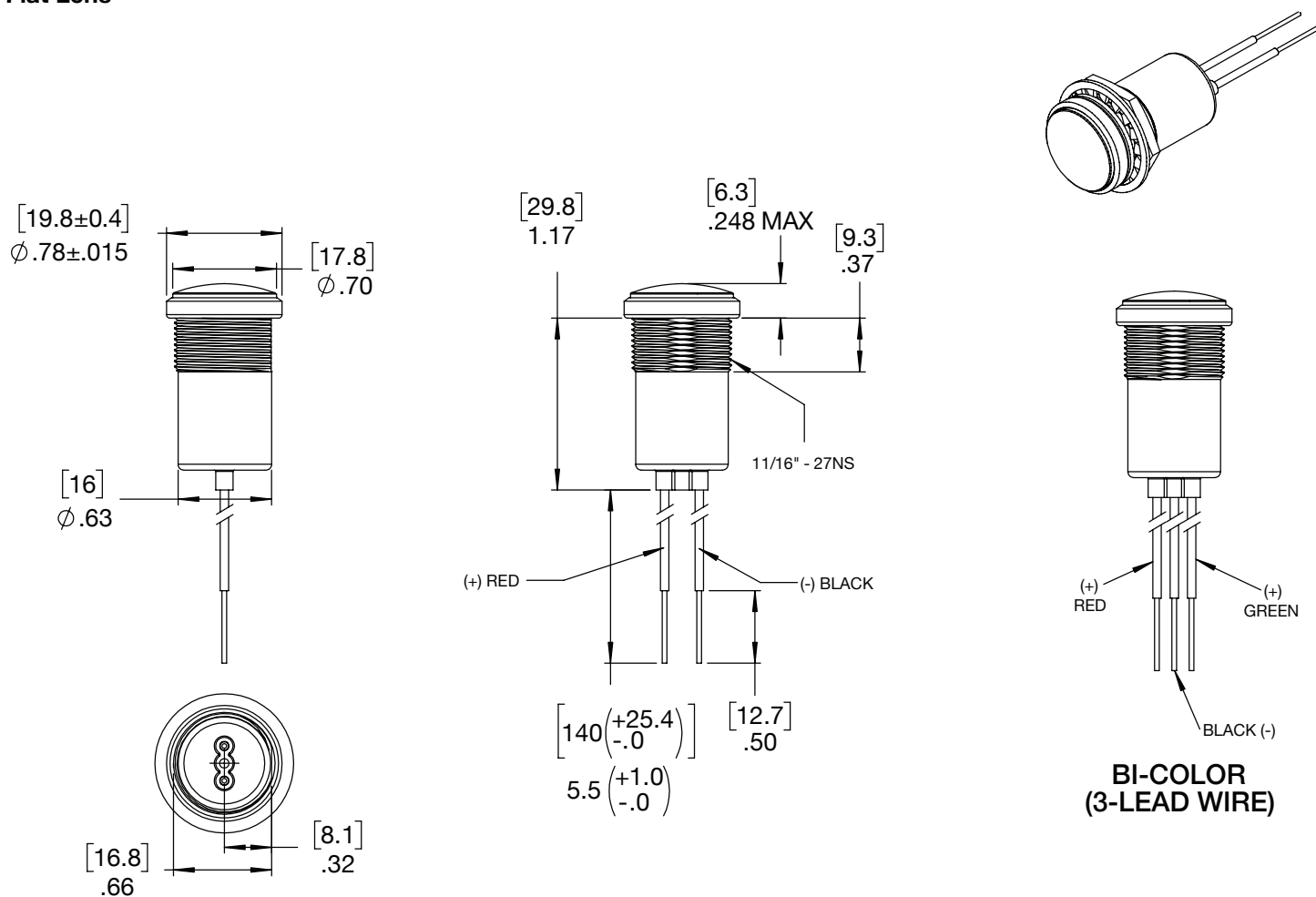

Mounting Hardware (Included for flat and semi dome lenses)

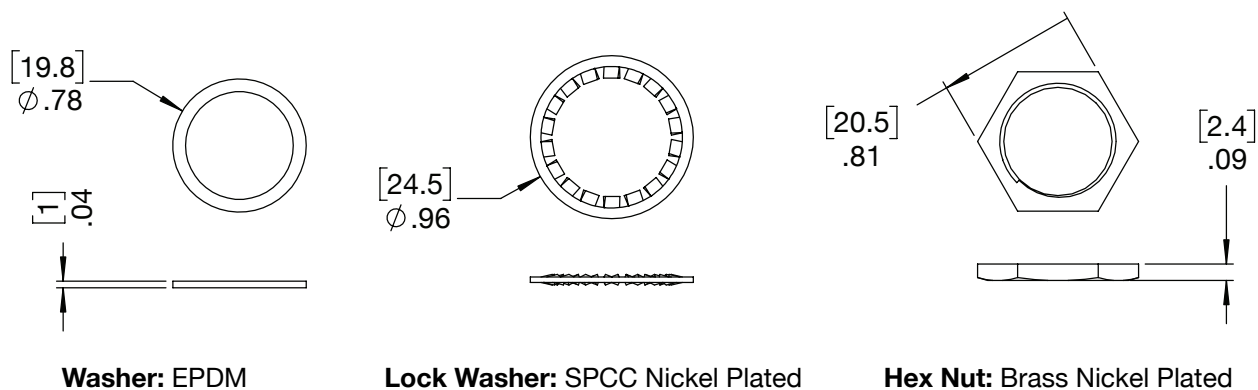

Notes:

1. All dimensions are in inches [millimeters]
2. Tolerance is $\pm[0.25]$ 0.01 unless otherwise noted.
3. The specifications, characteristics and technical data described in the datasheet are subject to change without prior notice.

Product Specifications

| Materials | |
|--------------------|---|
| Housing | White Polycarbonate UL 94 V-0 |
| Lens | Transparent Polycarbonate UL 94 V-0 |
| | UV Material: Polycarbonate Resin (Semi dome lens only) |
| Bezel | Plated, Black Color Finish |
| Wire Leads | Tinned Copper Conductor PVC Insulation |
| Washer (installed) | EPDM rubber |
| Lock Washer | SPCC, Nickel Plated |
| Hex Nut | Brass, Nickel Plated |

| Installation Specifications | |
|-----------------------------|--|
| Mounting Hole ("D" Shape) | 11/16" or 0.688" (17.46 mm) |
| Panel Thickness (max.) | 0.156" (3.96 mm) |
| Wire Leads | 24 AWG - UL1430 rated, 5.5" (140 mm) long, stripped .5" Anode (+): Red lead (Single Color) and Green and Red leads (Bicolor) |
| Mounting Torque | 15 in-lbs (17.28 kg-cm) |

| Electrical Specifications | |
|---------------------------|-----------------------------------|
| Operating Voltage | 5 VDC to 28 VDC (flex voltage) |
| Operating Current | 20mA (max.) |

| Temperature Specifications | |
|----------------------------|------------------------------------|
| Operating Temperature | -25°C to +80°C -13°F to +176°F |
| Storage Temperature | -30°C to +100°C -22°F to +212°F |

Optical Ratings*

| Part Number | Color | Luminance (mcd) |
|-------------|-----------|-----------------|
| PML50RFVW | Red | 950 |
| PML50WFVW | White | 2980 |
| PML50GFVW | Green | 3640 |
| PML50BFVW | Blue | 270 |
| PML50YFVW | Yellow | 2020 |
| PML50RGFVW | Red/Green | 1130/2380 |

| Part Number | Color | Luminance (mcd) |
|-------------|-----------|-----------------|
| PML50SRFVW | Red | 780 |
| PML50SWFVW | White | 1090 |
| PML50SGFVW | Green | 1770 |
| PML50SBFVW | Blue | 200 |
| PML50SYFVW | Yellow | 970 |
| PML50SRGFVW | Red/Green | 520/1370 |

*Test Parameters: Voltage at 24VDC and Temperature at 25°C or 77°F

Compliances and Approvals



Mouser Electronics

Authorized Distributor

Click to View Pricing, Inventory, Delivery & Lifecycle Information:

VCC:

[PML50GFVW](#) [PML50WFVW](#) [PML50BFVW](#) [PML50RGFVW](#) [PML50YFVW](#) [PML50RFVW](#) [PML50SWFVW](#)
[PML50SGFVW](#) [PML50SRFVW](#) [PML50SRGFVW](#) [PML50SYFVW](#) [PML50SBFVW](#)