

A REF

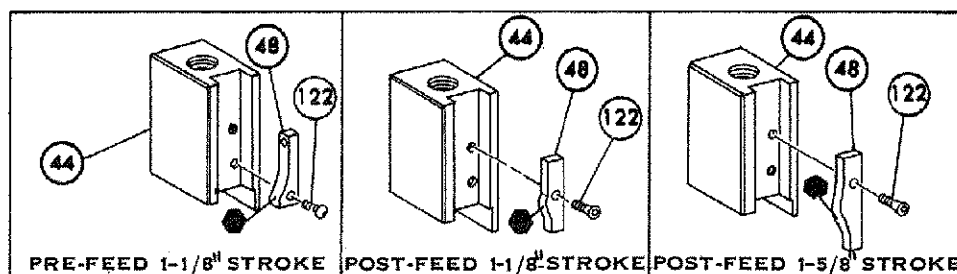

B

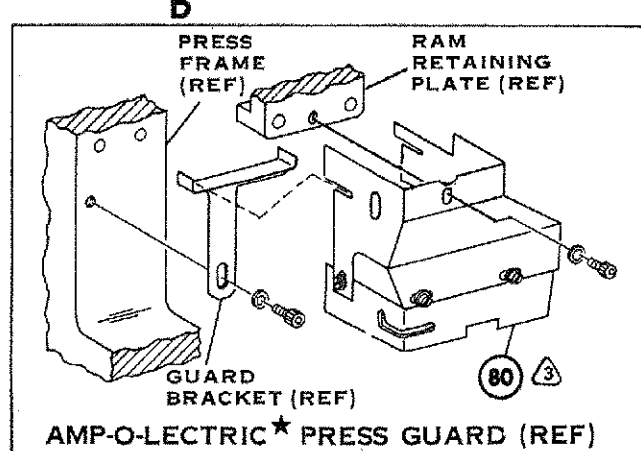

AMP-O-LECTRIC PRESS GUARD (REF)

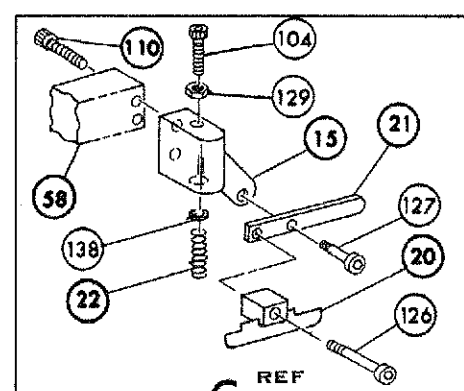

ALTERNATE DRAG METHOD

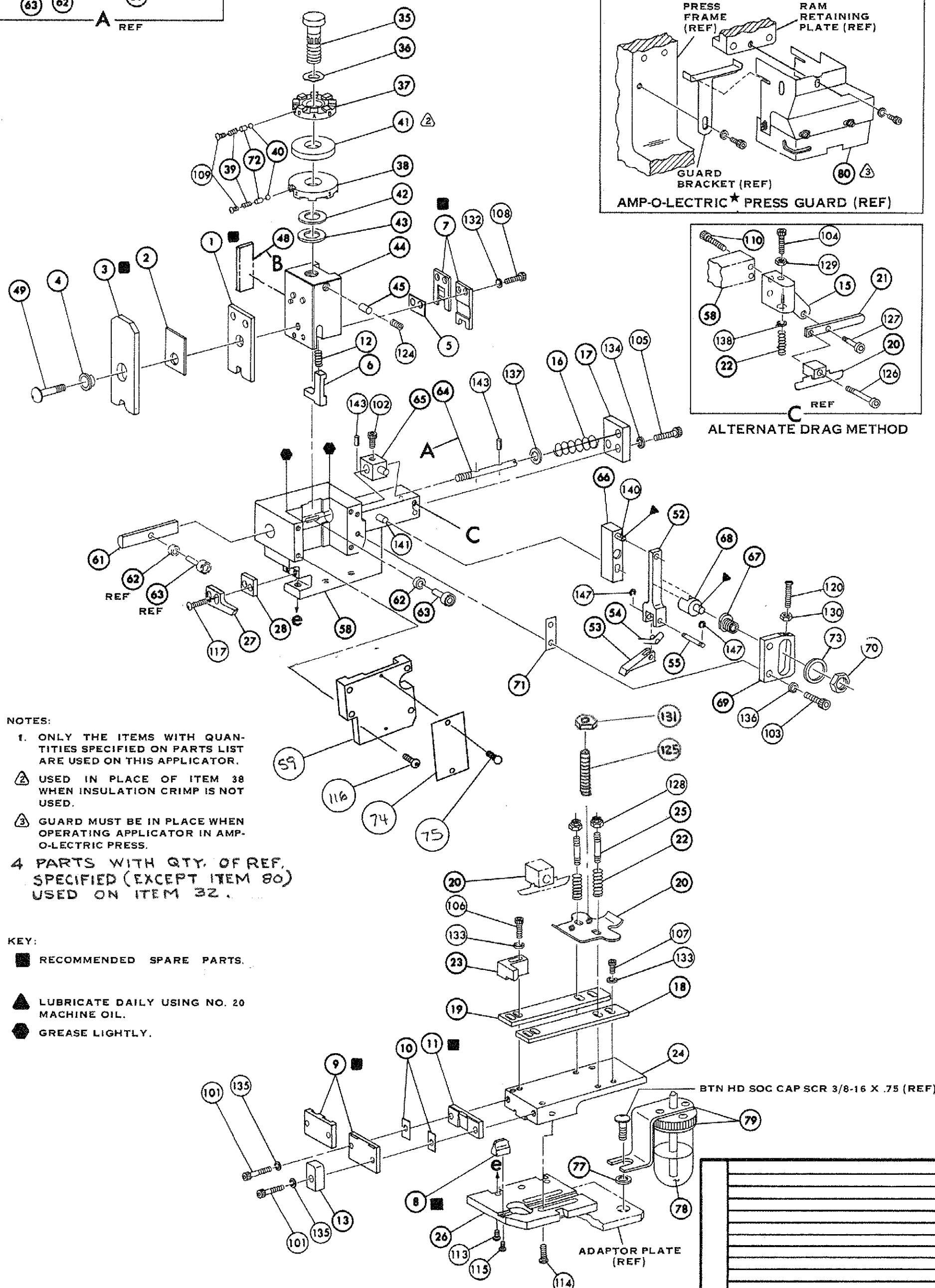

NOTES:

1. ONLY THE ITEMS WITH QUANTITIES SPECIFIED ON PARTS LIST ARE USED ON THIS APPLICATOR.
2. USED IN PLACE OF ITEM 38 WHEN INSULATION CRIMP IS NOT USED.
3. GUARD MUST BE IN PLACE WHEN OPERATING APPLICATOR IN AMP-O-LECTRIC PRESS.
4. PARTS WITH QTY. OF REF. SPECIFIED (EXCEPT ITEM 80) USED ON ITEM 32.

KEY:

- RECOMMENDED SPARE PARTS.
- ▲ LUBRICATE DAILY USING NO. 20 MACHINE OIL.
- GREASE LIGHTLY.

LTR REVISION RECORD

162	REF	690517-1	SPACER	71
161	REF	22594-8	HEX, NUT	70
160	REF	240628-1	PLATE, ADJ	69
159	REF	240626-1	SHAFT, PIVOT	68
158	REF	240633-1	BUSHING	67
157	REF	455680-1	LEVER, INTERMEDIATE	66
156	REF	240629-1	BLOCK, PIVOT	65
155	REF	240632-2	SCREW, ADJ	64
154	REF	240659-3	PIN, CAM ROLLER	63
153	REF	240658-1	CAM, ROLLER	62
152	REF	454398-1	ROD, FEED	61
151				60
150	REF	454220-1	CAP, RAM	59
149	REF	453736-1	HOUSING	58
148				57
147				56
146	REF	240624-1	PIN, FEED FINGER	55
145	REF	691499-1	SPRING, FEED FINGER	54
144	REF	240635-1	FINGER, FEED	53
143	REF	240634-1	LEVER, TERMINAL	52
142				51
141				50
140	1	7-21002-9	BOLT, CRIMPER	49
139	1	690602-5	CAM, PRE FEED 1- 1/8 STROKE	48
138				47
137				46
136	1	690191-1	PLUG, NYLON	45
135	1	455674-1	RAM	44
134	1	690125-1	WASHER, LAMINATED	43
133	1	690124-1	WASHER, RAM	42
132	1	690223-1	SPACER, DISC	41
131	1	23241-6	BALL, STEEL	40
130	1	690170-1	SPRING, COMPRESSION	39
129			DISC, INSULATION	38
128	1	7-690141-6	DISC, WIRE	37
127	1	22480-5	WASHER, SPRING	36
126	1	690212-1	POST, RAM	35
125				34
124				33
123	1	458980-1	APPLICATOR, BASIC (SUB-ASSY.)	32
122				31
121				30
120				29
119	1	3-690451-2	SPACER, STRIPPER	28
118	1	240639-1	STRIPPER	27
117	REF	455676-1	PLATE, BASE	26
116	2	22354-8	DRAG, STUD	25
115	1	455678-1	PLATE, STRIP GUIDE	24
114			PLATE, STRIP HOLD	23
113	2	4-22281-1	SPRING, DRAG	22
112			LEVER, DRAG	21
111	1	454177-1	DRAG, STOCK	20
110	1	458030-5	GUIDE, STRIP REAR	19
109	1	458031-5	GUIDE, STRIP FRONT	18
108	REF	454178-1	GUIDE, FEED ROD	17
107	REF	4-22284-9	SPRING, FEED RETURN	16
106			ADAPTOR, DRAG	15
105				14
104			SPACER, HOLD DOWN	13
103			SPRING, HOLD DOWN	12
102	1	240644-1	PLATE, REAR SHEAR	11
101	2	240645-8	SPACER, SHEAR PLATE	10
80	1	240642-1	PLATE, FRONT SHEAR	9
79	1	3-240654-5	ANVIL	8
78	1	1-240651-2	BLADE, SLUG	7
77			HOLD DOWN	6
76	1	240641-8	SPACER, SHEAR BLADE	5
75			SPACER, TUBULAR, INS CRIMPER	4
74			CRIMPER, INSULATION	3
73			SPACER, INSULATION	2
72	1	456408-2	CRIMPER, WIRE	1

TERM APPL SPEC 114-2084

CRIMPING DATA

PAD LETTER	CRIMP HEIGHT	WIRE SIZE	WIRE STRIP LENGTH
A	.085	14	
B	.075	16	
C	.071	18	
D	NOT USED		
CRIMP WIRE	SIZE	TYPE	FEED PRESS REF.
110	F	.630	565435-5
INSULATION RANGE	WIRE RANGE	APPLICATOR INSTRUCTION	AI 8039
	18-14		

REMARKS AMP-O-LECTRIC PRE-FEED

THIS APPLICATOR WILL APPLY

350568

F EGN 0150-0946-04

E EGN 0150-0385-00

DI 0150-8600-98

D 0150-6789-96

C 0150-6389-25

B EGN 0160688

A REV PER ECU R-3318

7-04

8-08

4-96

8-95

8-95

8-95

8-95

SET UP GAGE

458638-1

8-24-73

8-27-73

8-27-73

8-27-73

8-27-73

LAYOUT NO.

668

8-24-73

8-27-73

8-27-73

8-27-73

8-27-73

APPROVED

R. BENNETT

8-24-73

8-27-73

8-27-73

8-27-73

8-27-73

8-27-73

8-27-73

8-27-73

LOC

A

C

687921-2

F

F

F

F

F

F

REV.

F

F

F

F

F

F

F

F

F

DATE

8-24-73

8-27-73

8-27-73

8-27-73

8-27-73

8-27-73

8-27-73

8-27-73

8-27-73

DATE

8-24-73

8-27-73

8-27-73

8-27-73

8-27-73

8-27-73

8-27-73

8-27-73

8-27-73

DATE

8-24-73

8-27-73

8-27-73

8-27-73

8-27-73

8-27-73

8-27-73

8-27-73

8-27-73

DATE

8-24-73

8-27-73

8-27-73

8-27-73

8-27-73

8-27-73

8-27-73

8-27-73

8-27-73

DATE

8-24-73

8-27-73

8-27-73

8-27-73

8-27-73

8-27-73

8-27-73

8-27-73

8-27-73

DATE

8-24-73

8-27-73

8-27-73

8-27-73

8-27-73

8-27-73

8-27-73

8-27-73

8-27-73

DATE

8-24-73

8-27-73

8-27-73

8-27-73

8-27-73

8-27-73

8-27-73

8-27-73

8-27-73

DATE

8-24-73

8-27-73

8-27-73

8-27-73

8-27-73

8-27-73

8-27-73

8-27-73

8-27-73

DATE

8-24-73

8-27-73

8-27-73

8-27-73

8-27-73

8-27-73

8-27-73

8-27-73

8-27-73

DATE

8-24-73

8-27-73

8-27-73

8-27-73

8-27-73

8-27-73

8-27-73

8-27-73

8-27-73

DATE

8-24-73

8-27-73

8-27-73

8-27-73

8-27-73

8-27-73

8-27-73

8-27-73

8-27-73

DATE

8-24-73

8-27-73

8-27-73

8-27-73

8-27-73

8-27-73

8-27-73

8-27-73

8-27-73

DATE

8-24-73

8-27-73

8-27-73

8-27-73

8-27-73

8-27-73

8-27-73

8-27-73

8-27-73

DATE

8-24-73

8-27-73

8-27-73

8-27-73

8-27-73

8-27-73

8-27-73

8-27-73

8-27-73

DATE

8-24-73

8-27-73

8-27-73

8-27-73

8-27-73

8-27-73

8-27-73

8-27-73

8-27-73

DATE

8-24-73

8-27-73

8-27-7

Mouser Electronics

Authorized Distributor

Click to View Pricing, Inventory, Delivery & Lifecycle Information:

[TE Connectivity:](#)

[687921-2](#)