

2				1			
LOC	DIST	REVISIONS					
FX	00	F	LTR	DESCRIPTION	DATE	DWN	APVD
		O		REL PER NPR 20032	18JUL2000	JRB	RAS
		A		REV PER ECN 0K80-0228-00	23OCT2000	JM	RAS
		B		REV PER EC 0K80-0311-01	14JAN2002	RGV	GEM

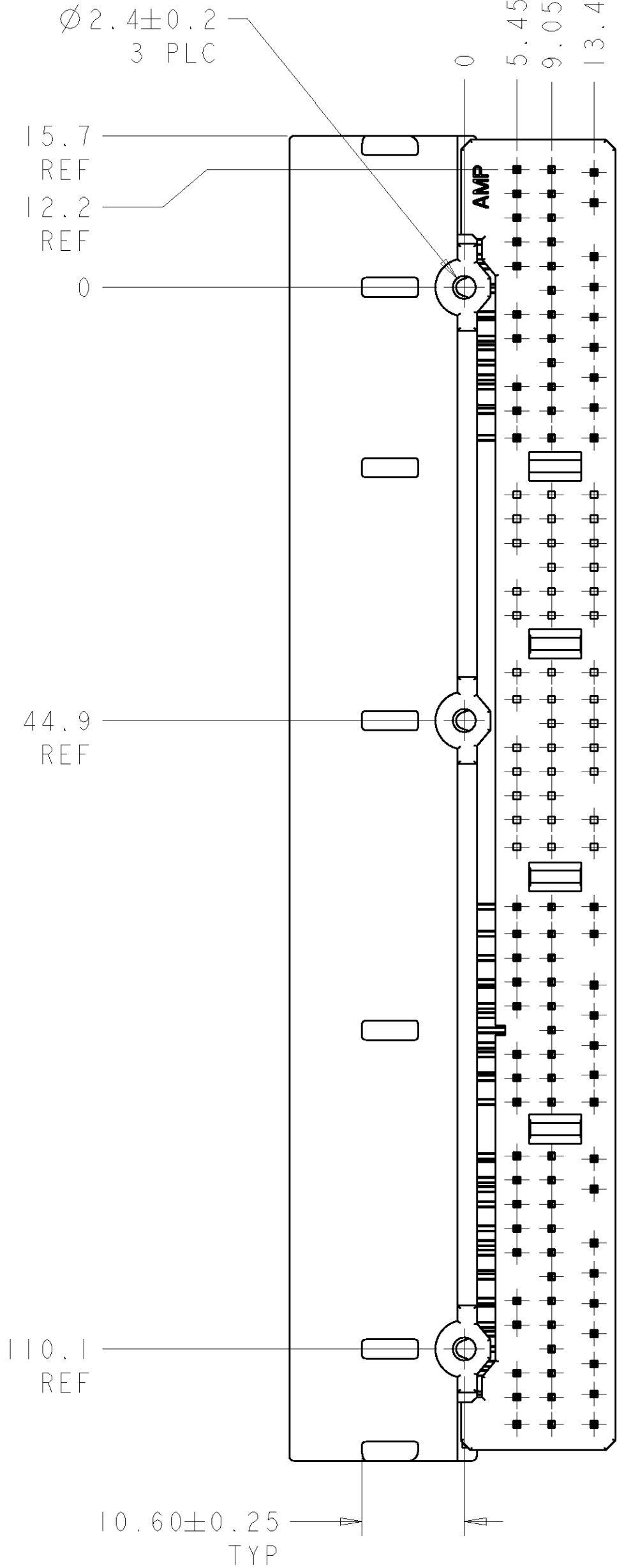

- TO BE MEASURED AT 7.5MM FROM -Z-
- POWER CIRCUITS, 29 PLACES, SEE FIG 1
- FOR CIRCUIT NUMBERS, SEE FIG 1
- DATE CODE
- TO BE MATED SMOOTHLY WITH:  
24 POSN: P/N 353029  
31 POSN: P/N 353826, 1318682
- RECOMMENDED SCREW: PAN HEAD, TYPE 2 TAPPING SCREW, 3.0 DIA X 6.0 LG MAX, PER JIS B1115, B1122
- FASTENING TORQUE FOR SCREW: 0.392Nm MAX
- TO BE DETERMINED BY CUSTOMER

NATURAL	PBT	TINE PLATE	3
PRE-TIN	COPPER ALLOY	TAB CONTACT	2
NATURAL	PBT	CAP HOUSING	1
FINISH/COLOR	MATERIAL	NAME	ITEM NO

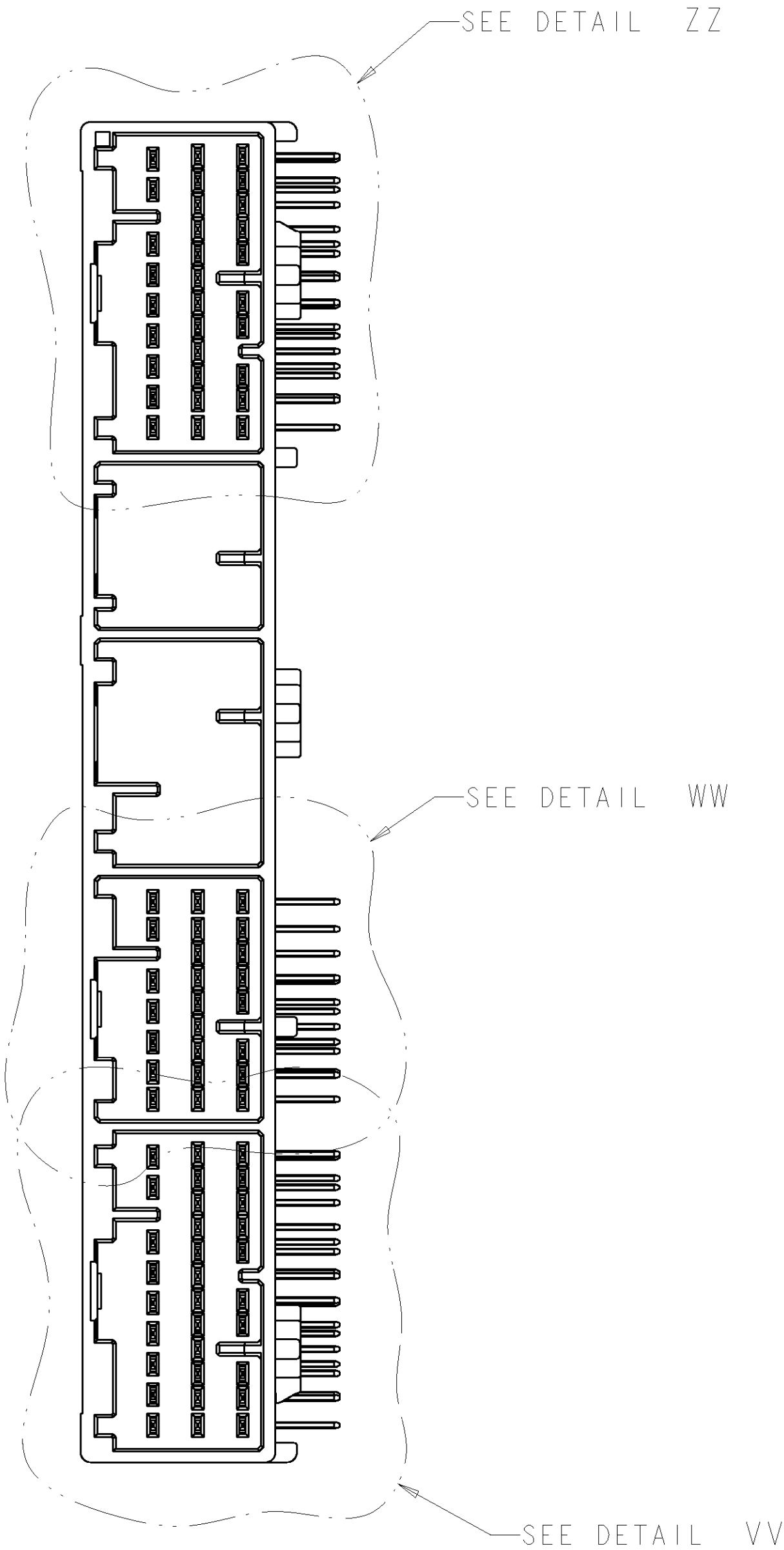
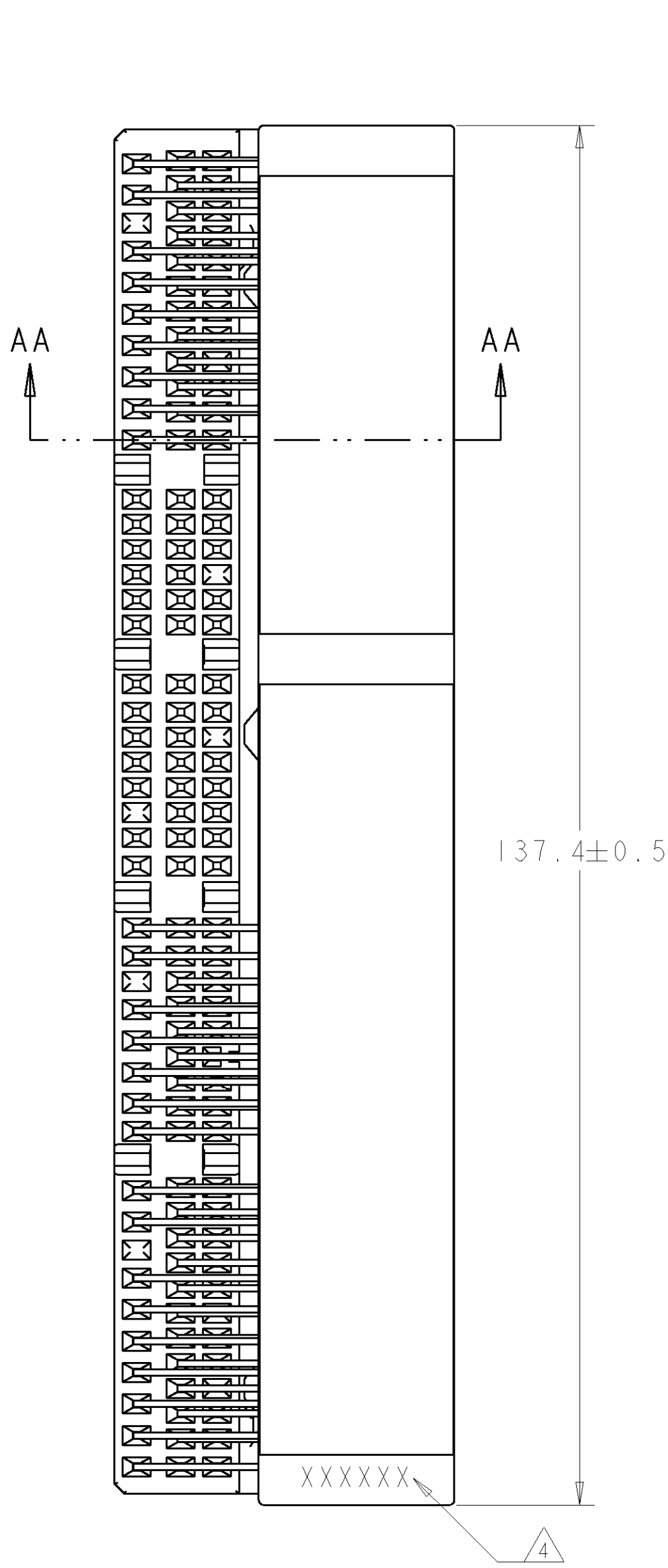
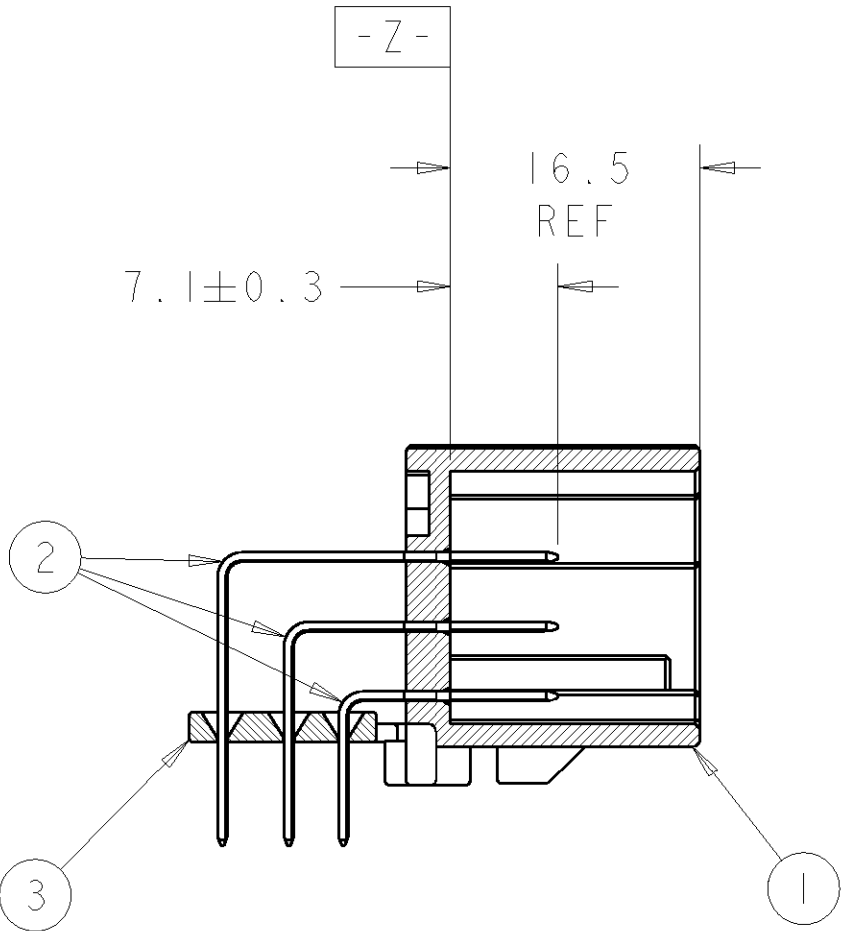

SECTION AA-AA  
SCALE 2:1

638760-1 PART NUMBER			
THIS DRAWING IS A CONTROLLED DOCUMENT FOR AMP INCORPORATED. ANY DISCREPANCY, CHANGE, AND THE CONTROLLING ENGINEERING ORGANIZATION SHOULD BE CONTACTED FOR THE LATEST REVISION.		DWN JEFF MCNEAL 24MAY2000 CWR RAY SMITH 24MAY2000 APRD RAY SMITH 24MAY2000	
DIMENSIONS: mm		TOLERANCES, UNLESS OTHERWISE SPECIFIED: 0 PLC ±0.30 1 PLC ±0.30 2 PLC ±0.30 3 PLC ±0.30 4 PLC ±0.30 5 PLC ±0.30 6 PLC ±0.30 7 PLC ±0.30 8 PLC ±0.30 9 PLC ±0.30 10 PLC ±0.30 11 PLC ±0.30 12 PLC ±0.30 13 PLC ±0.30 14 PLC ±0.30 15 PLC ±0.30 16 PLC ±0.30 17 PLC ±0.30 18 PLC ±0.30 19 PLC ±0.30 20 PLC ±0.30 21 PLC ±0.30 22 PLC ±0.30 23 PLC ±0.30 24 PLC ±0.30 25 PLC ±0.30 26 PLC ±0.30 27 PLC ±0.30 28 PLC ±0.30 29 PLC ±0.30 30 PLC ±0.30 31 PLC ±0.30 32 PLC ±0.30 33 PLC ±0.30 34 PLC ±0.30 35 PLC ±0.30 36 PLC ±0.30 37 PLC ±0.30 38 PLC ±0.30 39 PLC ±0.30 40 PLC ±0.30 41 PLC ±0.30 42 PLC ±0.30 43 PLC ±0.30 44 PLC ±0.30 45 PLC ±0.30 46 PLC ±0.30 47 PLC ±0.30 48 PLC ±0.30 49 PLC ±0.30 50 PLC ±0.30 51 PLC ±0.30 52 PLC ±0.30 53 PLC ±0.30 54 PLC ±0.30 55 PLC ±0.30 56 PLC ±0.30 57 PLC ±0.30 58 PLC ±0.30 59 PLC ±0.30 60 PLC ±0.30 61 PLC ±0.30 62 PLC ±0.30 63 PLC ±0.30 64 PLC ±0.30 65 PLC ±0.30 66 PLC ±0.30 67 PLC ±0.30 68 PLC ±0.30 69 PLC ±0.30 70 PLC ±0.30 71 PLC ±0.30 72 PLC ±0.30 73 PLC ±0.30 74 PLC ±0.30 75 PLC ±0.30 76 PLC ±0.30 77 PLC ±0.30 78 PLC ±0.30 79 PLC ±0.30 80 PLC ±0.30 81 PLC ±0.30 82 PLC ±0.30 83 PLC ±0.30 84 PLC ±0.30 85 PLC ±0.30 86 PLC ±0.30 87 PLC ±0.30 88 PLC ±0.30 89 PLC ±0.30 90 PLC ±0.30 91 PLC ±0.30 92 PLC ±0.30 93 PLC ±0.30 94 PLC ±0.30 95 PLC ±0.30 96 PLC ±0.30 97 PLC ±0.30 98 PLC ±0.30 99 PLC ±0.30 100 PLC ±0.30	
MATERIAL		FINISH	
CUSTOMER DRAWING		WEIGHT 36.5g	
SIZE		CAGE CODE	
DRAWING NO		SCALE 2:1	
SHEET 1 OF 3		REV B	

LOC	DIST	REVISIONS					
FX	00	F	LTR	DESCRIPTION	DATE	DWN	APVD
		-		SEE SHEET 1	-	-	-

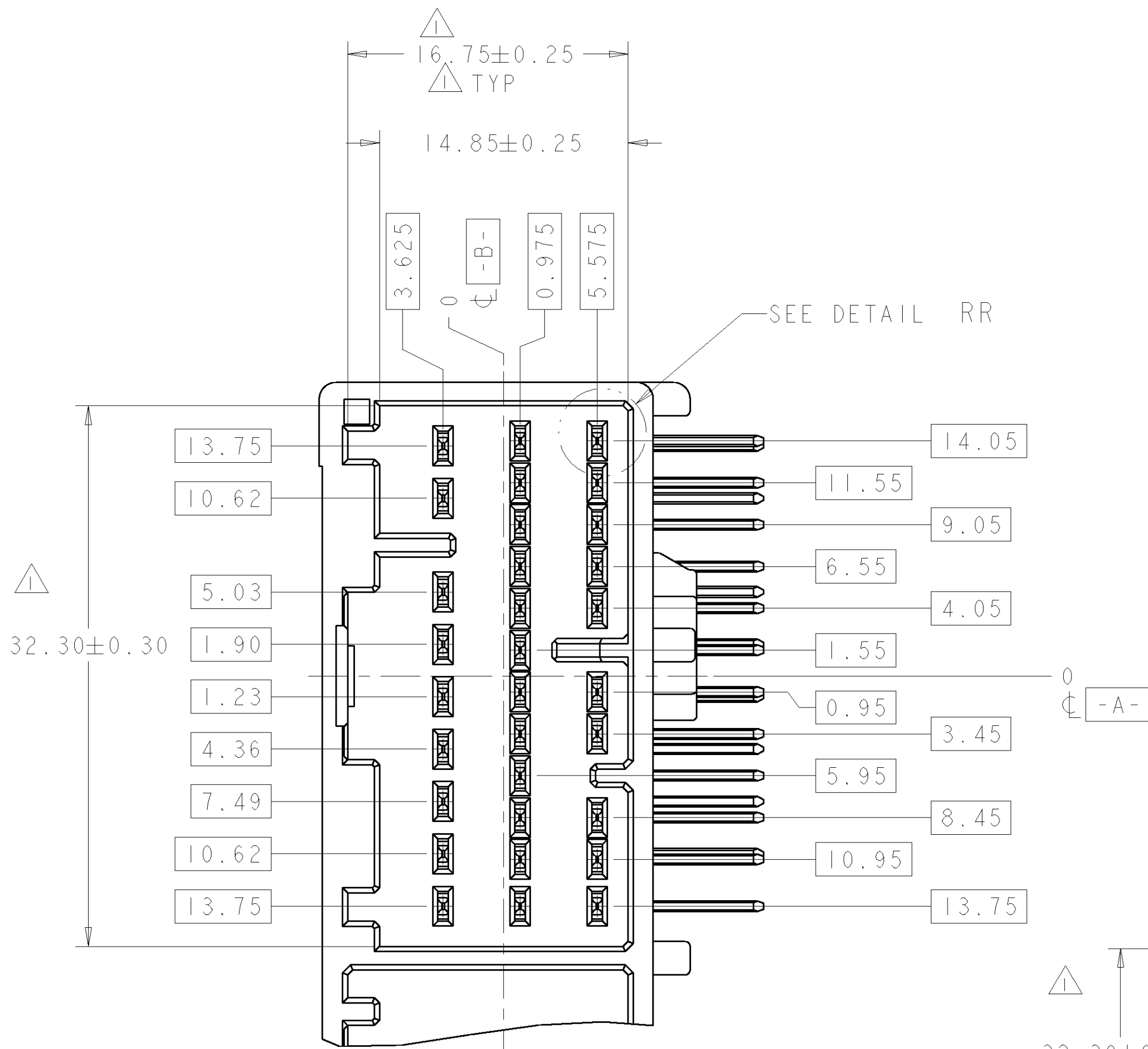

DETAIL ZZ  
SCALE 4:1

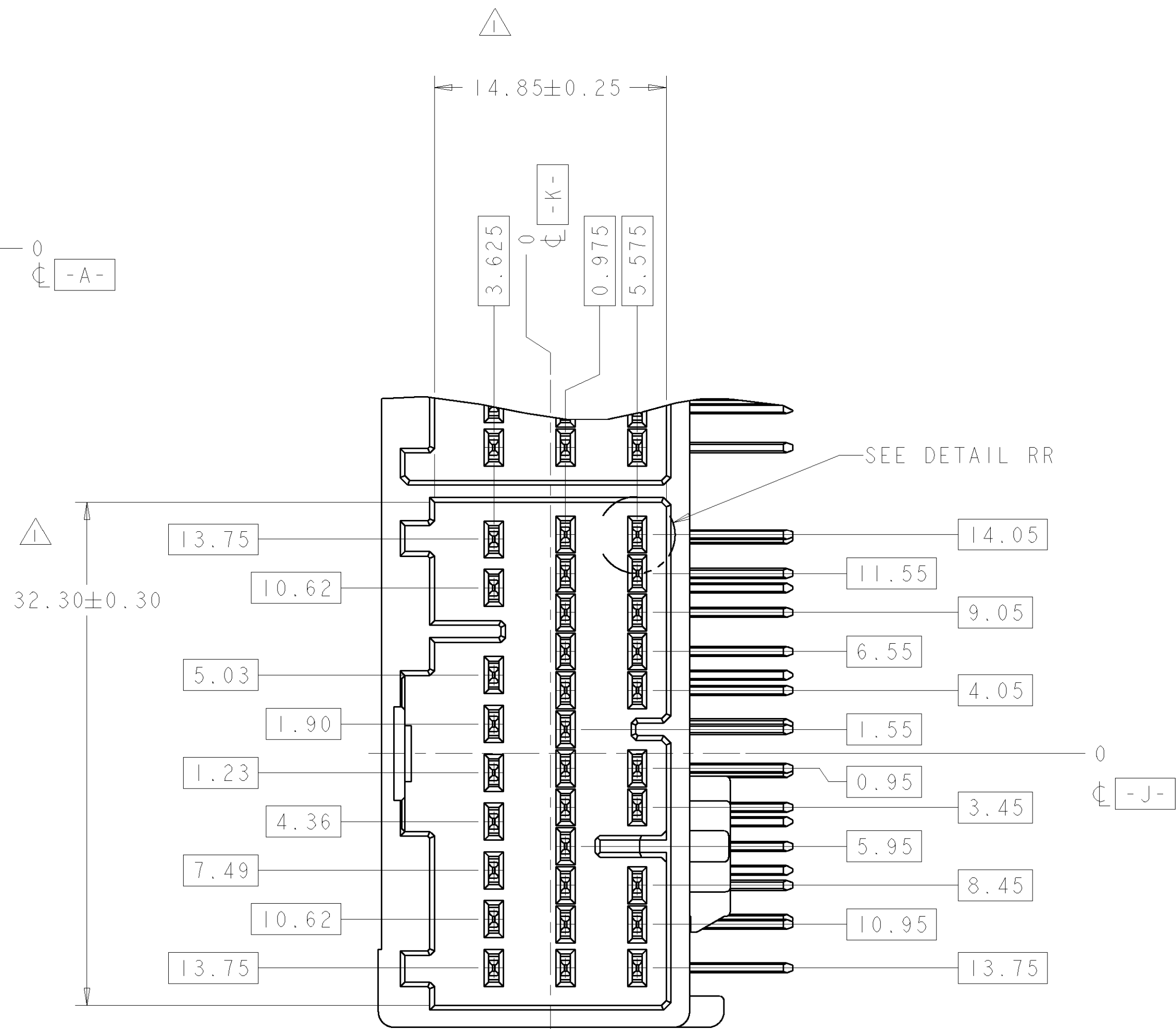

DETAIL VV  
SCALE 4:1

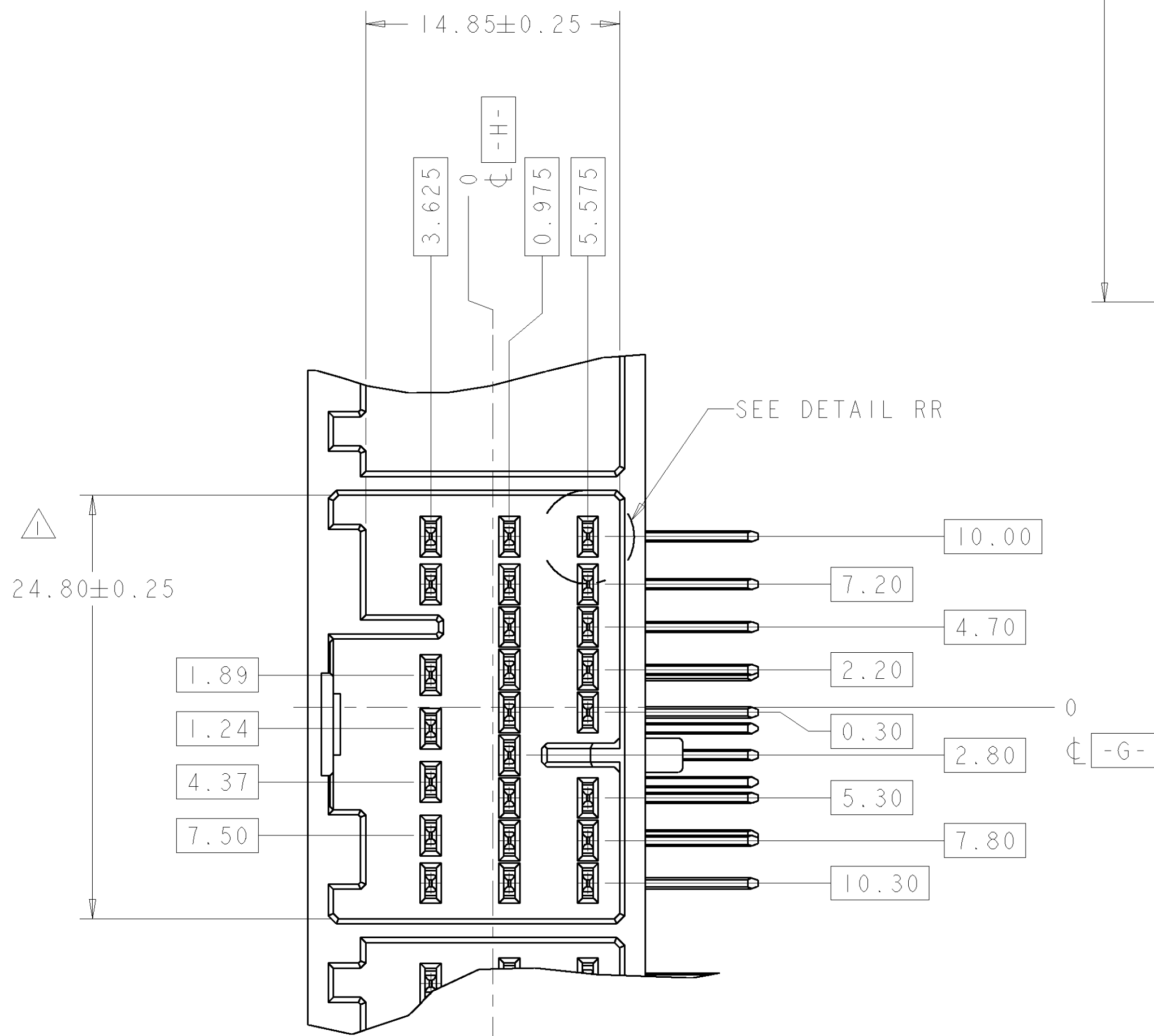

DETAIL WW  
SCALE 4:1

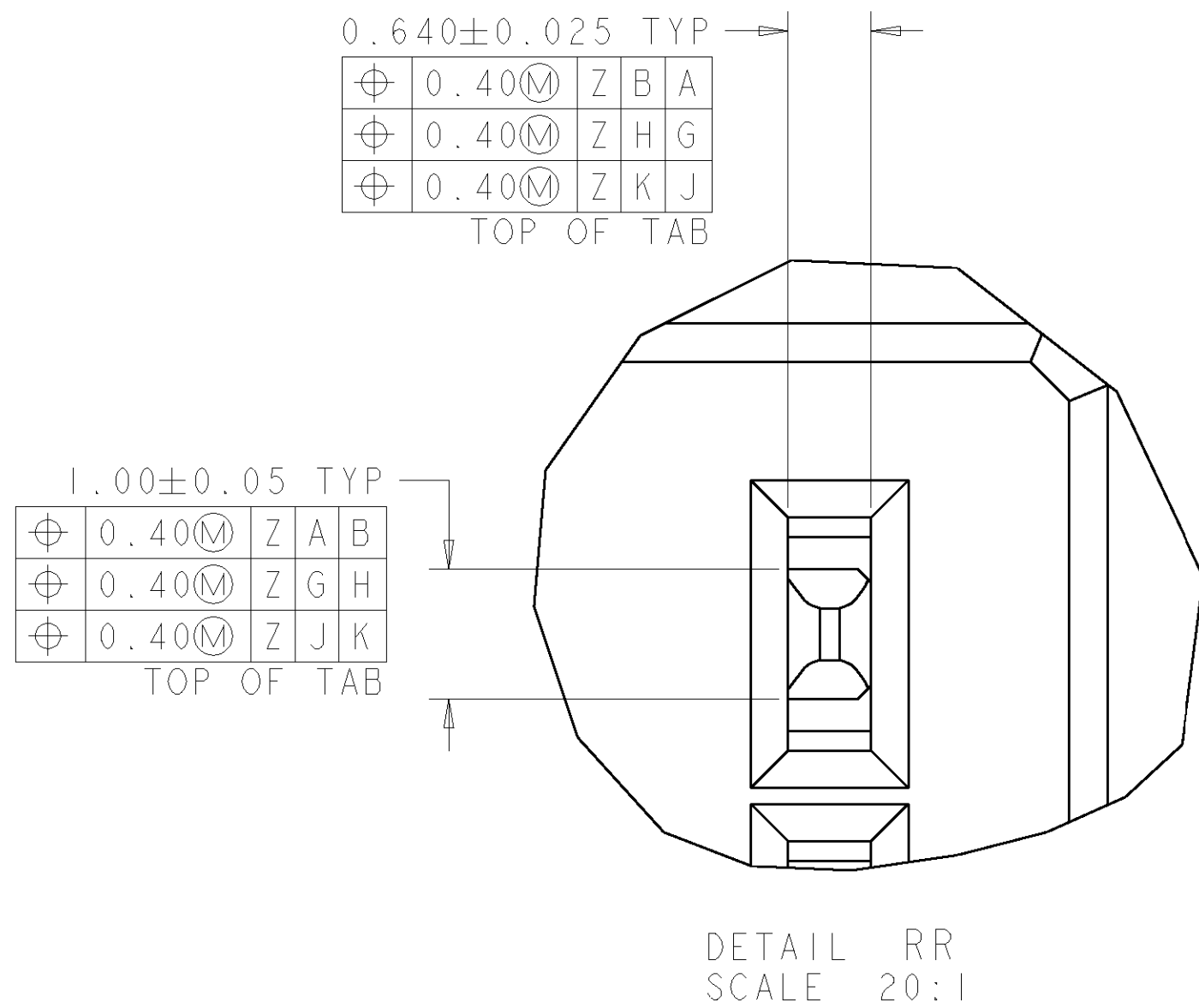

DETAIL RR  
SCALE 20:1

THIS DRAWING IS A CONTROLLED DOCUMENT FOR AMP INCORPORATED. ANY DISCREPANCY TO CHANGE AND THE CONTROLLING ENGINEERING ORGANIZATION SHOULD BE CONTACTED FOR THE LATEST REVISION.		DWN JEFF MCNEAL 24MAY2000	Tyco Electronics Harrisburg, PA 17105-3608	
DIMENSIONS: mm		CHK RAY SMITH 24MAY2000	NAME ASSEMBLY, 86 POSN HDIII, 040 SERIES CAP HOUSING	
TOLERANCES UNLESS OTHERWISE SPECIFIED: 0 PLC $\pm 0.30$ 1 PLC $\pm 0.30$ 2 PLC $\pm 0.30$ 3 PLC $\pm 0.30$ 4 PLC $\pm 0.30$ ANGLES $\pm 1^\circ$		APRD RAY SMITH 24MAY2000	SIZE A1 00779	
MATERIAL -		PRODUCT SPEC -	DRAWING NO C=638760	
FINISH -		APPLICATION SPEC -	SCALE 2:1 SHEET 2 OF 3 REV B	
WEIGHT -		CUSTOMER DRAWING		

LOC	DIST	REVISIONS					
		F	LTR	DESCRIPTION	DATE	DWN	APVD
FX	00	-	-	SEE SHEET 1	-	-	-

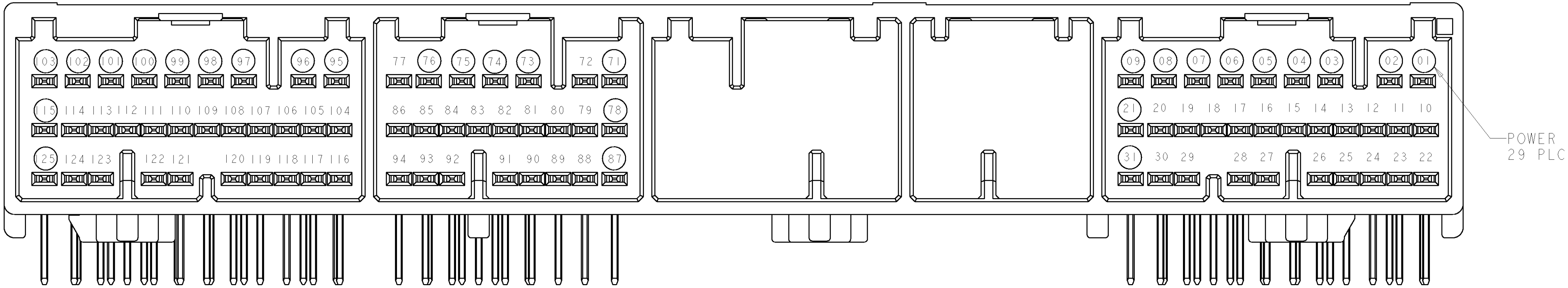
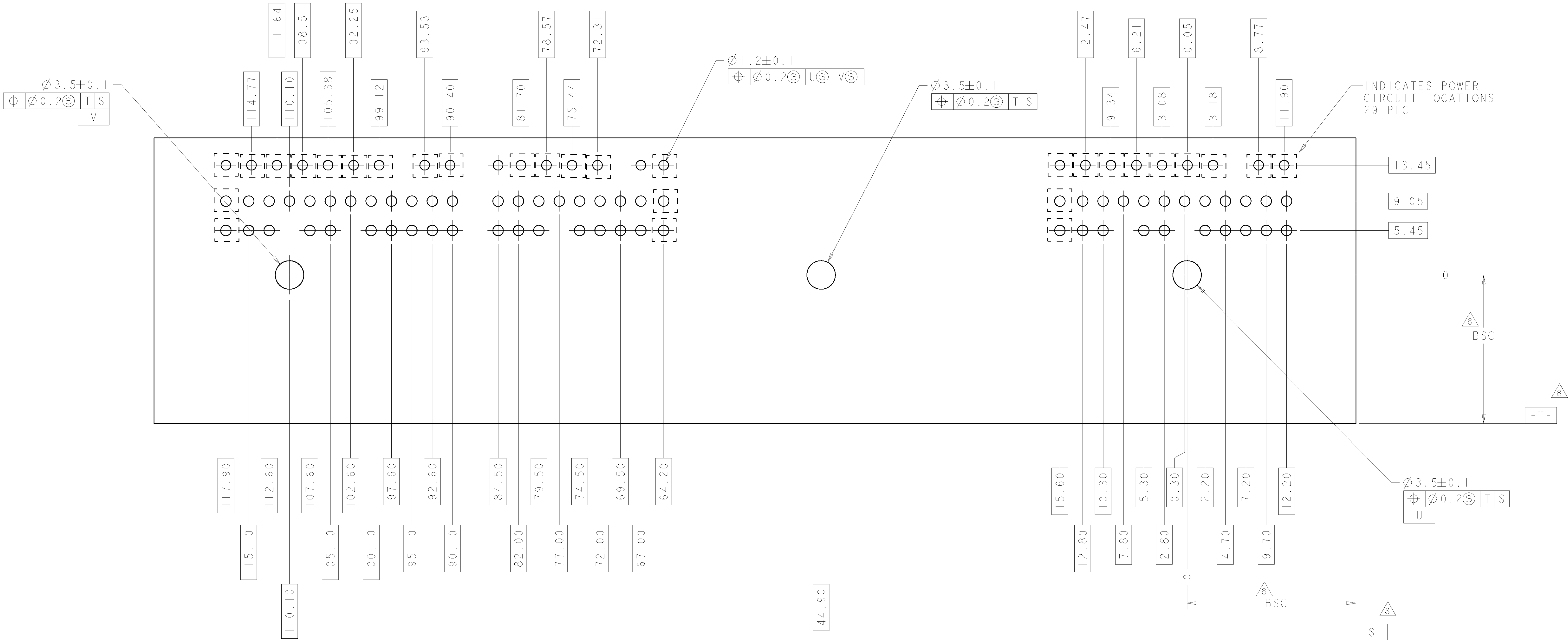

FIGURE 1: CIRCUIT NUMBERS AND POWER CIRCUITS



PC BOARD LAYOUT  
RECOMMENDED THICKNESS: 1.57 MM  
COMPONENT SIDE SHOWN

THIS DRAWING IS A CONTROLLED DOCUMENT FOR AMP INCORPORATED. ANY DISCREPANCY TO CHANGE AND THE CONTROLLING ORGANIZATION SHOULD BE CONTACTED FOR THE LATEST REVISION.		DWN JEFF MCNEAL	24MAY2000	<b>AMP</b> Tyco Electronics Harrisburg, PA 17105-3608
DIMENSIONS: mm		CHK RAY SMITH	24MAY2000	
TOLERANCES UNLESS OTHERWISE SPECIFIED: 0 PLC ±0.30 1 PLC ±0.30 2 PLC ±0.30 3 PLC ±0.30 4 PLC ±0.30 ANGLES ±°		APVD RAY SMITH	24MAY2000	
MATERIAL		FINISH	±°	
NAME ASSEMBLY, 86 POSN HDIII, 040 SERIES CAP HOUSING		PRODUCT SPEC	-	SIZE A1 CAGE CODE 00779 DRAWING NO. C=638760
APPLICATION SPEC		WEIGHT	-	
CUSTOMER DRAWING		SCALE	2:1	
		SHEET	3 OF 3	

# Mouser Electronics

Authorized Distributor

Click to View Pricing, Inventory, Delivery & Lifecycle Information:

[TE Connectivity:](#)

[638760-1](#)