

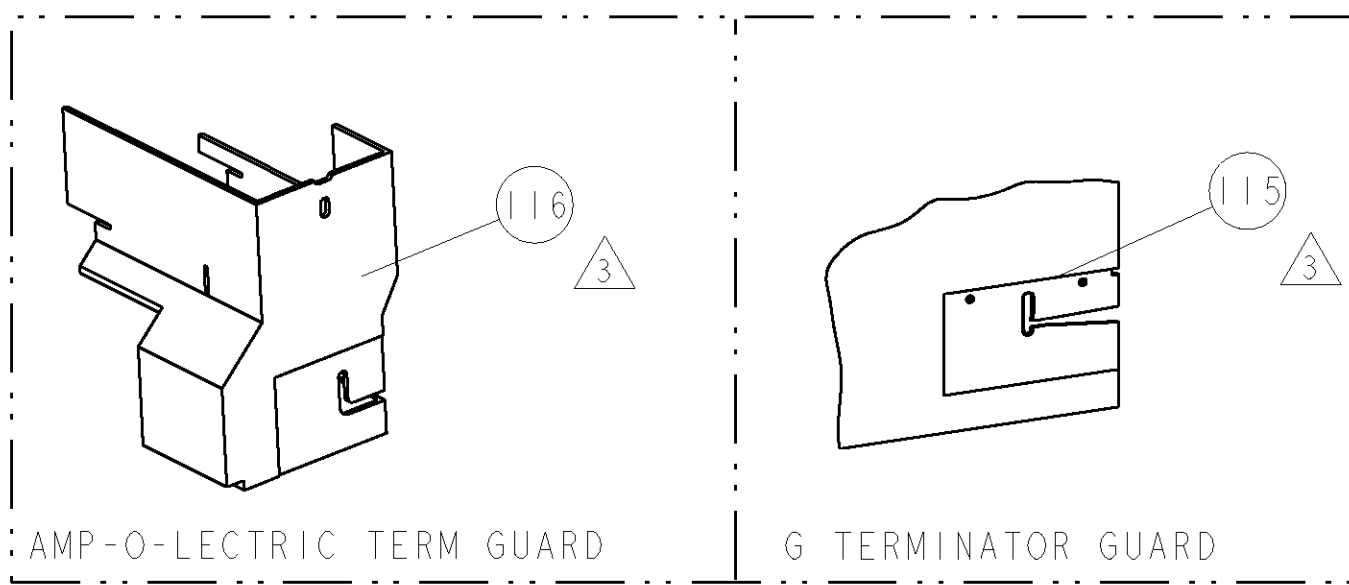

8			7		
THIS DRAWING IS UNPUBLISHED.			RELEASED FOR PUBLICATION		
(C) COPYRIGHT 20			20		
BY TYCO ELECTRONICS CORPORATION. ALL RIGHTS RESERVED.					
PART NUMBER	REV	FIRST USED	POWER UNIT	FEED TYPE	DESCRIPTION
1855258-1	A	122500-1	LEADMAKER	AIR FEED	CUTS CARRIER
1855258-2	A	565435-5	BENCH MODEL K	AIR FEED	CUTS CARRIER
1855258-3	A	354500-1	BENCH MODEL G	AIR FEED	CUTS CARRIER
7-1855258-7	A	-	-	-	SPARE PARTS

- △ RECOMMENDED SPARE PARTS
- △ GREASE LIGHTLY
- △ GUARD MUST BE IN PLACE WHEN OPERATING APPLICATOR IN A BENCH MACHINE
- △ INSTALL ITEMS 101, 102, AND 119 ON SIDE OF STRIPPER ON APPL HOUSING USING ITEM 21.

**\* WARNING**  
ON INSTALLATION, SET WIRE DISC TO LARGEST WIRE SIZE SETTING. USE OF SETTINGS BELOW MIN. REQUIRED CRIMP HEIGHT SETTING WILL CAUSE DAMAGE TO CRIMP TOOLING.



TERMINAL NAME: TERMINAL, RING							
TYCO PN	MFR PN	DELPHI TERM - DELPHI CRIMP SPECS					
1949337	2977821						REF SETTING
-	-	CRIMP HEIGHT			WIRE SIZE		
-	-	2.20±0.05mm[.086±.002]			0.80mm2		
-	-	2.10±0.05mm[.082±.002]			0.50mm2		
-	-	-			-		
-	-	-			-		
-	-	-			-		
-	-	CRIMP	SIZE		TYPE	RANGE	
-	-	WIRE	2.97mm [.117]		F	0.50-0.80mm2	
-	-	INSUL	4.6mm [.170]		F	Ø2.69-3.13mm MAX	
WIRE STRIP LENGTH 4.90-5.10mm	TERM APPL SPEC NONE	FEED 13.90mm	APPLICATOR INSTRUCTIONS 408-8040			SET UP GAGE 458637-1	

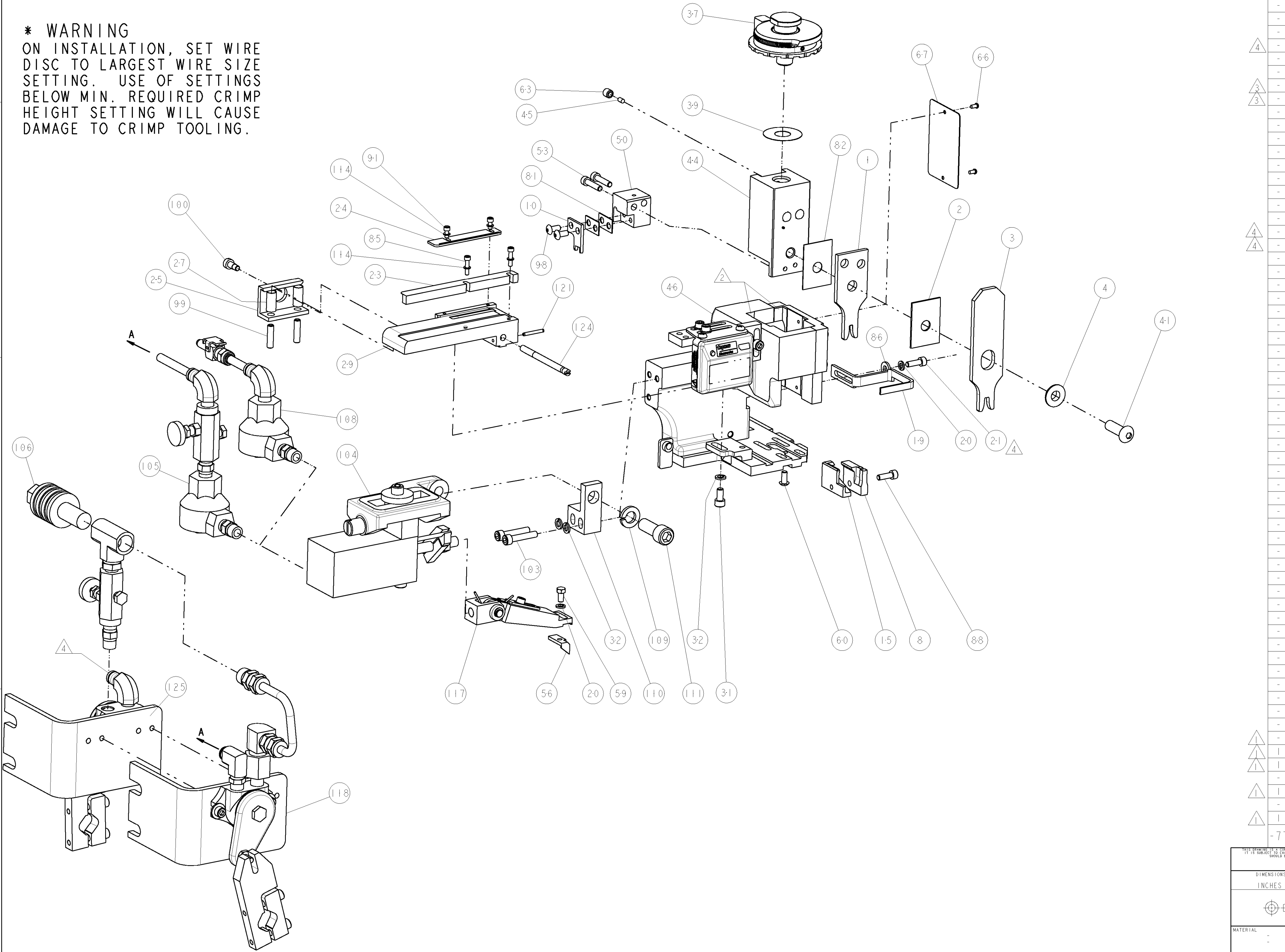

-	-	1	-	-	455350-4	AIR BLAST ASS'Y	125
-	1	1	1	-	690432-3	ADJUSTMENT SCREW	124
-	1	1	1	-	4-21028-0	PIN, SLOTTED SPRING .094 X .750	121
△	18	24	18	IN	27319-4	TUBING, POLY-FLO, NATURAL	119
-	-	1	-	-	692655-6	AIR FEED VALVE ASSEMBLY	118
-	1	1	1	-	461062-1	FEED FINGER ASSEMBLY	117
△	-	-	REF	-	455749-1	GUARD WINDOW	116
△	REF	-	-	-	679532-1	INSERT, GUARD	115
-	4	4	4	-	21024-2	WASHER, SPRG LOCK, REG NO 4	114
-	1	1	1	-	3-21001-5	SCR, SKT HD CAP 3/8-16 X 1.000	111
-	1	1	1	-	459610-1	MOUNT, FEED BRACKET	110
-	1	1	1	-	21024-8	WASHER, SPRG LOCK, REG 3/8	109
-	1	-	1	-	692655-7	AIR FEED VALVE ASSEMBLY	108
-	-	1	-	-	24042-2	VALVE, SLEEVE, 3-WAY	106
-	-	1	-	-	692655-5	AIR FEED VALVE ASSEMBLY	105
-	1	1	1	-	461065-1	ASSEMBLY, AIR FEED	104
-	2	2	2	-	3-21000-9	SCR, SKT HD CAP 10-32 X 1.000	103
-	1	1	1	-	986220-1	CLAMP, CABLE, BLACK	102
△	1	-	1	-	23238-1	INSERT, COUPLING	101
△	1	1	1	-	22353-8	SCR, SHLD, SLOT HD, 3/16 DIA	100
-	2	2	2	-	5-21006-6	SCR, SET, CUP POINT 10-32 X .750	99
-	2	2	2	-	2-21002-1	SCR, BTN SKT HD CAP 8-32 X .375	98
-	2	2	2	-	1-21000-3	SCR, SKT HD CAP 4-40 X .250	91
-	1	1	1	-	2-21000-7	SCR, SKT HD CAP 8-32 X .500	88
-	1	1	1	-	21055-7	WASHER, FLAT, REG NO 10	86
-	2	2	2	-	1-21000-5	SCR, SKT HD CAP 4-40 X .500	85
-	1	1	1	-	455888-4	SPACER, CRIMPER	82
-	2	2	2	-	1-240641-7	SPACER	81
-	1	1	1	-	4088040	SF APPL INST 408-8040	72
-	1	1	1	-	217238-1	GENERAL INSTRUCTION PKG	71
-	1	1	1	-	461264-5	PLATE, IDENTIFICATION	67
-	2	2	2	-	21017-2	SCREW, DRIVE	66
-	1	1	1	-	21009-2	SCR, SET, SELF LOCKING 1/4-20 X .250	63
-	1	1	1	-	22733-8	SCR, BHSC, SELF-LOCKING, 8-32 X .375	60
-	1	1	1	-	2-22603-0	SCR, HEX HD CAP 8-32 X .312	59
-	1	1	1	-	3-694433-9	FEED PAWL	56
-	2	2	2	-	2-21000-9	SCR, SKT HD CAP 8-32 X .750	53
-	1	1	1	-	1583893-6	HOLDER, SLUG BLADE	50
-	1	1	1	-	1633399-1	APPL., BASIC AIR FEED SUB ASSY	46
-	1	1	1	-	690191-1	PLUG,NYLON	45
-	1	1	1	-	455673-1	RAM, SIDE FEED	44
-	1	1	1	-	7-21002-9	SCR, BTN SKT HD CAP 5/16-24 X 1.00	41
-	1	1	1	-	690125-1	SHIM SUB-ASSY	39
-	1	1	1	-	879103-2	FINE ADJUST HEAD ASSEMBLY	37
-	3	3	3	-	21024-5	WASHER, SPRG LOCK, REG NO 10	32
-	1	1	1	-	3-21000-4	SCR, SKT HD CAP 10-32 X .375	31
-	1	1	1	-	2-844048-6	PLATE, REAR STRIP GUIDE	29
-	2	2	2	-	22281-9	SPRING, COMPRESSION	27
-	1	1	1	-	356835-1	LEVER, DRAG RELEASE	26
-	1	1	1	-	240792-1	DRAG, TERMINAL	25
-	1	1	1	-	1-690438-5	FRONT STRIP GUIDE	24
-	1	1	1	-	2-189124-1	GUIDE, FRONT STRIP	23
-	1	1	1	-	2-21000-7	SCR, SKT HD CAP 8-32 X .500	21
-	2	2	2	-	21024-4	WASHER, SPRG LOCK, REG NO 8	20
-	1	1	1	-	1-456468-1	STRIPPER, SPECIAL	19
△	1	1	1	-	1-1633124-1	PLATE, REAR SHEAR	15
△	1	1	1	-	1583859-5	BLADE, SLUG	10
△	1	1	1	-	1633507-9	ANVIL, SPECIAL, COMBINATION	8
-	1	1	1	-	2-238009-9	BLOCK, FL CRIMPER SPACER	4
△	1	1	1	-	4-1633471-6	CRIMPER, INSULATION F	3
-	1	1	1	-	1-455888-0	SPACER, CRIMPER	2
△	1	1	1	-	9-1633305-0	CRIMPER, WIRE PREMIUM	1

THIS DRAWING IS A PROPERTY OF TYCO ELECTRONICS. IT IS TO BE USED ONLY FOR THE APPLICATIONS AND CONDITIONS SPECIFIED HEREON. IT IS NOT TO BE REPRODUCED OR TRANSMITTED IN ANY FORM OR BY ANY MEANS, ELECTRONIC OR MECHANICAL, WITHOUT PERMISSION IN WRITING FROM TYCO ELECTRONICS. ANY UNAUTHORIZED REPRODUCTION OR TRANSMISSION IS PROHIBITED. TYCO ELECTRONICS ASSUMES NO LIABILITY FOR ANY DAMAGE OR LOSS OF PROFITS, INCLUDING CONSEQUENTIAL DAMAGES, ARISING FROM THE USE OF THIS DRAWING.				DWN C. REICHEL		APRIL 2007		tyco Electronics		Tyco Electronics Harrisburg, PA 17105-3608	
DIMENSIONS: INCHES				TOLERANCES UNLESS OTHERWISE SPECIFIED:				CHG T. ELBIN		APRIL 2007	

# Mouser Electronics

Authorized Distributor

Click to View Pricing, Inventory, Delivery & Lifecycle Information:

[TE Connectivity:](#)

[1855258-2](#)