

8				7			
THIS DRAWING IS UNPUBLISHED.				RELEASED FOR PUBLICATION			
COPYRIGHT 20				20			
BY TYCO ELECTRONICS CORPORATION. ALL RIGHTS RESERVED.							
PART NUMBER		REV	FIRST USED	POWER UNIT	FEED TYPE	DESCRIPTION	
1855252-1		C	122500-1	LEADMAKER	AIR FEED	CUTS CARRIER	
1855252-2		C	565435-5	BENCH MODEL K	AIR FEED	CUTS CARRIER	
1855252-3		C	354500-1	BENCH MODEL G	AIR FEED	CUTS CARRIER	
1855252-6		C	122500-1	LEADMAKER	AIR FEED	CONTINUOUS CARRIER	
7-1855252-7		B	-	-	-	SPARE PARTS	

- △ RECOMMENDED SPARE PARTS
- △ GREASE LIGHTLY
- △ GUARD MUST BE IN PLACE WHEN OPERATING APPLICATOR IN A BENCH MACHINE
- △ WHEN RUNNING TERMINAL PN 1949327-1 USE ITEM 119
WHEN RUNNING TERMINAL PN 1949327-2 USE ITEM 34
WHEN RUNNING TERMINAL PN 1949327-3 USE ITEM 120
- △ TERMINAL PN 1949327-1 REQUIRES 1.240 FEED.
TERMINAL PN 1949327-2 REQUIRES .800 FEED.
TERMINAL PN 1949327-3 REQUIRES 1.000 FEED.
ADJUSTMENT IN FEED IS NECESSARY WHEN CHANGING TERMINALS.

*** WARNING**
ON INSTALLATION, SET WIRE DISC TO LARGEST WIRE SIZE SETTING. USE OF SETTINGS BELOW MIN. REQUIRED CRIMP HEIGHT SETTING WILL CAUSE DAMAGE TO CRIMP TOOLING.

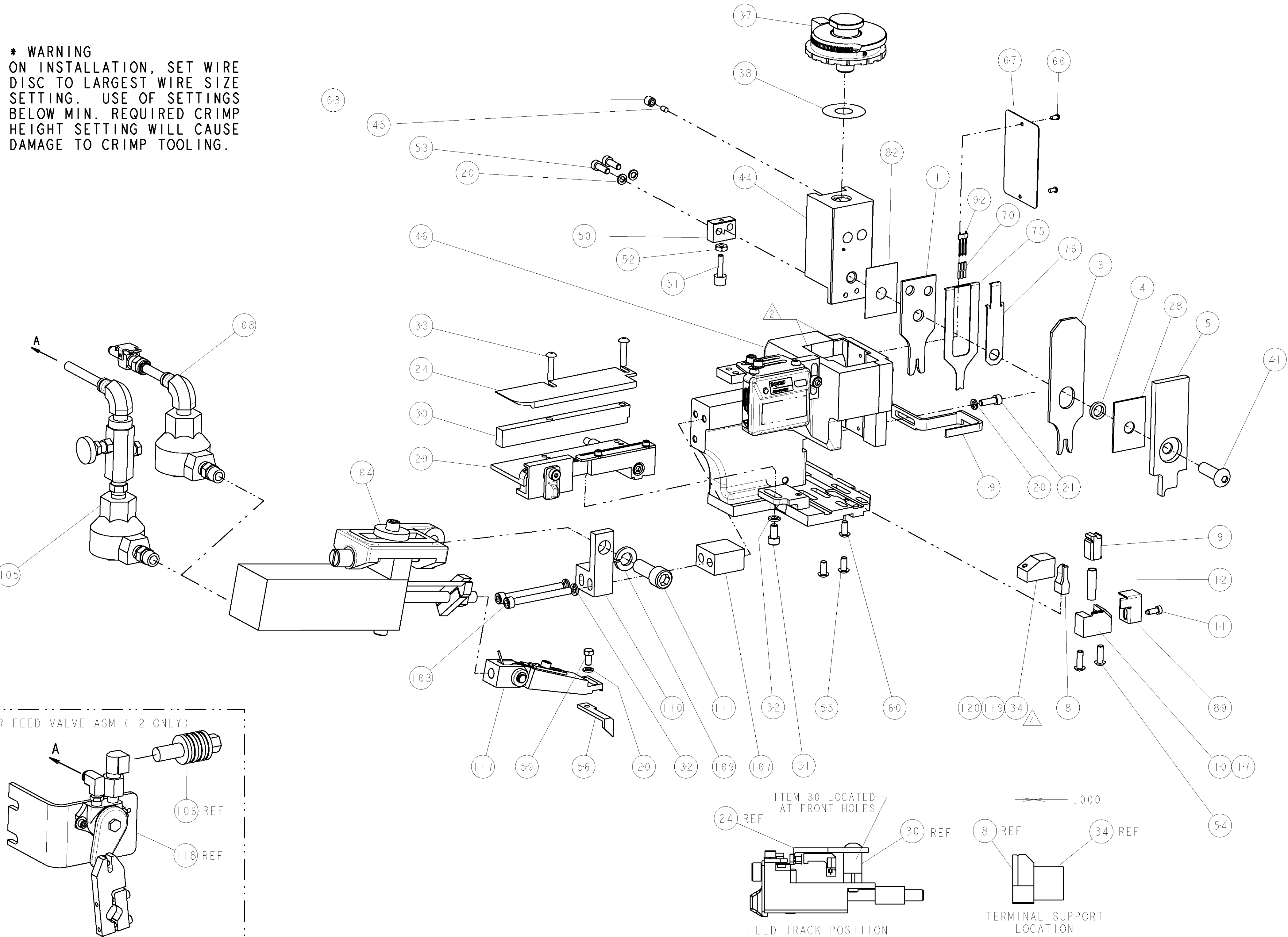

TERMINAL NAME: T-20 MAJOR TERMINAL, SINGLE CRIMP					
TYCO PN	MANUF PN	CHRISTIANA INDUSTRIES TERMINAL - AMP CRIMP SPECS			
1949327-1	1302159			REF SETTING	
1949327-2	1302120	CRIMP HEIGHT		WIRE SIZE	
1949327-3	1302160	2.02±0.05mm [.080±.002]		18AWG	
-	-	1.88±0.05mm [.074±.002]		20AWG	
-	-	-		-	
-	-	-		-	
-	-	CRIMP	SIZE	TYPE	RANGE
-	-	WIRE	1.78mm [.070]	F	20-18 AWG
-	-	INSUL	3.30mm [.130]	F	Ø.110 MAX
WIRE STRIP LENGTH .116 -.131		TERM APPL SPEC NONE	FEED 5	APPLICATOR INSTRUCTIONS 408-8040 SET UP GAGE 458637-1	

LOC		DIST		REV		DATE		DWN		APVD	
A		66		P		LTH		DESCRIPTION		DATE	
				A		RELEASED		17APR2007		MEH	
				B		ECR 07-014018		12JUN2007		MEH	
				C		ECR 07-014378		15JUN2007		MEH	

4	-	1	1	1	1	1	-	5-690786-3	SUPPORT, TERMINAL	120
4	-	1	1	1	1	1	-	5-690786-6	SUPPORT, TERMINAL	119
	-	-	-	REF	-	-	-	692655-6	AIR FEED VALVE ASSEMBLY	118
	-	1	1	1	1	1	-	461062-1	FEED FINGER ASSEMBLY	117
3	-	-	-	REF	-	..	-	455749-1	GUARD WINDOW	116
3	-	-	REF	-	-	..	-	679532-1	INSERT, GUARD	115
	-	1	1	1	1	1	-	3-21001-5	SCR, SKT HD CAP 3/8-16 X 1.000	111
	-	1	1	1	1	1	-	459610-9	MOUNT, FEED BRACKET	110
	-	1	1	1	1	1	-	21024-8	WASHER, SPRG LOCK, REG 3/8	109
	-	1	1	1	1	1	-	692655-7	AIR FEED VALVE ASSEMBLY	108
	-	1	1	1	1	1	-	461690-1	SPACER, AIR FEED	107
	-	-	-	REF	-	-	-	24024-2	VALVE, SHUT OFF	106
	-	-	-	1	-	-	-	692655-5	AIR FEED VALVE ASSEMBLY	105
	-	1	1	1	1	1	-	461065-2	ASSEMBLY, AIR FEED	104
	-	2	2	2	2	2	-	4-21000-3	SCR, SKT HD CAP 10-32 X 2.000	103
	-	1	1	1	1	1	-	1424350-1	HOLDER, PIN, WIRED	92
	-	1	1	1	1	1	-	318563-1	GUARD, FRONT CHIP	89
	-	1	1	1	1	1	-	455888-1	SPACER, CRIMPER	82
	-	1	1	1	1	1	-	1490524-1	DEPRESSOR, SPACER	76
	-	1	1	1	1	1	-	1490525-3	DEPRESSOR, WIRE	75
	-	1	1	1	1	1	-	4088040	SF APPL INST 408-8040	72
	-	1	1	1	1	1	-	217238-1	GENERAL INSTRUCTION PKG	71
	-	3	3	3	3	3	-	2-23147-2	SPRING, COMPRESSION	70
	-	1	1	1	1	1	-	461264-5	PLATE, IDENTIFICATION	67
	-	2	2	2	2	2	-	21017-2	SCREW, DRIVE	66
	-	1	1	1	1	1	-	21009-2	SCR, SET, SELF LOCKING 1/4-20 X .250	63
	-	1	1	1	1	1	-	22733-8	SCR, BHSC, SELF-LOCKING, 8-32 X .375	60
	-	1	1	1	1	1	-	2-22603-0	SCR, HEX HD CAP 8-32 X .312	59
	-	1	1	1	1	1	-	4-694433-7	FEED PAWL	56
	-	2	2	2	2	2	-	2-21002-1	SCR, BTN SKT HD CAP 8-32 X .375	55
	-	2	2	2	2	2	-	2-21002-2	SCR, BTN SKT HD CAP 8-32 X .500	54
	-	2	2	2	2	2	-	2-21000-7	SCR, SKT HD CAP 8-32 X .500	53
	-	1	1	1	1	1	-	21018-5	NUT, HEX, REG 6-32	52
	-	1	1	1	1	1	-	811242-2	BUMPER, HOLD DOWN	51
	-	1	1	1	1	1	-	690753-1	SPACER, TONKER	50
	-	1	1	1	1	1	-	1633399-1	APPL., BASIC AIR FEED SUB ASSY	46
	-	1	1	1	1	1	-	690191-1	PLUG,NYLON	45
	-	1	1	1	1	1	-	1-455673-4	RAM, SIDE FEED	44
	-	1	1	1	1	1	-	7-21002-9	SCR, BTN SKT HD CAP 5/16-24 X 1.00	41
	-	1	1	1	1	1	-	469367-3	SHIM	38
	-	1	1	1	1	1	-	879103-3	FINE ADJUST HEAD ASSEMBLY	37
4	-	1	1	1	1	1	-	1-690786-5	TERMINAL SUPPORT	34
	-	2	2	2	2	2	-	2-21002-4	SCR, BTN SKT HD CAP 8-32 X .750	33
	-	3	3	3	3	3	-	21024-5	WASHER, SPRG LOCK, REG NO 10	32
	-	1	1	1	1	1	-	3-21000-4	SCR, SKT HD CAP 10-32 X .375	31
	-	1	1	1	1	1	-	1320908-8	SPACER, STRIP GUIDE	30
	-	1	1	1	1	1	-	1-1633091-2	ASSEMBLY, STRIP GUIDE	29
	-	1	1	1	1	1	-	1-455888-0	SPACER, CRIMPER	28
	-	1	1	1	1	1	-	1-1320928-3	PLATE, STRIP GUIDE	24
	-	1	1	1	1	1	-	2-21000-7	SCR, SKT HD CAP 8-32 X .500	21
	-	4	4	4	4	4	-	21024-4	WASHER, SPRG LOCK, REG NO 8	20
	-	1	1	1	1	1	-	456468-5	STRIPPER, SPECIAL	19
△	-	1	1	1	1	1	-	679625-1	SHEAR HOLDER, FRONT (NO CUT)	17
△	-	1	1	1	1	1	-	3-22280-3	SPRING, COMPRESSION	12
△	-	1	1	1	1	1	-	690461-1	STOP, SHEAR	11
△	-	1	1	1	1	1	-	690459-1	SHEAR HOLDER, FRONT	10
△	-	1	1	1	1	1	-	462006-1	FLOATING SHEAR, FRONT	9
△	1	1	1	1	1	1	-	2-1633108-0	ANVIL, COMBINATION .070	8
△	-	1	1	1	1	1	-	2-455889-0	DEPRESSOR, SHEAR	5
△	-	1	1	1	1	1	-	1-238011-0	BLOCK, CRIMPER SPACER	4
△	1	1	1	1	1	1	-	4-456134-4	CRIMPER, INSULATION F PREMIUM	3
△	1	1	1	1	1	1	-	456404-5	CRIMPER, WIRE PREMIUM	1

DIMENSIONS:		TOLERANCES UNLESS OTHERWISE SPECIFIED:		DWN		23MAR2007		tyco		Tyco Electronics	
INCHES		9 PLC ±.01		HERR		23MAR2007		Harrisburg, PA 17105-3608			
		1 PLC ±.01		G. BAILEY		23MAR2007		NAME		FINE ADJUST SIDE FEED	
		3 PLC ±.01		T. BENCHOFF		23MAR2007		PRODUCT SPEC		HDM APPLICATOR	
		4 PLC ±.001						APPLICATION SPEC			
MATERIAL		FINISH		WEIGHT		SIZE		CAGE CODE		DRAWING NO	
						A1		00779		C=1855252	
CUSTOMER DRAWING		SCALE		3:5		SHEET		OF		REV	

CUSTOMER VIEWABLE ASSEMBLY

Mouser Electronics

Authorized Distributor

Click to View Pricing, Inventory, Delivery & Lifecycle Information:

[TE Connectivity:](#)

[1855252-6](#)