

LOC	DIST	REVISIONS				
DW		P	LTR	DESCRIPTION	DATE	APVD
				SEE SHEET 1.		

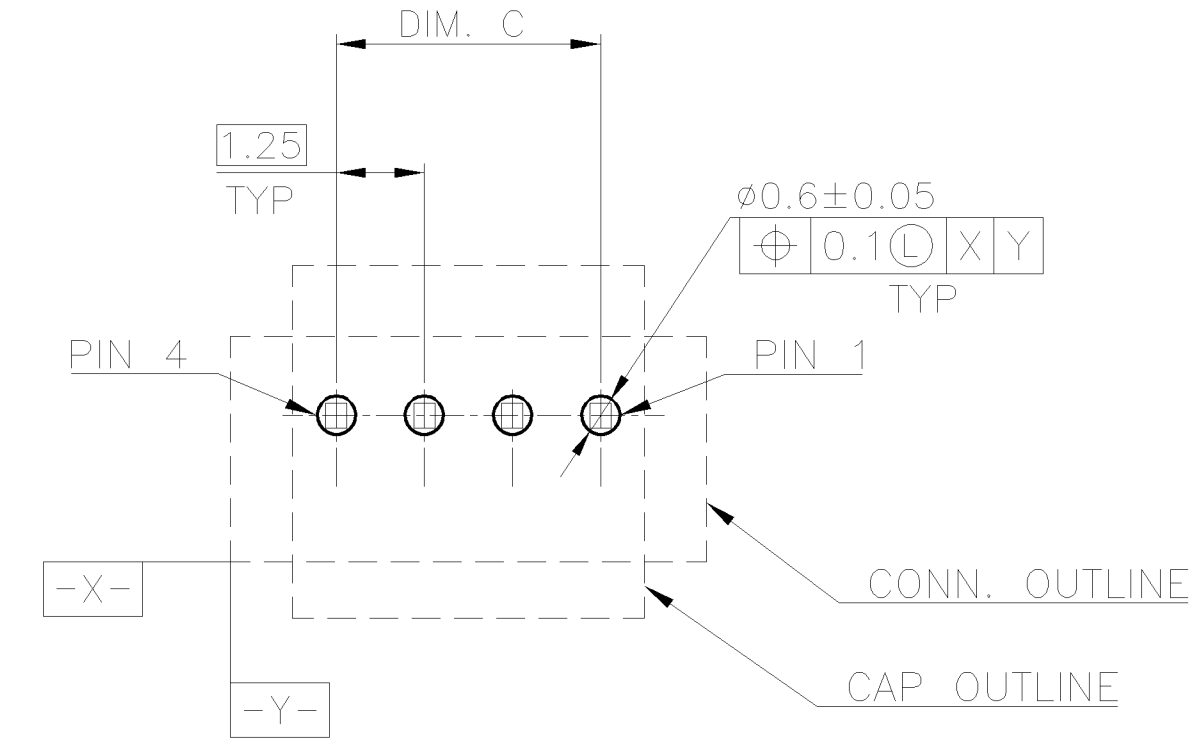
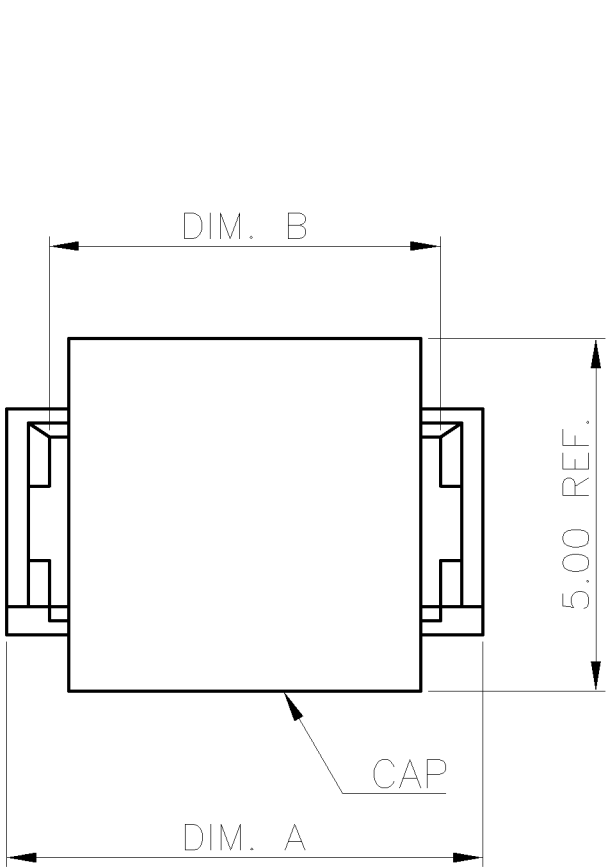

RECOMMENDED P.C.B LAYOUT
(THICKNESS=1.20mm) TOLERANCE±0.05mm

NOTE:

- MATERIAL:
HOUSING: THERMOPLASTIC (PA9T) WITH 30% GF, UL 94V-0, NATURAL COLOR.
CAP: THERMOPLASTIC (LCP) WITH 30% GF, UL 94V-0, BLACK COLOR.
CONTACTS: PHOSPHOR BRONZE.
- FINISH:
CONTACTS: 3.048μm[120μ"] MIN. MATTE-TIN OVER
1.27μm[50μ"]MIN. NICKEL ON ENTIRE CONTACT.
- NO TE LOGO AND DATE CODE ON THE PRODUCT.
- WAVE SOLDER CAPABLE TO 260°C AS TE SPEC. 109-201, CONDITION B.

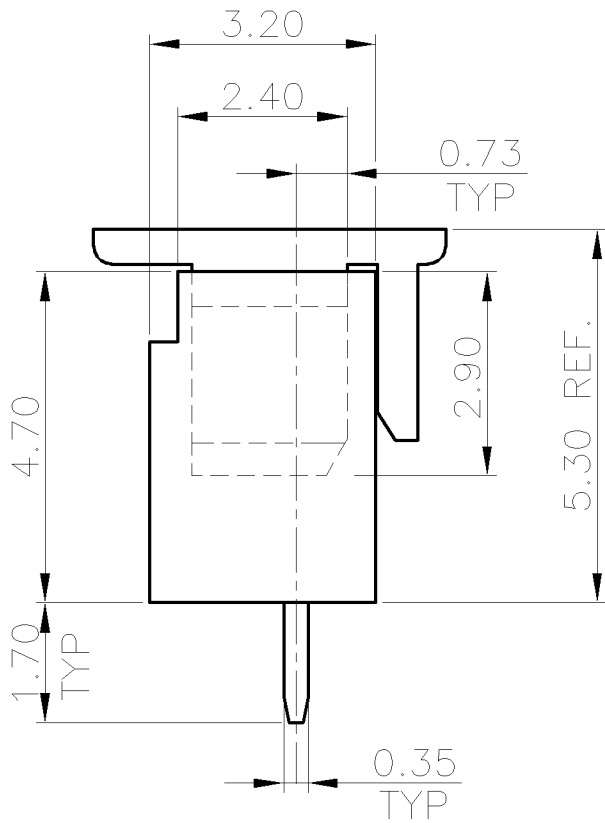
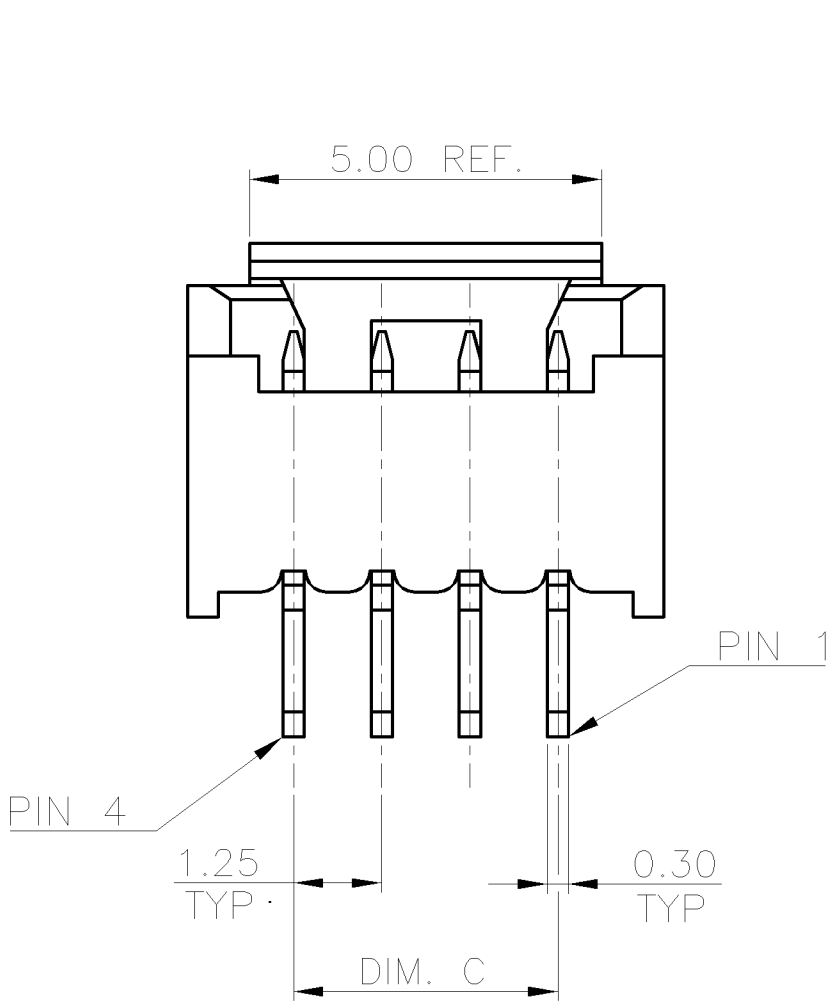

0.16 g	3.75	5.55	6.75	4	1775363-4
WEIGHT	C	B	A	NO. OF CONTACTS	PART NUMBER

THIS DRAWING IS A CONTROLLED DOCUMENT.		<div><div></div><div>Tyco Electronics</div></div>		Tyco Electronics Corporation	
		CHK		Taipei, Taiwan	
DIMENSIONS: MM		APVD		NAME	
		PRODUCT SPEC		1.25 MM PITCH WIRE TO BOARD CONNECTOR, HEADER, DIP, VERTICAL, WITH CAP	
TOLERANCES UNLESS OTHERWISE SPECIFIED:		QUALIFICATION TEST REPORT			
0 PLC ± - 1 PLC ± 0.3 2 PLC ± 0.2 3 PLC ± 0.15 4 PLC ± - ANGLES ± 3°		WEIGHT		SIZE	RESTRICTED TO
MATERIAL		SEE TABLE		CAGE CODE	
SEE NOTE				DRAWING NO	
				A300779	C=1775363
		CUSTOMER DRAWING		SCALE	
				SHEET	2 OF 4
				REV	C

4

3

2

1

LOC	DIST	REVISIONS				
DW		P	LTR	DESCRIPTION	DATE	APVD
				SEE SHEET 1.		

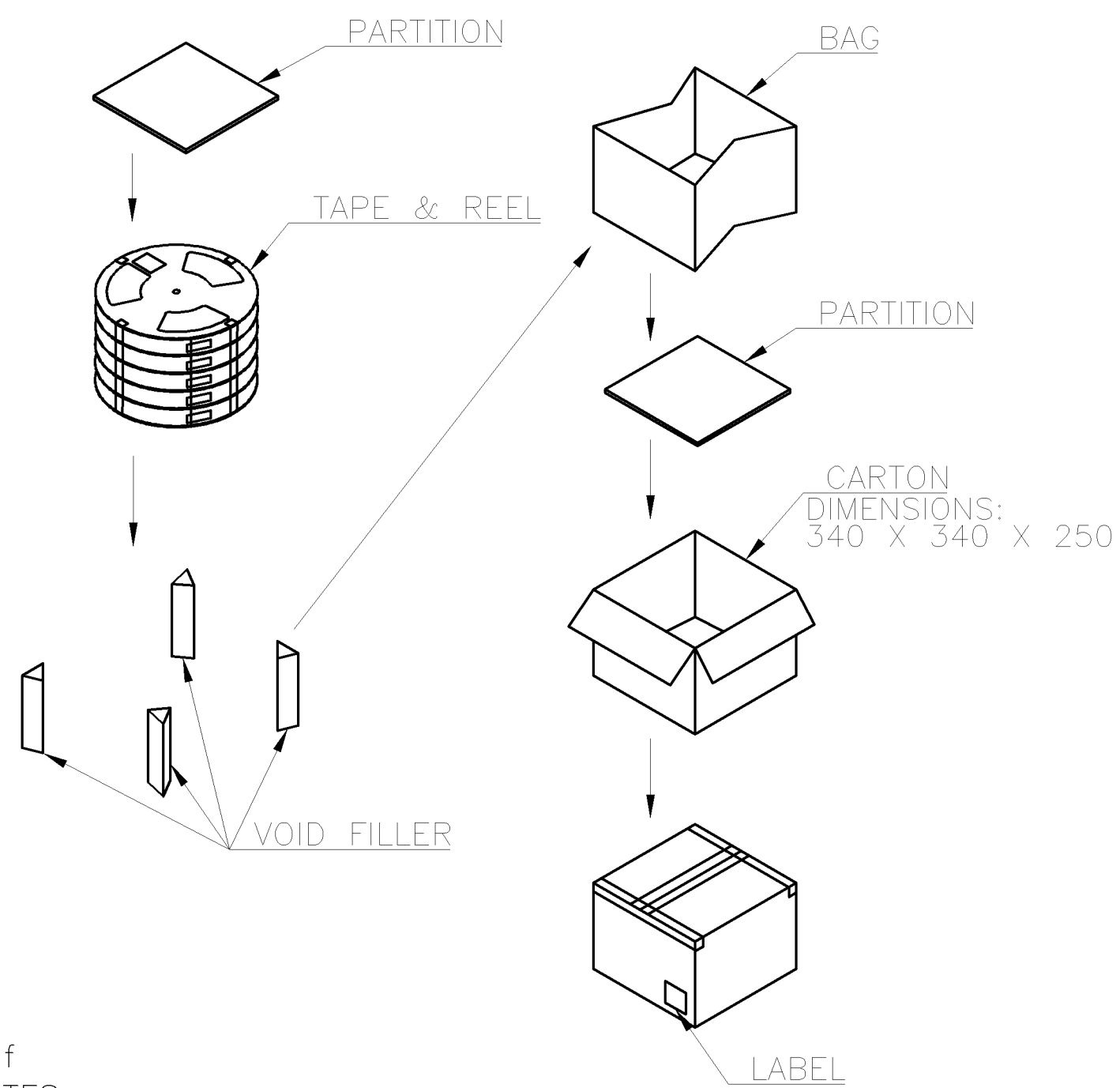
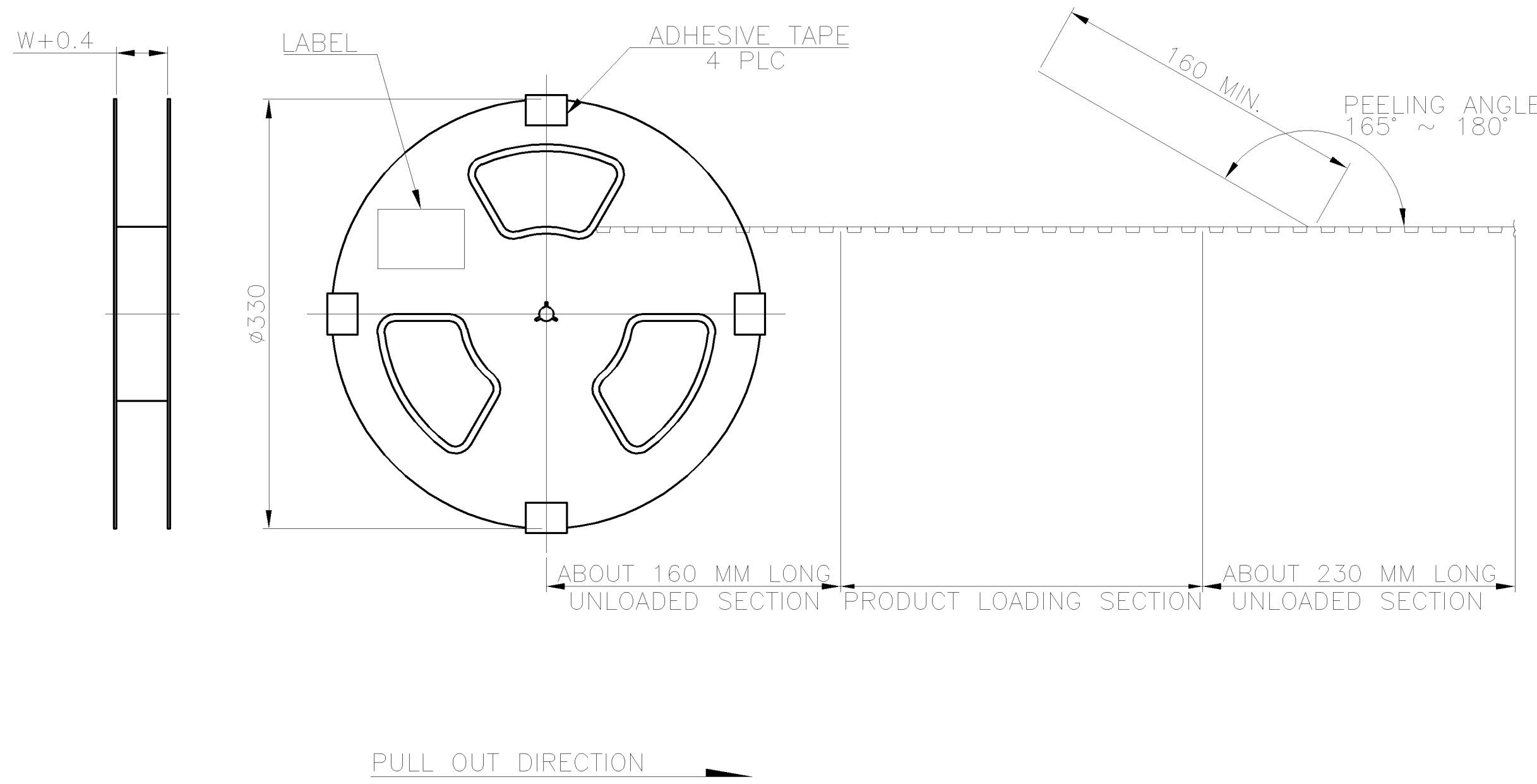

NOTE:
1. PEELING FORCE: 10gf ~ 130gf
2. PEELING SPEED: 300mm/MINUTES.

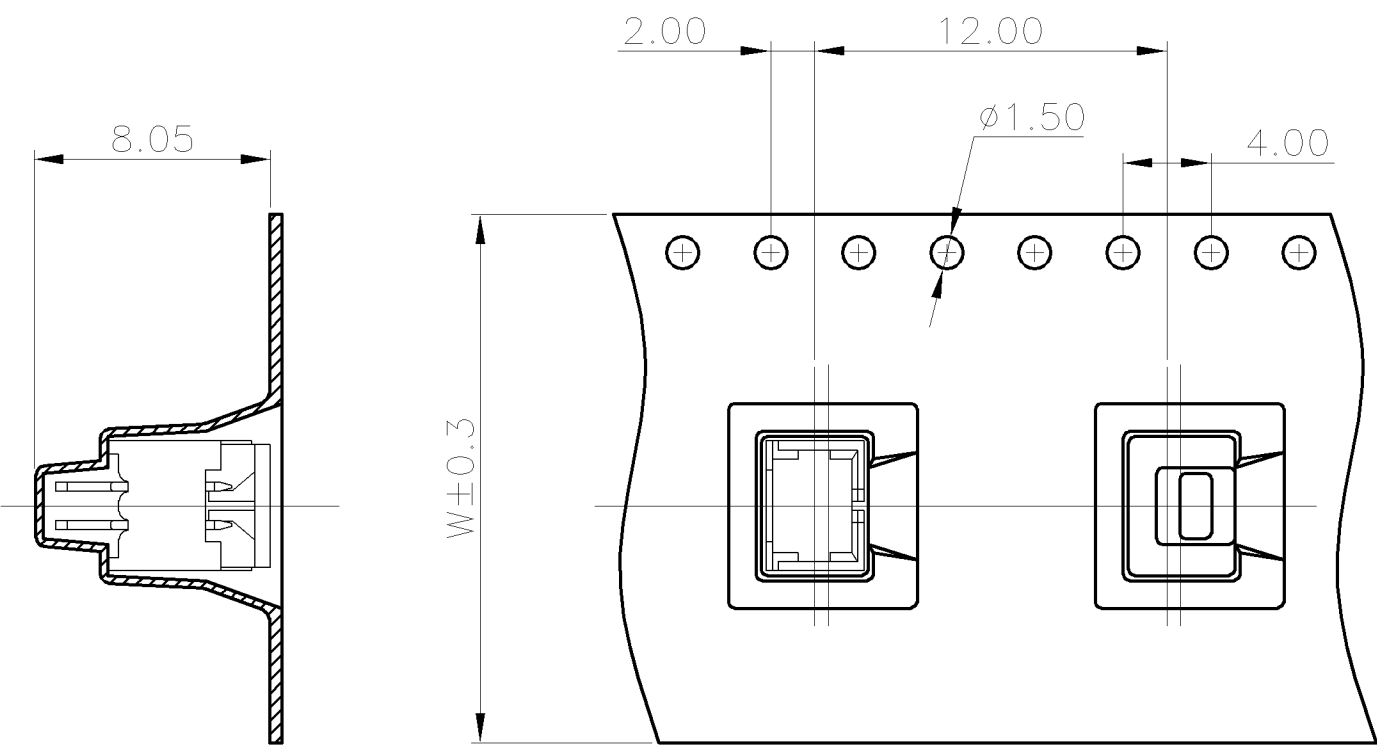

700	7	4900	24	4.56	0.74	3	1775363-3
				4.46	0.64	2	1775363-2
REELS/ CARTON	REELS/ CARTON	QUANTITY	DIM W	G/W (KG)	N/W (KG)	NO. OF CONTACTS	PART NUMBER

THIS DRAWING IS A CONTROLLED DOCUMENT.		DWN	Tyco Electronics Corporation Taipei, Taiwan				
		CHK					
		APVD					
DIMENSIONS: MM		PRODUCT SPEC		NAME			
		QUALIFICATION TEST REPORT		1.25 MM PITCH WIRE TO BOARD CONNECTOR, HEADER, DIP, VERTICAL, WITH CAP			
MATERIAL		WEIGHT		SIZE	CAGE CODE	DRAWING NO	RESTRICTED TO
		CUSTOMER DRAWING		A300779		C=1775363	
				SCALE	SHEET		REV
					3 OF 4		C

Mouser Electronics

Authorized Distributor

Click to View Pricing, Inventory, Delivery & Lifecycle Information:

[TE Connectivity:](#)

[1775363-3](#)