

4

3

2

1

| LOC | DIST | REVISIONS | | | | |
|-----|------|-----------|-----|-----------------------|---------|-------|
| GP | 00 | P | LTR | DESCRIPTION | DATE | APVD |
| | | | C | REV PER ECO-06-006253 | 16MAR06 | RG MP |

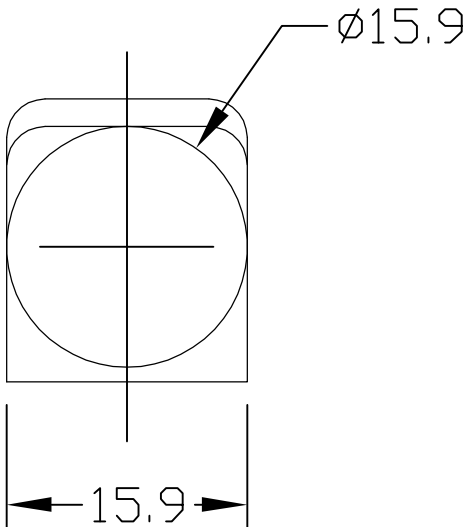

- 5 CABLE ENTRY OF BOOT IS MOULDED SOLID AND CROPPED TO SUIT CABLE USED BY CUSTOMER.
4. MATERIAL: ALL COLORS TO BE FIRE RETARDANT GRADE PVC 55 SHORE A, RATED TO UL94V-0. COLORS: SEE TABLE
3. FINISH: GLOSSY, CLEAN WITH NO INTERNAL & EXTERNAL BURRS.
2. ITEMS PROVIDED TO THIS SPECIFICATION SHALL BE IDENTIFIED ON THE CONTAINER WITH THE FOLLOWING INFORMATION: PART NUMBER & DATE CODE OF MANUFACTURE.
1. PART NUMBER CHANGES AND OR DESIGN CHANGES AFFECTING ITEM INTERCHANGEABILITY REQUIRE PRIOR TYCO APPROVAL AND AUTHORIZATION BY REVISION TO THIS DRAWING.

| | |
|-----------|-------|
| 1651003-4 | BLUE |
| 1651003-3 | GREY |
| 1651003-2 | RED |
| 1651003-1 | BLACK |
| TYCO PN | COLOR |

| | | | | | | | |
|----------------------------------------|--|-------------------------------------------|--|--------------------------------------------------|--|------------------------------|--|
| THIS DRAWING IS A CONTROLLED DOCUMENT. | | DWN 28AUG00 NGUYEN/GRZYBOWSKI | | <div><div>tyco</div><div>Electronics</div></div> | | Tyco Electronics Corporation | |
| | | CHK — | | Harrisburg, PA 17105-3608 | | | |
| DIMENSIONS: mm | | TOLERANCES UNLESS OTHERWISE SPECIFIED: | | NAME | | | |
| | | 0 PLC ± — | | INSULATION BOOT SIZE #4 AND #8 — | | | |
| | | 1 PLC ± .50 | | | | | |
| | | 2 PLC ± .25 | | | | | |
| | | 3 PLC ± — | | | | | |
| 4 PLC ± — | | APVD 25FEB05 | | | | | |
| MATERIAL | | FINISH | | PRODUCT SPEC | | APPLICATION SPEC | |
| — | | — | | — | | — | |
| | | | | WEIGHT — | | RESTRICTED TO | |
| | | | | A300779 | | C-1651003 | |
| CUSTOMER DRAWING | | | | SCALE 1:1 | | SHEET 1 OF 1 | |
| | | | | REV C | | | |

Mouser Electronics

Authorized Distributor

Click to View Pricing, Inventory, Delivery & Lifecycle Information:

[TE Connectivity:](#)

[901-0121-32034](#) [901-0121-32031](#)