

LOC	DIST	REVISIONS					
— —	— —	P	LTR	DESCRIPTION	DATE	DWN	APVD
			C	REV PER ECO 08-024900	10-20-08	CT	KT

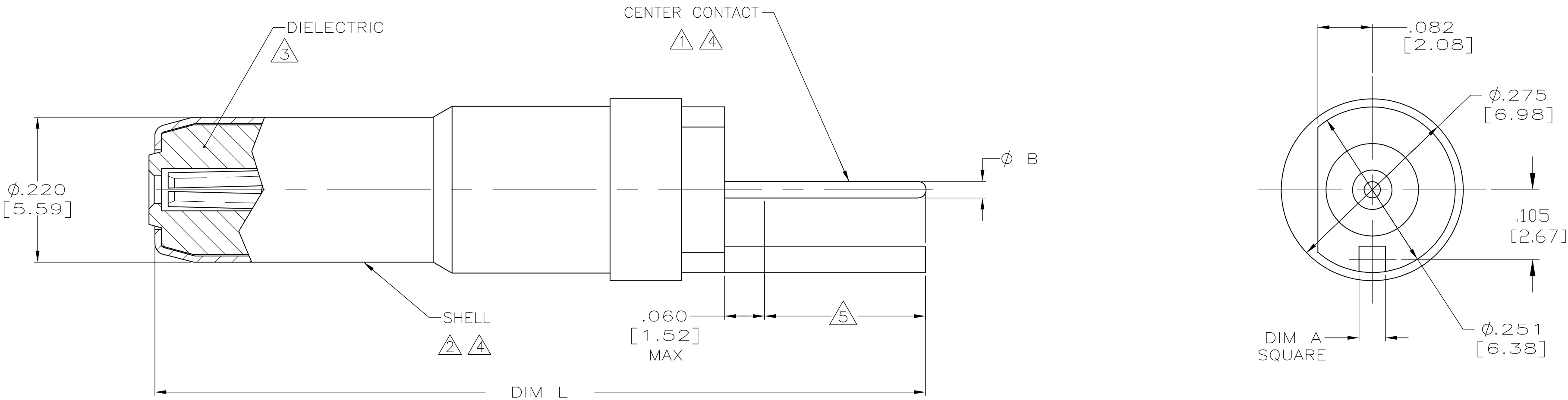

- 1

BERYLLIUM COPPER PER ASTM-B-197 OR ASTM-B-643.
- 2

BRASS PER ASTM-B-16.
- 3

PTFE PER ASTM-D-1710.
- 4

GOLD PLATE PER ASTM-B-488 (MIL-G-45204), TYPE 2, GRADE C, .000050 [0.00127] MIN THK OVER NICKEL PLATE PER QQ-N-290, .000050 [0.00127] MIN THK.
- 5

THIS AREA IS SOLDER DIPPED. (-4 ONLY)

.020±.002 [0.51±0.05]	.040±.003 [1.02±0.08]	NO	1.205 [30.61]	1484201-5
.026 [0.66] MAX	.047 [1.19] MAX	YES	1.277 [32.44]	1484201-4
.020±.002 [0.51±0.05]	.040±.003 [1.02±0.08]	NO	1.277 [32.44]	1484201-3
.020±.002 [0.51±0.05]	.040±.003 [1.02±0.08]	NO	1.249 [31.72]	1484201-2
.020±.002 [0.51±0.05]	.040±.003 [1.02±0.08]	NO	1.158 [29.41]	1484201-1
DIM B	DIM A	SOLDER DIPPED	L±.020 [±0.51]	PART NUMBER

THIS DRAWING IS A CONTROLLED DOCUMENT.		DWN	1-10-02	<div><div><div></div><div>Tyco</div><div>Electronics</div></div><div>Tyco Electronics Corporation Harrisburg, PA 17105-3608</div></div>			
		CHK	1-10-02				
DIMENSIONS: INCHES [mm]		TOLERANCES UNLESS OTHERWISE SPECIFIED:		NAME			
		0 PLC ± - 1 PLC ± - 2 PLC ± - 3 PLC ± .005 [0.13] 4 PLC ± - ANGLES ± - FINISH		PRODUCT SPEC			
				APPLICATION SPEC			
MATERIAL		WEIGHT		SIZE	CAGE CODE	DRAWING NO	RESTRICTED TO
SEE CALLOUTS		-		A2	00779	C=1484201	-
		CUSTOMER DRAWING		SCALE	8:1	SHEET	1 of 1
				REV		C	

Mouser Electronics

Authorized Distributor

Click to View Pricing, Inventory, Delivery & Lifecycle Information:

[TE Connectivity:](#)

[1484201-2](#)