

4

3

2

1

THIS DRAWING IS UNPUBLISHED.

RELEASED FOR PUBLICATION

© COPYRIGHT

ALL RIGHTS RESERVED.

LOC

DIST

REVISIONS

| P | LTR | DESCRIPTION | DATE | DWN | APVD |
|---|-----|---------------|-----------|-----|------|
| | A2 | ECR-14-002795 | 26FEB2014 | GK | HMR |
| | | | | | |
| | | | | | |
| | | | | | |

REPLACED BY OCEAN STYLE APPLICATOR PART
NUMBER 2150247-1

FOR REPLACEMENT PARTS FOR APPLICATOR 1339612
REFER TO ADDITIONAL PAGE(S). SPARE PARTS KIT (IF LISTED)
WILL REMAIN AVAILABLE.

THE REPLACEMENT OCEAN STYLE APPLICATOR HAS THE
SAME TERMINATOR/PRESS INTERFACE AS APPLICATOR
1339612

| | | | | | | |
|--|--|------------------|------------------|-------|--------------|--|
| THIS DRAWING IS A CONTROLLED DOCUMENT. | | DWN | GOPALAKRISHNA HV | | | |
| | | CHK | RAGHAVENDRA | | | |
| | | APVD | RAGHAVENDRA | | | |
| | | PRODUCT SPEC | | | | |
| | | APPLICATION SPEC | | | | |
| | | WEIGHT | | | | |
| | | CUSTOMER DRAWING | | SCALE | SHEET 1 OF 2 | |
| | | | | REV | A2 | |

| | | | |
|--------------------------|-----------|------------|---------------|
| TE Connectivity | | | |
| END FEED HD-I APPLICATOR | | | |
| SIZE | CAGE CODE | DRAWING NO | RESTRICTED TO |
| A3 | | ©- 1339612 | |

| | |
|---|---|
| DIMENSIONS: | TOLERANCES UNLESS OTHERWISE SPECIFIED: |
|  | 0 PLC ± 1 PLC ± 2 PLC ± 3 PLC ± 4 PLC ± ANGLES ± |
| MATERIAL | FINISH |



1. RECOMMENDED SPARE PARTS.
2. GREASE RAM, CAM, CAM FOLLOWER AND FEED ROD LIGHTLY.
3. LUBRICATE DAILY PER THE APPLICATOR INSTRUCTION SHEET SUPPLIED WITH THE APPLICATOR.
4. CERTAIN TERMINALS REQUIRE LUBRICATION. REFER TO THE APPLICATOR INSTRUCTION SHEET FOR MORE INFORMATION.
5. CUT TO LENGTH AT ASSY

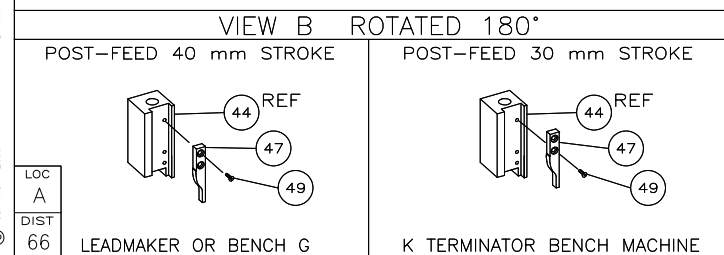
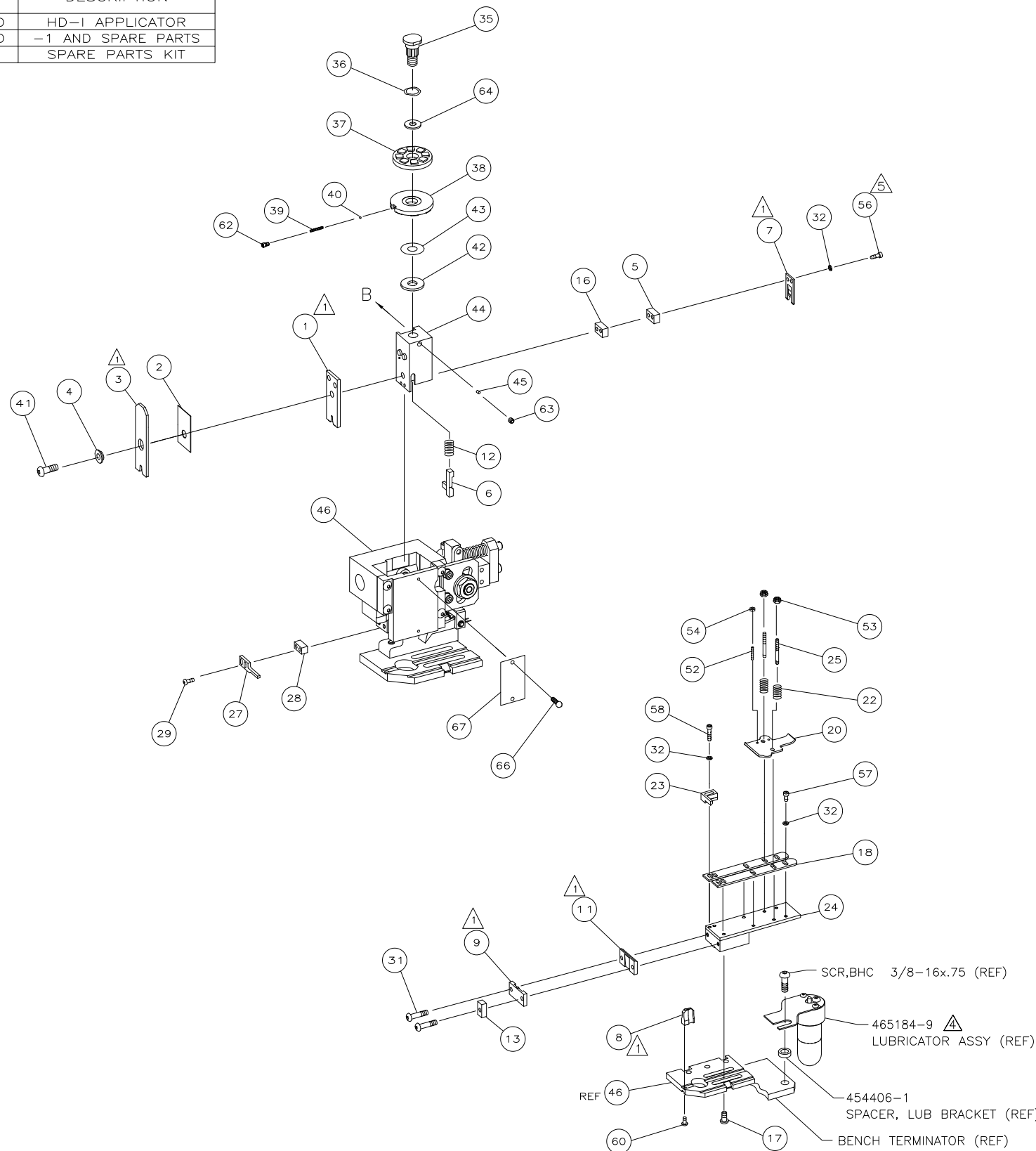

| | | | | | | |
|---|------|-----|-------|-------------|------------------------------|---------|
| | - | 1 | 1 | 1339612 | PRINT, APPLICATOR LOG SHEET | 72 |
| | - | 1 | 1 | 1338705-2 | DOCUMENTATION PACKAGE | 71 |
| | | | | | | 70 |
| | | | | | | 69 |
| | | | | | | 68 |
| | - | 1 | 1 | 461264-1 | PLATE, IDENTIFICATION | 67 |
| | - | 2 | 2 | 21017-2 | SCR,DRIVE(#2X.19)ID PLATE | 66 |
| | | | | | | 65 |
| | - | 1 | 1 | 986950-1 | WASHER, FLAT PRECISION | 64 |
| | - | 1 | 1 | 3-18031-0 | SCR,SKT SET(M6X6)RAM | 63 |
| | - | 1 | 1 | 18023-9 | SCR,SKT CAP(M4X6)CP DSC | 62 |
| | | | | | | 61 |
| | - | 1 | 1 | 18024-7 | SCR,BHC(M4X10)ANVIL | 60 |
| | | | | | | 59 |
| | - | 2 | 2 | 1-18023-3 | SCR,SHC(M4X16)HOLD DOWN | 58 |
| | - | 5 | 5 | 18023-9 | SCR,SHC(M4X6)STRIP GUIDE | 57 |
| | - | 2 | 2 | 9-18023-6 | SCR,SHC(M4X14)SLUG BLADE | 56 |
| | | | | | | 55 |
| | - | 2 | 2 | 18029-1 | NUT,HEX(M3)DRAG | 54 |
| | - | 2 | 2 | 986965-1 | NUT,HEX SL(M4)DRAG STUD | 53 |
| | - | 2 | 2 | 2-18032-2 | SCR,SKT SET(M3X10)DRAG | 52 |
| | | | | | | 51 |
| | | | | | | 50 |
| | - | 1 | 1 | 18024-3 | SCR,BHC(M3X10)CAM | 49 |
| | | | | | | 48 |
| | - | 1 | 1 | 1338676-1 | CAM, POST-FEED 30 & 40 mm ST | 47 |
| | - | 1 | 1 | 1338662-2 | APPLICATOR, BASIC (SUBASSY) | 46 |
| | - | 1 | 1 | 690191-1 | PLUG, NYLON | 45 |
| | - | 1 | 1 | 1320998-1 | RAM | 44 |
| | - | 1 | 1 | 690125-1 | WASHER, LAMINATED | 43 |
| | - | 1 | 1 | 690124-9 | WASHER, RAM | 42 |
| | - | 1 | 1 | 2-18024-6 | SCREW,BHC(M8X25)CRIMPER | 41 |
| | - | 1 | 1 | 23241-1 | BALL, STEEL | 40 |
| | - | 1 | 1 | 2-22278-7 | SPRING, COMPRESSION | 39 |
| | - | 1 | 1 | 1320922-1 | DISC, INSULATION | 38 |
| | - | 1 | 1 | 354777-1 | WIRE DISC, PLASTIC | 37 |
| | - | 1 | 1 | 22480-5 | WASHER, SPRING | 36 |
| | - | 1 | 1 | 690212-1 | POST, RAM | 35 |
| | | | | | | 34 |
| | | | | | | 33 |
| | - | 9 | 9 | 18025-2 | WASHER,LOCK(M4)SHEAR BL | 32 |
| | - | 2 | 2 | 1-18024-0 | SCR,BHC(M4X20)SHEAR PL | 31 |
| | | | | | | 30 |
| | - | 2 | 2 | 18024-8 | SCR,BHC(M4X12)STRIPPER | 29 |
| | - | 1 | 1 | 3-690451-2 | SPACER, STRIPPER | 28 |
| | - | 1 | 1 | 240639-1 | STRIPPER | 27 |
| | | | | | | 26 |
| | - | 2 | 2 | 1320906-1 | DRAG, STUD | 25 |
| | - | 1 | 1 | 1320995-3 | STRIP GUIDE | 24 |
| | - | 1 | 1 | 240825-3 | PLATE, STRIP HOLD DOWN | 23 |
| | - | 2 | 2 | 4-22281-1 | SPRING, DRAG | 22 |
| | | | | | | 21 |
| | - | 1 | 1 | 1338665-1 | DRAG, STOCK | 20 |
| | | | | | | 19 |
| | - | 2 | 2 | 1338663-6 | GUIDE, LOWER STRIP | 18 |
| | - | 4 | 4 | 1-18024-8 | SCR,BHC(M6X12)STRIP GD PL | 17 |
| | - | 1 | 1 | 1338708-1 | SPACER, SLUG BLADE | 16 |
| | | | | | | 15 |
| | | | | | | 14 |
| | - | 1 | 1 | 690481-7 | SPACER, HOLD DOWN | 13 |
| | - | 1 | 1 | 23846-1 | SPRING, HOLD DOWN | 12 |
| | - | 1 | 1 | 240833-2 | PLATE, REAR SHEAR | 11 |
| | | | | | | 10 |
| | - | 1 | 1 | 690496-4 | PLATE, FRONT SHEAR | 9 |
| | 1 | 2 | 1 | 1333220-8 | ANVIL | 8 |
| | - | 1 | 1 | 690474-3 | BLADE, SLUG | 7 |
| | - | 1 | 1 | 1-455892-1 | HOLD DOWN, TERMINAL | 6 |
| | - | 1 | 1 | 2-240641-4 | SPACER, SLUG BLADE | 5 |
| | - | 1 | 1 | 238009-2 | SPACER, BLOCK CRIMPER | 4 |
| | 1 | 2 | 1 | 1-1213077-3 | CRIMPER, INSULATION | 3 |
| | - | 1 | 1 | 455888-4 | SPACER, CRIMPER | 2 |
| | 1 | 2 | 1 | 456409-7 | CRIMPER, WIRE | 1 |
| | -77 | -71 | -1 | PART NO | DESCRIPTION | ITEM NO |
| REVISION OF EACH ASSY NO (WHEN BLANK, USE DWG REVISION) | | | | | | |
| PARTS LIST | | | | | | |
| D PER ASSY | MATL | | HT TR | | FIN | |
| S: mm [INCHES] | | | | | | |
| SCALE PRINT. | | | | | | |
| S UNLESS SPECIFIED: | | | | | | |
| ± | | | | | | |
| ± | | | | | | |
| ± | | | | | | |
| ± | | | | | | |
| ± | | | | | | |
| ± | | | | | | |
| ± | | | | | | |
| ± | | | | | | |
| ± | | | | | | |
| ± | | | | | | |
| ± | | | | | | |
| ± | | | | | | |
| ± | | | | | | |
| ± | | | | | | |
| ± | | | | | | |
| ± | | | | | | |
| ± | | | | | | |
| ± | | | | | | |
| ± | | | | | | |
| ± | | | | | | |
| ± | | | | | | |
| ± | | | | | | |
| ± | | | | | | |
| ± | | | | | | |
| ± | | | | | | |
| ± | | | | | | |
| ± | | | | | | |
| ± | | | | | | |
| ± | | | | | | |
| ± | | | | | | |
| ± | | | | | | |
| ± | | | | | | |
| ± | | | | | | |
| ± | | | | | | |
| ± | | | | | | |
| ± | | | | | | |
| ± | | | | | | |
| ± | | | | | | |
| ± | | | | | | |
| ± | | | | | | |
| ± | | | | | | |
| ± | | | | | | |
| ± | | | | | | |
| ± | | | | | | |
| ± | | | | | | |
| ± | | | | | | |
| ± | | | | | | |
| ± | | | | | | |
| ± | | | | | | |
| ± | | | | | | |
| ± | | | | | | |
| ± | | | | | | |
| ± | | | | | | |
| ± | | | | | | |
| ± | | | | | | |
| ± | | | | | | |
| ± | | | | | | |
| ± | | | | | | |
| ± | | | | | | |
| ± | | | | | | |
| ± | | | | | | |
| ± | | | | | | |
| ± | | | | | | |
| ± | | | | | | |
| ± | | | | | | |
| ± | | | | | | |
| ± | | | | | | |
| ± | | | | | | |
| ± | | | | | | |
| ± | | | | | | |
| ± | | | | | | |
| ± | | | | | | |
| ± | | | | | | |
| ± | | | | | | |
| ± | | | | | | |

Mouser Electronics

Authorized Distributor

Click to View Pricing, Inventory, Delivery & Lifecycle Information:

[TE Connectivity:](#)

[1339612-1](#)