

4

3

2

1

THIS DRAWING IS UNPUBLISHED. RELEASED FOR PUBLICATION 12, 2002.
 © COPYRIGHT 2002 BY TYCO ELECTRONICS CORPORATION. ALL RIGHTS RESERVED.

LOC	DIST	REVISIONS			
P	LTR	DESCRIPTION	DATE	DWN	APVD
A	40	E	ECN 0150-0589-02	4-02	WH RS

1. TORQUE 8.0 IN-LBS $\begin{matrix} +1.5 \\ -0.5 \end{matrix}$ IN-LBS BIDIRECTIONAL
2. 5/16" WRENCH HEAD 1055265-1
3. PREVIOUS PART NUMBER 2098-0275-50

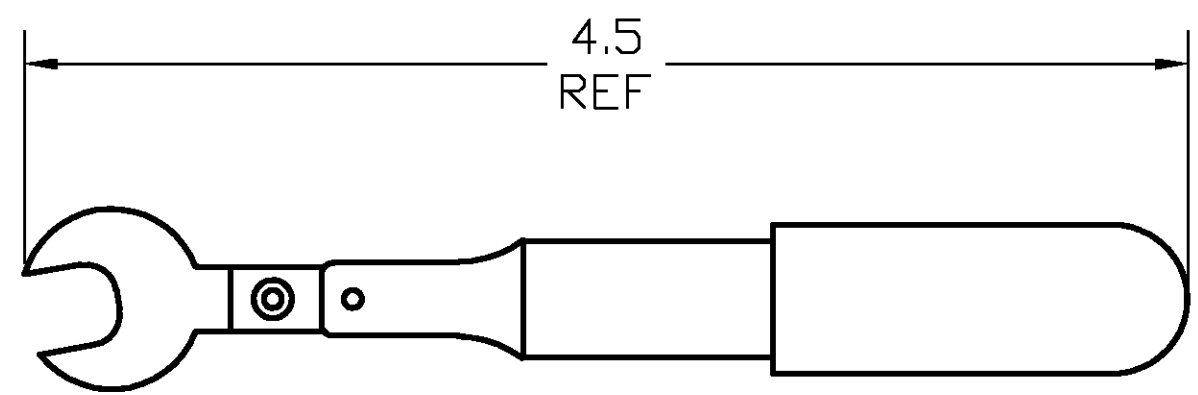

THIS DRAWING IS A CONTROLLED DOCUMENT.		DWN	DAVID STULL	12/12/02	tyco Electronics	Tyco Electronics Corporation	
		CHK	DAVID STULL	12/12/02		Harrisburg, PA 17112	
		APVD	R.SCHAEFFER	12/12/02	NAME		
		PRODUCT SPEC	408-8640				
		APPLICATION SPEC	-				
		WEIGHT	.30 LBS.	SIZE	A3	CAGE CODE	00779
		CUSTOMER DRAWING		DRAWING NO	1055258		RESTRICTED TO
				SCALE	1:1	SHEET	1 OF 1
				REV	E		

DIMENSIONS:		TOLERANCES UNLESS OTHERWISE SPECIFIED:	
INCHES		0 PLC	± -
		1 PLC	± -
		2 PLC	± -
		3 PLC	± -
		4 PLC	± -
		ANGLES	± -
MATERIAL	-	FINISH	NICKEL PLATING

D
C
B
A

D
C
B
A

Mouser Electronics

Authorized Distributor

Click to View Pricing, Inventory, Delivery & Lifecycle Information:

[TE Connectivity:](#)

[2098-0275-54](#)