

3D VIEW

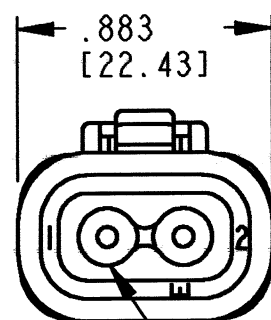

E-SEAL GROMMET 7

7 SHRINK BOOT

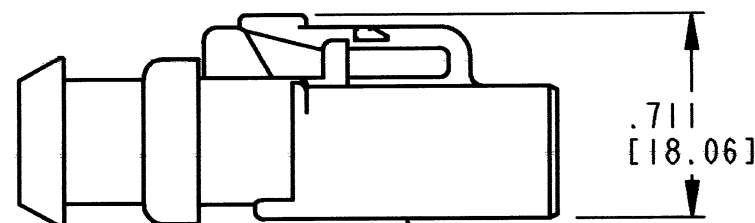
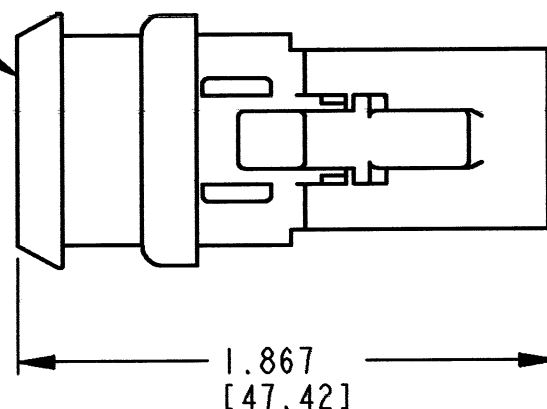

PLUG

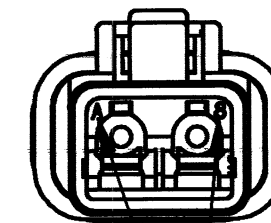

DATE CODE: MONTH IS REPRESENTED BY SEQUENTIAL ALPHA CHARACTERS. EX: A=JANUARY; YEAR IS REPRESENTED BY LAST NUMERICAL DIGIT. EX: 8=2008

7. MODIFICATION: PLUG IS BLACK, GROMMET IS AN E-SEAL, SHRINK BOOT.

6. MATERIAL: HOUSING: PLASTIC; GROMMET: RUBBER

5. PART DESIGNED TO BE USED WITH DTP04-2P-**** RECEPTACLES. (****) = ALL HIGH TEMPERATURE MODIFICATIONS. CONSULT FACTORY FOR MODIFICATIONS.

4. FOR CONTACT AND WIRE PERFORMANCE AND APPLICATION CHARACTERISTICS SEE ENVELOPE DRAWING 0425-015-0000.

3. SECONDARY WEDGE LOCK SOLD SEPARATELY, WP-2S.

2. DIMENSION TOLERANCE: $\pm .025$ [.64].

1. DIMENSIONS ARE IN INCHES [mm].

NOTES: UNLESS OTHERWISE SPECIFIED

REV
A

DTP06-2S-CE09

REVISIONS

SYM	DESCRIPTION	DATE	APPROVED
NC	NEW RELEASE PER E.O. P19839	5/13/08	R.D.R.
A	REVISED PER E.O. P20259	4-16-10	RDR

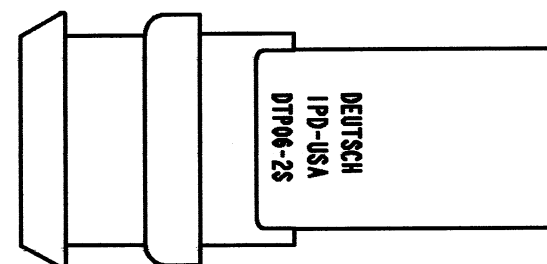

CONTACT SIZE	MIN. INSUL. O.D.	MAX INSUL. O.D.	WIRE RANGE [mm ²] REF ONLY 4
12	.097 [2.46]	.158 [4.01]	12-14 AWG [3.0-2.0]

SIGNATURE & DATE	
DR	P. CARNAHAN 04/21/08
CHK	B. Dylor 4/16/10
PE	R. Milligan 3/10/10
APPD	J. Beaul 4-15-10
SCALE	NONE WT

PLUG
2 CONTACTS, SIZE 12
COLOR: BLACK, E-SEAL
-CE09 MOD
DTP SERIES

ENVELOPE

EP	MATL. CODE
3850 INDUSTRIAL AVE. HEMET, CA 92545	
DEUTSCH INDUSTRIAL	
B	DTP06-2S-CE09
DWG SIZE	CODE 11139 SHEET 1 OF 1

Mouser Electronics

Authorized Distributor

Click to View Pricing, Inventory, Delivery & Lifecycle Information:

[TE Connectivity:](#)

[DTP06-2S-CE09](#)