

REVISIONS			
REV	DESCRIPTION	DATE	APPV
A	INITIAL RELEASE OF LINX INTERNAL DRAWING	01/MAR/19	CLL

NOTES: (UNLESS OTHERWISE SPECIFIED)

1. ALL DIMENSIONS ARE IN MILLIMETERS [IN].
2. DIMENSIONS APPLY AFTER FINISHING.
3. MANUFACTURE TO BE COMPLIANT WITH EU RoHS DIRECTIVE, USE MATERIALS THAT DO NOT CONTAIN REACH SUBSTANCES OF VERY HIGH CONCERN >1000ppm, AND USE DRC CONFLICT-FREE SOURCED MATERIALS.
4. ELECTRICAL SPECIFICATIONS ARE LISTED FOR REFERENCE ONLY. SEE LINX DATA SHEET FOR CURRENT PROPERTIES.
 1. IMPEDANCE: 50Ω
 2. FREQUENCY RANGE: 0 TO 6 GHz
5. MECHANICAL SPECIFICATIONS:
 1. TEMPERATURE RANGE: -55°C TO +155°C
 2. RECOMMENDED TORQUE: 0.57 Nm (5 in lbs)
 3. CONNECTOR DURABILITY: 500 CYCLES MIN.
 4. INTERFACE: SMA TYPE IAW MIL-STD-348B
6. PRODUCT QUALIFIED IAW LINX TEST PLAN AT CURRENT REVISION.
7. UNLISTED DIMENSIONS ARE CONTROLLED BY SOLID MODEL AT LATEST REVISION.
8. LABEL LOT BAG AND BOX IAW LINX LABEL DRAWING [MEC-LBL-4x2.5-PAPER-ID]

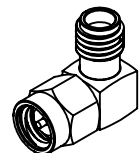
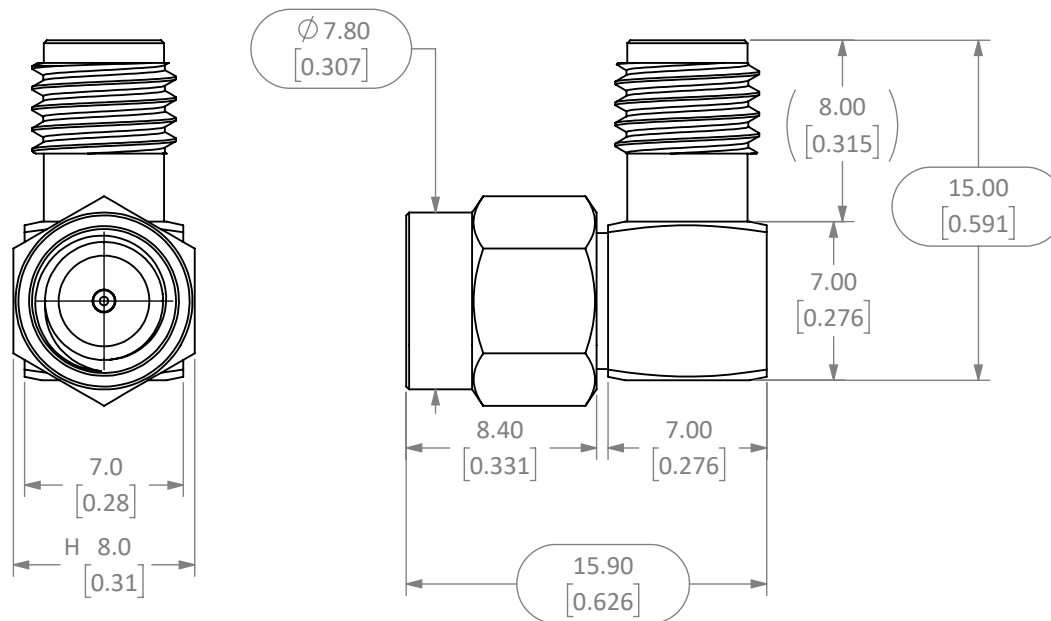

SCALE 1:1

WARNING: THIS DRAWING CONTAINS PROPRIETARY INFORMATION THAT IS THE SOLE PROPERTY OF LINX TECHNOLOGIES, AND SHALL BE TREATED AS SUCH. NO DISCLOSURE OR REPRODUCTION OF THIS DOCUMENT IS PERMITTED, IN WHOLE OR IN PART, WITHOUT THE EXPRESS WRITTEN PERMISSION OF LINX TECHNOLOGIES OR ITS DESIGNATED AGENTS.

MATERIAL:	INTERPRET DIMENSIONS AND TOLERANCES PER ASME Y14.5.		PROJECTION:
BRASS	.X ± 3.0	ANGLES: $\pm 1^\circ$	
BeCu, PTFE	.XX $\pm .50$	SURFACE: $\sqrt{32}$	
	.XXX $\pm .100$		
FINISH:	DRAWN: M. SCHULTE	DT: 21/JAN/19	
SEE TABLE	ENGR: DASARATHAN	DT:	
GOLD			

LINX PART NUMBER	FINISH
CONSMA010	NICKEL
CONSMA010-G	GOLD



159 ORT LANE
MERLIN, OR 97532

TITLE:		
CONNECTOR IN-LINE SMA RA JACK TO PLUG		
SIZE	DWG. NO.	REV
A	C-CONSMA010-X	A
SCALE: 3:1	DO NOT SCALE DRAWING	SHEET 1 OF 1

Mouser Electronics

Authorized Distributor

Click to View Pricing, Inventory, Delivery & Lifecycle Information:

[TE Connectivity:](#)

[CONSMA010-G](#)