

ITEM NUMBER	DESCRIPTION
1	CONNECTOR, LINX PART CONREVSMA014-178 OR EQUIVILANT SEE PART MOR MATERIALS
2	HEAT SHRINK POLYOL BLACK FOR .270Ø
3	NUT, 1/4-36X1.7mm THK NIC/BRASS
4	WASHE, 1/4" ID TOOTH, NIC/BRASS
5	O-RING, .5 X 1.4mm SIL, BLACK
6	CABLE , COAX, RG174, BLACK

REVISIONS			
REV	DESCRIPTION	DATE	APPV
B	UPDATED DRAWING TO REFLECT UPDATED DRAWING STANDARDS. ADDED NOTES 4-11	JHAGER 10/25/21	

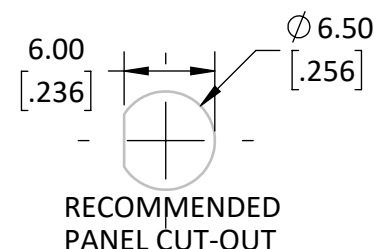
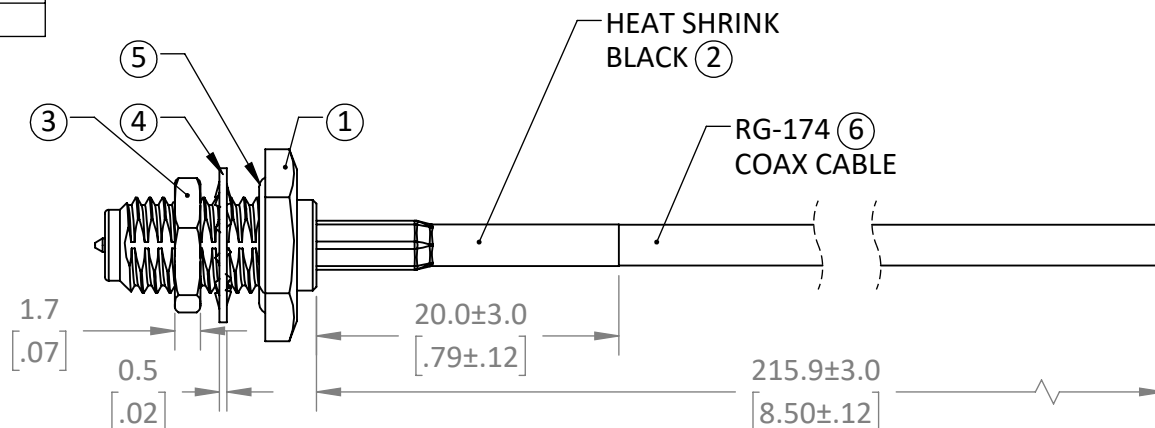
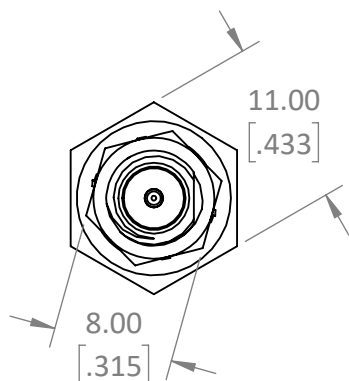

NOTES: (UNLESS OTHERWISE SPECIFIED)

- ALL DIMENSIONS ARE IN MILLIMETERS [IN].
- DIMENSIONS APPLY AFTER FINISHING.
- MANUFACTURE TO BE COMPLIANT WITH EU RoHS DIRECTIVE, USE MATERIALS THAT DO NOT CONTAIN REACH SUBSTANCES OF VERY HIGH CONCERN >1000ppm, AND USE DRC CONFLICT-FREE SOURCED MATERIALS.
- IMPEDANCE: 50Ω
- INSERTION LOSS: NTE (1dB/m)xvf(GHz)
- MINIMUM BEND RADIUS: 10.5mm
- MAX FREQUENCY: 6 GHz
- PANEL THICKNESS: 5mm [3/16"] MAX
- INTERFACE SMA TYPE REVERSE POLARITY IAW FCC PART15.

**WARNING:** THIS DRAWING CONTAINS PROPRIETARY INFORMATION THAT IS THE SOLE PROPERTY OF LINX TECHNOLOGIES, AND SHALL BE TREATED AS SUCH. NO DISCLOSURE OR REPRODUCTION OF THIS DOCUMENT IS PERMITTED, IN WHOLE OR IN PART, WITHOUT THE EXPRESS WRITTEN PERMISSION OF LINX TECHNOLOGIES OR ITS DESIGNATED AGENTS.

MATERIAL:	INTERPRET DIMENSIONS AND TOLERANCES PER ASME Y14.5.	PROJECTION: 
	.X ±2.0      ANGLES: ±1° .XX ±1.00      SURFACE: √ .XXX ±.500	
FINISH:	DRAWN: JHAGER	DT: 10/25/21
	ENGR: DASARATHAN	DT:



159 ORT LANE  
MERLIN, OR 97532

TITLE: <b>CABLE ASSEMBLY RG174/U RP-SMA JACK UN-TERMINATED</b>		
SIZE <b>A</b>	DWG. NO. <b>C-CONREVSMA014-C08.5</b>	REV <b>B</b>
SCALE: 2:1	DO NOT SCALE DRAWING	SHEET 1 OF 1

# Mouser Electronics

Authorized Distributor

Click to View Pricing, Inventory, Delivery & Lifecycle Information:

[TE Connectivity:](#)

[CONREVSMA014-C08.5](#)