

Standardausführung: V23529-A₂¹1x1-Cxxx-+
Standardversion

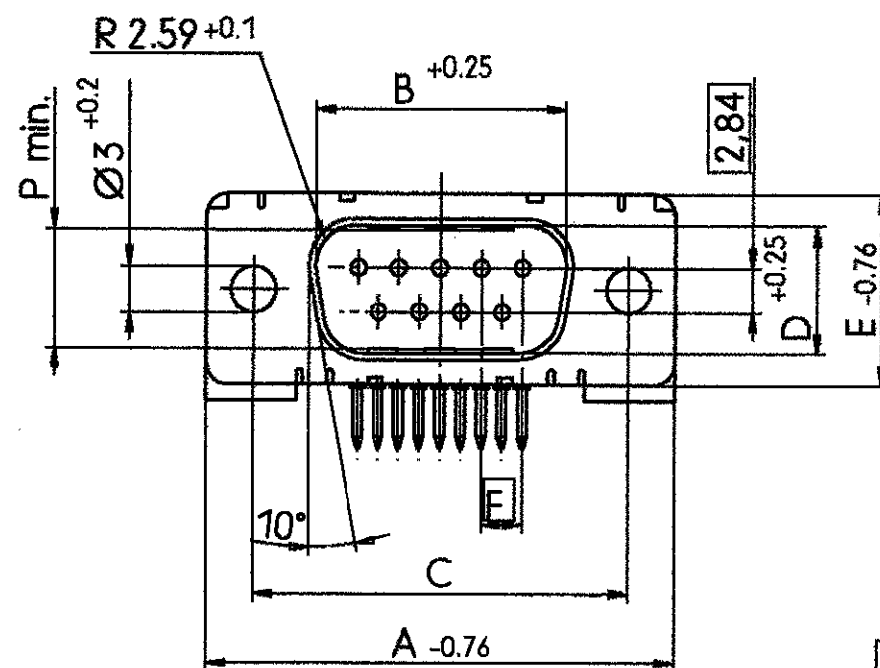

Einbauhöhe
Mounting height

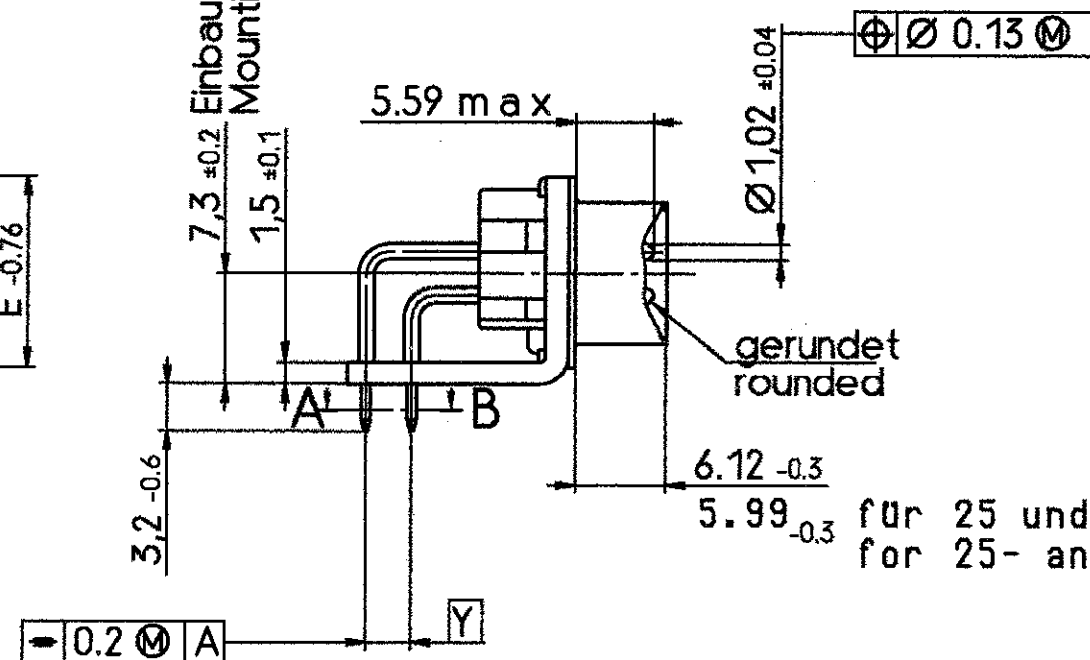

Schnitt AB des Lötanschlusses
Cross-section AB of solderpin
(20:1)

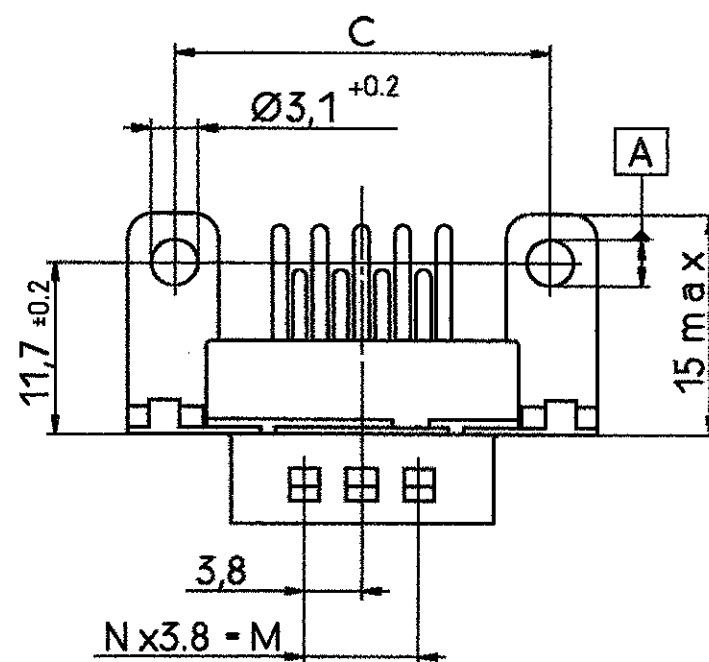

Ordercode Sachnr	Contacts Polzahl	Mass/Dimension								
V23529-Axxxx		A	B	C	D	E	F	M	N	P
..-Cx09-+	09	31.19	16.79	25.0 ^{+0.12} _{-0.13}	8.23	12.93	2.74	7.6	2	7.72
..-Cx15-+	15	39.52	25.12	33.3 ^{+0.15} _{-0.1}			2.74	15.2	4	7.69
..-Cx25-+	25	53.42	38.84	47.04 ^{+0.13} _{-0.13}			2.76	26.6	7	7.65
..-Cx37-+	37	69.7	55.30	63.5 ^{+0.13} _{-0.13}			2.76	41.8	11	7.65

Anforderungsstufe/Performance level¹⁾

Sachnr/Ordernr V23529-	Y
Axx1x-Cxxx-+	2.84
Axx2x-Cxxx-+	2.54

1) nach DIN 41652 T.2 und T.4
according to DIN 41652 p.2 and p.4

tyco		TYCO ELECTRONICS CORPORATION		SCALE 2:1 (20:1)		WEIGHT	
Electronics		OOSTKAMP - BELGIUM		DIMENSIONS IN MM		MATERIAL	
DATE 18.04.89		NAME Embo		PART NAME		SHT. 1+	
DEP. PD COM				Pinconnector-90° solderversion			
TOLERANCE UNLESS SPECIFIED OTHERWISE				PART NO.		V23529-A****-C****-*-7427	
Customer Drawing Nr. C 1393478-8						OF 8	

mit Gewindebolzen: M3 V23529-A₂¹xx4-Cxxx-+
with threadlock 4-40 UNC V23529-A₂¹xx5-Cxxx-+

Verdrehsicherheit ≥ 70 Ncm
torsionresistance

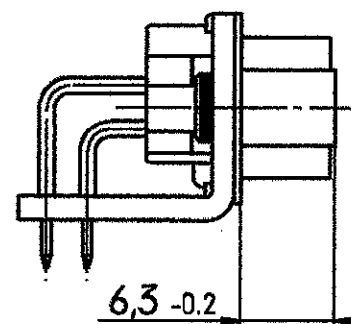
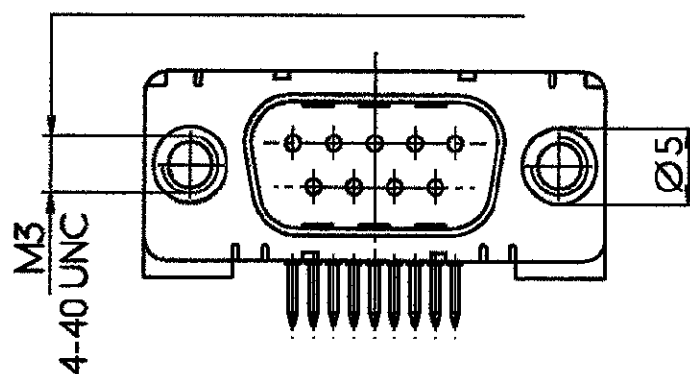

mit Gewinde: M3 V23529-A₂¹xx2-Cxxx-+
with thread 4-40 UNC V23529-A₂¹xx3-Cxxx-+

Verdrehsicherheit ≥ 70 Ncm
torsionresistance

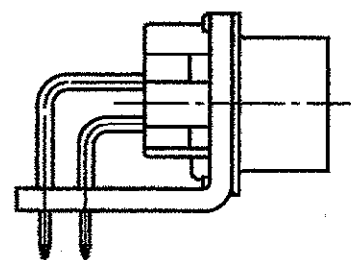
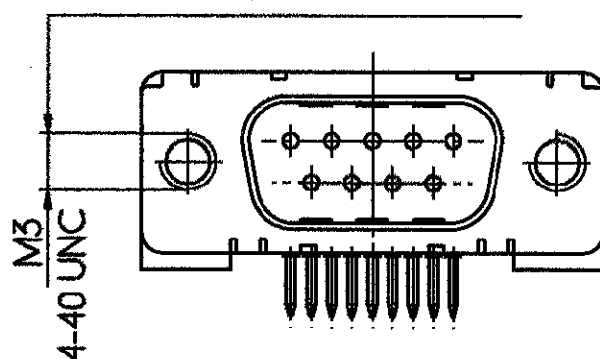

mit Clipbefestigung: V23529-A₂¹2xx-Cxxx-+
with snap-in

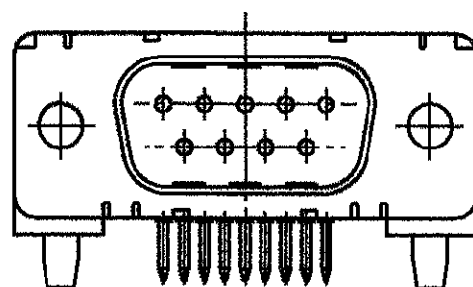

LP-Dicke 1,6±0,13mm, Loch Ø3,1 +0.2
PC-board-thickness 1,6±0,13mm, Hole Ø3,1 +0.2

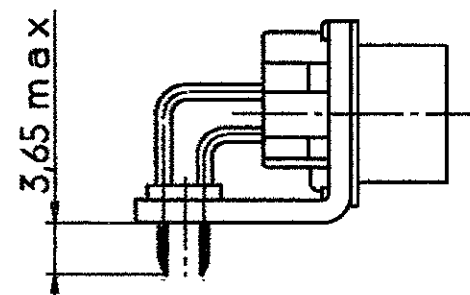

Leiterplattenbohrung
PCB hole pattern

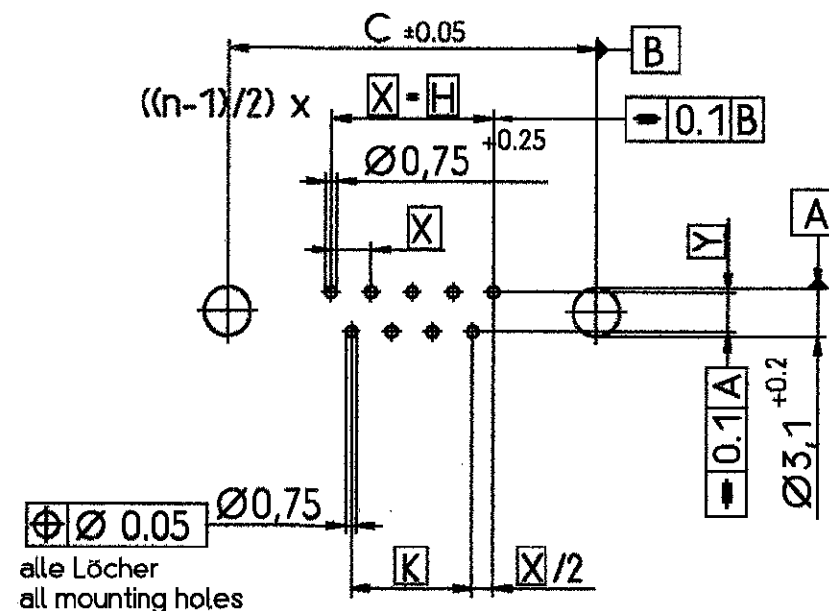

Mass Dimension	Polzahl n Number of contacts n			
	9	15	25	37
C	25	33.3	47.04	63.5
H	10.96	19.18	33.12	49.68
K	8.22	16.44	30.36	46.92
X	2.74	2.74	2.76	2.76
Y	2.54 oder 2.84			

1) nach DIN 41652 T.2 und T.4
according to DIN 41652 p.2 and p.4

tyco		TYCO ELECTRONICS CORPORATION		SCALE 2:1		WEIGHT	
Electronics		OOSTKAMP - BELGIUM		DIMENSIONS IN MM		MATERIAL	
REV. CHANGE ORDER		DATE		APP.		PART NAME	
B2 EH10-0351-05		14 APR 05		DATE 18.04.89		Stiftleiste-90° Lötversion	
B1 EHCO-0362-04		25 JUN 04		NAME Embo		(Variant 2 und 3) 1)	
B EH01-1460-03		03 DEC 03		DEP. PD COM		Pinconnector-90° solderversion	
A1 OU60-0081-00		04 SEP 00		KV		(Type 2 and 3) 1)	
A WO 00/7003		26.05.00		VS		PART NO.	
09 WO97/2518		04.02.97		BTH		V23529-A****-C****-7427	
08 WO96/2515		15.04.96		BTH		SHT. Z+	
REV. CHANGE ORDER		DATE		APP.		Customer Drawing Nr. C 1393478-8	
						OF 8	

Standardausführung isoliert: V23529-A³₄1x1-Cxxx-+
Standardversion insulated

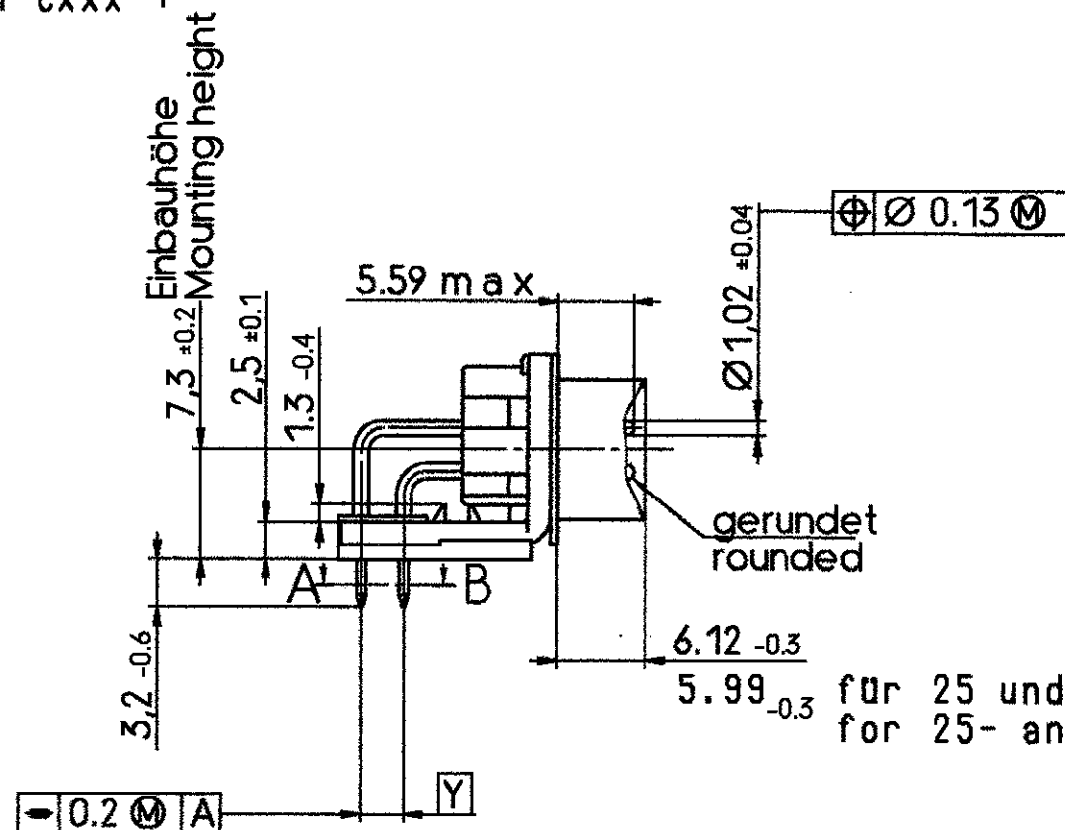
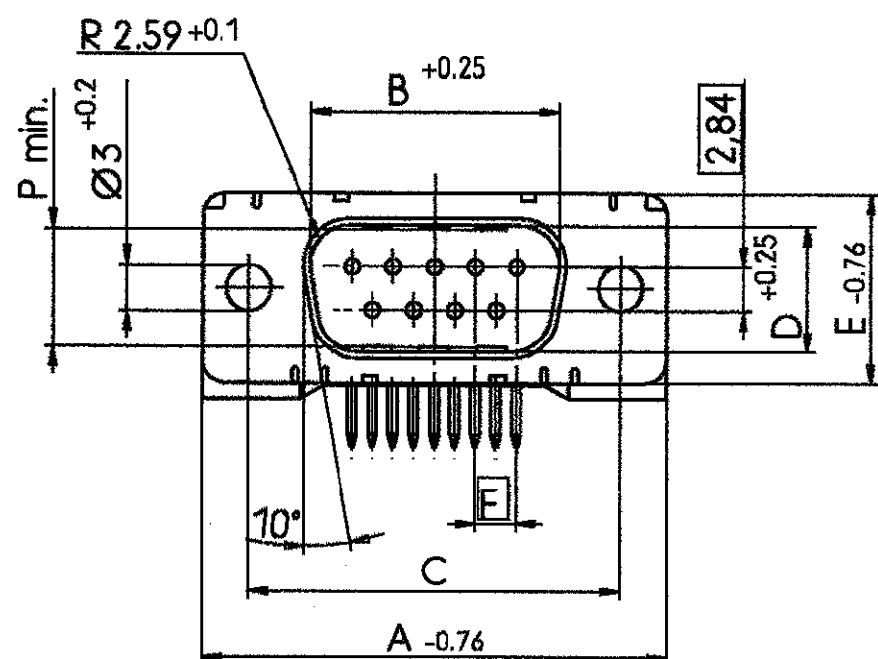

Schnitt AB des Lötanschlusses
Cross-section AB of solderpin
(20:1)

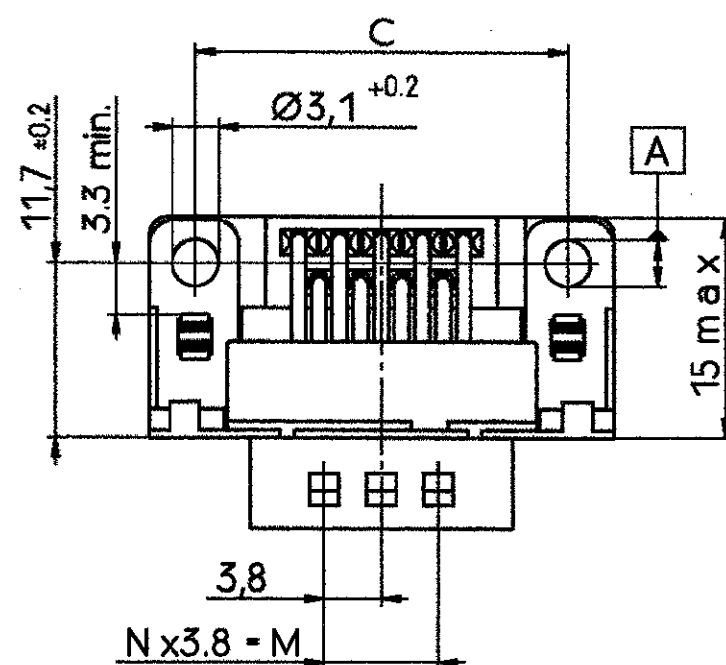

Ordercode Sachnr	Contacts Polzahl	Mass/Dimension									
V23529-Axxxx		A	B	C	D	E	F	M	N	P	
...Cx09-+	09	31.19	16.79	25.0 ^{+0.12} _{-0.13}	8.23	12.93	2.74	7.6	2	7.72	
...Cx15-+	15	39.52	25.12	33.3 ^{+0.15} _{-0.1}			2.74	15.2	4	7.69	
...Cx25-+	25	53.42	38.84	47.04 ^{+0.13} _{-0.13}			2.76	26.6	7	7.65	
...Cx37-+	37	69.7	55.30	63.5 ^{+0.13} _{-0.13}			2.76	41.8	11	7.65	

Anforderungsstufe/Performance level¹⁾

Sachnr/Ordernr V23529-	Y
Axx1x-Cxxx-+	2.84
Axx2x-Cxxx-+	2.54

1) nach DIN 41652 T.2 und T.4
according to DIN 41652 p.2 and p.4

tyco TYCO ELECTRONICS CORPORATION		SCALE 2:1 (20:1)		WEIGHT	
OOSTKAMP - BELGIUM		DIMENSIONS IN MM		MATERIAL	
LOC GW		DATE 18.04.89		PART NAME	
NAME Embo		REV. 01		Stiftleiste-90° Lötanschluss	
DEP. PD COM		REV. 02		(Variant 2 und 3) ¹⁾	
REV. 03		REV. 03		Pinconnector-90° solderversion	
REV. 04		REV. 04		(Type 2 and 3) ¹⁾	
REV. 05		REV. 05		PART NO.	
REV. 06		REV. 06		V23529-A****-C****-7427	
REV. 07		REV. 07		SHT. 3+	
REV. 08		REV. 08		OF 8	
REV. 09		REV. 09		Customer Drawing Nr. C 1393478-8	

mit Gewindebolzen : M3 V23529-A³/₄xx4-Cxxx-+

with threadlock 4-40 UNC V23529-A³/₄xx5-Cxxx-+

Verdrehsicherheit \geq 70 Ncm
torsionresistance

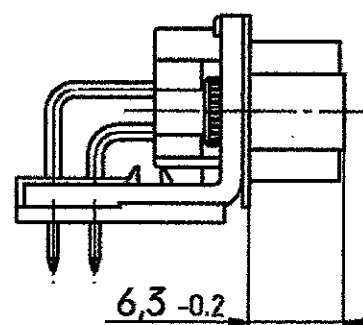
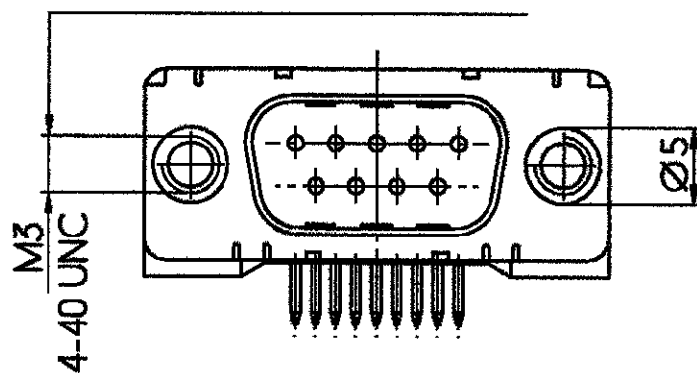

mit Gewinde: M3 V23529-A³/₄xx2-Cxxx-+

with thread 4-40 UNC V23529-A³/₄xx3-Cxxx-+

Verdrehsicherheit \geq 70 Ncm
torsionresistance

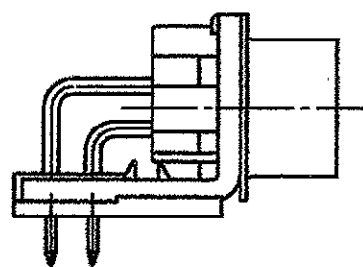
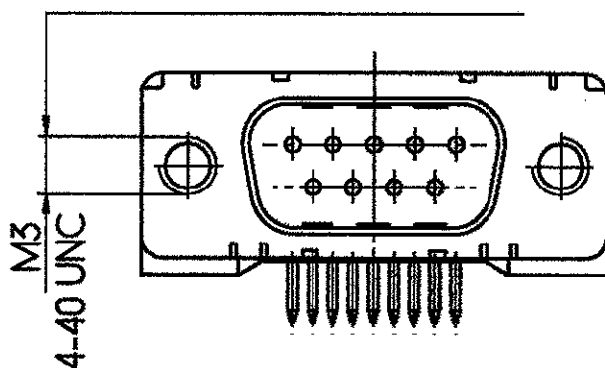

mit Clipbefestigung: V23529-A³/₄2xx-Cxxx-+
with snap-in

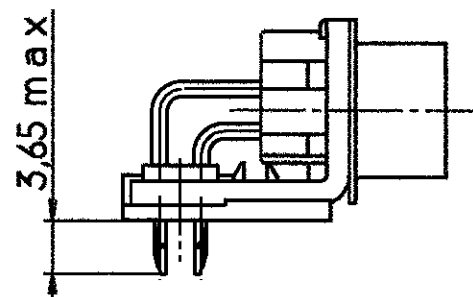
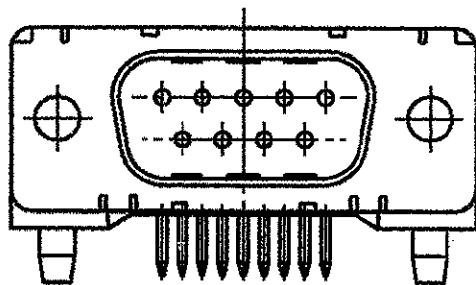

Leiterplattenbohrung
PCB hole pattern

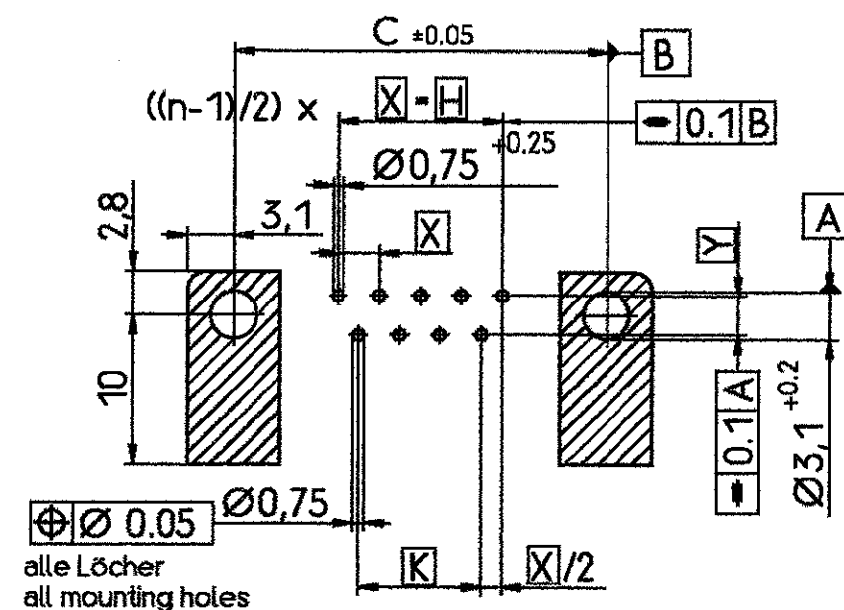

Mass	Polzahl n			
Dimension	Number of contacts n			
	9	15	25	37
C	25	33.3	47.04	63.5
H	10.96	19.18	33.12	49.68
K	8.22	16.44	30.36	46.92
X	2.74	2.74	2.76	2.76
Y	2.54 oder 2.84			

1) nach DIN 41652 T.2 und T.4
according to DIN 41652 p.2 and p.4

tyco		TYCO ELECTRONICS CORPORATION		SCALE 2:1		WEIGHT	
OOSTKAMP - BELGIUM		LOC. GW		DIMENSIONS IN MM		MATERIAL	
REV. CHANGE ORDER		DATE		PART NAME		SHT. 4+	
B2 EH10-0531-05		14 APR 05		Stiftleiste-90° Lötversion			
B1 EH00-0362-04		15 JUN 04		(Variant 2 und 3) 1)			
B EH01-1460-03		03 DEC 03		Pinconnector-90° solder version			
A1 OU60-0081-00		04 SEP 00		(Type 2 and 3) 1)			
A WO 00/7003		26.05.00		PART NO.			
09 WO97/2518		04.02.97		TOLERANCE UNLESS SPECIFIED OTHERWISE			
08 WO96/2515		15.04.96		V23529-A****-C****-7427			
Customer Drawing Nr. C 1393478-8				OF 8			

Standardausführung ohne Winkel: V23529-A50x1-Cxxx-+
Standardversion without bracket

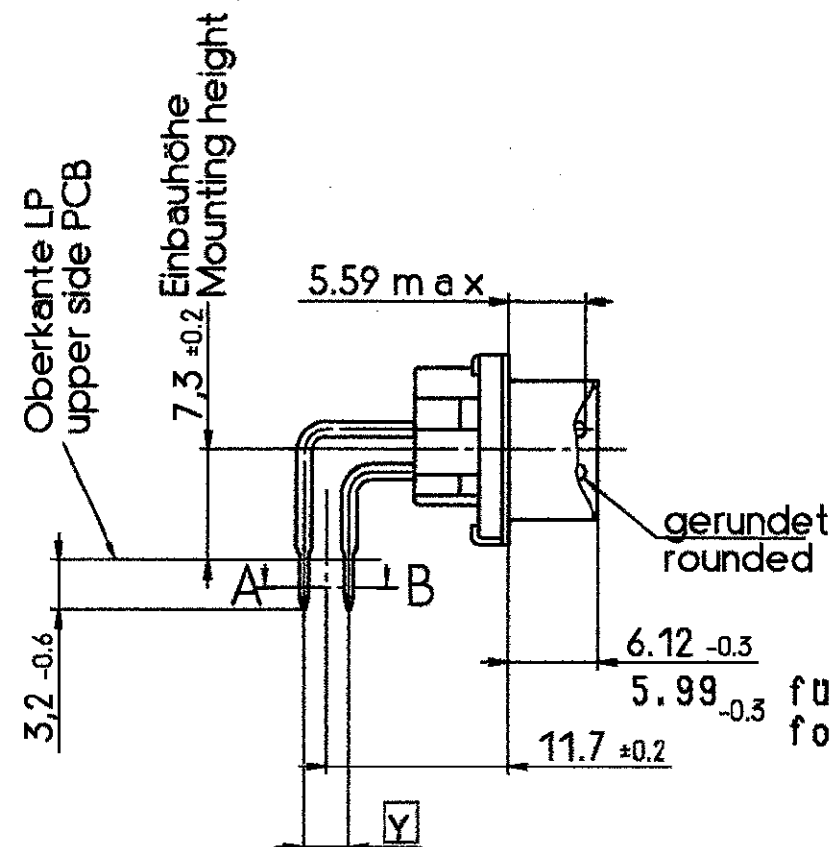
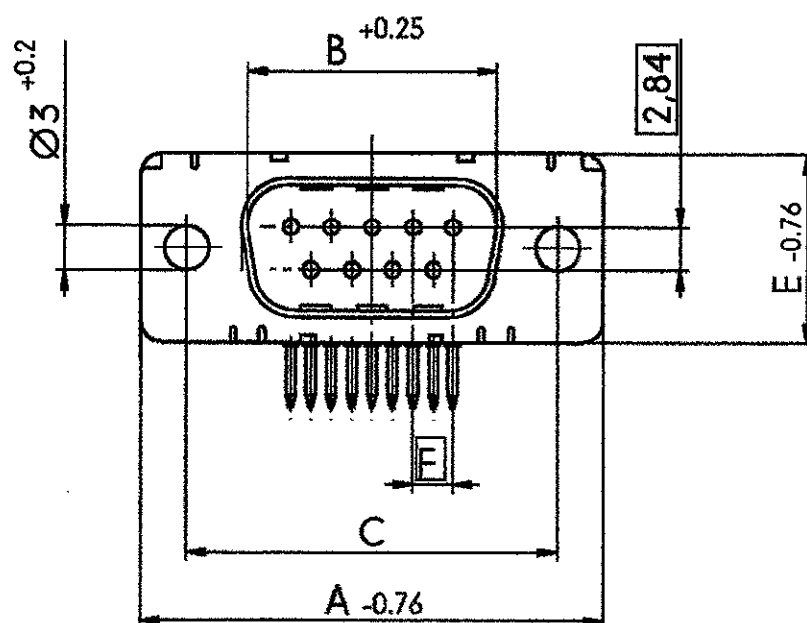

Schnitt AB des Lötanschlusses
Cross-section AB of solderpin
(20:1)

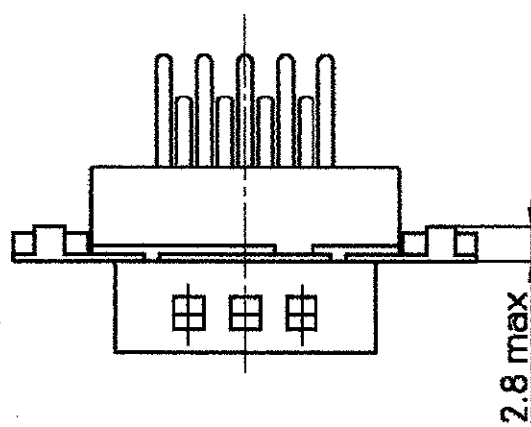
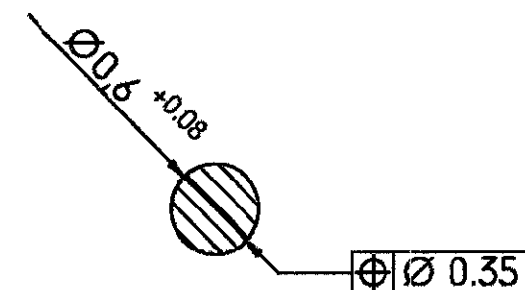

Ordercode Sachnr V23529-Axxxx	Contacts Polzahl	Mass/Dimension								
		A	B	C	D	E	F			P
..-Cx09-+	09	31.19	16.79	25.0 ^{+0.12} _{-0.13}	8.23	12.93	2.74			7.72
..-Cx15-+	15	39.52	25.12	33.3 ^{+0.15} _{-0.1}			2.74			7.69
..-Cx25-+	25	53.42	38.84	47.04 ^{+0.13} _{-0.13}			2.76			7.65
..-Cx37-+	37	69.7	55.30	63.5 ^{+0.13} _{-0.13}			2.76			7.65

Anforderungsstufe/Performance level¹⁾

Sachnr/Ordernr V23529-	Y
A501x-Cxxx-+	2.84
A502x-Cxxx-+	2.54

tyco TYCO ELECTRONICS CORPORATION		SCALE 2:1 (20:1)		WEIGHT	
OOSTKAMP - BELGIUM		DIMENSIONS IN MM		MATERIAL	
Loc GW		DATE 18.04.89		PART NAME	
B2 EH10-0531-05 14 APR 05 JvdH		NAME Embo		Stiftleiste-90° Lötanschluss (Variant 2 und 3) ¹⁾ Pinconnector-90° solder version (Type 2 and 3) ¹⁾	
B1 EHCO-0361-04 25 JUN 04 JvdH		DEP. PD COM			
B EH01-1460-03 03 DEC 03 JvdH		TOLERANCE UNLESS SPECIFIED OTHERWISE		PART NO.	
A1 OU60-0081-00 04 SEP 00 KV		VS		V23529-A*****-C***-*-7427	
A WO 00/7003 26.05.00		BTH		SHT. 5+	
09 WO97/2518 04.02.97		BTH		OF 8	
08 WO96/2515 15.04.96		APP.		Customer Drawing Nr. C 1393478-8	
REV. CHANGE ORDER		DATE			

1) nach DIN 41652 T.2 und T.4
according to DIN 41652 p.2 and p.4

mit Gewindebolzen: M3 V23529-A50x4-Cxxx-+
with threadlock 4-40 UNC V23529-A50x5-Cxxx-+

Verdrehsicherheit ≥ 70 Ncm
torsionresistance

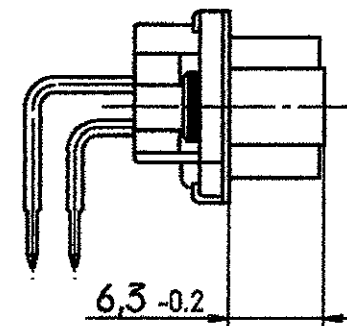
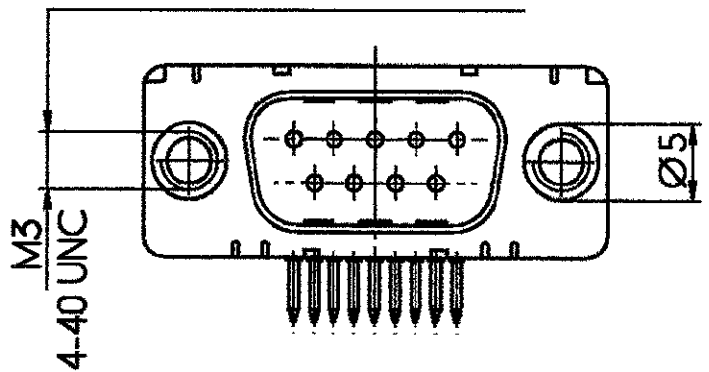

mit Gewinde: M3 V23529-A50x2-Cxxx-+
with thread 4-40 UNC V23529-A50x3-Cxxx-+

Verdrehsicherheit ≥ 70 Ncm
torsionresistance

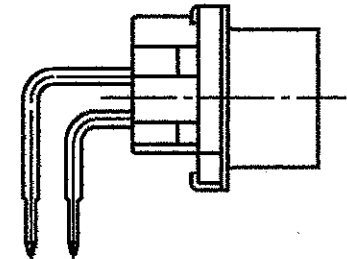
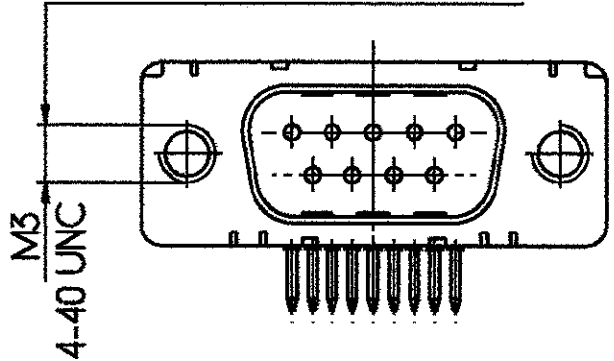

Leiterplattenbohrung
PCB hole pattern

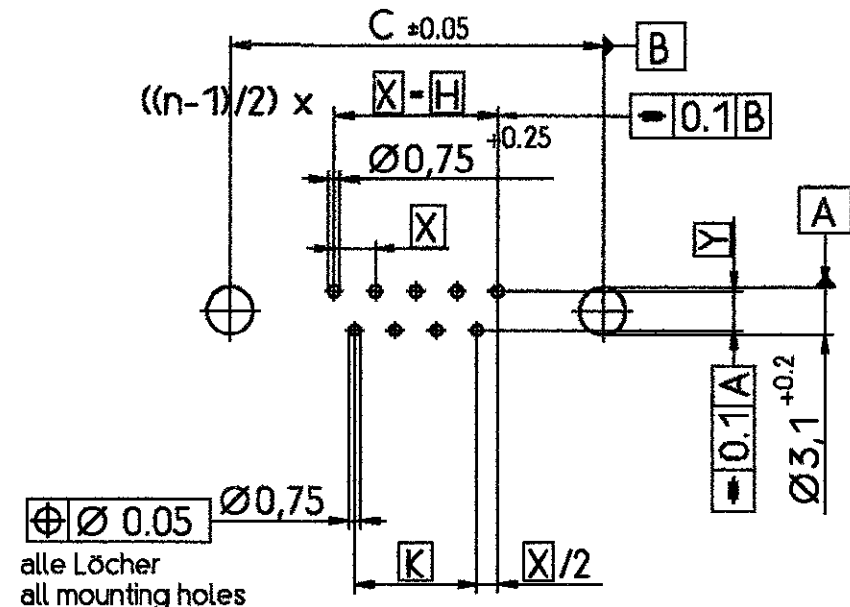

Mass Dimension	Polzahl n Number of contacts n			
	9	15	25	37
C	25	33.3	47.04	63.5
H	10.96	19.18	33.12	49.68
K	8.22	16.44	30.36	46.92
X	2.74	2.74	2.76	2.76
Y	2.54 oder or 2.84			

1) nach DIN 41652 T.2 und T.4
according to DIN 41652 p.2 and p.4

tyco		TYCO ELECTRONICS CORPORATION				SCALE 2:1	WEIGHT
Electronics		OOSTKAMP - BELGIUM		Loc GW		MATERIAL	
REV.		CHANGE ORDER		DATE		PART NAME	
B2		EH10-0531-05		14 APR 05		JvdH	
B1		EH00-0362-04		25 JUN 04		JvdH	
B		EH01-1460-03		03 DEC 03		JvdH	
A1		OU60-0081-00		04 SEP 00		KV	
A		WO 00/7003		26.05.00		VS	
09		WO97/2518		04.02.97		BTH	
08		WO96/2515		15.04.96		BTH	
TOLERANCE UNLESS SPECIFIED OTHERWISE		DATE		APP.		Customer Drawing Nr. C 1393478-8	
DATE		APP.		TOLERANCE UNLESS SPECIFIED OTHERWISE		PART NO.	
18.04.89		Embo		PD COM		Stiftleiste-90° Lötversion (Variant 2 und 3) 1)	
Pinconnector-90° solderversion (Type 2 and 3) 1)		PART NO.		SHT.		6+	
V23529-A****-C****-*-7427		OF 8					

V 2 3 5 2 9 - A * * * * - C * * * * - +

Winkelausführung Beschriftung		// bracket type // marking
1	Metallwinkel mit Hersteller-Beschriftung	// metal bracket // producer marking
2	Metallwinkel ohne Beschriftung	// metal bracket // no marking
3	Metallwinkel isoliert mit Hersteller-Beschriftung	// metal bracket insulated // producer marking
4	Metallwinkel isoliert ohne Beschriftung	// metal bracket insulated // no marking
5	ohne Metallwinkel mit Hersteller-Beschriftung	// without metal bracket // producer marking

Leiterplattenbefestigung // PCB mounting	
0	ohne LP-Befestigung // none
1	Loch Ø 3 // hole Ø 3
2	mit Clip // snap-in
3	mit Gewinde M3 // thread M3

Anschlußvarianten // contact type	
1	Stiellänge 3,2 mm // pin length 3,2 mm Raster 2,84 x 2,76 // spacing 2,84 x 2,76
2	Stiellänge 3,2 mm // pin length 3,2 mm Raster 2,54 x 2,76 // spacing 2,54 x 2,76

Steckerbefestigung // connector mounting	
1	Loch Ø 3 // hole Ø 3
2	Gewinde M3 // thread M3
3	Gewinde 4-40UNC // thread 4-40UNC
4	Gewindebolzen M3 // stud bolt screwlock M3
5	Gewindebolzen 4-40UNC // stud bolt screwlock 4-40UNC

SUFFIX	
-(ohne) (without)	Isolierteil grau RAL 7035 // insulation piece grey RAL 7035
S	Isolierteil schwarz RAL 9005 // insulation piece black RAL 9005
H	Isolierteil schwarz RAL 9005 // insulation piece black RAL 9005 Sonderbeschriftung H // customer marking H
T	Isolierteil schwarz hochtemperaturbeständig // insulation piece black high temperature resistant

Polzahl // No. of contacts	
09	9 polig // 9-contacts
15	15 polig // 15-contacts
25	25 polig // 25-contacts
37	37 polig // 37-contacts

Kontaktfläche / Anforderungsstufe // contact surface / performance level			
1	Au	/ Güte I	// Au / PL I
2	Au	/ Güte II	// Au / PL II

Steckerart // connector type	
C	Stiftleiste mit Schirnfiederung // pinconnector with grounding fingers

THIS INFORMATION IS CONFIDENTIAL AND PROPRIETARY TO TYCO ELECTRONICS CORPORATION AND ITS WORLDWIDE SUBSIDIARIES AND AFFILIATES. IT MAY NOT BE DISCLOSED TO ANYONE, OTHER THAN TYCO ELECTRONICS PERSONEL, WITHOUT WRITTEN AUTHORIZATION FROM TYCO ELECTRONICS CORPORATION, HARRISBURG PENNSYLVANIA USA.

1) nach DIN 41652 T.2 und T.4
according to DIN 41652 p.2 and p.4

tyco		TYCO ELECTRONICS CORPORATION		SCALE		WEIGHT	
Electronics		OOSTKAMP - BELGIUM		MATERIAL			
		DATE 18.04.89		PART NAME			
		NAME Embo		Stiftleiste-90° Austauschführung			
		APP. PD COM		Pinconnector-90° solder version			
		TOLERANCE UNLESS SPECIFIED OTHERWISE		PART NO.		SEIT. 74	
		V23529-A****-C****-7427					
REV. CHANGE ORDER		DATE		APP. Customer Drawing Nr. C 1393478-8		OF 8	

Active part numbers. Contact
Tyco Electronics for
other configuration availability

Old Part Number	Tyco Part Number	PRIMARY	SECONDARY
V23529-A1111-C109	1393478-8		
V23529-A1111-C209	1-1393478-0		
V23529-A1111-C215	1-1393478-1		
V23529-A1111-C225	1-1393478-2		
V23529-A1111-C237	1-1393478-3		
V23529-A1113-C209	2-1393478-4		
V23529-A1115-C209	3-1393478-0		
V23529-A1115-C215	3-1393478-1		
V23529-A1115-C225	3-1393478-2		
V23529-A1115-C237	3-1393478-3		
V23529-A1121-C209	4-1393478-4		
V23529-A1121-C215	4-1393478-5		
V23529-A1121-C237	4-1393478-6		
V23529-A1122-C115	5-1393478-4		
V23529-A1122-C209	5-1393478-5		
V23529-A1122-C237	5-1393478-6		
V23529-A1123-C209	6-1393478-3		
V23529-A1123-C215	6-1393478-4		
V23529-A1123-C225	6-1393478-5		
V23529-A1123-C237	6-1393478-6		
V23529-A1124-C109	7-1393478-3		
V23529-A1125-C209	8-1393478-0		
V23529-A1125-C237	8-1393478-1		
V23529-A1215-C209	1393479-4		
V23529-A1221-C109	1-1393479-4		
V23529-A1221-C215	1-1393479-8		
V23529-A1221-C225	1-1393479-9		
V23529-A1222-C109	3-1393479-1		
V23529-A1222-C209	3-1393479-3		
V23529-A1222-C215	3-1393479-4		
V23529-A1222-C225	3-1393479-5		
V23529-A1222-C237	3-1393479-6		
V23529-A1223-C109	4-1393479-2		
V23529-A1223-C209	4-1393479-3		
V23529-A1223-C215	4-1393479-4		
V23529-A1223-C225	4-1393479-5		
V23529-A1223-C237	4-1393479-6		
V23529-A1225-C209	6-1393479-4		
V23529-A1225-C215	6-1393479-5		
V23529-A1225-C225	6-1393479-6		
V23529-A1112-C225	2-1393478-1		

Old Part Number	Tyco Part Number	PRIMARY	SECONDARY
V23529-A1225-C237	6-1393479-7		
V23529-A3113-C209	7-1393479-7	OBSOLETE	
V23529-A3121-C109	8-1393479-6	OBSOLETE	
V23529-A3121-C209	8-1393479-8	SUPERSEDED	5-338168-2
V23529-A3121-C215	8-1393479-9	SUPERSEDED	5-338169-2
V23529-A3121-C225	9-1393479-0	SUPERSEDED	5-338170-2
V23529-A3121-C237	9-1393479-1	SUPERSEDED	5-338171-2
V23529-A3122-C209	6-1393487-0		
V23529-A3122-C209	5-1393487-8	SUPERSEDED	7-338168-2
V23529-A3122-C215	5-1393487-9	SUPERSEDED	7-338169-2
V23529-A3122-C237	9-1393479-5	SUPERSEDED	7-338171-2
V23529-A3125-C109	9-1393479-8	OBSOLETE	
V23529-A3125-C209	1393480-1	SUPERSEDED	8-338168-2
V23529-A3125-C215	6-1393487-2	SUPERSEDED	8-338169-2
V23529-A3125-C225	6-1393487-3	SUPERSEDED	8-338170-2
V23529-A3125-C237	6-1393487-4	SUPERSEDED	8-338171-2
V23529-A3212-C209	1393480-4	OBSOLETE	
V23529-A3221-C209	6-1393487-9	SUPERSEDED	0-338168-2
V23529-A3221-C215	7-1393487-0	SUPERSEDED	0-338169-2
V23529-A3221-C225	7-1393487-1	SUPERSEDED	0-338170-2
V23529-A3221-C237	7-1393487-2	SUPERSEDED	0-338171-2
V23529-A3222-C209	7-1393487-7	SUPERSEDED	2-338168-2
V23529-A3222-C215	7-1393487-8	SUPERSEDED	2-338169-2
V23529-A3222-C225	7-1393487-9	SUPERSEDED	2-338170-2
V23529-A3222-C237	8-1393487-0	SUPERSEDED	2-338171-2
V23529-A3223-C209	1392010-9	SUPERSEDED	1-338168-2
V23529-A3223-C215	1-1393480-1	SUPERSEDED	1-338169-2
V23529-A3223-C225	1-1392010-0	SUPERSEDED	1-338170-2
V23529-A3223-C237	1-1392010-1	SUPERSEDED	1-338171-2
V23529-A3225-C209	1-1393480-5	SUPERSEDED	3-338168-2
V23529-A3225-C215	8-1393487-5	SUPERSEDED	3-338169-2
V23529-A3225-C225	8-1393487-6	SUPERSEDED	3-338170-2
V23529-A3225-C237	8-1393487-7	SUPERSEDED	3-338171-2
V23529-A3213-C209	1393480-8	OBSOLETE	
V23529-A3111-C209	7-1393479-1	OBSOLETE	
V23529-A3113-C209	7-1393479-7	OBSOLETE	
V23529-A3113-C215	7-1393479-9	OBSOLETE	
V23529-A3122-C225	9-1393479-4	SUPERSEDED	7-338170-2
V23529-A3125-C137	9-1393479-9	OBSOLETE	

1) nach DIN 41652 T.2 und T.4
according to DIN 41652 p.2 and p.4

tyco		Tyco Electronics Corporation		SCALE		WEIGHT	
Electronics		Oostkamp - Belgium		DIMENSIONS IN MM		MATERIAL	
DATE 18.04.89		NAME Embo		PART NAME		Stiftleiste-90° Lötanschluss (Variant 2 und 3) 1) Pinconnector-90° solder version (Type 2 and 3) 1)	
DEP. PD COM		TOLERANCE UNLESS SPECIFIED OTHERWISE		PART NO.			
REV. CHANGE ORDER		DATE		APP.			
B2 EH10-0531-05 14 APR 05 JvdH		B1 EH10-0362-04 25 JUN 04 JvdH		B EH01-1460-03 03 DEC 03 JvdH		A1 OU60-0081-00 04 SEP 00 KV	
A WO 00/7003 26.05.00 VS		Customer Drawing Nr. C 1393478-8		V23529-A****-C****-7427		SHT. 8- OF 8	

THIS INFORMATION IS CONFIDENTIAL AND PROPRIETARY TO TYCO ELECTRONICS CORPORATION AND ITS WORLDWIDE SUBSIDIARIES AND AFFILIATES. IT MAY NOT BE DISCLOSED TO ANYONE, OTHER THAN TYCO ELECTRONICS PERSONNEL, WITHOUT WRITTEN AUTHORIZATION FROM TYCO ELECTRONICS CORPORATION, HARRISBURG, PENNSYLVANIA, USA.

PROPRIETARY

Mouser Electronics

Authorized Distributor

Click to View Pricing, Inventory, Delivery & Lifecycle Information:

[TE Connectivity:](#)

[6-1393478-3](#)