

REVISIONS

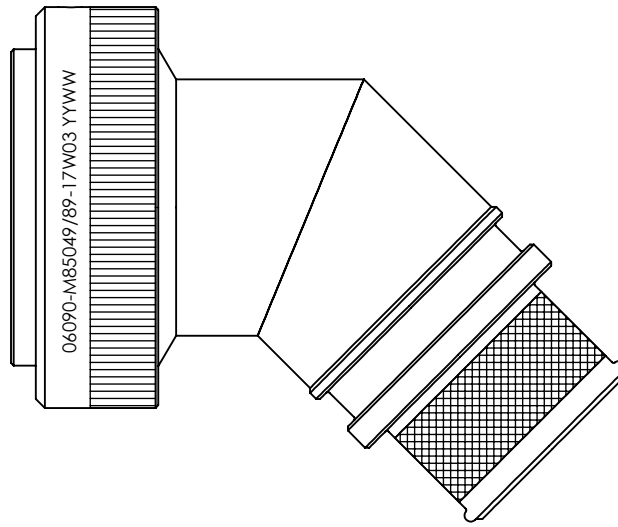

## SELF-LOCKING SHIELD BAND TERMINATION SHRINK BOOT ACCOMMODATION 45° ADAPTOR

1. THIS PRODUCT IS DESIGNED TO TERMINATE A BRAIDED CABLE SHIELD AND A HEAT SHRINKABLE LIPPED BOOT TO A CONNECTOR, AND DESIGNED TO MEET REQUIREMENTS OF AS85049/89.
2. ALL COMPONENTS SHALL BE PACKAGED AND SUPPLIED IN A PLASTIC BAG AND LABELED WITH M85049/89 DESIGNATION. e.g. M85049/89-17W03
3. THIS ADAPTOR MATES TO CONNECTOR MIL-DTL-38999 SERIES III & IV.
4. PART SUPPLIED WITH STANDARD DETENTED SELF-LOCKING WHICH PROVIDES A POSITIVE AUDIBLE DETENTED COUPLING.
5. CATEGORY 3B - MEDIUM DUTY - NON-ENVIRONMENTAL
6. FOR MATERIALS AND PLATING FINISHES INFORMATION REFER TO R85049.  
FOR ALTERNATIVE MATERIALS AND PLATING FINISHES CONTACT TE CONNECTIVITY.

RELEASED FOR PUBLICATION

ALL RIGHTS RESERVED.

THIS DRAWING IS UNPUBLISHED.

© COPYRIGHT 20 BY

|  |                        |            |   |                           |
|--|------------------------|------------|---|---------------------------|
| DIMENSIONS:<br>INCHES  | DWN: N.HAWKINS         | 10/06/2019 | MATERIAL: SEE P/N BREAKDOWN   | FINISH: SEE P/N BREAKDOWN |
|  | CHK: R.STYLES          | 14/06/2019 | <b>STE</b> TE Connectivity  |                           |
| TOLERANCES UNLESS OTHERWISE SPECIFIED:<br><br>GENERAL TOL<br>LINEAR ±.01"<br>ANGULAR ±1° | APVD: M.PAUL           | 27/06/2019 | PART NUMBER: R85049/89 SERIES   |                           |
|  | PRODUCT SPEC:<br>-     |            | NAME: Connector Accessories, Electrical, Backshell, 45 DEG, Self-Locking, Shield Band Termination (RFI/EMI), Shrink Boot Accommodation, Category 3B |                           |
|  | APPLICATION SPEC:<br>- |            | SIZE: A4  | CAGE CODE: 06090          |
|  | WEIGHT:                |            | DRAWING NO: C-P45767  | RESTRICTED TO:            |
|  | CUSTOMER DRAWING       |            | SCALE: 1.5:1  | SHEET: 1 OF 2             |
|  |                        |            |   | REV: BA                   |

REVISIONS

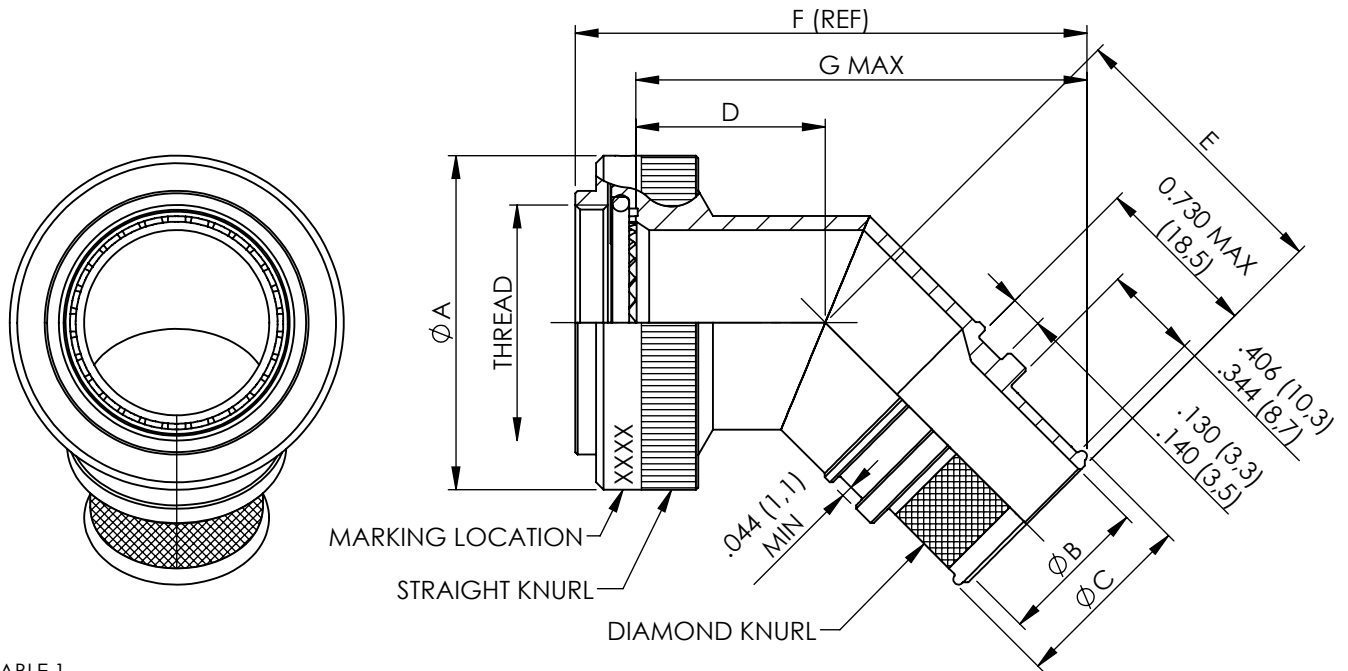

TABLE 1

| ACCESSORY SHELL SIZE | SHELL SIZE CODE | THREAD    | A MAX DIA     | B DIA ±.010 ENTRY SIZE |               | C DIA REF    |               | D MAX       | E MAX       | G MAX        |              | F (REF)      |              |
|----------------------|-----------------|-----------|---------------|------------------------|---------------|--------------|---------------|-------------|-------------|--------------|--------------|--------------|--------------|
|                      |                 |           |               | 02                     | 03            | 02           | 03            |             |             | 02           | 03           | 02           | 03           |
| 09                   | A               | M12 x 1.0 | .858 (21.79)  | N/A                    | .250 (6.35)   | N/A          | .395 (10.03)  | 1.01 (25.7) | 1.16 (29.5) | N/A          | 1.970 (50.0) | N/A          | 2.218 (56.3) |
| 11                   | B               | M15 x 1.0 | .984 (24.99)  | N/A                    | .312 (7.92)   | N/A          | .457 (11.61)  | 1.03 (26.2) | 1.19 (30.2) | N/A          | 2.033 (51.6) | N/A          | 2.281 (57.9) |
| 13                   | C               | M18 x 1.0 | 1.157 (29.39) | .312 (7.92)            | .438 (11.13)  | .457 (11.61) | .583 (14.81)  | 1.06 (26.9) | 1.21 (30.7) | 2.007 (52.8) | 2.122 (53.9) | 2.325 (59.1) | 2.370 (60.2) |
| 15                   | D               | M22 x 1.0 | 1.279 (32.49) | .438 (11.13)           | .562 (14.27)  | .583 (14.81) | .707 (17.96)  | 1.08 (27.4) | 1.24 (31.5) | 2.163 (54.9) | 2.207 (56.1) | 2.411 (61.2) | 2.455 (62.4) |
| 17                   | E               | M25 x 1.0 | 1.406 (35.71) | .500 (12.70)           | .625 (15.88)  | .645 (16.38) | .770 (19.56)  | 1.11 (28.2) | 1.26 (32.0) | 2.229 (56.6) | 2.273 (57.7) | 2.477 (62.9) | 2.521 (64.0) |
| 19                   | F               | M28 x 1.0 | 1.516 (38.51) | .625 (15.88)           | .750 (19.05)  | .770 (19.56) | .895 (22.73)  | 1.12 (28.4) | 1.27 (32.3) | 2.290 (58.2) | 2.334 (59.3) | 2.538 (64.5) | 2.582 (65.6) |
| 21                   | G               | M31 x 1.0 | 1.621 (41.71) | .625 (15.88)           | .812 (20.62)  | .770 (19.56) | .957 (24.31)  | 1.15 (29.2) | 1.30 (33.0) | 2.341 (59.5) | 2.408 (61.2) | 2.589 (65.8) | 2.656 (67.5) |
| 23                   | H               | M34 x 1.0 | 1.768 (44.91) | .688 (17.48)           | .938 (23.83)  | .829 (21.06) | 1.083 (27.51) | 1.17 (29.7) | 1.33 (33.8) | 2.404 (61.1) | 2.493 (63.3) | 2.652 (67.4) | 2.741 (69.6) |
| 25                   | J               | M37 x 1.0 | 1.889 (47.98) | .750 (19.05)           | 1.000 (25.40) | .895 (22.73) | 1.145 (29.08) | 1.20 (30.5) | 1.35 (34.3) | 2.471 (62.8) | 2.559 (65.0) | 2.719 (69.1) | 2.807 (71.3) |

METRIC EQUIVALENTS ARE IN PARENTHESIS AND ARE GIVEN FOR GENERAL INFORMATION ONLY

TABLE 2

| CODE | FINISH  |
|------|---|
| N    | ELECTROLESS NICKEL (96HRS SALT SPRAY RESISTANCE)                                    |
| W    | CADMIUM OLIVE DRAB OVER ELECTROLESS NICKEL (1000HRS SALT SPRAY RESISTANCE)          |
| Z    | ZINC NICKEL BLACK PASSIVATE OVER ELECTROLESS NICKEL (1000HRS SALT SPRAY RESISTANCE) |
| P    | CADMIUM OLIVE DRAB OVER ELECTROLESS NICKEL (SELECTIVE PLATING)                      |

NOTES FOR SELECTIVE PLATING: -  
 1. CADMIUM/NICKEL INTERFACE SHALL BE COATED WITH POLYSULFIDE SEALANT.  
 2. AREA FREE OF CADMIUM.

SELECTIVE PLATING

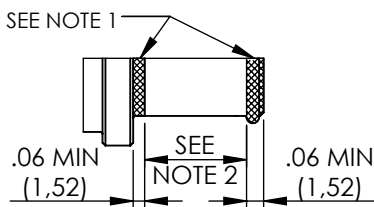

BASIC PART NUMBER \_\_\_\_\_  
 SPECIFICATION SHEET \_\_\_\_\_  
 CONFIGURATION \_\_\_\_\_  
 - (DASH) FOR SELF-LOCKING \_\_\_\_\_  
 CONNECTOR SHELL SIZE (TABLE 1) \_\_\_\_\_  
 FINISH (TABLE 2) \_\_\_\_\_  
 ENTRY SIZE (TABLE 1) \_\_\_\_\_

R85049/89-17W03

RELEASED FOR PUBLICATION

ALL RIGHTS RESERVED.

THIS DRAWING IS UNPUBLISHED.

© COPYRIGHT 20 BY

|  |                   |            |   |                           |
|--|-------------------|------------|---|---------------------------|
| DIMENSIONS:<br>INCHES                      | DWN: N.HAWKINS    | 10/06/2019 | MATERIAL: SEE P/N BREAKDOWN   | FINISH: SEE P/N BREAKDOWN |
|  | CHK: R.STYLES     | 14/06/2019 | TE Connectivity   |                           |
| TOLERANCES UNLESS OTHERWISE SPECIFIED:     | APVD: M.PAUL      | 27/06/2019 |   |                           |
| GENERAL TOL<br>LINEAR ±.01"<br>ANGULAR ±1° | PRODUCT SPEC:     | -          | NAME: Connector Accessories, Electrical, Backshell, 45 DEG, Self-Locking, Shield Band Termination (RFI/EMI), Shrink Boot Accommodation, Category 3B |                           |
|  | APPLICATION SPEC: | -          | SIZE: A4  | CAGE CODE: 06090          |
|  | WEIGHT:           | -          | DRAWING NO: C=P45767  | RESTRICTED TO             |
|  | CUSTOMER DRAWING  | -          | SCALE: 1.25:1   | SHEET: 2 OF 2             |
|  |                   |            | REV: BA   |                           |

# Mouser Electronics

Authorized Distributor

Click to View Pricing, Inventory, Delivery & Lifecycle Information:

[TE Connectivity:](#)

[R85049/89-15N03](#)