

REVISIONS					
P	LTR	DESCRIPTION	DATE	DWN	APVD
	Y	REVISED PER ECO-12-012320	04JUL12	KH	MZ
	Z	REVISED PER ECO-16-017885	07OCT2017	RS	MZ

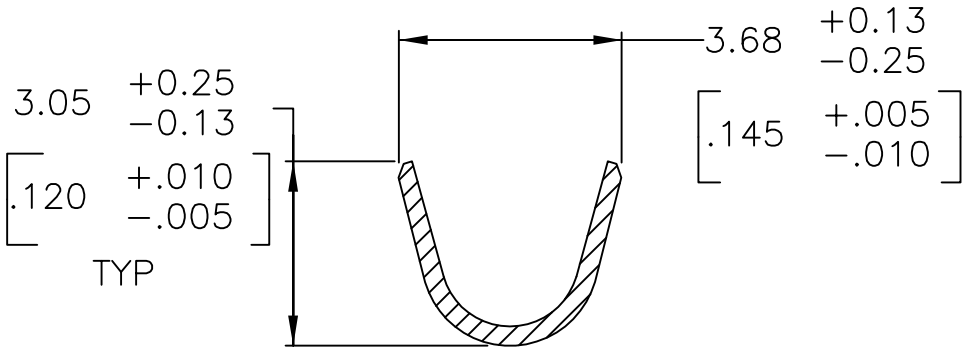

SECTION A-A

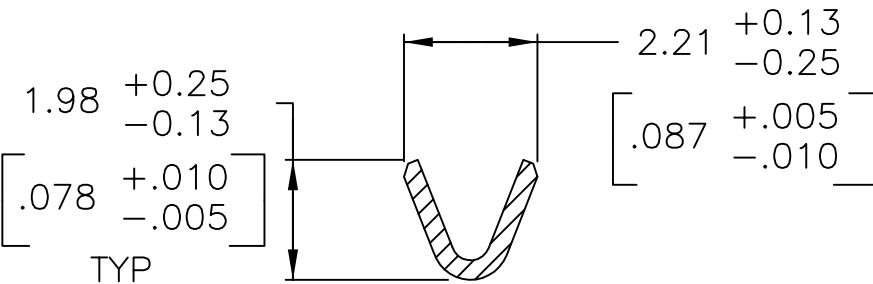

SECTION B-B

- 1 0.76µm [.000030] MIN GOLD PER MIL-G-45204 ON MATING END FOR A LENGTH OF 5.08 [.200] MIN WITH 1.27µm[.000050] MIN MATTE TIN PLATE IN WIRE CRIMP AREA, BOTH OVER 0.76µm [.000030] MIN NICKEL PER QQ-N-290.
- 2 1.27µm [.000050] MIN TIN-LEAD PER MIL-T-10727 OVER 0.76µm [.000030] MIN NICKEL PER QQ-N-290.
- 3 0.76µm [.000030] MIN GOLD PER MIL-G-45204 ON MATING END FOR A LENGTH OF 5.08 [.200] MIN WITH A UNIFORM GRADIENT TO 0.25µm [.000010] MIN GOLD PER MIL-G-45204 ON THE REMAINDER OVER 0.76µm [.000030] MIN NICKEL PER QQ-N-290.
- 4 0.38µm [.000015] MIN GOLD PER MIL-G-45204 ON MATING END FOR A LENGTH OF 5.08 [.200] MIN WITH 1.27µm[.000050] MIN MATTE TIN PLATE IN WIRE CRIMP AREA, BOTH OVER 0.76µm [.000030] MIN NICKEL PER QQ-N-290.
- 5 1.27µm [.000050] MIN GOLD PER MIL-G-45204 ON MATING END FOR A LENGTH OF 5.08 [.200] MIN WITH GOLD FLASH ON REMAINDER OVER 0.76µm [.000030] MIN NICKEL PER QQ-N-290.
- 6 GOLD PLATING NEED NOT APPEAR IN THIS AREA.
- 7 REVERSE REELED FOR MINI-APPLICATOR.
- 8 WIRE RANGE 24-20 AWG. INSULATION RANGE 2.03[.080]-2.54[.100].
- 9 NOT RELEASED, AMP HOLLAND USE ONLY
- 10 0.38µm [.000015] MIN GOLD PER MIL-G-45204 ON MATING END FOR A LENGTH OF 5.08 [.200] MIN, 1.27µm [.000050] MIN TIN-LEAD PER MIL-T-10727 FOR A LENGTH OF 5.69 [.224] MIN ON OPPOSITE END, BOTH OVER 1.27µm [.000050] MIN NICKEL PER QQ-N-290 ON ENTIRE CONTACT.
- 11 1.27µm [.000050] MIN TIN PER MIL-T-10727 OVER 0.76µm [.000030] MIN NICKEL PER QQ-N-290.
- 12 OBSOLETE PARTS: OBSOLETE CIS STREAMLINING PER D.RENAUD/D.SINISI

	STANDARD	11	BRASS	1-66399-0	1-66331-5
	7	11	BRASS	1-66399-0	1-66331-4
12	OBSOLETE	7	1	PHOSPHOR BRONZE	-
	OBSOLETE	7	10	BRASS	66399-5
	OBSOLETE	7	5	BRASS	-
		-	-	BRASS	-
	OBSOLETE	-	-	BRASS	-
		7	1	BRASS	66399-4
		7	4	BRASS	66399-3
	OBSOLETE	7	3	BRASS	66399-2
		7	2	BRASS	66399-1
	STANDARD	1	BRASS	66399-4	66331-4
	STANDARD	3	BRASS	66399-2	66331-2
	STANDARD	2	BRASS	66399-1	66331-1
	REELING	BODY FINISH	BODY MATERIAL	LOOSE PIECE REF	PART NO.

THIS DRAWING IS A CONTROLLED DOCUMENT.		DWN	08/06/91	TE Connectivity	
		CHK	9-19-91		
		APVD	9-20-91		
		PRODUCT SPEC			
DIMENSIONS: mm [INCHES]		TOLERANCES UNLESS OTHERWISE SPECIFIED:		NAME	
		0 PLC	± -	APPLICATION SPEC	
		1 PLC	± -	SIZE	
		2 PLC	± 0.13 [.005]	CAGE CODE	
		3 PLC	± -	DRAWING NO	
MATERIAL SEE CALLOUTS		4 PLC	± -	RESTRICTED TO	
		ANGLES	± -	WEIGHT	
		FINISH	SEE CALLOUTS	CUSTOMER DRAWING	
				SCALE	8:1
				SHEET	1 of 1
				REV	Z

# Mouser Electronics

Authorized Distributor

Click to View Pricing, Inventory, Delivery & Lifecycle Information:

[TE Connectivity:](#)

[66331-7](#)