

REVISIONS					
P	LTR	DESCRIPTION	DATE	DWN	APVD
B		ECO-06-028040	30NOV2006	LAM	JW
C		REVISED PER ECN-21-104603	25MAY2021	AK	SZ

D

D

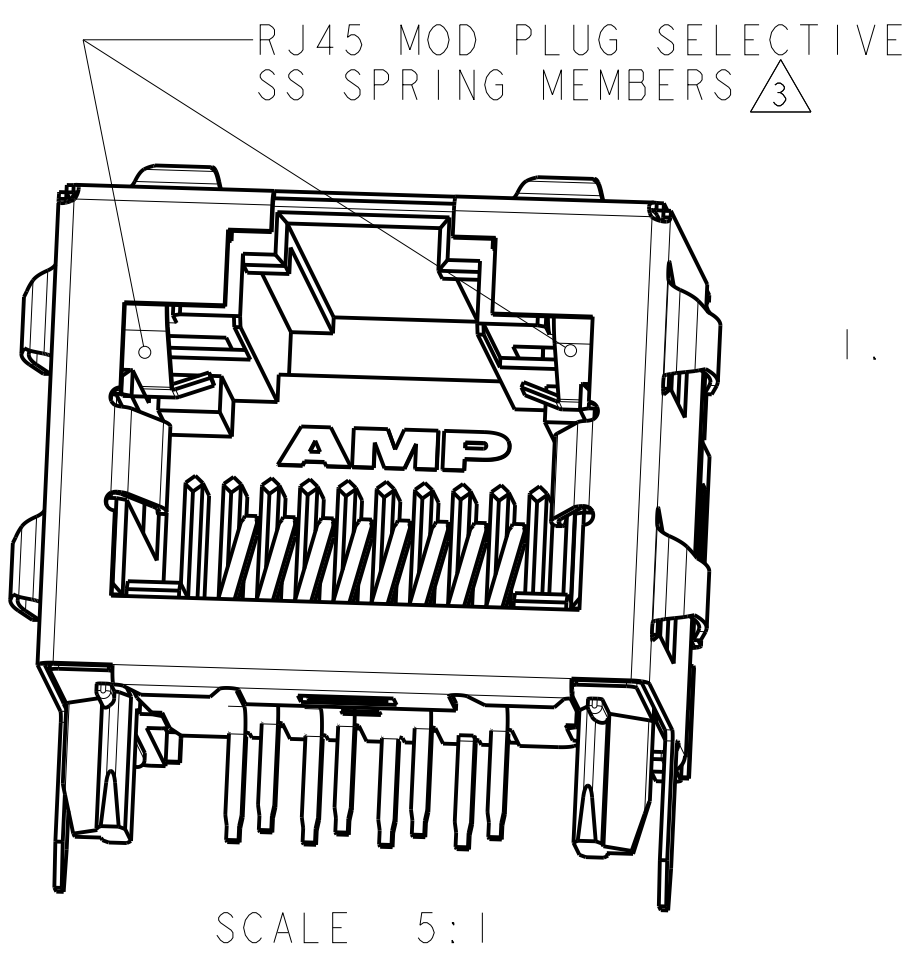
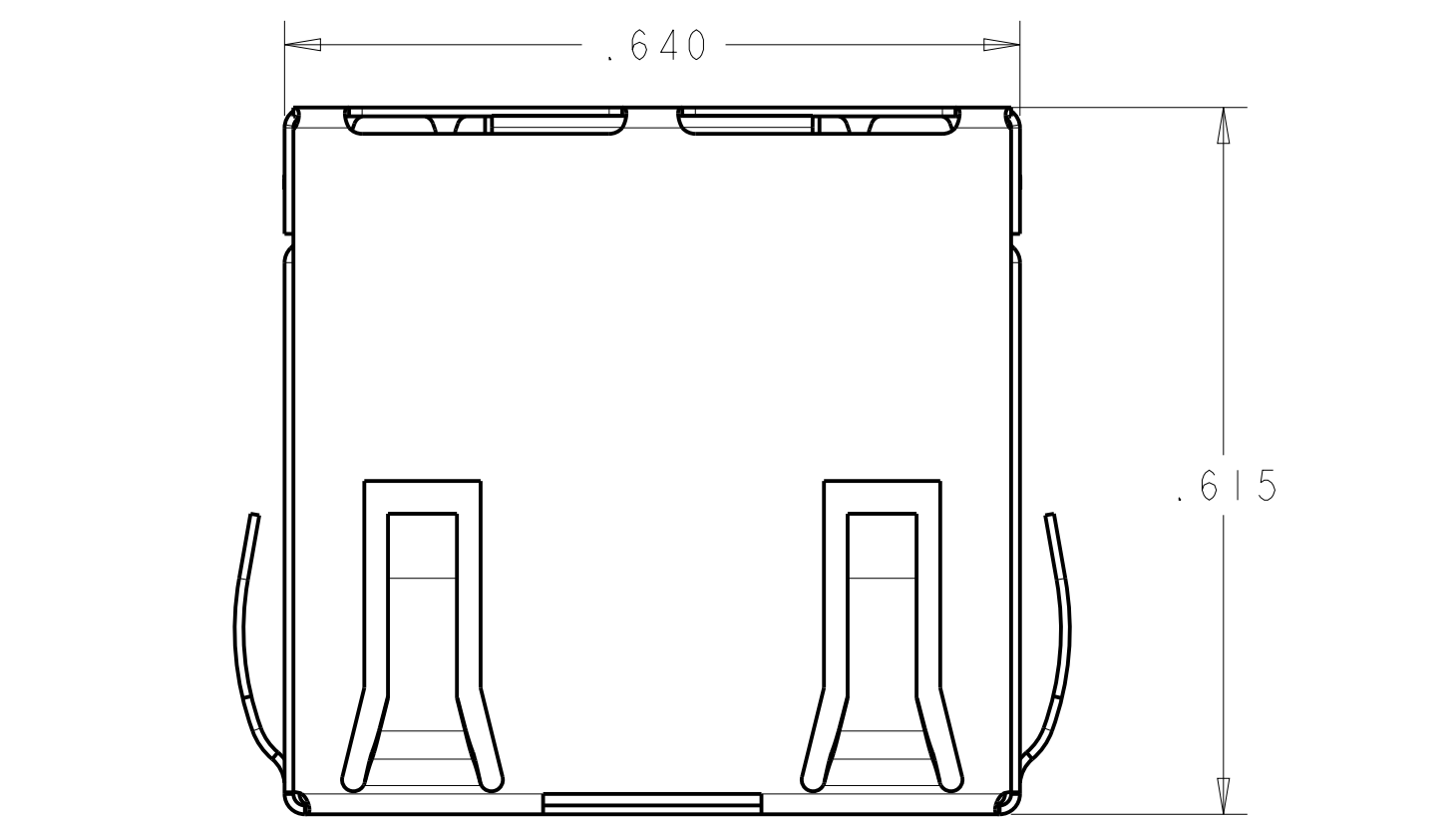

1. MATERIAL:
- HOUSING -- COLOR: BLACK, HIGH TEMPERATURE THERMOPLASTIC, PER UL94V-0; IR REFLOW SOLDERING PROCESS COMPATIBLE.
- TERMINALS -- .014 THICK PHOSPHER BRONZE PLATING -- .000050 INCHES GOLD IN CONTACT AREA, .000150 INCHES MATTE TIN ON SOLDER TAILS, ALL OVER .000050 INCHES OF NICKEL.
- SHIELD -- .0077 THICK COPER ZINC ALLOY, PREPLATED WITH .000050 INCHES MIN SATIN NICKEL WITH .000080 INCHES MIN TIN POST DIPPED ON PCB GROUND TABS.

C

C

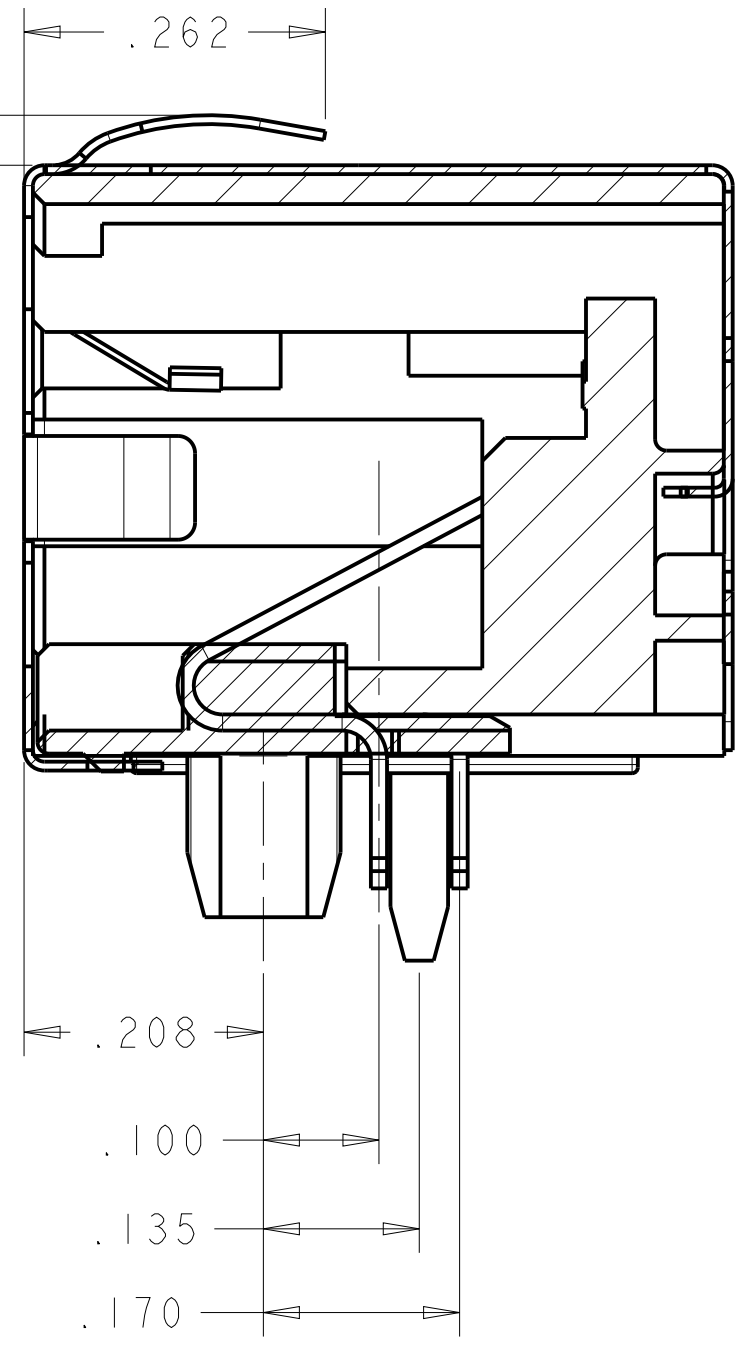
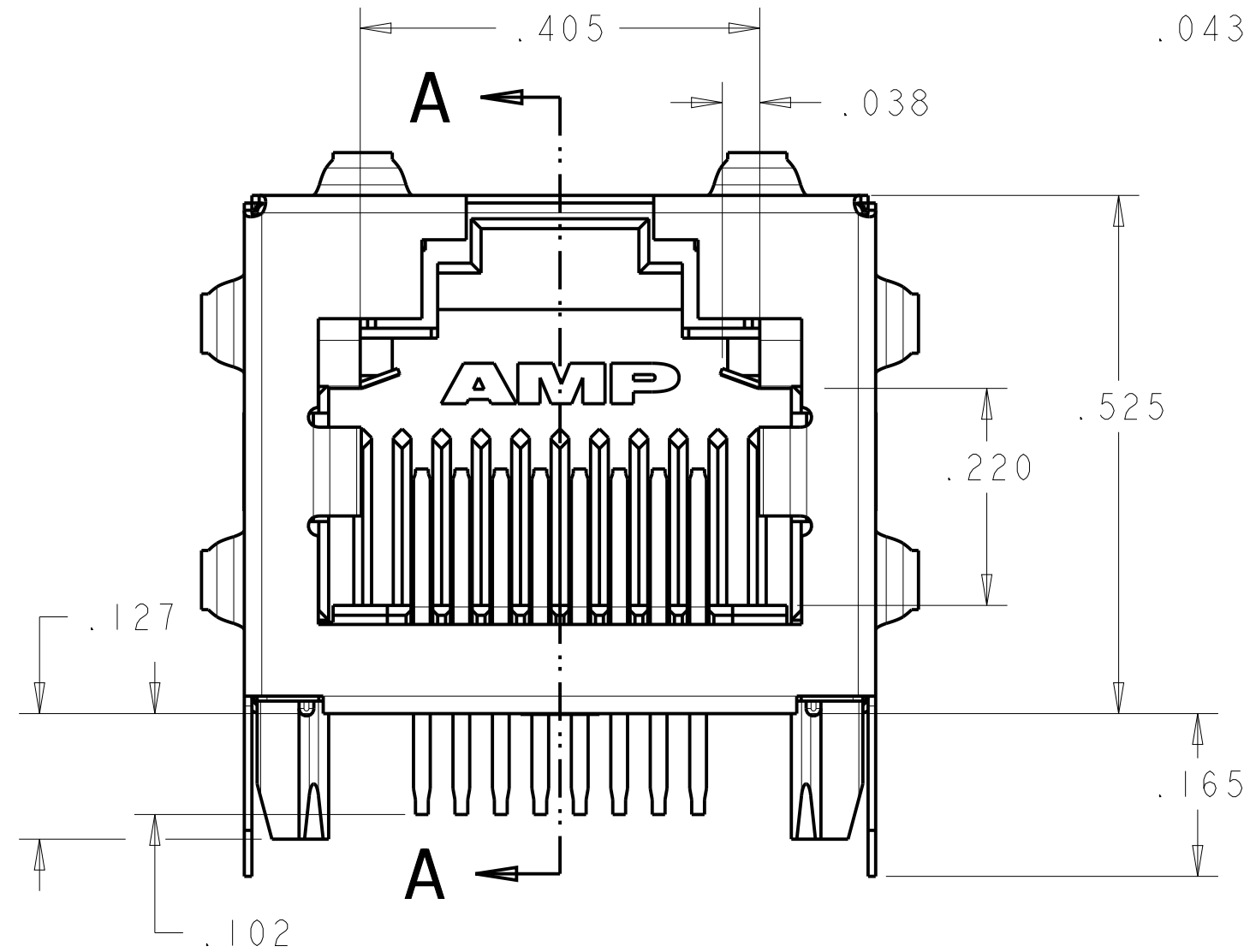

2. JACK CAVITY CONFORMS TO FCC RULES AND REGULATIONS PART 68, SUBPART F.
3. RJ45 MOD PLUG SELECTIVE -- THIS CONNECTOR UTILIZES 2 STAINLESS STEEL SPRING MEMBERS WHICH PREVENT THE INSERTION OF A RJ11 (6 POSITION) PLUG INTO THE JACK PORT, WHILE ALLOWING A RJ45 (8 POSITION) PLUG TO MATE FREELY.
- WARNING: THIS FEATURE WAS DEVELOPED FOR TYPICAL PLUG INSERTION FORCES. EXCESSIVE INSERTION FORCE MAY OVERCOME THE SELECTIVE FEATURES AND DAMAGE THE CONNECTOR.

B

6364288  
B

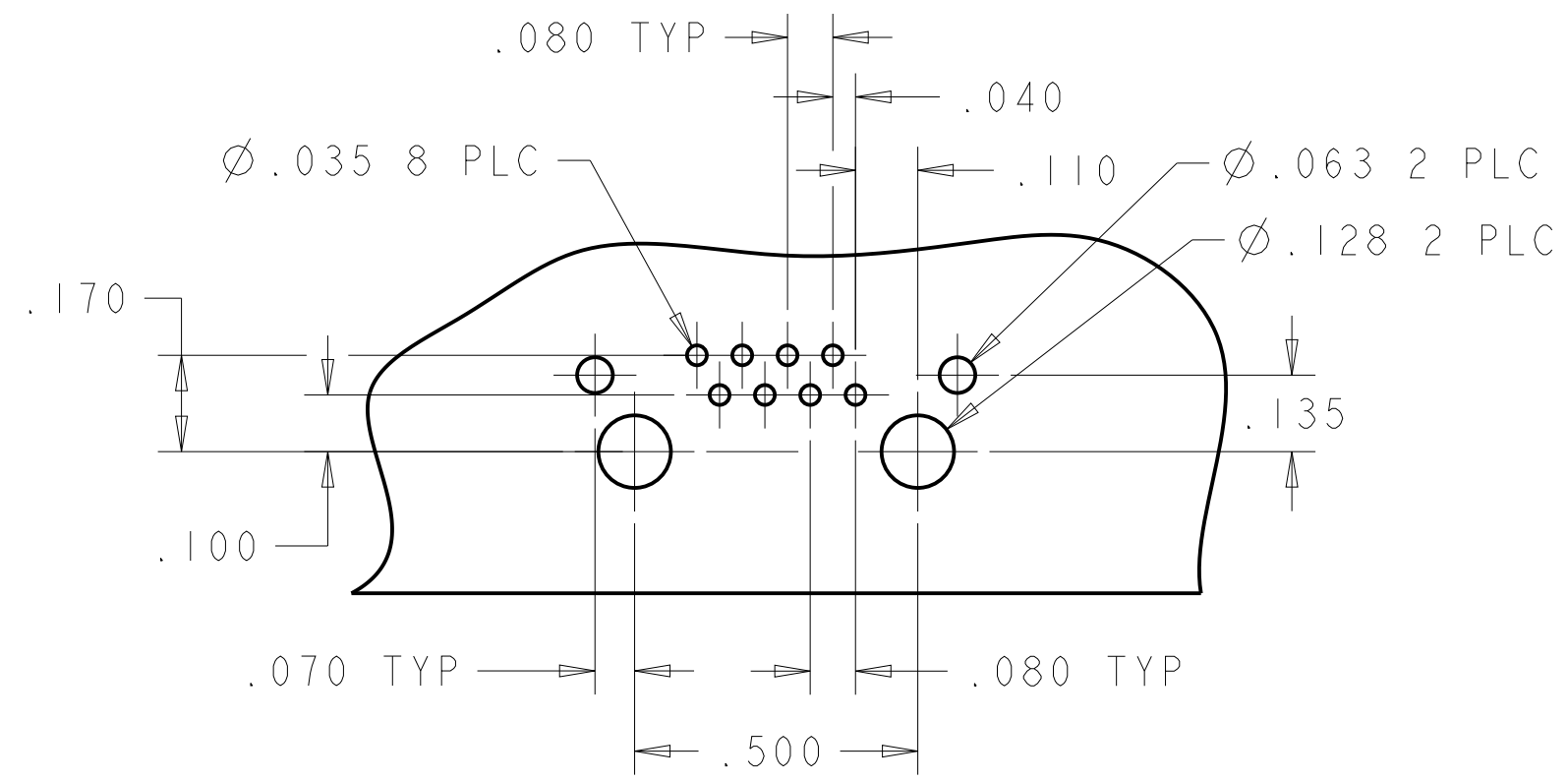

SECTION A-A

NONE	6364288-4
AS SHOWN	6364288-1
TYCO LOGO	PART NUMBER

A

A

THIS DRAWING IS A CONTROLLED DOCUMENT.

DIMENSIONS:  
INCHES

MATERIAL  
SEE NOTE 1

TOLERANCES UNLESS OTHERWISE SPECIFIED:

0 PLC	±
1 PLC	±
2 PLC	±
3 PLC	±.013
4 PLC	±
ANGLES	±
FINISH	±

SEE NOTE 1

DWN  
L.A.MAYER  
09MAY2005

CHK  
J.WESTMAN  
09MAY2005

APVD  
S.FLICKINGER  
09MAY2005

PRODUCT SPEC  
108-1163-4

APPLICATION SPEC  
114-2154

WEIGHT  
-

CUSTOMER DRAWING

TE Connectivity

NAME  
INVERTED MOD JACK ASSEMBLY, 1 X 1, SHIELDED, PANEL GROUNDS, RJ45 MOD PLUG SELECTIVE CAPABILITY

SIZE  
A200779

CAGE CODE  
C-6364288

DRAWING NO  
C-6364288

RESTRICTED TO

SCALE  
2:1

SHEET  
1

OF  
1

REV  
C

# Mouser Electronics

Authorized Distributor

Click to View Pricing, Inventory, Delivery & Lifecycle Information:

[TE Connectivity:](#)

[6364288-1](#)