

REVISIONS					
P	LTR	DESCRIPTION	DATE	DWN	APVD
	A	RELEASE TO PRODUCTION	02APR2020	AY	PS
	A1	34 POSITION ADDED	11MAR2021	AY	PS

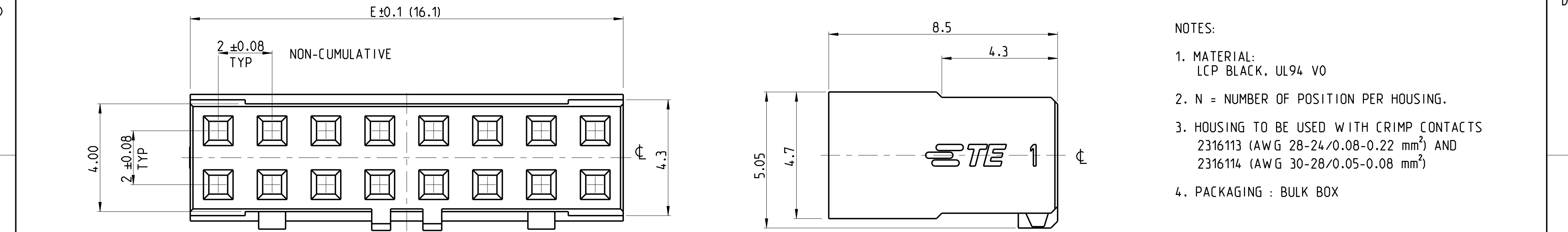

- NOTES:
1. MATERIAL:
LCP BLACK, UL94 V0
 2. N = NUMBER OF POSITION PER HOUSING.
 3. HOUSING TO BE USED WITH CRIMP CONTACTS
2316113 (AWG 28-24/0.08-0.22 mm²) AND
2316114 (AWG 30-28/0.05-0.08 mm²)
 4. PACKAGING : BULK BOX

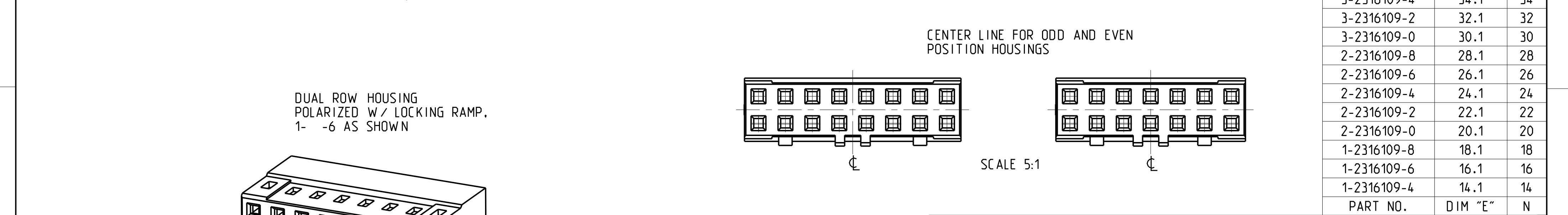
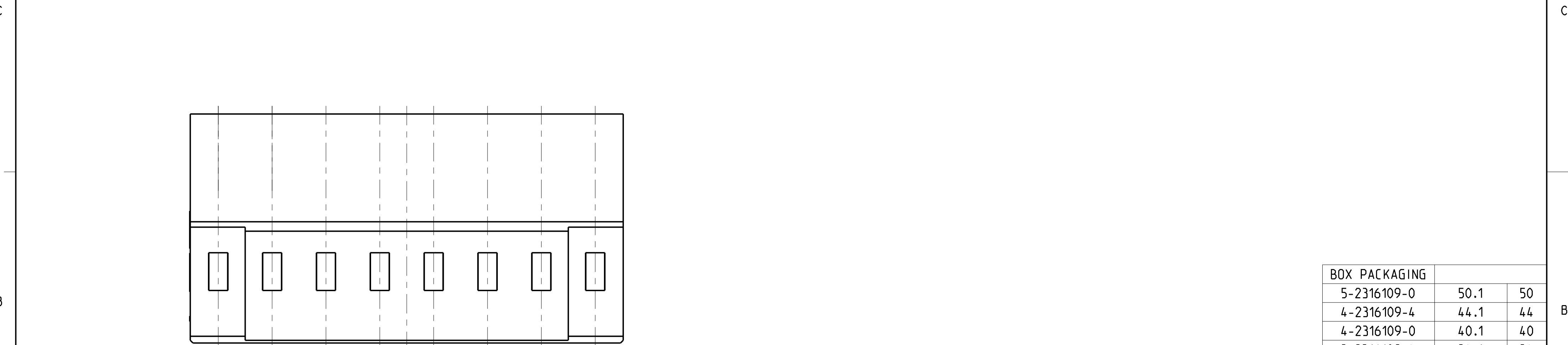

DUAL ROW HOUSING
POLARIZED W/ LOCKING RAMP.
1- -6 AS SHOWN

THIS DRAWING IS A CONTROLLED DOCUMENT.		DWN 06SEP2016 RAKSHITH R NAYAK	TE Connectivity	
DIMENSIONS: mm		CHK 06SEP2016 PRASHANTH S		
	TOLERANCES UNLESS OTHERWISE SPECIFIED: 0 PLC ± 1 PLC ±0.15 2 PLC ±0.10 3 PLC ± 4 PLC ± ANGLES ±2° FINISH -	APVD 06SEP2016 PRASHANTH S	NAME AMPMODU 2mm RECEPTACLE, wIB HOUSING, CRIMP, DR. W/ LOCK RAMP	
		PRODUCT SPEC 108-64040-1	SIZE A2	CAGE CODE 00779
MATERIAL SEE NOTE 1		APPLICATION SPEC 114-32173	RESTRICTED TO -	
		WEIGHT -	SCALE 10:1	SHEET 1 OF 1
		CUSTOMER DRAWING	REV A1	

Mouser Electronics

Authorized Distributor

Click to View Pricing, Inventory, Delivery & Lifecycle Information:

[TE Connectivity:](#)

[2-2316109-0](#)