

NOTES:

- 1 FOR USE ON STANDARD APPLICATORS.(RIGHT-LEFT FEED)
- 2 FOR USE ON MINIATURE APPLICATORS.(LEFT-RIGHT FEED)
- 3 FOR USE ON MINIATURE APPLICATORS,
AMP O-MATOR APPLICATION.(LEFT-RIGHT FEED)
- 4 OBSOLETE PARTS: OBSOLETE CIS STREAMLINING PER D.RENAUD/D.SINISI

FOR 2,1 DIA. PIN.
MATE-N-LOK PIN

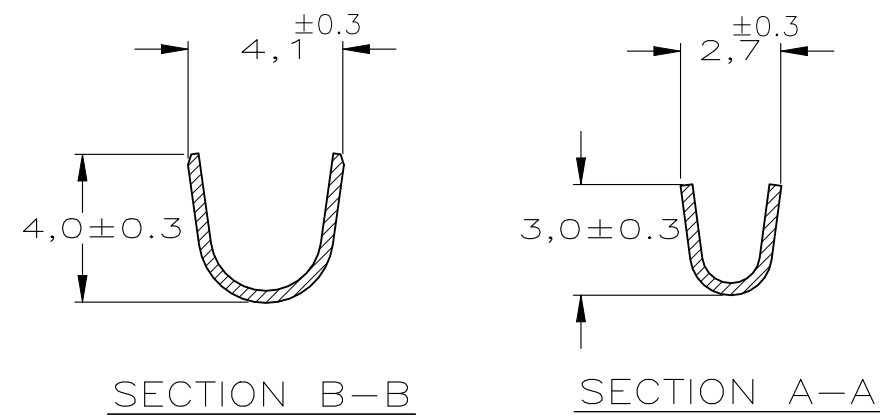

WIRE RANGE :
0,5-1,0mm² AWG
INSULATION RANGE :
1,8-3,3mm DIA.

4	OBSOLETE	2	SEL. GOLD	BRASS	8=163300=1
	OBSOLETE	3	PRE-TINPLATED	BRASS	1=163300=5
		2	PRE-TINPLATED	PHOSPHOR BR.	163300=8
	OBSOLETE	2	UNPLATED	PHOSPHOR BR.	163300=7
		2	PRE-TINPLATED	BRASS	163300=6
	OBSOLETE	2	UNPLATED	BRASS	163300=5
4	OBSOLETE	1	PRE-TINPLATED	PHOSPHOR BR.	163300=4
		1	UNPLATED	PHOSPHOR BR.	163300=3
		1	PRE-TINPLATED	BRASS	163300=2
	OBSOLETE	1	UNPLATED	BRASS	163300=1
		PLATING		MATERIAL	PARTNUMBER

—	—	—	—	—	CUSTOMER DRAWING				FOR REFERENCE ONLY WILL NOT BE UPDATED		
—	—	—	—	—	© COPYRIGHT — BY						
—	—	—	—	—	ALL INTERNATIONAL RIGHTS RESERVED.						
—	—	—	—	—	THIS DRAWING IS UNPUBLISHED RELEASED FOR PUBLICATION _____,19____						
J4	REVISED PER ECR-21-111103		PJ	VS	18AUG2021	 TE Connectivity		NAME SOCKET MATE-N-LOK.			
J3	REVISED PER ECR-21-101087		PJ	VS	11MAY2021						
J2	REVISED PER ECO-11-005294		RK	HMR	13APR11						
LTR.	REVISION RECORD		DR.	CHK.	DATE						
DR.: J.V.D.HEIJDEN.		CHK.: A.BIJNEN.		APP.: L.V.SOEST.		DWG.No.			REV.LTR.	SHEET	A3
DATE: 10-04-92		DATE: —		DATE: —		163300			J4	1 OF 1	

Mouser Electronics

Authorized Distributor

Click to View Pricing, Inventory, Delivery & Lifecycle Information:

[TE Connectivity:](#)

[163300-6 \(Cut Strip\)](#)