

D

C

B

A

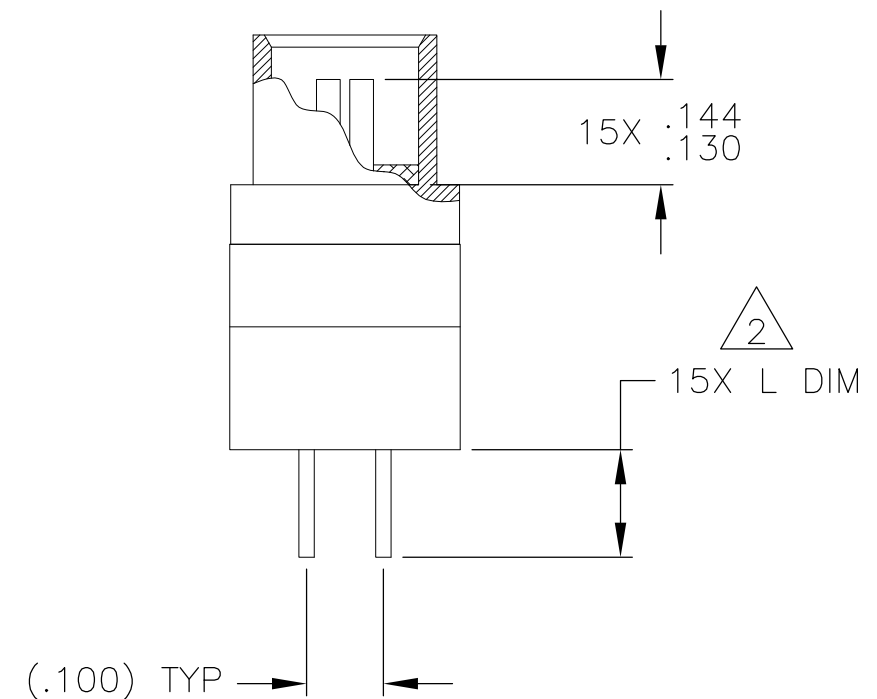
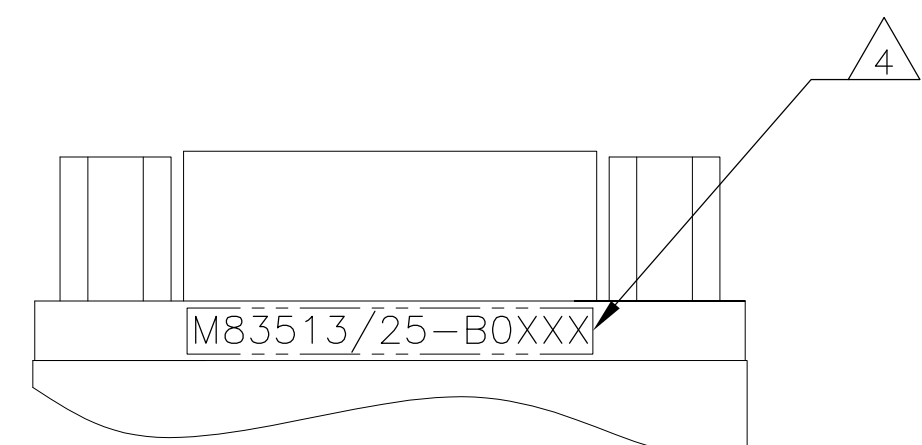
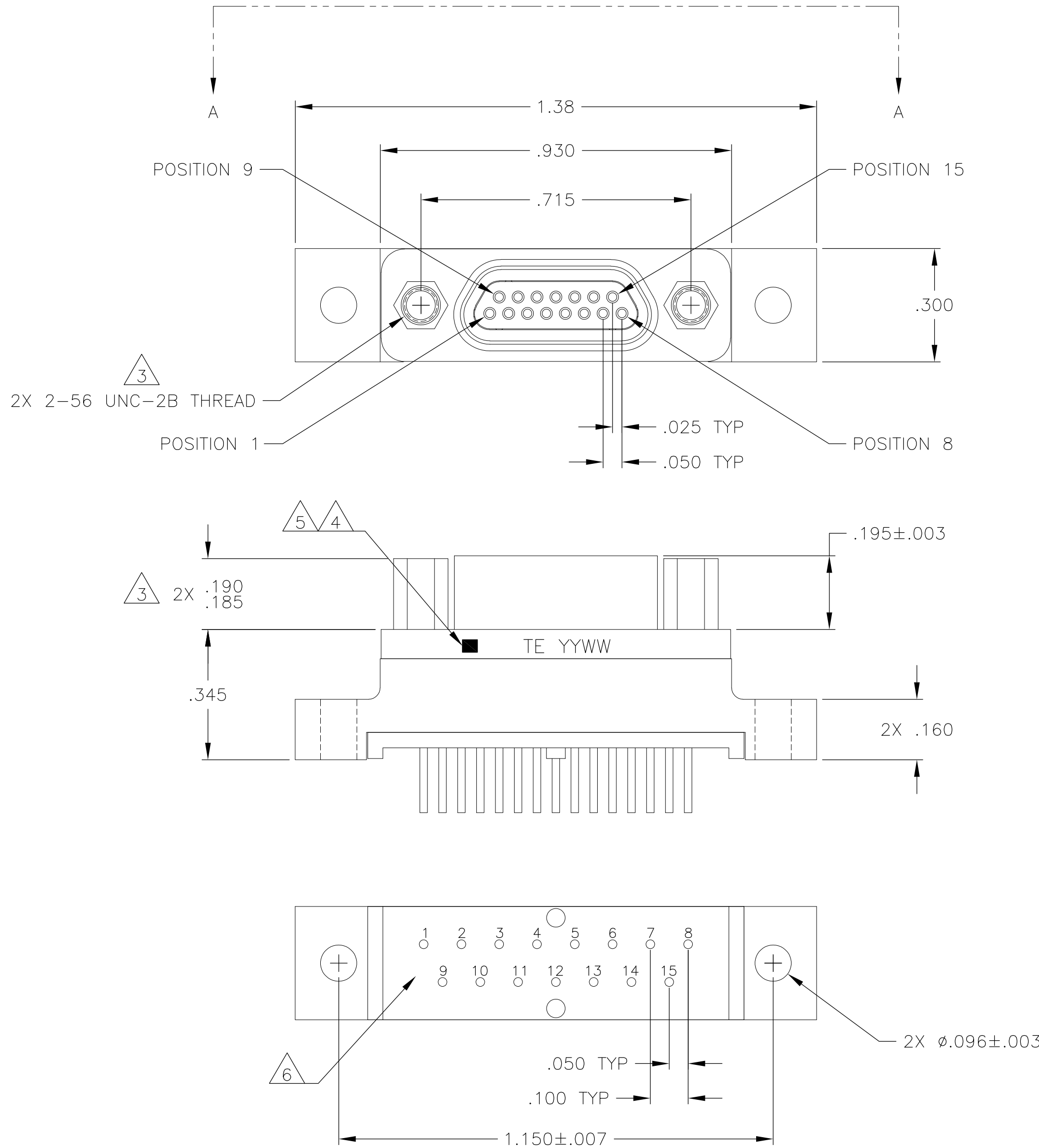

JACKPOSTS OMITTED
FOR CLARITY

SEE SHEET 2 FOR NOTES

THIS DRAWING IS A CONTROLLED DOCUMENT.		DWN C SCHOLL 2 JUL 12	TE Connectivity	
DIMENSIONS: INCHES		CHK — APVD M STORRY 2 JUL 12		
TOLERANCES UNLESS OTHERWISE SPECIFIED:		PRODUCT SPEC — APPLICATION SPEC — WEIGHT —	NAME RECEPTACLE ASSEMBLY, MCKS, ST1 STRAIGHT TERMINATION, PCB MOUNT, 2 ROW, SIZE 15, PER MIL-DTL-83513/25	
MATERIAL SEE NOTES		FINISH SEE NOTES	SIZE A2	CAGE CODE 98278
			DRAWING NO C=1532275	RESTRICTED TO —
			SCALE 4:1	SHEET 1 OF 2
			REV A	

4

3

2

1

THIS DRAWING IS UNPUBLISHED.

RELEASED FOR PUBLICATION

© COPYRIGHT - By -

ALL RIGHTS RESERVED.

LOC

DIST

REVISIONS

P	LTR	DESCRIPTION	DATE	DWN	APVD
	-	SEE SHEET 1	-	-	-

TE PART NUMBER	MIL-DTL-83513 PIN	MCKS DESCRIPTION	SHELL FINISH	HARDWARE	L DIM±.015
1532275-1	M83513/25-B01CN	MCKS-C2-B-15SST1	CADMIUM	NONE	.109
1532275-2	M83513/25-B01CP	MCKS-C2-P-15SST1	CADMIUM	JACKPOSTS	.109
1532275-3	M83513/25-B01NN	MCKS-N1-B-15SST1	NICKEL	NONE	.109
1532275-4	M83513/25-B01NP	MCKS-N1-P-15SST1	NICKEL	JACKPOSTS	.109
1532275-5	M83513/25-B02CN	MCKS-C2-B-15SST1A	CADMIUM	NONE	.140
1532275-6	M83513/25-B02CP	MCKS-C2-P-15SST1A	CADMIUM	JACKPOSTS	.140
1532275-7	M83513/25-B02NN	MCKS-N1-B-15SST1A	NICKEL	NONE	.140
1532275-8	M83513/25-B02NP	MCKS-N1-P-15SST1A	NICKEL	JACKPOSTS	.140
1532275-9	M83513/25-B03CN	MCKS-C2-B-15SST1B	CADMIUM	NONE	.172
1-1532275-0	M83513/25-B03CP	MCKS-C2-P-15SST1B	CADMIUM	JACKPOSTS	.172
1-1532275-1	M83513/25-B03NN	MCKS-N1-B-15SST1B	NICKEL	NONE	.172
1-1532275-2	M83513/25-B03NP	MCKS-N1-P-15SST1B	NICKEL	JACKPOSTS	.172

1

SHELL MATERIAL: 6061-T6 ALUMINUM
FINISH OPTIONS:
ELECTROLESS NICKEL PLATED PER SAE-AMS-C-26074 OR SAE AMS 2404 OR CADMIUM PLATED PER SAE-AMS-QQ-P-416 WITH YELLOW CHROMATE
INSULATOR: LIQUID CRYSTAL POLYMER (LCP)
HARDWARE: 300 SERIES STAINLESS STEEL
TB BOX: POLYPHENYLENE SULFIDE (PPS) AND EPOXY POTTING

2

TERMINATION: 24AWG GOLD PLATED COPPER WIRE, Sn63Pb37 SOLDER DIPPED UP TO MOUNTING SURFACE AT A MINIMUM

3

JACKPOST HARDWARE SHALL BE PERMANENTLY INSTALLED AS SHOWN WHEN REQUIRED BY THE MIL PIN. JACKPOST DIMENSIONS AND REQUIREMENTS ARE DEFINED IN MIL-DTL-83513/5.

4

CONNECTOR SHALL BE MARKED IN ACCORDANCE WITH METHOD I OF MIL-STD-1285. MARKING SHALL CONTAIN THE MILITARY PIN, CAGE CODE (OR TE), AND DATE CODE. EXAMPLE: M83513/25-BOXXX TE YYWW (WHERE XXX IS PART OF THE PIN SHOWN IN THE "MIL-DTL-83513 PIN" COLUMN OF THE PART NUMBER TABLE, AND YYWW IS THE DATE CODE). FOR THE SIZE 15 RECEPTACLE, THE MARKING MUST BE PRINTED ON BOTH SIDES OF THE FLANGE. TEXT HEIGHT SHALL BE .035 INCH MINIMUM.

5

POSITION 1 SHALL BE INDICATED BY AN IDENTIFIABLE MARK, LOCATED APPROXIMATELY AS SHOWN ON THE POSITION 1 SIDE OF THE CONNECTOR FLANGE. THIS MARK SHALL BE INCLUDED AS PART OF THE PART MARKING INFORMATION.

6

TERMINAL IDENTIFICATION NUMBERS AS SHOWN DO NOT ACTUALLY APPEAR ON THE PART (FOR IDENTIFICATION ONLY)

7

ALL REQUIREMENTS CONFORM TO MIL-DTL-83513/25. SEE MIL-SPEC FOR DETAILED INTERFACE DIMENSIONS AND SUGGESTED PCB LAYOUTS

THIS DRAWING IS A CONTROLLED DOCUMENT.

DIMENSIONS:
INCHES

MATERIAL

SEE NOTES

TOLERANCES UNLESS OTHERWISE SPECIFIED:

0 PLC ± -

1 PLC ± -

2 PLC ± .010

3 PLC ± .005

4 PLC ± -

ANGLES ± 1°

FINISH

SEE NOTES

DWN
C SCHOLL
CHK
-
APVD
M STORRY
PRODUCT SPEC
APPLICATION SPEC
WEIGHT
-
CUSTOMER DRAWING

2 JUL 12
2 JUL 12

TE Connectivity

NAME
RECEPTACLE ASSEMBLY, MCKS, ST1 STRAIGHT
TERMINATION, PCB MOUNT, 2 ROW,
SIZE 15, PER MIL-DTL-83513/25

SIZE
A2

CAGE CODE
98278

DRAWING NO
C=1532275

RESTRICTED TO
-

SCALE
4:1

SHEET
2 of 2

REV
A

1532275

1532275

1532275

1532275

1471-9 (3/11)

Mouser Electronics

Authorized Distributor

Click to View Pricing, Inventory, Delivery & Lifecycle Information:

[TE Connectivity:](#)

[1-1532275-0](#)