

REVISIONS			
LTR	DESCRIPTION	DATE	APPROVED
C	REVISED PER ECN T-013336	890928	J.BLAIR
D	REVISED PER DCR# T-22996	6/11/99	M.HIGGY

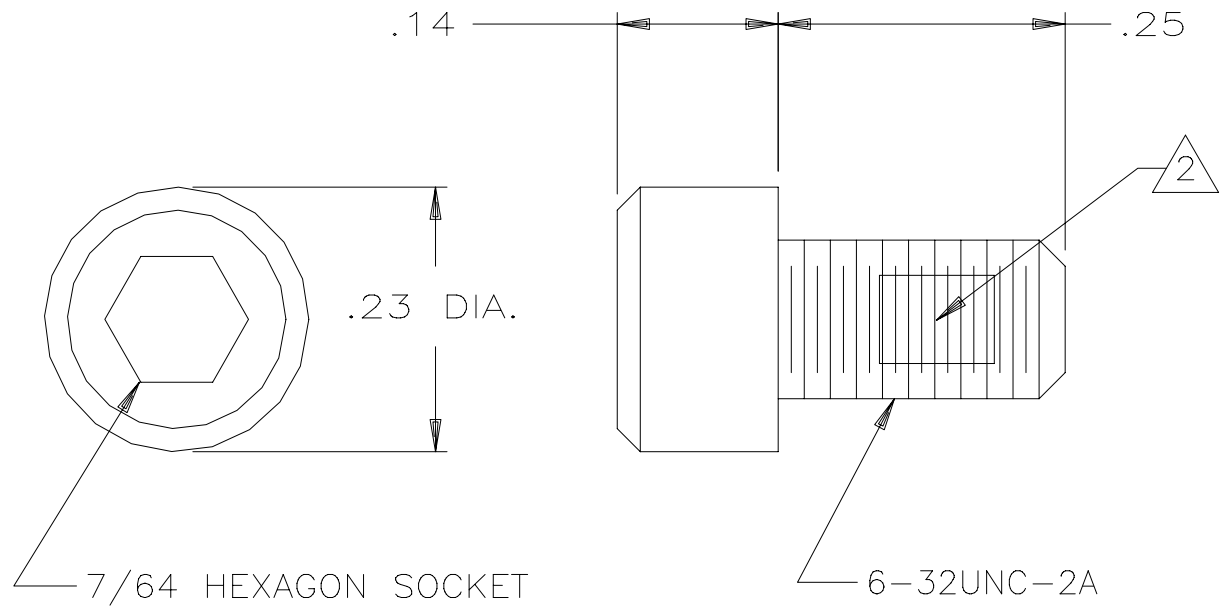

NOTES:

1. PART USED WITH MTC RECEPTACLE ASSEMBLIES.
2. SCREW PROVIDED WITH LOCKING ELEMENT IN ACCORDANCE WITH MIL-F-18240, CONFIGURATION B.
3. WEIGHT: .0021 Lbs. [.93 gr.] MAXIMUM.
4. MATERIAL: STAINLESS STEEL PER QQ-S-763
FINISH: PASSIVATED PER QQ-P-35

If this document is printed it becomes uncontrolled.
Check with the web for latest revision.

SPECIFICATION CONTROL DRAWING

UNLESS OTHERWISE SPECIFIED DIMENSIONS ARE IN INCHES. METRIC DIMENSIONS ARE IN BRACKETS. DECIMALS .XXX ± .005 { mm } .XX ± .01 { mm } ANGLES .X ± WEIGHT 3 lbs { g }	DRAWN	V.D.T.	8-19-76	<i>Raychem</i> RAYCHEM CORPORATION 300 CONSTITUTION DRIVE MENLO PARK, CALIFORNIA 94025	TITLE <h3 style="margin: 0;">MTC ADAPTOR SCREW</h3>			
	CHECKED	DCT	9-2-76					
	APPROVED	RAS	9-3-76					
	APPROVED	P.M.N.	9-3-76					
CAD NAME				T22996.DWG				
THIRD ANGLE PROJECTION				SIZE	CODE IDENT. NO.	DWG. NO.	REV	
				A	06090	D-659-0044	D	
DO NOT SCALE THIS DRAWING						SHEET 1 OF 1		

Mouser Electronics

Authorized Distributor

Click to View Pricing, Inventory, Delivery & Lifecycle Information:

[TE Connectivity:](#)

[699360-000](#)