

| REVISIONS | | | | | |
|-----------|-----|-----------------|-----------|-----|------|
| P | LTR | DESCRIPTION | DATE | DWN | APVD |
| | A | INITIAL RELEASE | 30JUL2019 | RV | DH |

7012

*

*

*

| TERM. BLOCK PART NO. | |
|--------------------------|----------|
| 32650-02 | |
| HARDWARE ASSY PART NO. | |
| | |
| STANDARD | 32694-03 |
| W/K COILS | 32694-10 |
| W/L27 COIL | 32694-14 |
| W/L7,L21,L22 & L24 COILS | 32694-04 |
| PACKAGING ASSY PART NO. | |
| 32707-01 (STANDARD) | |
| W/OPTION GZ | 32707-06 |
| W/OPTION K | |
| W/OPTION P | |
| W/OPTION U | |
| W/OPTION W | |
| W/OPTION X | 32849-01 |
| W/OPTION L | |
| W/OPTION LL | |
| W/OPTION T | |

| ENCL. CODE | NOMIAL VOLTAGE | FREQ. HZ | PART NO. |
|------------|----------------|----------|----------|
| A | 120V | 60 | 32274-01 |
| B | 240V | 60 | 32274-02 |
| C | 480V | 60 | 32274-03 |
| D | 550V | 60 | 32274-04 |
| E | 24V | 60 | 32274-05 |
| F | 127V | 50 | 32274-06 |
| G | 240V | 50 | 32274-07 |
| H | 12V | 60 | 32274-08 |
| I | 6V | 60 | 32274-09 |
| J | 208V | 60 | 32274-10 |
| K | 120V 240V | 60 | 32274-11 |
| K1 | 120V 240V | 60 | 32274-12 |
| L1 | 12V | 50 | 32274-13 |
| L2 | 24V | 50 | 32274-14 |
| L3 | 48V | 50 | 32274-15 |
| L4 | 380V | 60 | 32274-16 |
| L5 | 208V | 50 | 32274-17 |
| L6 | 380V | 50 | 32274-18 |
| L7 | 120V | 25-400 | 32274-19 |
| L8 | 110V | 60 | 32274-20 |
| L9 | 220V | 60 | 32274-21 |
| L10 | 440V | 60 | 32274-22 |
| L12 | 110V | 50 | 32274-23 |
| L13 | 220V | 50 | 32274-24 |
| L15 | 415V | 50 | 32274-25 |
| L16 | 440V | 50 | 32274-26 |
| L17 | 500V | 50 | 32274-27 |
| L18 | 550V | 50 | 32274-28 |
| L19 | 48V | 60 | 32274-29 |
| L20 | 70V | 60 | 32274-30 |
| L21 | 208V | 25-400 | 32274-31 |
| L22 | 240V | 25-400 | 32274-32 |
| L23 | 32V | 50 | 32274-33 |
| L24 | 440V | 25-400 | 32274-34 |
| L25 | 120V | 60 | 32274-35 |
| L26 | 277V | 60 | 32274-36 |
| L27 | 208V 240V | 60 | 32274-37 |
| L28 | 120V | 60 | 32274-38 |

| TIME CODE | TIME RANGE | TIME COMP. ASSY P/N | TIME HEAD ASSY P/N |
|-----------|-------------|---------------------|--------------------|
| A | .1-1 SEC. | 32302-01 | 32625-05 |
| B | .5-5 SEC. | 32302-02 | 32625-01 |
| C | 1.5-15 SEC. | 32302-03 | |
| D | 5-50 SEC. | 32302-04 | |
| E | 20-200 SEC. | 32302-05 | |
| F | 1-10 MIN. | 32302-06 | |
| H | 3-30 MIN. | 32302-07 | 32625-09 |
| I | 6-60 MIN. | 32302-08 | |
| J | 3-120 CYC. | 32302-09 | 32625-09 |
| K | 1-300 SEC. | 32302-10 | 32625-01 |

| OPTION CODE | OPTION * | OPTION PART NO. | OUTLINE & DIM.DWG. |
|-------------|---------------------------|-----------------|--------------------|
| A1 | SINGLE Q.C. TERMINALS | 32728-01 | SS-625 |
| A2 | DOUBLE Q.C. TERMINALS | 32729-01 | SS-626 |
| B | PLUG-IN TERMINALS | 32730-01 | SS-627 |
| BC | PLUG-IN & RECEPT. (ST) | 32731-01 | SS-628 |
| BD | PLUG-IN & RECEPT. (Q.C) | 32732-01 | SS-629 |
| GZ | ENCLOSURE, NEMA 2 | 32733-01 | SS-633 |
| I1 | TIME HEAD CAP (BLACK) | 32734-01 | SS-634 |
| I2 | TIME HEAD CAP (CLEAR) | 32734-02 | SS-634 |
| K | EXPL. PROOF ENCLOSURE | 32807-01 | N/A |
| M | DUST TIGHT GASKETS | 32737-01 | SS-631 |
| P | OCTAL PLUG-IN | 32738-01 | SS-630 |
| S | DIAL STOPS | 32741-01 | SS-632 |
| T | AUX.SWITCH T.S. TIMING | 32742-01 | SS-641 |
| U | DUST TIGHT ENCLOSURE | 32744-01 | SS-636 |
| W | WATER-TIGHT ENCL.NEMA 4 | 32745-01 | SS-635 |
| X | PANEL MOUNT | 32748-01 | N/A |
| Y1 | HORIZ. CALIB. W/O X | 32726-01 | N/A |
| Y2 | HORIZ. CALIB. W/COMP.SPG. | 32727-01 | N/A |
| L | AUX.SW. (INST. XFER) | 32739-01 | SS-638 |
| LL | (2) AUX.SW. (INST. XFER) | 32739-03 | SS-638 |

| FIELD INSTALLATION KITS | | | |
|-------------------------|----------|--------------------------------|----------|
| CATALOG NUMBER | KIT CODE | DESCRIPTION | PART NO. |
| 700062 | I1 | TAMPER-PROOF COVER (BLACK) | 32708-01 |
| 700071 | I2 | TAMPER-PROOF COVER (CLEAR) | 32708-02 |
| 700034 | K | ENCLOSURE, EXPL.PROOF | 32736-01 |
| 700099 | W | ENCLOSURE, WATER-TIGHT, NEMA 4 | 32746-01 |
| 700077 | B | PLUG-IN MOUNTING | 32725-01 |
| 700042 | GZ | ENCLOSURE, NEMA 2 | 32913-01 |
| 700047 | L | AUX. SWITCH (INST. XFER) | 32740-01 |
| 700097 | P | OCTAL PLUG ADAPTER | 32912-01 |
| 700121 | T | AUX. SWITCH (TWO-STEP TIMING) | 32743-01 |
| 700041 | X | PANEL MOUNTING | 32749-01 |
| 700030 | - | SWITCH BLOCK ASSY | 32911-01 |
| 700137 | - | PLUG-IN RECEPT. (SCREW TERM.) | 32324-01 |
| 700141 | - | PLUG-IN RECEPT. (Q.C. TERM.) | 32324-02 |
| 700048 | LL | DOUBLE AUX. SWITCH KIT | 32026-01 |

NOTES:

- ① WHEN L7, L21, L22 OR L24 COILS ARE SPECIFIED, SUBSTITUTE TIME HEAD ASSY AS FOLLOWS:
USE 32625-06 IN PLACE OF 32625-05
USE 32625-02 IN PLACE OF 32625-01
USE 32625-10 IN PLACE OF 32625-09
AND TEST PER TP-TRE-05.
2. DIELECTRIC TEST PER TP-TRE-01.
3. PERFORMANCE TEST PER TP-TRE-02 (REF. ES-TRE-01 & ES-TRE-02)

* CAUTION SHOULD BE EXERCISED IN ORDERING (ASSIGNING) MULTIPLE OPTIONS - CONSULT PRODUCT MANAGER FOR VERIFICATION IF NECESSARY.

| | | | | | | | | | | | |
|--|--|--|--|-----------------|--|--|--|--|--|---------------|--|
| THIS DRAWING IS A CONTROLLED DOCUMENT. | | DWN RV | | 30JUL2019 | | <div> TE Connectivity</div> | | | | | |
| | | CHK RV | | 30JUL2019 | | | | | | | |
| DIMENSIONS: INCHES | | <div>TOLERANCES UNLESS OTHERWISE SPECIFIED:</div> <div><div>0 PLC ± -</div><div>1 PLC ± -</div><div>2 PLC ± -</div><div>3 PLC ± -</div><div>4 PLC ± -</div><div>ANGLES ± -</div></div> | | APVD DH | | 30JUL2019 | | NAME 7000 SERIES TIMING RELAY — — | | | |
| PRODUCT SPEC — | | | | | | | | | | | |
| APPLICATION SPEC — | | | | | | | | | | | |
| SIZE | | | | CAGE CODE | | DRAWING NO | | | | RESTRICTED TO | |
| MATERIAL — | | | | FINISH — | | WEIGHT 0 | | | | A3 | |
| CUSTOMER DRAWING | | | | | | SCALE NTS | | SHEET 1 OF 3 | | REV A | |

THIS DRAWING IS UNPUBLISHED.

RELEASED FOR PUBLICATION

© COPYRIGHT — TE Connectivity Ltd.

ALL RIGHTS RESERVED.

REVISIONS

| P | LTR | DESCRIPTION | DATE | DWN | APVD |
|---|-----|-------------|------|-----|------|
| | — | SEE SHEET 1 | — | — | — |

Outline Dimensions (Dimensions in inches)

Models 7012, 7022



Models 7014, 7024



Model 7032



Panel Mount Option "X"



Surge/Transient Protection Option



THIS DRAWING IS A CONTROLLED DOCUMENT.

DIMENSIONS:
INCHES

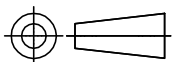

MATERIAL

TOLERANCES UNLESS
OTHERWISE SPECIFIED:

0 PLC ± —
1 PLC ± —
2 PLC ± —
3 PLC ± —
4 PLC ± —
ANGLES ± —

FINISH

DWN 30JUL2019

RV 30JUL2019

CHK 30JUL2019

RV 30JUL2019

APVD 30JUL2019

DH

PRODUCT SPEC

APPLICATION SPEC

WEIGHT 0

CUSTOMER DRAWING



TE Connectivity

NAME

7000 SERIES TIMING RELAY

SIZE CAGE CODE DRAWING NO RESTRICTED TO

A3 — C=7000—SERIES

SCALE NTS SHEET 2 of 3 REV A

THIS DRAWING IS UNPUBLISHED.

RELEASED FOR PUBLICATION

© COPYRIGHT — TE Connectivity Ltd.

ALL RIGHTS RESERVED.

REVISIONS

| P | LTR | DESCRIPTION | DATE | DWN | APVD |
|---|-----|-------------|------|-----|------|
| | — | SEE SHEET 1 | — | — | — |

Ordering Information

Typical Part No. ➤

70

1

2

A

D

GZ

1. Basic Series:

70 = 7000 series electropneumatic timing relay

2. Operation:

1 = On-delay
2 = Off-delay
3 = On-delay, off-delay (double head)

3. Contact Arrangement:

2 = 2PDT (2 form C)
**4 = 4PDT (4 form C)

4. Coil Voltage:

| | |
|-------------------------------------|-------------------------------------|
| AC Coils | DC Coils |
| A = 120VAC, 60 Hz.; 110VAC, 50Hz. | M = 28VDC |
| B = 240VAC, 60 Hz.; 220VAC, 50Hz. | N = 48VDC |
| C = 480VAC, 60 Hz. | O = 24VDC |
| D = 550VAC, 60 Hz. | P = 125VDC |
| E = 24VAC, 60 Hz. | Q = 12VDC |
| F = 127VAC, 50 Hz. | R = 60VDC |
| G = 240VAC, 50Hz. | S = 250VDC |
| H = 12VAC, 60 Hz. | T = 550VDC |
| K = Dual voltage (combines A & B) | U = 16VDC |
| L = Special AC coils (L1, L2, etc.) | V = 32VDC |
| | W = 96VDC |
| | Y = 6VDC |
| | Z = 220VDC |
| | X = Special DC coils (X1, X2, etc.) |

5. Timing Range:

Models 7012, 7022 & 7024

A = .1 to 1 sec.
B = .5 to 5 sec.
C = 1.5 to 15 sec.
D = 5 to 50 sec.
E = 20 to 200 sec.
F = 1 to 10 min.
H = 3 to 30 min.
I = 6 to 60 min.
J = 3 to 120 cyc.
K = 1 to 300 sec.

†Models 7014 & 7032

For model 7032 specify separate time range code for each head. Example: AB.
Any two ranges may be selected.
A = .2 to 2 sec.
B = .7 to 7 sec.
C = 2 to 20 sec.
D = 10 to 100 sec.
E = 30 to 300 sec.
F = 1.5 to 15 min.
H = 3 to 30 min.

6. Options:

| | |
|---|---|
| A1 = Single quick-connect terminals (note 4). | I2 = Tamper-proof Cap, transparent (Cannot be combined with Option X). |
| A2 = Double quick-connect terminals (note 4). | L = Auxiliary Switch, instant transfer. 7012 only (notes 2 & 6). |
| B = Plug-in connectors (note 4). | LL = Two Aux. Switches, instant transfer. On Model 7014 Factory Installed Only. (notes 2 & 6) |
| GZ = Enclosure with bottom knockouts (note 1). | M = Dust-tight Gasketing (notes 4 & 5). |
| H2 = Hermetically sealed enclosure, 8 pin solder (notes 1 & 4). | P = Octal Plug Adapter. Can be combined only with options I1, I2, M, S, X, or Y1. (note 4). |
| H3 = Hermetically sealed enclosure, 8 pin octal (notes 1 & 4). | S = Dial Stops. |
| H4 = Hermetically sealed enclosure, 8 screw terminal block (notes 1 & 4). | T = Auxiliary Switch, two-step timing (notes 2 & 6). |
| *H6 = Hermetically sealed enclosure, 11 pin solder (notes 1 & 4). | V = Transient/Surge Protection (for DC coil voltage only). |
| *H7 = Hermetically sealed enclosure, 11 pin octal (notes 1 & 4). | X = Panelmount includes hardware and adjustment for horizontal operation (note 4) |
| *H8 = Hermetically sealed enclosure, 11 screw terminal block (notes 1 & 4). | Y1 = Horizontal testing, for horizontal operation without panel mounting (note 4). |
| I1 = Tamper-proof Cap, opaque black (Cannot be combined with Option X). | Y2 = Horizontal testing, with Compensating Spring for vertical operation (note 4). |

Notes:

- Cannot be combined with B, P or X Options
- Cannot be combined with B, P or Y2 Options
- Cannot be combined with GZ, H, I1, I2, K, W or Y1 Options
- Not Avail. on 4-Pole Models
- Not Available with L, T or LL options.
- Not Available on hermetically sealed units.
- Sized to accommodate one L or T Auxiliary Switch
- ** Not available on 7032 model.

† Available with letter graduated dials only. Upper end of time range may be twice the value shown
†† 120 cycles = 2 sec.

Our authorized distributors are more likely to maintain the following items in stock for immediate delivery.

| | | | | | | | | |
|--------|--------|---------|--------|---------|--------|--------|---------|--------|
| 7012AA | 7012AE | 7012ACL | 7012PB | 7012PJ | 7022AA | 7022AE | 7022AJ | 7022PA |
| 7012AB | 7012AF | 7012BC | 7012PC | 7012PK | 7022AB | 7022AF | 7022AKT | 7022PB |
| 7012AC | 7012AH | 7012NC | 7012PD | 7012PKX | 7022AC | 7022AH | 7022BC | 7022PC |
| 7012AD | 7012AK | 7012PA | 7012PF | 7012PJX | 7022AD | 7022AI | 7022BK | 7022PK |

Ordering Options — Can only be ordered as factory installed options (Dimensions, where shown, are in inches)

A1 – Single Quick-Connect Terminals

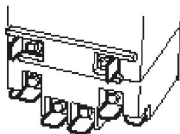

A2 – Double Quick-Connect Terminals

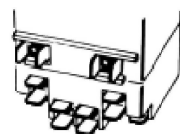

B – Plug-In Connectors
Use with Accessory "C" or "D" below.

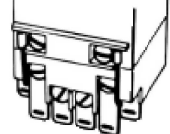

GZ – Metal Enclosure
With knockouts for bottom connection.
3.16" W x 3.84" D x 7.63"H

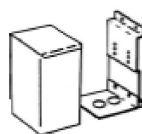

H – Hermetically Sealed Enclosure



I – Tamper-Proof Cover

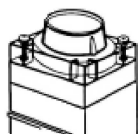

L – Auxiliary Switch

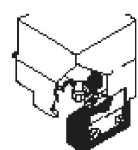

LL – Auxiliary Switch

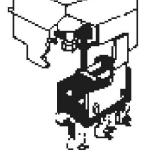

M – Dust tight

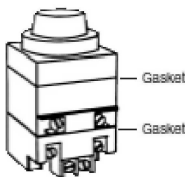

P – Octal Plug Adapter

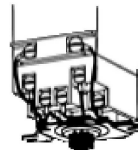

S – Dial Stops



T – Auxiliary Switch

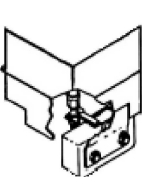

V – Transient/Surge Protection

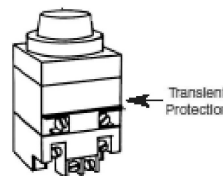

X – Panelmount Kit
Mounting hardware included.

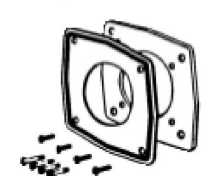

Accessories (Not available for 7032 models)

Plug-In Receptacle (Accessory C)



Screw Terminals
Catalog No. 700137.
For use with "B" Option.

Plug-In Receptacle (Accessory D)



Quick Connect Terminals
Catalog No. 700141.
For use with "B" Option.

Ordering options can only be ordered as factory installed options.

| | | | | | | | |
|--|--|------------------|-----------|--------------------------|-----------|---------------|---------------|
| THIS DRAWING IS A CONTROLLED DOCUMENT. | | DWN RV | 30JUL2019 | TE Connectivity | | | |
| | | CHK RV | 30JUL2019 | | | | |
| DIMENSIONS: INCHES | | APVD DH | 30JUL2019 | NAME | | | |
| | | PRODUCT SPEC | | 7000 SERIES TIMING RELAY | | | |
| | | APPLICATION SPEC | | — | | | |
| MATERIAL | | WEIGHT | 0 | SIZE | CAGE CODE | DRAWING NO | RESTRICTED TO |
| — | | CUSTOMER DRAWING | | A3 | 00779 | ©=7000—SERIES | — |
| | | | | SCALE | NTS | SHEET | REV |
| | | | | | | 3 of 3 | A |

Mouser Electronics

Authorized Distributor

Click to View Pricing, Inventory, Delivery & Lifecycle Information:

[TE Connectivity:](#)

[1472973-5](#)