

REVISIONS					
#	LYR	DESCRIPTION	DATE	DWN	APVD
B		REVISED PER ECO-11-019033	20SEP11	KH	MZ
C		REVISED PER ECO-19-011232	06AUG2019	RS	MZ

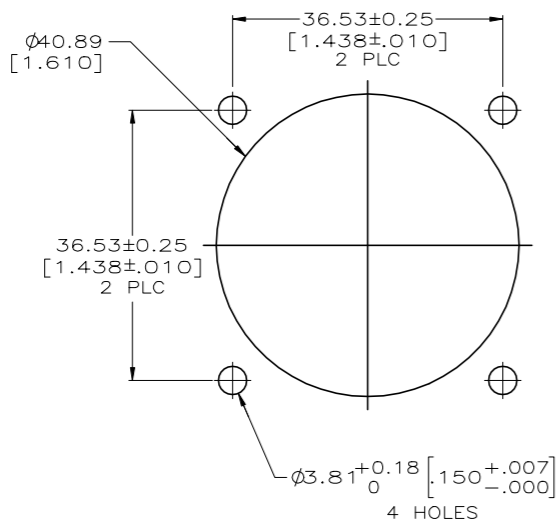
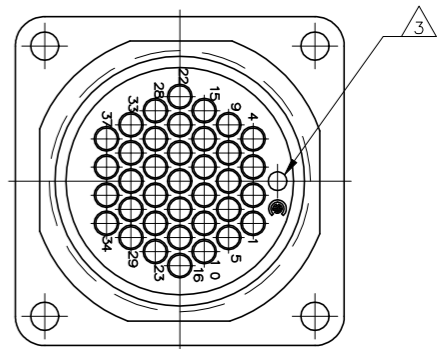
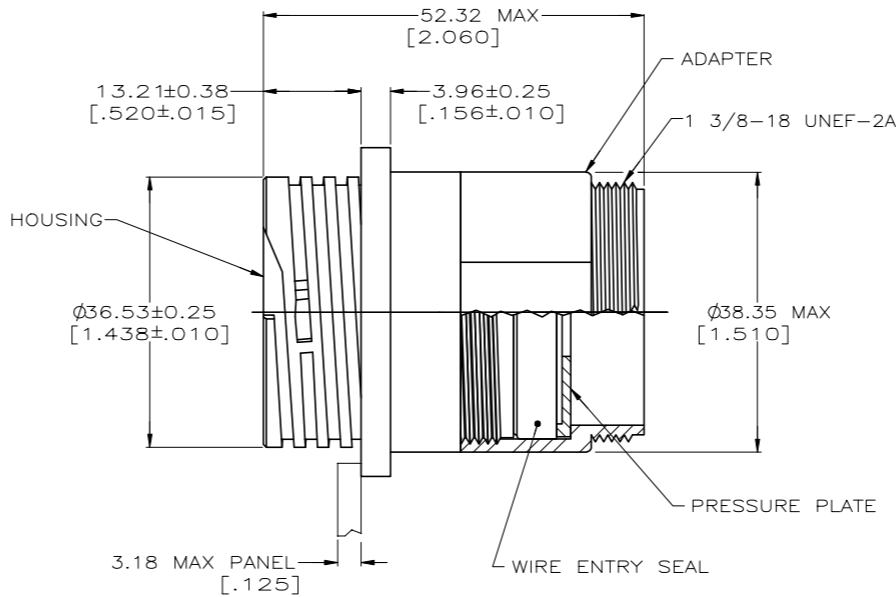
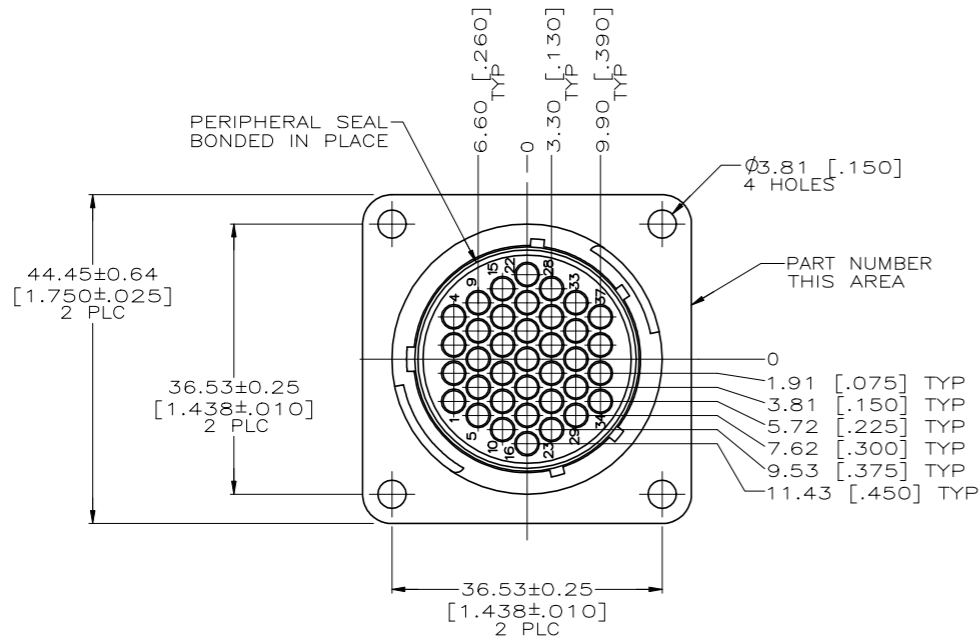

RECOMMENDED PANEL CUTOUT

- 1 ADAPTER AND HOUSING: NYLON, BLACK.  
WIRE ENTRY SEAL: ELASTOMER, RED-IRON OXIDE.  
PERIPHERAL SEAL: ELASTOMER, BLACK.
2. CONNECTOR WILL ACCEPT (37) MULTIMATE PIN CONTACTS.
- 3 ORIENTATION HOLE USED IN THE MANUFACTURING PROCESS ONLY.  
THIS HOLE IS NOT INTENDED FOR WIRE INSERTION.

796286-1  
PART NUMBER

THIS DRAWING IS A CONTROLLED DOCUMENT.		DWN C.DORWART 11 NOV 98	TE Connectivity	
DIMENSIONS: INCHES		CHK K.DOWHOWER 15NOV99	NAME	
TOLERANCES UNLESS OTHERWISE SPECIFIED:		APVD K.DOWHOWER 15NOV99	RCPT ASSEMBLY, SIZE 23-37, STANDARD SEX, SQUARE FLANGE, SEALED CIRCULAR PLASTIC CONNECTOR	
Ø		PRODUCT SPEC 108-1579	RESTRICTED TO	
MATERIAL		APPLICATION SPEC	SIZE A1	
FINISH		WEIGHT	CAGE CODE 00779	
1		CUSTOMER DRAWING	DRAWING NO C=796286	
		SCALE 2:1	SHEET 1 OF 1	
			REV C	

# Mouser Electronics

Authorized Distributor

Click to View Pricing, Inventory, Delivery & Lifecycle Information:

[TE Connectivity:](#)

[796286-1](#)