

LOC	DIST	REVISIONS				
CM	53	P	LTR	DESCRIPTION	DATE	OWN
						APVD
			U2	REVISED PER ECR 12-013810	24SEPT12	JR

- 1

PLATE OVERALL WITH 0.00127 [.000050] MIN NICKEL, THEN PLATE INSIDE OF WIRE BARREL AND ON TIP OF PIN WITH 0.00076 [.000030] MIN GOLD.
2. WIRE RANGE: 0.05 – 0.4 mm² [30 – 22 AWG].
3. INSULATION RANGE: 1.02–1.91 [.040–.075] DIA.
4. DIMENSIONS IN BRACKETS ARE IN INCHES.

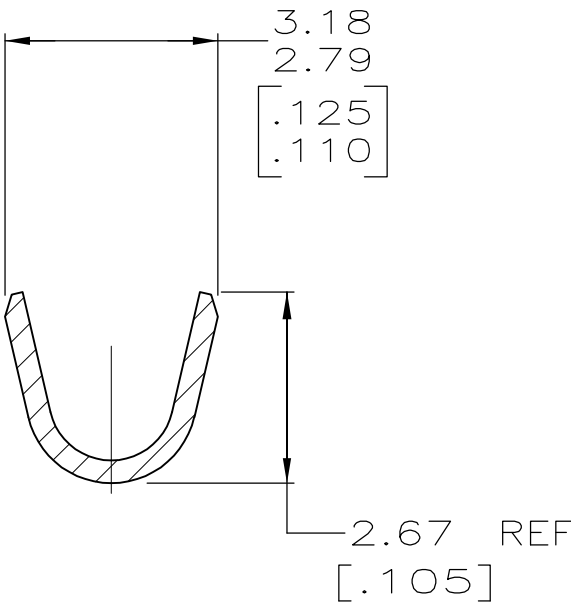
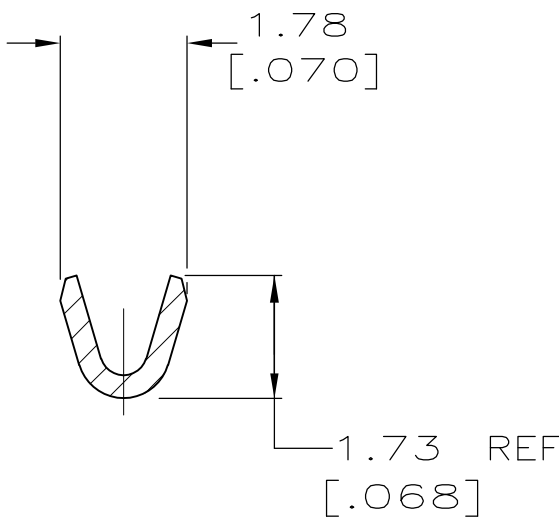
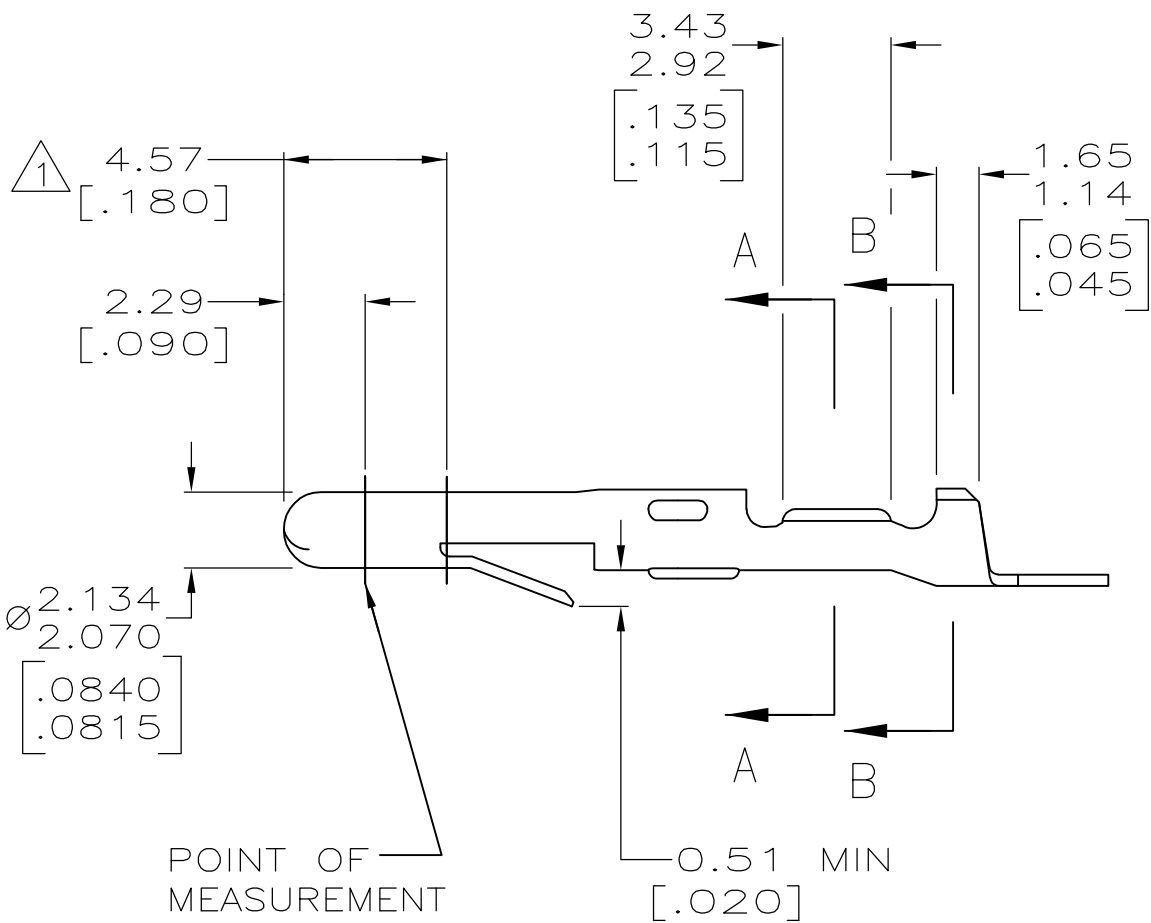
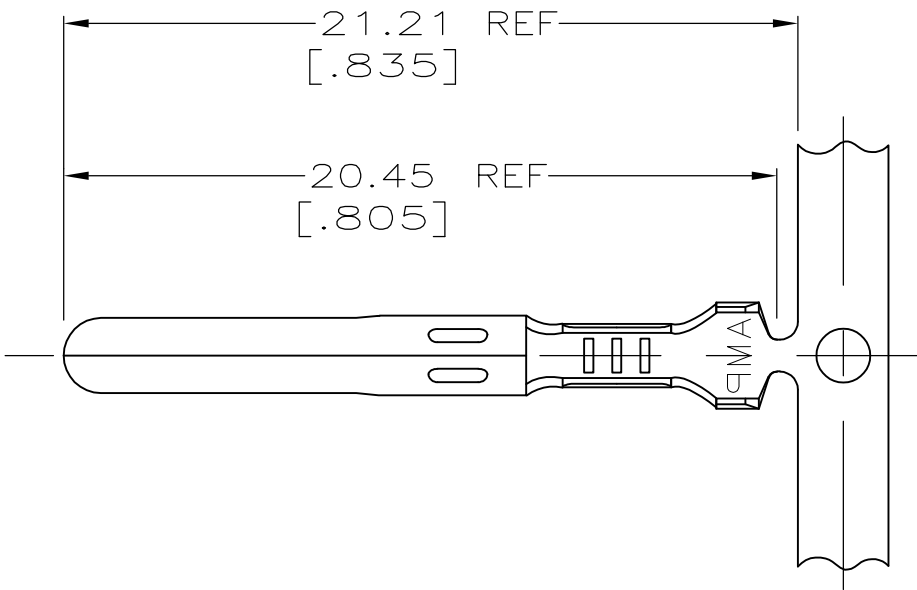

1	0.30 [.012] BRASS	350079-5
	PRE-TIN	0.30 [.012] PH BRZ
PRE-TIN	0.30 [.012] BRASS	350079-1
FINISH	MATERIAL	PART NO

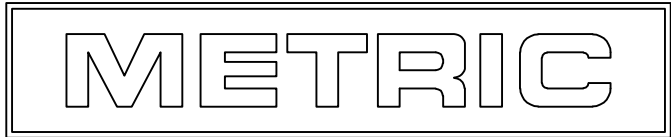

THIS DRAWING IS A CONTROLLED DOCUMENT FOR AMP INCORPORATED. IT IS SUBJECT TO CHANGE AND THE CONTROLLING ENGINEERING ORGANIZATION SHOULD BE CONTACTED FOR THE LATEST REVISION.

THIS DRAWING IS A CONTROLLED DOCUMENT.		DWN 2-15-93	TE Connectivity		
DIMENSIONS: mm[INCHES]		CHK 2-15-93			
TOLERANCES UNLESS OTHERWISE SPECIFIED:		APVD 2-22-93	NAME		
0 PLC ± -		PRODUCT SPEC	PIN, MATE-N-LOK™		
1 PLC ± -		APPLICATION SPEC	-		
2 PLC ± 0.25 [.010]			-		
3 PLC ± -			-		
4 PLC ± -			-		
ANGLES ± ± -			-		
FINISH			-		
MATERIAL		WEIGHT -	A2 00779 C-350079		
SEE TABLE		SEE TABLE	CUSTOMER DRAWING		
			SCALE 5:1	SHEET 1 of 1	REV U2

Mouser Electronics

Authorized Distributor

Click to View Pricing, Inventory, Delivery & Lifecycle Information:

[TE Connectivity:](#)

[350079-1](#)