

THIS DRAWING IS UNPUBLISHED.

RELEASED FOR PUBLICATION

,19 .

© COPYRIGHT 19

BY AMP INCORPORATED. ALL RIGHTS RESERVED.

LOC

DIST

REVISIONS

G

14

P

LTR

DESCRIPTION

DATE

DWN

APVD

C

REDRAWN PER 0720-0470-95

23JAN95

LO

ME

AMP  
WIRE RANGE

E13288

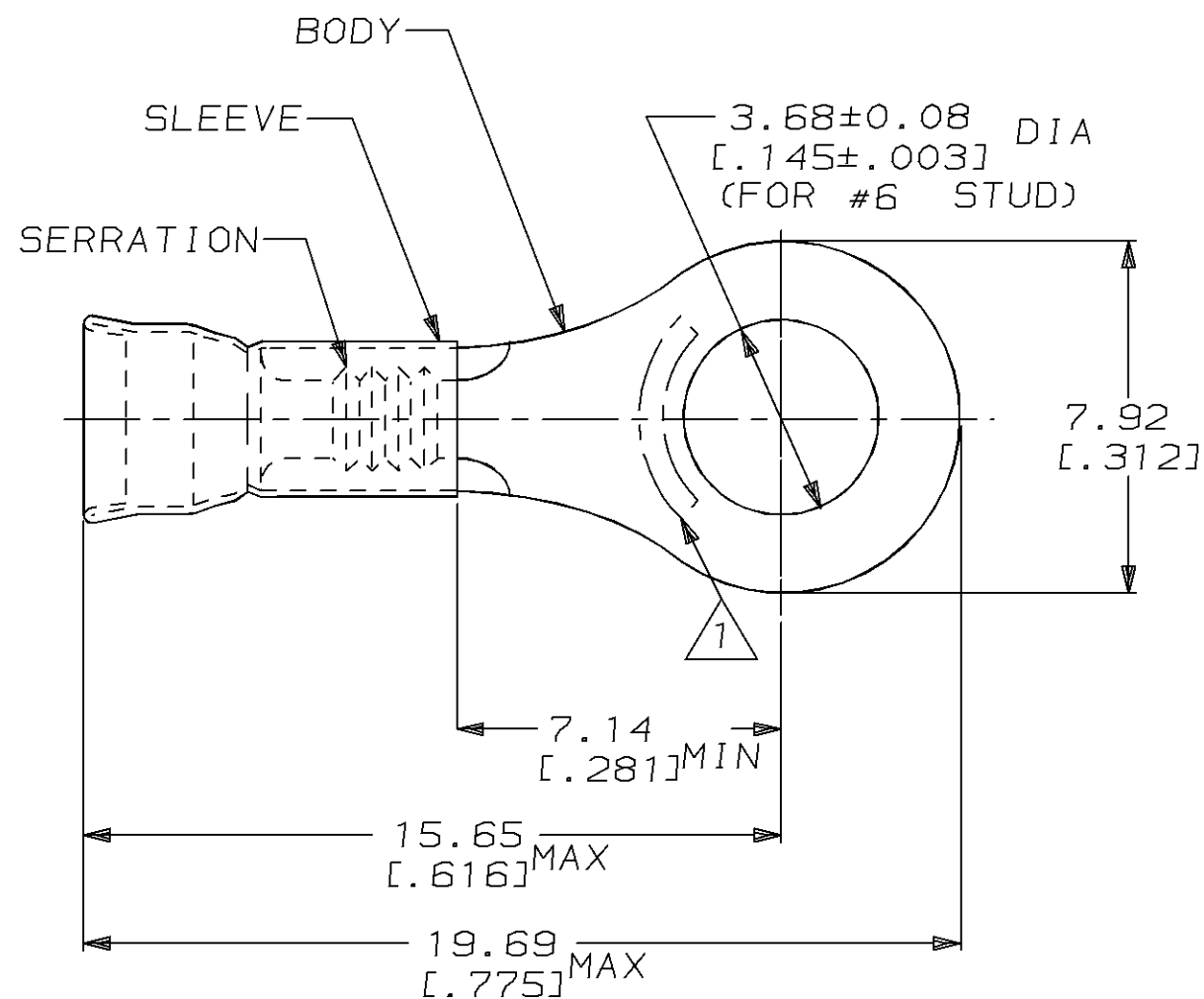
LR7189  
Certified22-16 AWG  
SOLID OR STRANDED22-16 AWG  
SOLID OR STRANDED22-16 AWG  
SOLID OR STRANDED

1 STAMP AMP 22-18\* APPROX AS SHOWN  
22-16 TERMINALS ARE STAMPED 22-18 IN  
ACCORDANCE WITH MILITARY SPEC MIL-T-7928  
COMMERCIAL WIRE RANGE IS 22-16

2. WIRE INSUL DIA, 2.67-3.56 [.105-.140]

3. TONGUE MATL THK, 0.79±0.05 [.031±.002]

5000	ON TAPE, REEL	2-31159-1
1000	LOOSE PIECE	31159
QTY	PACKAGE TYPE	PART NO

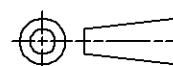
AMP INCORPORATED  
CUSTOMER SERVICE SYSTEMMAX RECOMMENDED OPERATING  
TEMPERATURE:  
170°C [338°F]THIS DRAWING IS A CONTROLLED DOCUMENT FOR AMP INCORPORATED.  
IT IS SUBJECT TO CHANGE AND THE CONTROLLING ENGINEERING  
ORGANIZATION SHOULD BE CONTACTED FOR THE LATEST REVISION.DIMENSIONS:  
mm [in]TOLERANCES UNLESS  
OTHERWISE SPECIFIED:0 PLC ±-  
1 PLC ±-  
2 PLC ±0.20 [.008]  
3 PLC ±-  
4 PLC ±-  
ANGLES ±-MATERIAL  
BODY, CU, SLV, CU PER  
ASTM B152FINISH  
TIN PLATE  
PER MIL-T-10727DWN  
L OLMEDA

23JAN95

CHK

M ELLIS

23JAN95

APVD

S BORTNER

23JAN95

PRODUCT SPEC

UL486A

APPLICATION SPEC

-

WEIGHT

-

CUSTOMER DRAWING

AMP Incorporated  
Harrisburg, PA 17105-3608NAME  
TERMINAL, RING,  
DIAMOND GRIP,  
WIRE SIZE, 22-16 AWGSIZE  
A3CAGE CODE  
00779DRAWING NO  
C-31159SCALE  
6:1SHEET  
1 OF 1REV  
CFOR ADDITIONAL  
PRODUCT INFORMATION OR  
COPIES OF DRAWINGS  
AND TECHNICAL DOCUMENTSPRODUCT INFORMATION CENTER  
1-800-522-6752FOR APPLICATION  
TOOLING INFORMATIONTOOLING ASSISTANCE CENTER  
1-800-722-1111

FOR ORDER ENTRY

1-800-526-5142

AMP 1470-19 REV 09MAY94

# Mouser Electronics

Authorized Distributor

Click to View Pricing, Inventory, Delivery & Lifecycle Information:

[TE Connectivity:](#)

[2-31159-1](#)