

a) Part as supplied

243D012-12-G05

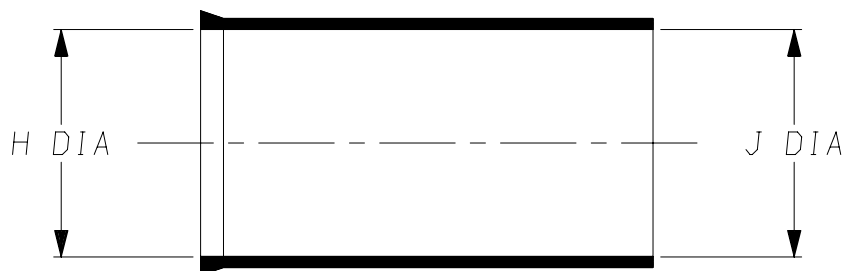

b) Part after unrestricted recovery

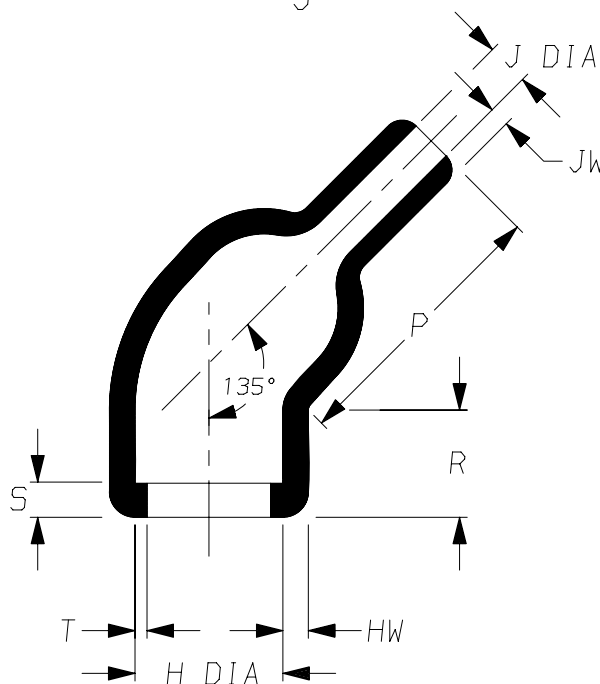

DIMENSIONS in millimetres  
(in inches, for reference)

Part No.	H		J		P		R		S		T		HW		JW	
	min	max	min	max	±10%	±10%	±10%	±10%	±10%	±10%	±10%	±10%	±20%	±20%	±20%	±20%
	a	b	a	b	b	b	b	b	b	b	b	b	b	b	b	b
243D012-12-G05	19 (0.75)	14.2 (0.56)	19 (0.75)	4.1 (0.16)	24 (0.94)	10 (0.39)	3.0 (0.12)	1.1 (0.04)	2.3 (0.09)	1.8 (0.07)						
	#		#													

This is an overexpanded variant  
Modified dimensions are shown thus:- #

Copyright (!)

The copyright in this drawing is the property of Tyco Electronics UK Ltd. The drawing is issued on the condition that it is not copied, reproduced or disclosed to a third party, either in whole or in part without the prior written consent of Tyco Electronics UK Ltd.

Drawn A.LILLEY. Checked Issue 2 Date December 2006 Conforms to ISO Recommendations  
3rd Angle Projection  
Not to Scale  
Approval Design MKTG. Q.A.

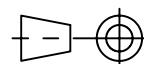

<b>Raychem</b>		<b>Specification Control Drawing</b>	Part Number <b>243D012-12-G05 Issue 2</b>
Iss.	Date	E.C.R. No.	Details of Change
2	December 2006	CR06-HM-012	Imperial dimensions added
2	December 2006	CR06-DM-104	Material description name changed

## Ordering Information

243D012-12-G05/**			
		↑	Adhesive Slash Number (if required see compatibility chart)
		↑	Modification number
		↑	Material Dash Number (see compatibility chart)
		↑	Base Part Number

## COMPATIBILITY CHART

Material Dash Number	Material Description	SPEC Number	Coating Slash Number
-12	FLUOROELASTOMER, FLEXIBLE	RT-1312, RW-2071	/225

## NOTES

- ① As supplied dimensions are for uncoated parts, when coating is added entry diameters will reduce by 1.5mm Max.

Tyco Electronics UK Ltd. Faraday Road, Swindon, Wiltshire, SN3 5HH England Telephone: (01793) 528171 Fax: 572516	Tyco Electronics Corporation 300, Constitution Drive, Menlo Park, CA 94025 USA Telephone (650) 361-3860 Fax: (650) 361-5579
Cage Code K1010	Cage Code 06090

# Mouser Electronics

Authorized Distributor

Click to View Pricing, Inventory, Delivery & Lifecycle Information:

[TE Connectivity:](#)

[961530-000](#)