

REVISIONS					
P	LTR	DESCRIPTION	DATE	DWN	APVD
	A	RELEASED PER ECO-19-013357	29AUG2019	CJV	JW
	B	REVISED PER ECO-19-014774	26SEP2019	CJV	JW

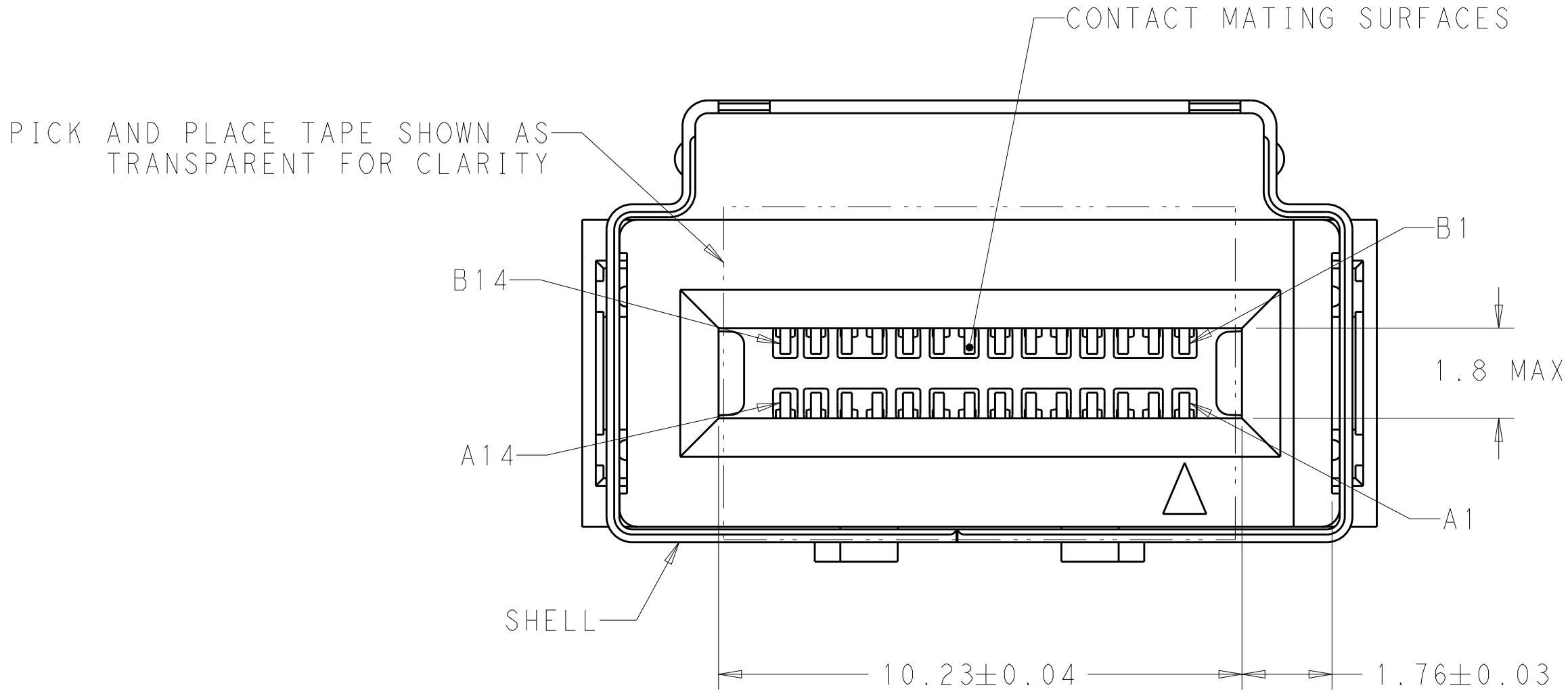

1. HOUSING - LCP, UL94V-0, BLACK.
CONTACT OVERMOLDS - LCP, UL94V-0, BLACK.
SHELL, CONTACTS, HOLD DOWNS - COPPER ALLOY.
PICK AND PLACE TAPE - POLYIMIDE FILM.
2. CONTACTS - GOLD PLATE ON MATING SURFACES,
TIN PLATE ON SOLDER FEET.
HOLD DOWNS - TIN PLATE.
SHELL- NICKEL PLATE, TIN PLATE ON HOLD
DOWNS.
3. DATUMS AND BASIC DIMENSIONS ESTABLISHED
BY CUSTOMER.
4. MINIMUM HOST PCB THICKNESS: 1.5.
5. SEE MSA SPECIFICATION FOR ADDITIONAL
PADDLE CARD LAYOUTS COMPATABLE WITH THIS
RECEPTACLE AND FOR OPTIONAL SPLIT
CONTACT PAD LAYOUTS FOR THE PADDLE CARD.
SPECIFICATION PINOUT MAY ALSO DESIGNATE
PAD SEQUENCE DIFFERENT FROM ILLUSTRATION.

6. POSITIONS DESIGNATED AS "SIGNAL" ARE
REQUIRED LOCATIONS FOR HIGH SPEED
DIFFERENTIAL PAIR SIGNALING. THESE
LOCATIONS MAY ALSO BE USED FOR SUPPORTING
SIDEBAND SIGNALS OR OTHER UTILITY
PURPOSES. POSITIONS DESIGNATED AS
"GROUND" ARE REQUIRED WHEN SUPPORTING
HIGH SPEED DIFFERENTIAL SIGNALS. THESE
LOCATIONS MAY ALSO BE USED FOR SIDEBAND
SIGNALS OR OTHER UTILITY PURPOSES.
7. RECOMMENDED COMPONENT AND TRACE KEEP OUT
AREA. EACH EDGE 0.15 MIN FROM EDGE OF
HOLE.
8. PART NUMBER AND DATE CODE MARKED IN
APPROXIMATE AREA SHOWN.
9. TAPE AND REEL PACKAGED FOR PICK AND PLACE
SURFACE MOUNT PROCESSING.
POCKET TAPE PITCH = 20.

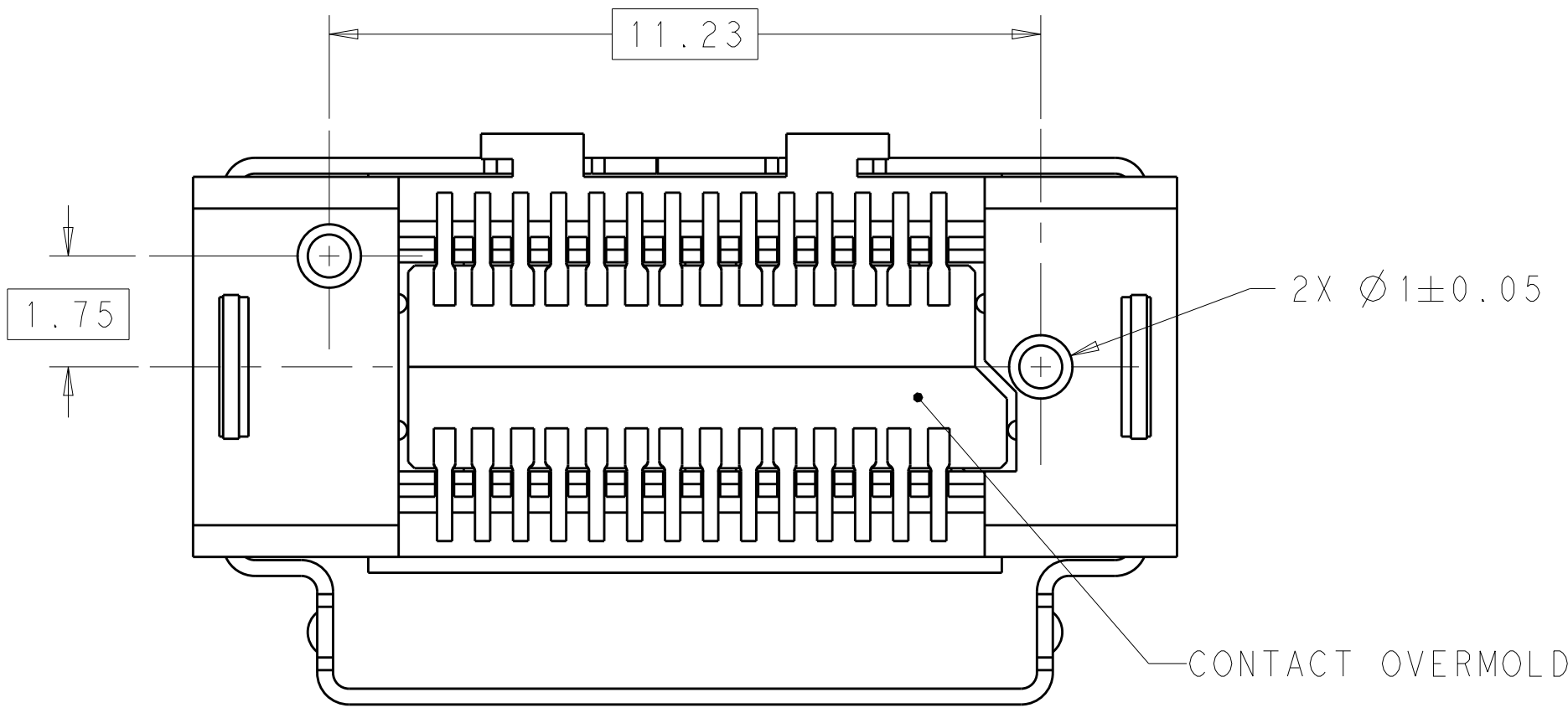
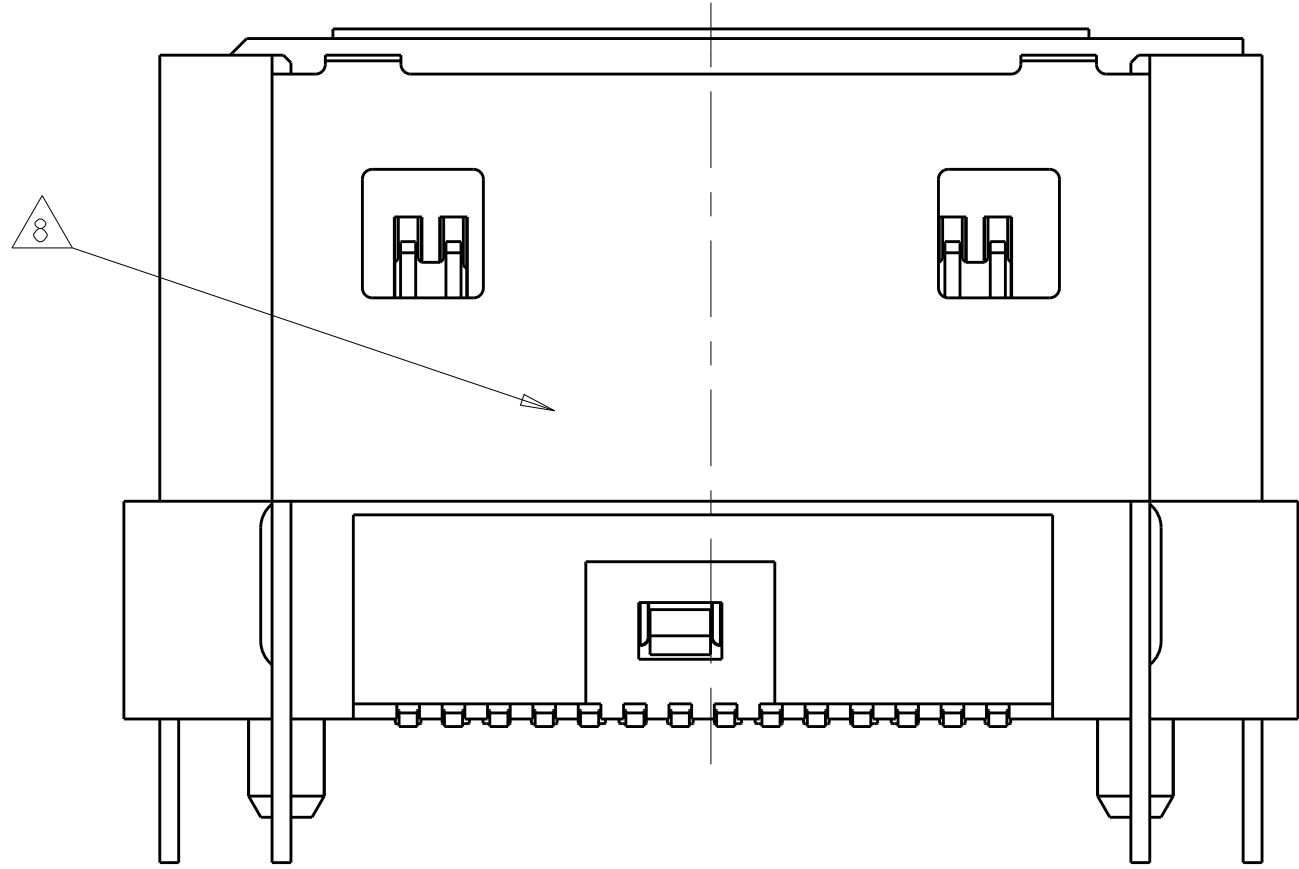
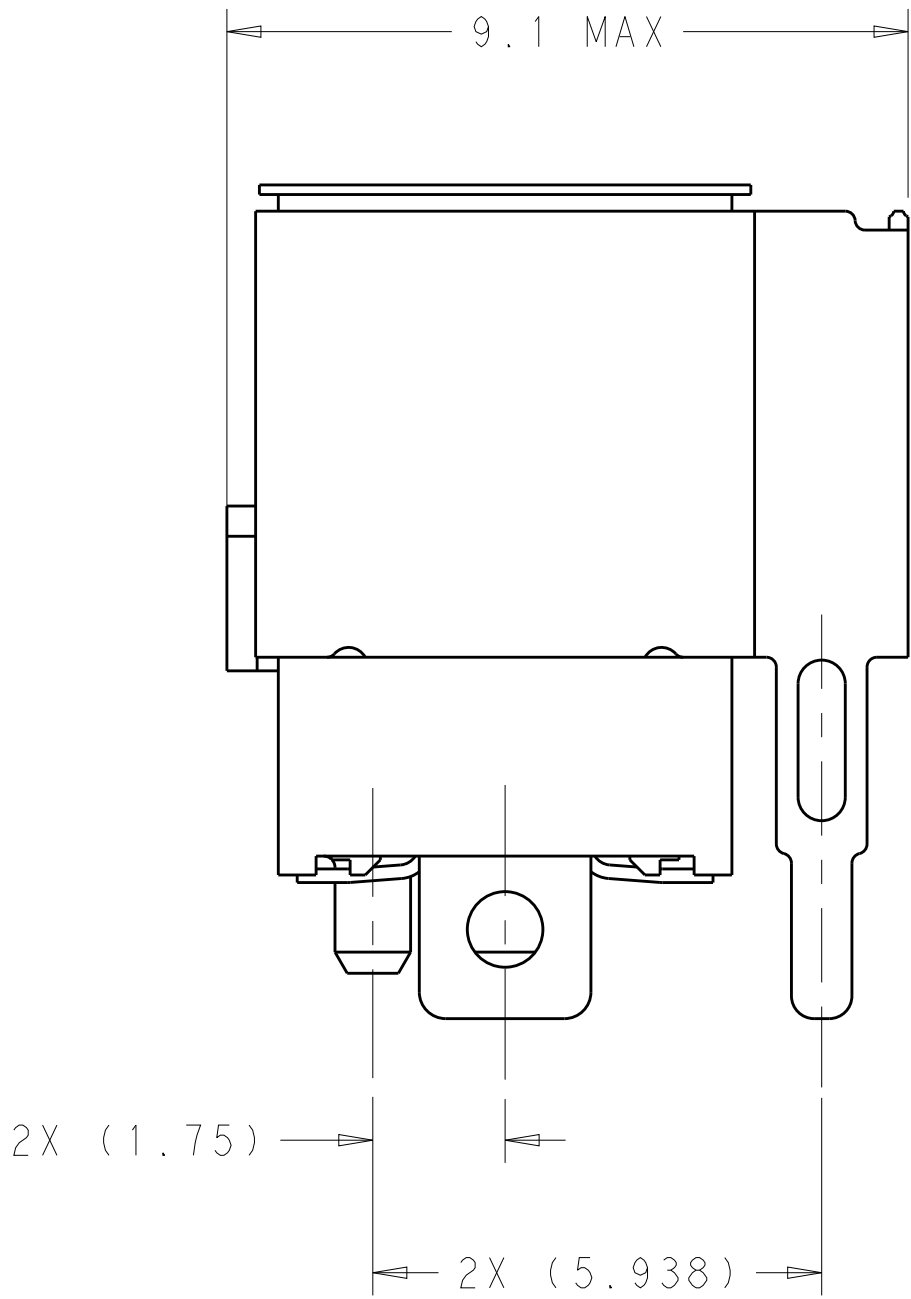
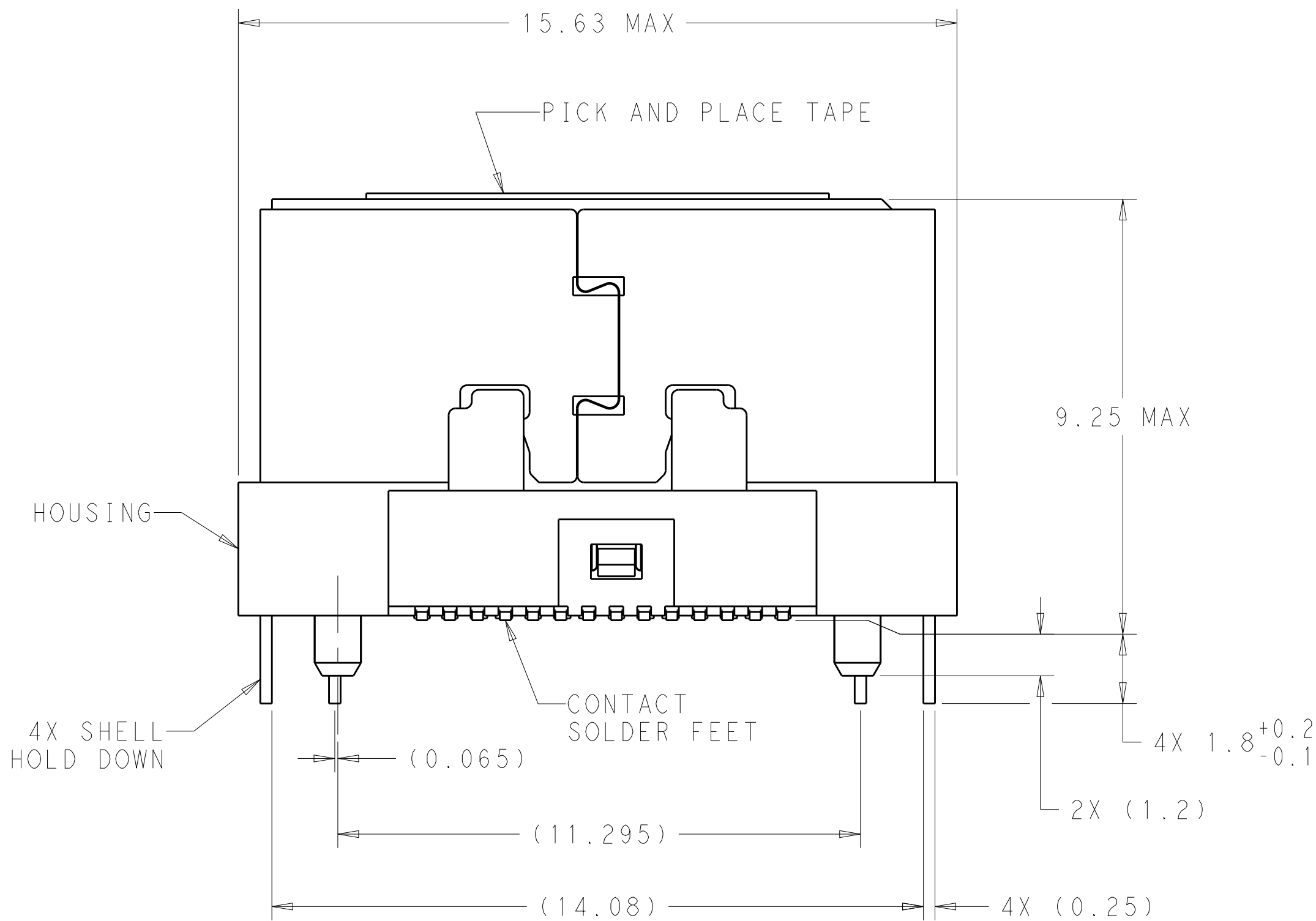

0.76µm Au	200	2354531-3
0.38µm Au	100	2354531-2
FLASH Au/PdNi	50	2354531-1
PLATING	MATING CYCLES	PART NUMBER

THIS DRAWING IS A CONTROLLED DOCUMENT.		DWN M. SHIRK 08APR2019	TE TE Connectivity	
DIMENSIONS:		CHK J. WESTMAN 08APR2019		
mm	TOLERANCES UNLESS OTHERWISE SPECIFIED:	APVD J. WESTMAN 08APR2019	NAME RECEPTACLE ASSEMBLY, VERTICAL, 28 POSITION, SLIVER 2.0	
	0 PLC	±"	PRODUCT SPEC	
	1 PLC	±"	108-130021	
	2 PLC	±"	APPLICATION SPEC	
	3 PLC	±"	114-130015	
MATERIAL	FINISH	WEIGHT	SIZE A1	CAGE CODE 00779
CUSTOMER DRAWING		DRAWING NO C=2354531	RESTRICTED TO	
		SCALE 10:1	SHEET 1	OF 3
		REV B		

REVISIONS				
P	LTR	DESCRIPTION	DATE	OWN
-	-	SEE SHEET 1	-	-

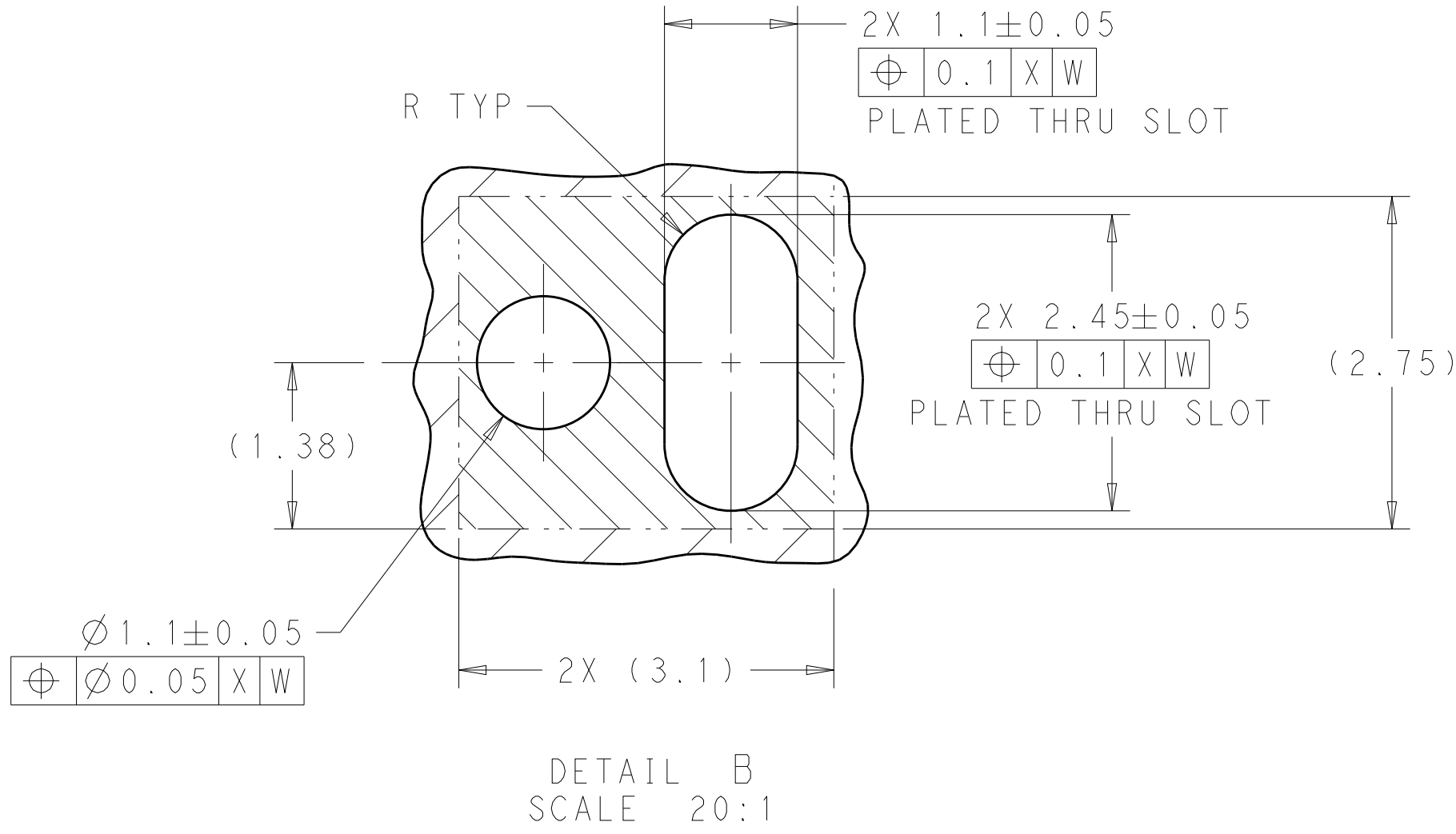
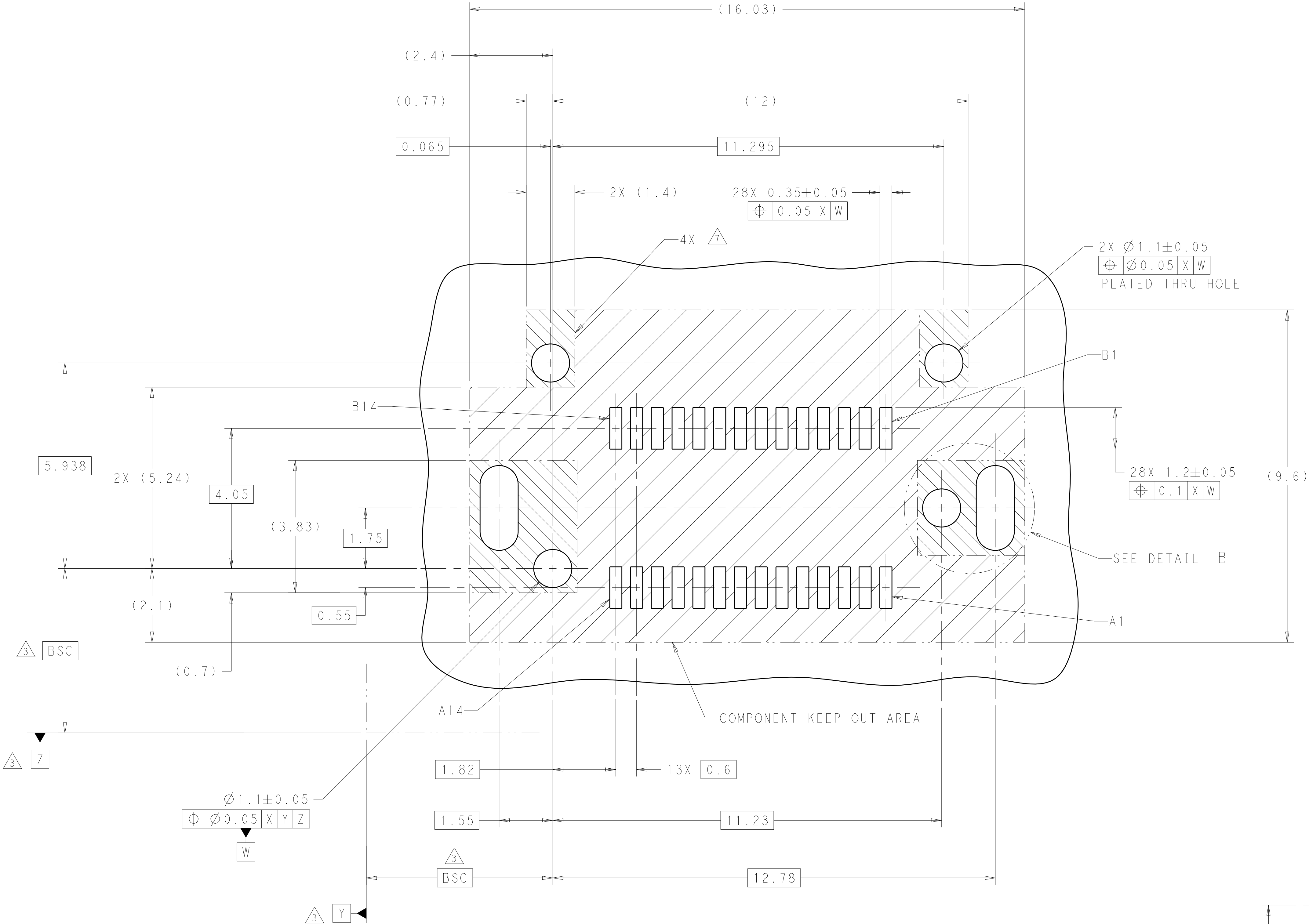

THIS DRAWING IS A CONTROLLED DOCUMENT.		OWN M. SHIRK 08APR2019	TE Connectivity	
DIMENSIONS:		CHK J. WESTMAN 08APR2019		
mm	TOLERANCES UNLESS OTHERWISE SPECIFIED:	APVD J. WESTMAN 08APR2019	NAME RECEPTACLE ASSEMBLY, VERTICAL, 28 POSITION, SLIVER 2.0	
	0 PLC ±"	PRODUCT SPEC	SIZE CAGE CODE DRAWING NO	
	1 PLC ±"	108-130021	A100779C=2354531	
	2 PLC ±"	APPLICATION SPEC	RESTRICTED TO	
	3 PLC ±"	114-130015	-	
MATERIAL	ANGLES ±"	WEIGHT	SCALE 10:1 SHEET 2 OF 3 REV B	
	FINISH	CUSTOMER DRAWING		

REVISIONS					
P	LTR	DESCRIPTION	DATE	DWN	APVD
-	-	SEE SHEET 1	-	-	-

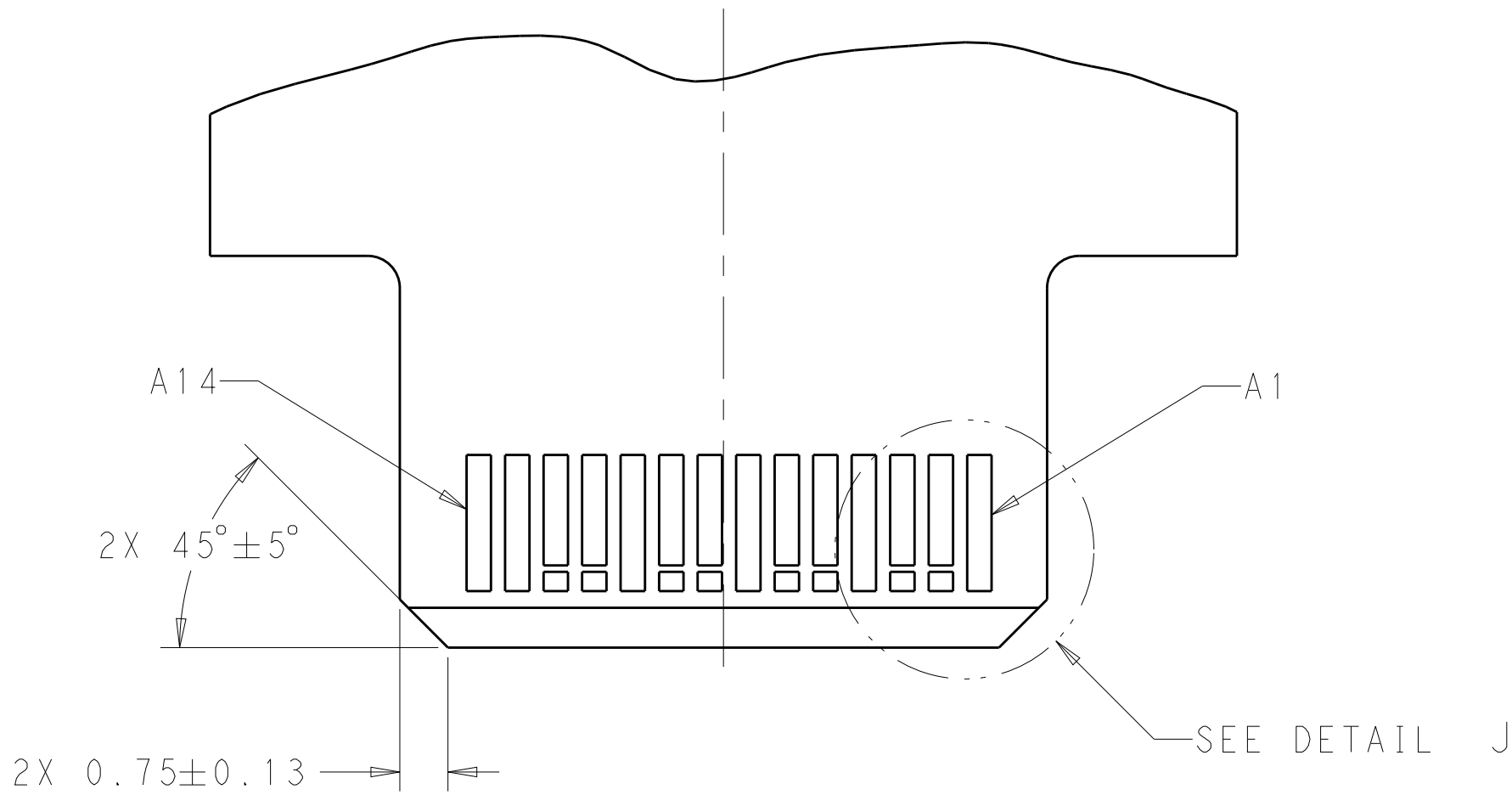
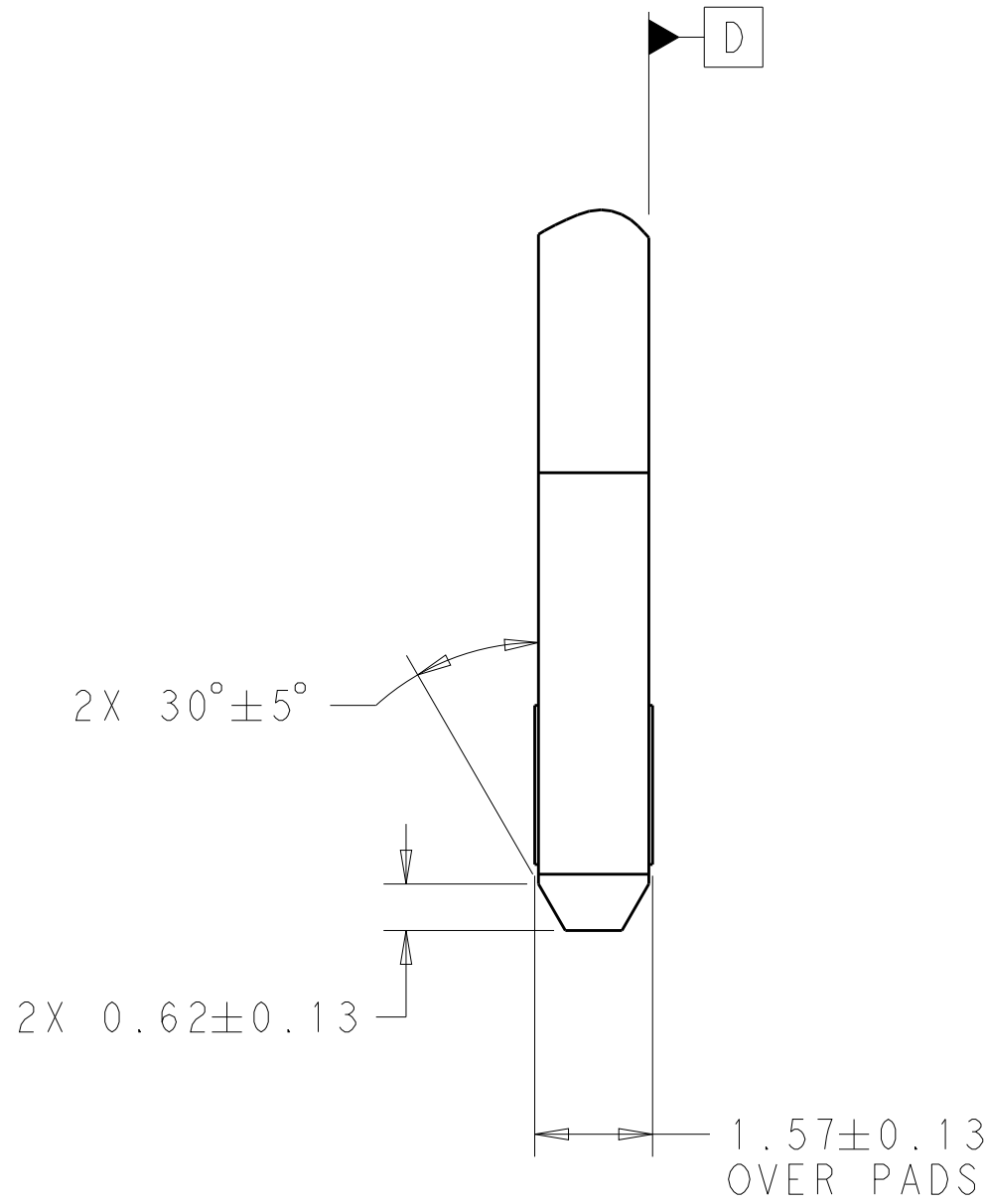
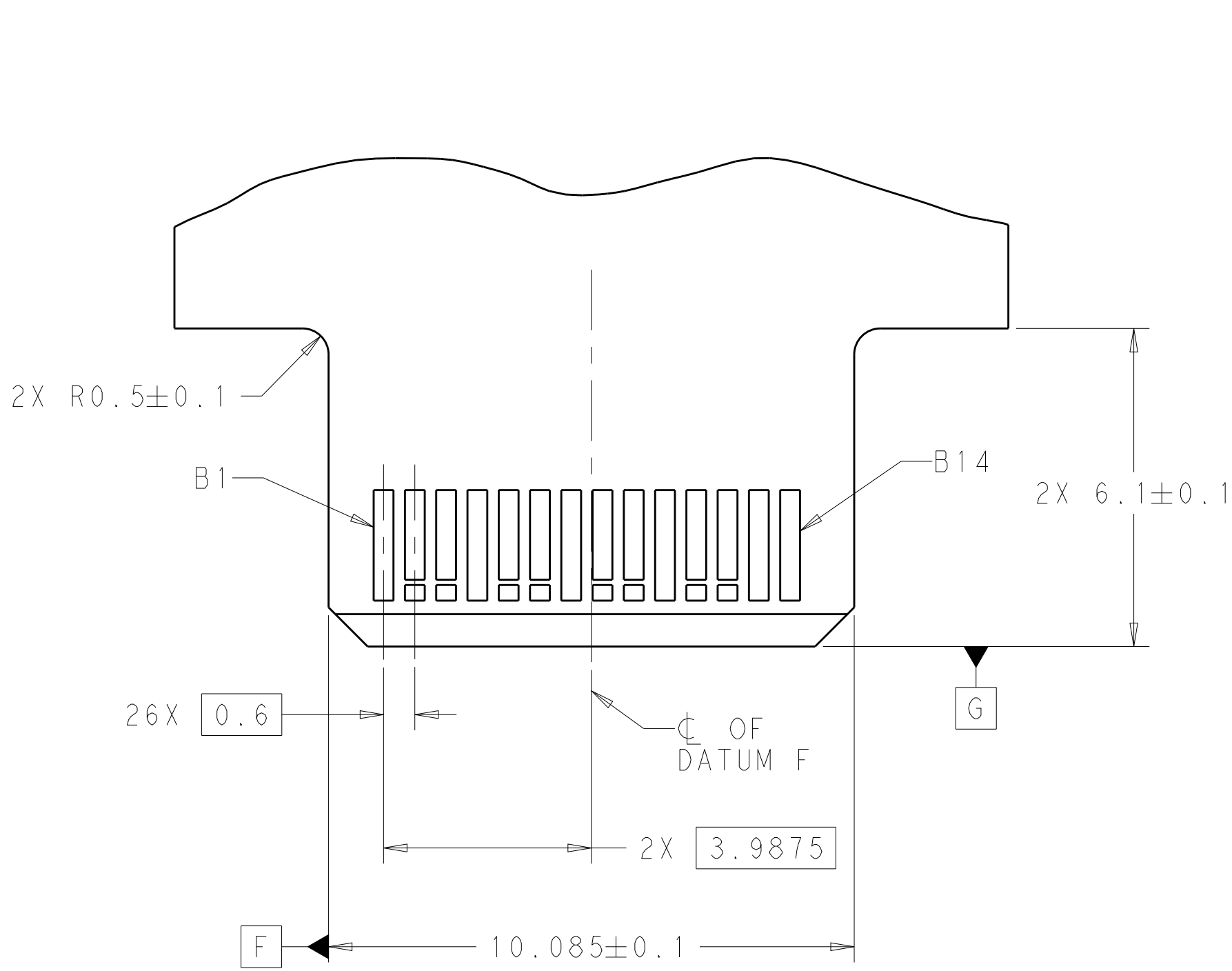

RECOMMENDED PCB OUTLINE DIMENSIONS.
TOLERANCE VALUES ARE CRITICAL. PLEASE BE SURE TO DESIGNATE
TOLERANCES TO PCB SUPPLIER TO ENSURE OPTIMIZED FUNCTIONALITY.

CONTACT NUMBER	SIDE A	SIDE B
1	GROUND	GROUND
2	SIGNAL	SIGNAL
3	SIGNAL	SIGNAL
4	GROUND	GROUND
5	SIGNAL	SIGNAL
6	SIGNAL	SIGNAL
7	GROUND	GROUND
8	SIGNAL	SIGNAL
9	SIGNAL	SIGNAL
10	GROUND	GROUND
11	SIGNAL	SIGNAL
12	SIGNAL	SIGNAL
13	GROUND	GROUND
14	GROUND	GROUND

CONNECTOR CONTACT IDENTIFICATION

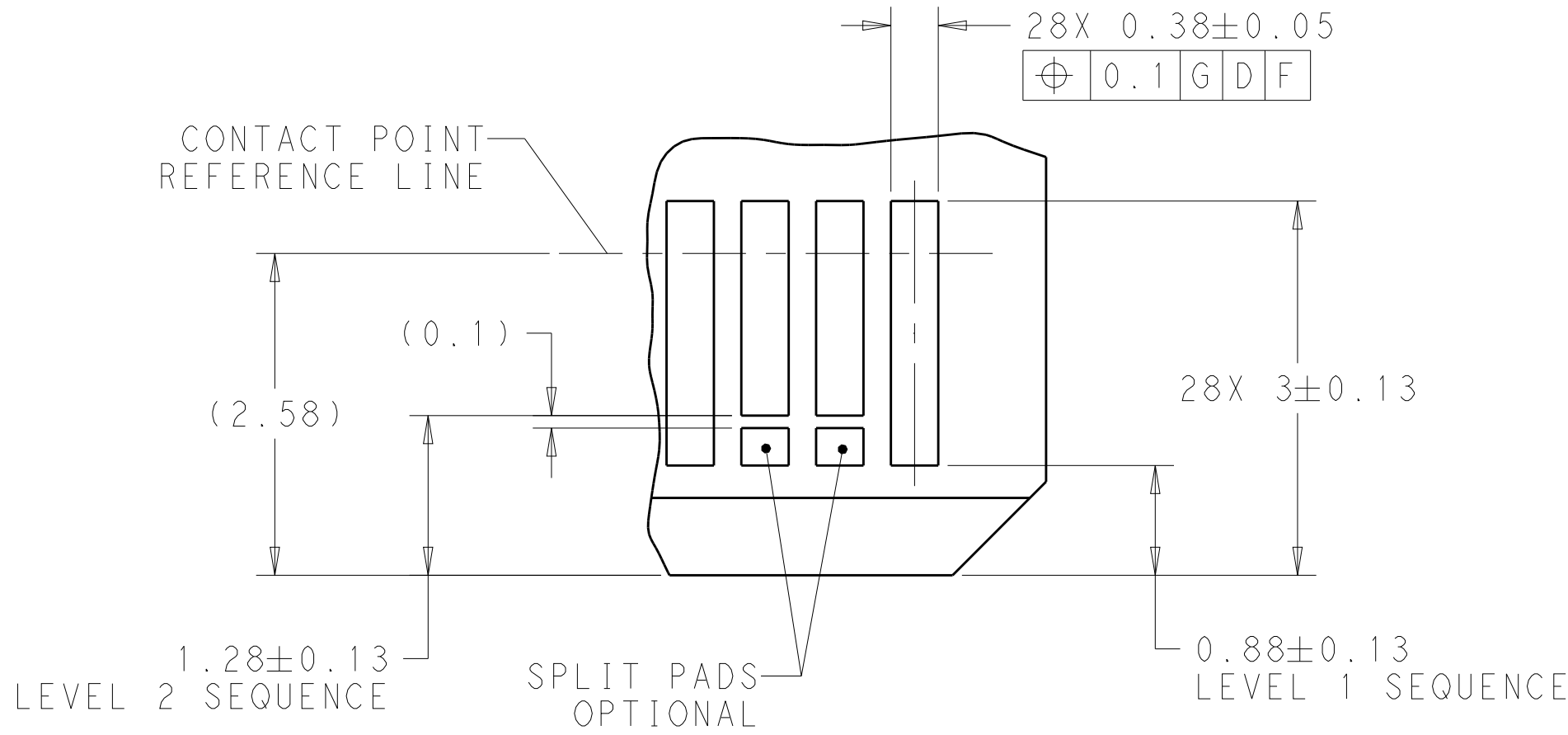

DETAIL J
SCALE 20:1

THIS DRAWING IS A CONTROLLED DOCUMENT.

DIMENSIONS:

mm

MATERIAL

TOLERANCES UNLESS OTHERWISE SPECIFIED:

0 PLC ±"

1 PLC ±"

2 PLC ±"

3 PLC ±"

4 PLC ±"

ANGLES ±"

FINISH ±"

DWN M. SHIRK 08APR2019

CHK J. WESTMAN 08APR2019

APVD J. WESTMAN 08APR2019

PRODUCT SPEC 108-130021

APPLICATION SPEC 114-130015

WEIGHT -

CUSTOMER DRAWING

NAME RECEPTACLE ASSEMBLY, VERTICAL, 28 POSITION, SLIVER 2.0

SIZE A1

CAGE CODE 00779

DRAWING NO. C=2354531

RESTRICTED TO -

SCALE 10:1

SHEET 3 OF 3

REV B

Mouser Electronics

Authorized Distributor

Click to View Pricing, Inventory, Delivery & Lifecycle Information:

[2354531-2](#) [2354531-3](#)