

REVISIONS					
P	LTR	DESCRIPTION	DATE	DWN	APVD
	C	REV PER ECO 20-002853	3-3-20	CT	DM

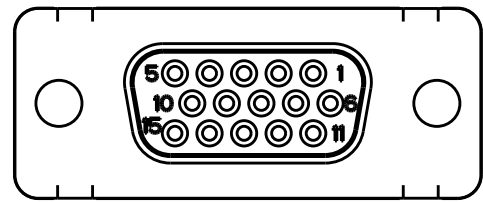

SIZE 1
SCALE 2:1

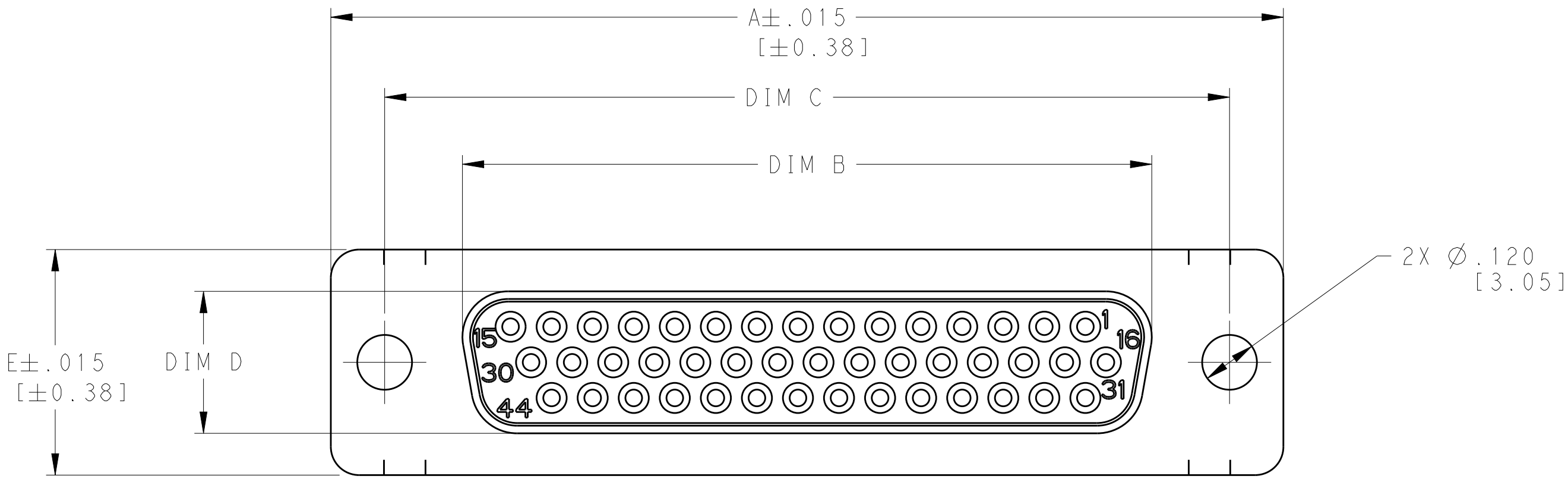
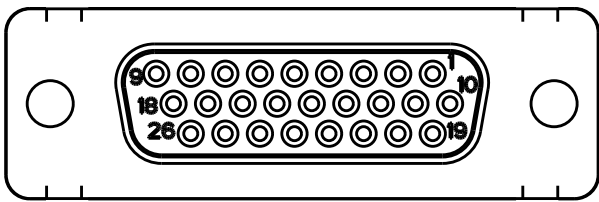

SIZE 2
SCALE 2:1

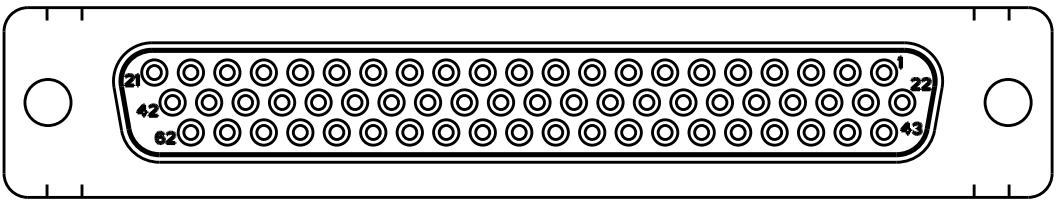

SIZE 4
SCALE 2:1

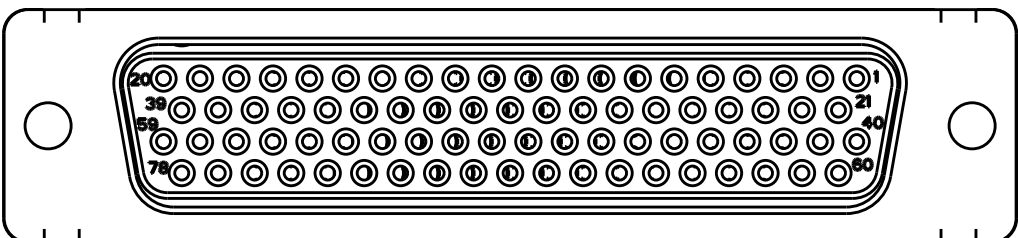

SIZE 5
SCALE 2:1

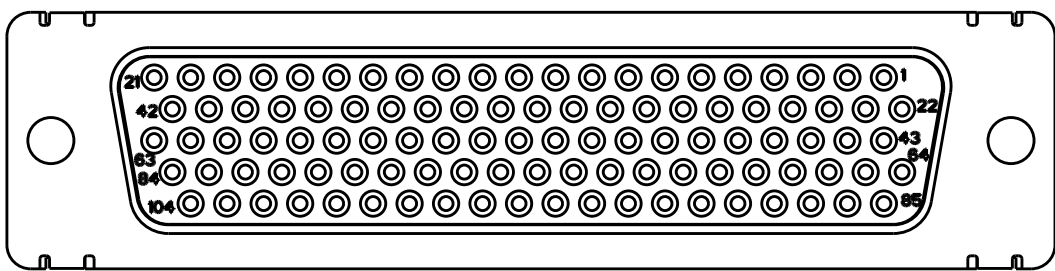

SIZE 6
SCALE 2:1

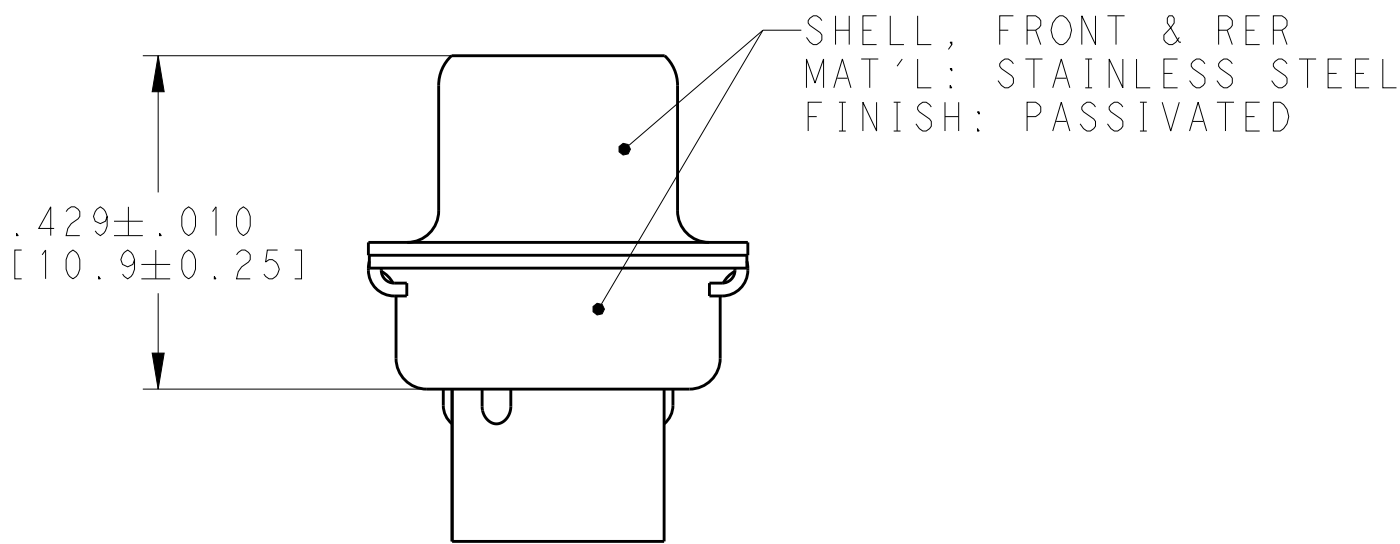
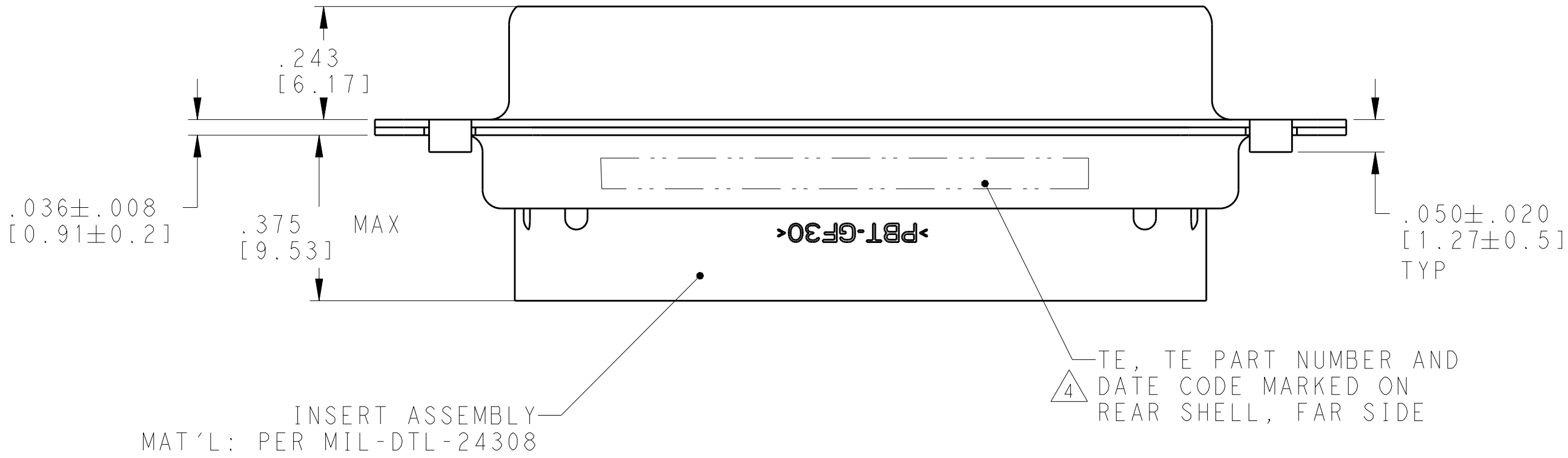

2335893-3 SHOWN

- THIS ASSEMBLY IS DESIGNED TO CONFORM TO THE LATEST ISSUE OF MIL-DTL-24308
- METAL RETENTION CLIPS ARE INCLUDED IN INSERTS.
- THIS RECEPTACLE WILL ACCEPT SIZE 22 SOCKET CONTACTS M39029/57-354 TE CONNECTIVITY PART NO. 204351-1. CONTACTS ARE NOT INCLUDED AND MUST BE ORDERED SEPARATELY.

4 MARKED WITH .047-.062 HIGH CHARACTERS. FAR SIDE REFERS TO THE WIDE SIDE OF THE KEYSTONE. NEAR SIDE REFERS TO THE NARROW SIDE OF THE KEYSTONE. IF THE REAR SHELL IS TOO SMALL FOR TE, TE PART NUMBER AND DATE CODE, THEN SPLIT AS FOLLOWS:
A: TE PART ON REAR SHELL, NEAR SIDE
B: TE AND DATE CODE ON REAR SHELL, FAR SIDE

DATE CODE IS FOUR DIGITS, FIRST TWO DIGITS REFER TO THE YEAR AND SECOND TWO DIGITS REFER TO THE WEEK.

WITH	2335891-5	.605 [15.37]	.423 [10.74]	2.406 [61.11]	2.064 [52.43]	2.635 [66.93]	78	5	1-2335893-1
WITHOUT	2335891-6	.668 [16.97]	.485 [12.32]	2.500 [63.50]	2.189 [55.60]	2.729 [69.32]	104	6	2335893-6
WITHOUT	2335891-5	.605 [15.37]	.423 [10.74]	2.406 [61.11]	2.064 [52.43]	2.635 [66.93]	78	5	2335893-5
WITHOUT	2335891-4	.494 [12.55]	.311 [7.90]	2.500 [63.50]	2.159 [54.84]	2.729 [69.32]	62	4	2335893-4
WITHOUT	2335891-3	.494 [12.55]	.311 [7.90]	1.852 [47.04]	1.511 [38.38]	2.088 [53.03]	44	3	2335893-3
WITHOUT	2335891-2	.494 [12.55]	.311 [7.90]	1.312 [33.32]	.971 [24.66]	1.541 [39.14]	26	2	2335893-2
WITHOUT	2335891-1	.494 [12.55]	.311 [7.90]	.984 [24.99]	.643 [16.33]	1.213 [30.81]	15	1	2335893-1
204351-1 CONTACTS	TE MATING PART NUMBER	DIM E	DIM D	DIM C	DIM B	DIM A	NUMBER OF POSITIONS	SHELL SIZE	TE PART NO.

THIS DRAWING IS A CONTROLLED DOCUMENT.		DWN C.C. THOMAS 8-21-18	21AUG2018	
DIMENSIONS: INCHES [mm]		CHK D. MILLER 8-21-18	NAME	
TOLERANCES UNLESS OTHERWISE SPECIFIED:		APVD D. MILLER 8-21-18	PRODUCT SPEC	
0 PLC ± 1 PLC ± 2 PLC ± 3 PLC ±.005 (0.13) 4 PLC ± ANGLES ± FINISH ±		APPLICATION SPEC		RESTRICTED TO
MATERIAL		WEIGHT		
CUSTOMER DRAWING		SCALE 4:1		SHEET 1 OF 1

TE TE Connectivity

RECEPTACLE ASSEMBLY, SIZE 1 THRU 6
SERIES 90, AMPLIMITE
WITH STAINLESS STEEL SHELLS

SIZE 1
CAGE CODE 00779
DRAWING NO. 2335893

Mouser Electronics

Authorized Distributor

Click to View Pricing, Inventory, Delivery & Lifecycle Information:

[TE Connectivity:](#)

[2335893-6](#)