

REVISIONS					
P	LTR	DESCRIPTION	DATE	DWN	APVD
	C	REV PER ECO 20-002853	3-3-20	CT	DM

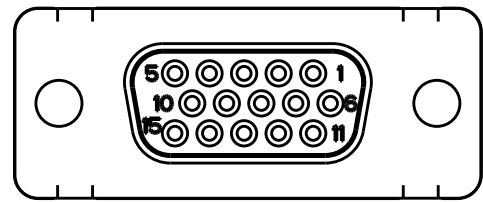

SIZE 1  
SCALE 2:1

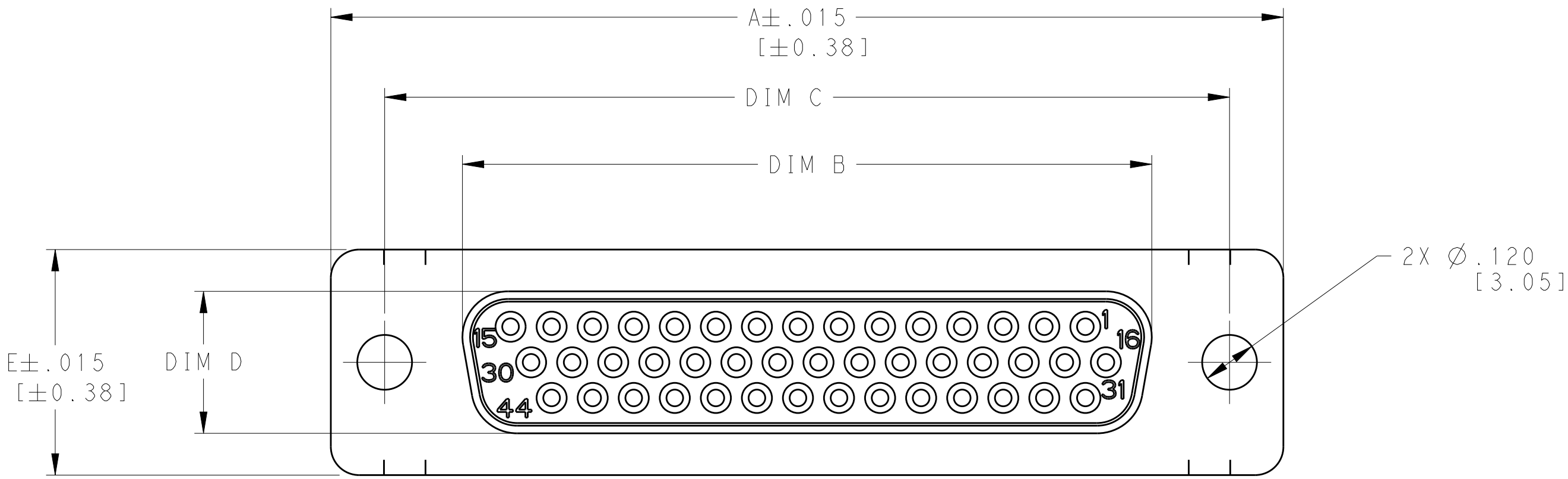
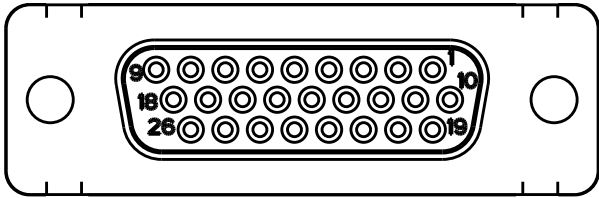

SIZE 2  
SCALE 2:1

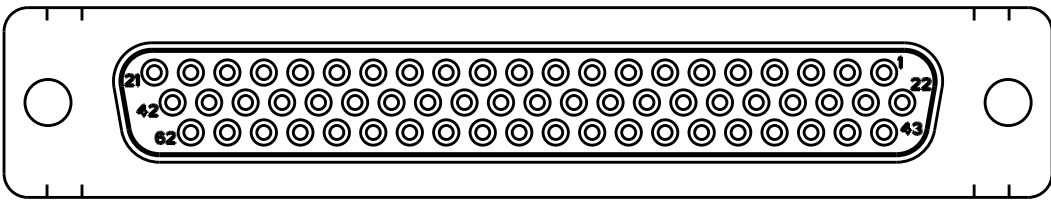

SIZE 4  
SCALE 2:1

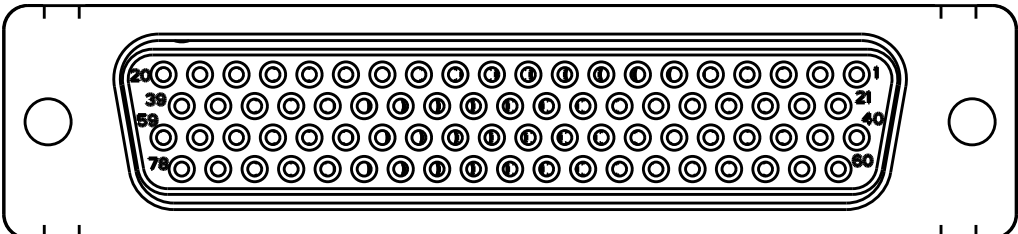

SIZE 5  
SCALE 2:1

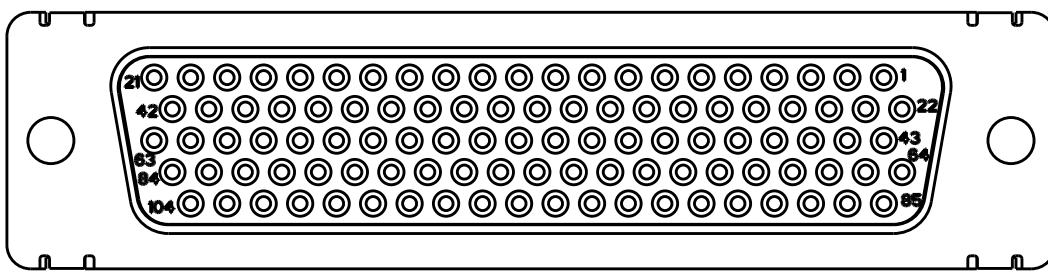

SIZE 6  
SCALE 2:1

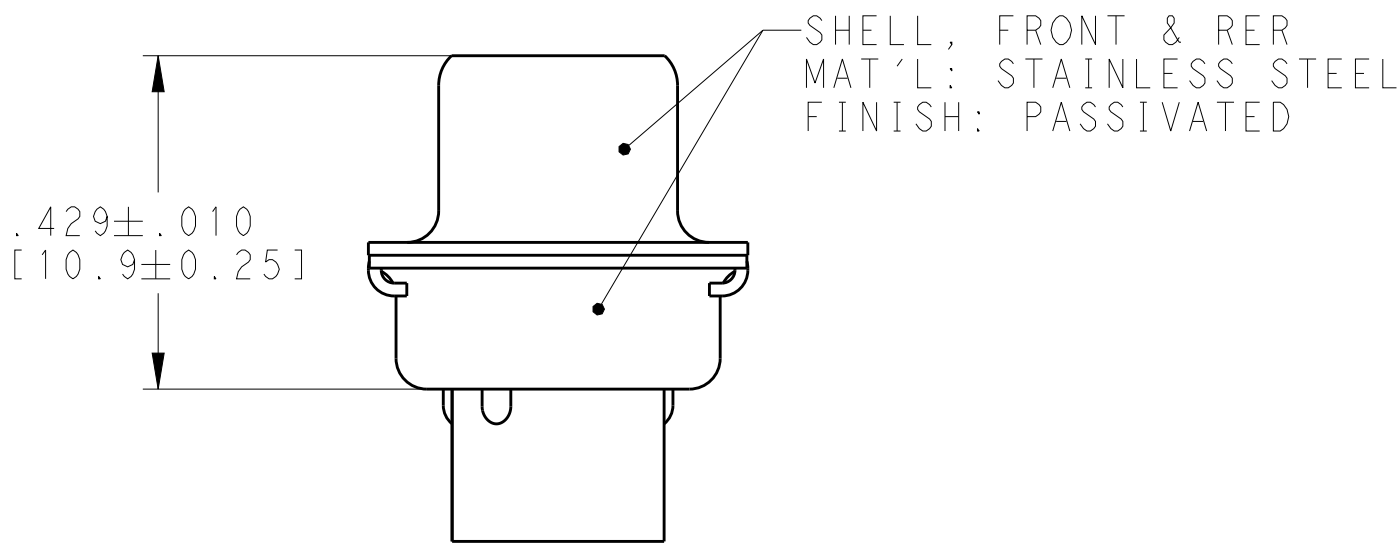
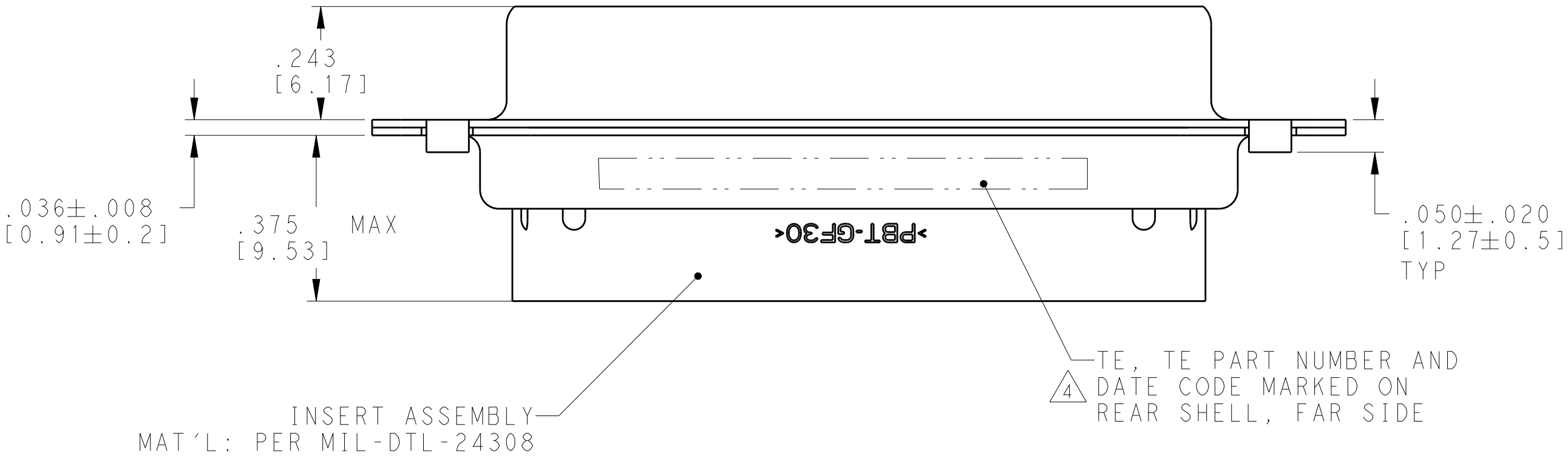

2335893-3 SHOWN

- THIS ASSEMBLY IS DESIGNED TO CONFORM TO THE LATEST ISSUE OF MIL-DTL-24308
- METAL RETENTION CLIPS ARE INCLUDED IN INSERTS.
- THIS RECEPTACLE WILL ACCEPT SIZE 22 SOCKET CONTACTS M39029/57-354 TE CONNECTIVITY PART NO. 204351-1. CONTACTS ARE NOT INCLUDED AND MUST BE ORDERED SEPARATELY.

4 MARKED WITH .047-.062 HIGH CHARACTERS. FAR SIDE REFERS TO THE WIDE SIDE OF THE KEYSTONE. NEAR SIDE REFERS TO THE NARROW SIDE OF THE KEYSTONE. IF THE REAR SHELL IS TOO SMALL FOR TE, TE PART NUMBER AND DATE CODE, THEN SPLIT AS FOLLOWS:  
A: TE PART ON REAR SHELL, NEAR SIDE  
B: TE AND DATE CODE ON REAR SHELL, FAR SIDE

DATE CODE IS FOUR DIGITS, FIRST TWO DIGITS REFER TO THE YEAR AND SECOND TWO DIGITS REFER TO THE WEEK.

WITH	2335891-5	.605 [15.37]	.423 [10.74]	2.406 [61.11]	2.064 [52.43]	2.635 [66.93]	78	5	1-2335893-1
WITHOUT	2335891-6	.668 [16.97]	.485 [12.32]	2.500 [63.50]	2.189 [55.60]	2.729 [69.32]	104	6	2335893-6
WITHOUT	2335891-5	.605 [15.37]	.423 [10.74]	2.406 [61.11]	2.064 [52.43]	2.635 [66.93]	78	5	2335893-5
WITHOUT	2335891-4	.494 [12.55]	.311 [7.90]	2.500 [63.50]	2.159 [54.84]	2.729 [69.32]	62	4	2335893-4
WITHOUT	2335891-3	.494 [12.55]	.311 [7.90]	1.852 [47.04]	1.511 [38.38]	2.088 [53.03]	44	3	2335893-3
WITHOUT	2335891-2	.494 [12.55]	.311 [7.90]	1.312 [33.32]	.971 [24.66]	1.541 [39.14]	26	2	2335893-2
WITHOUT	2335891-1	.494 [12.55]	.311 [7.90]	.984 [24.99]	.643 [16.33]	1.213 [30.81]	15	1	2335893-1
204351-1 CONTACTS	TE MATING PART NUMBER	DIM E	DIM D	DIM C	DIM B	DIM A	NUMBER OF POSITIONS	SHELL SIZE	TE PART NO.

THIS DRAWING IS A CONTROLLED DOCUMENT.		DWN C.C. THOMAS 8-21-18	NAME D.MILLER	
DIMENSIONS: INCHES [mm]		APVD D.MILLER 8-21-18	PRODUCT SPEC	
TOLERANCES UNLESS OTHERWISE SPECIFIED:		APPLICATION SPEC	WEIGHT	
MATERIAL		CUSTOMER DRAWING	SCALE 4:1	

TE Connectivity	
RECEPTACLE ASSEMBLY, SIZE 1 THRU 6 SERIES 90, AMPLIMITE WITH STAINLESS STEEL SHELLS	
SIZE A100779	RESTRICTED TO
CAGE CODE C=2335893	REV C

# Mouser Electronics

Authorized Distributor

Click to View Pricing, Inventory, Delivery & Lifecycle Information:

[TE Connectivity:](#)

[2335893-4](#)